

# For Sublease

## CENTRE 10

517 10<sup>th</sup> Avenue SW

11,028 to 19,224 s.f. of Premium Office Space Available



# Unit 850

11,028 s.f. to 19,224 s.f.

<b>Annual Net Rent</b>	Sublease Market Rate
<b>Availability</b>	30 Days
<b>Expiry</b>	November 30, 2029
<b>Op Cost</b>	\$16.29 p.s.f. (Est. 2026)
<b>Parking</b>	1 stall per 709 s.f. leased Call for parking rates

- 17 Offices
- 64 Workstations
- 2 Large Boardroom
- 6 Meeting Rooms
- Open Corner Meeting Areas
- Reception Area
- Kitchen / Lounge

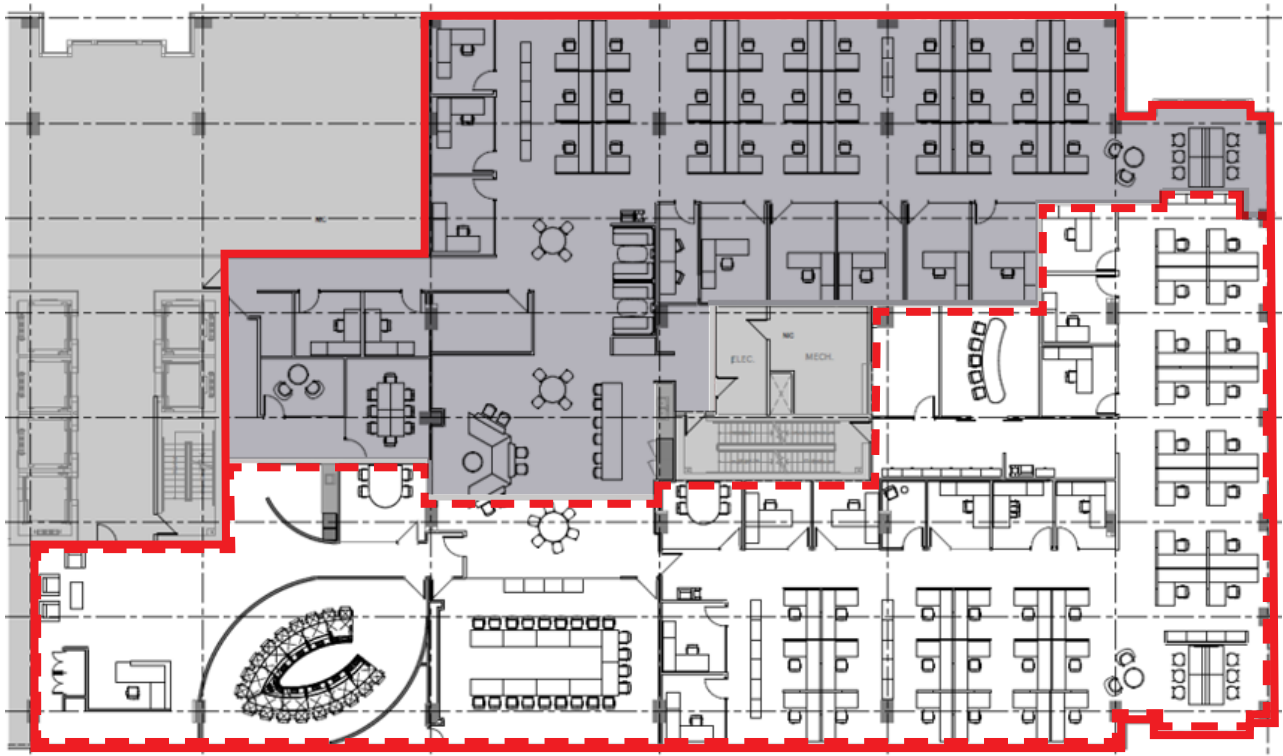

 11,028 s.f.       19,224 s.f.

# Current Floor Plan Gallery



## Location and Amenities

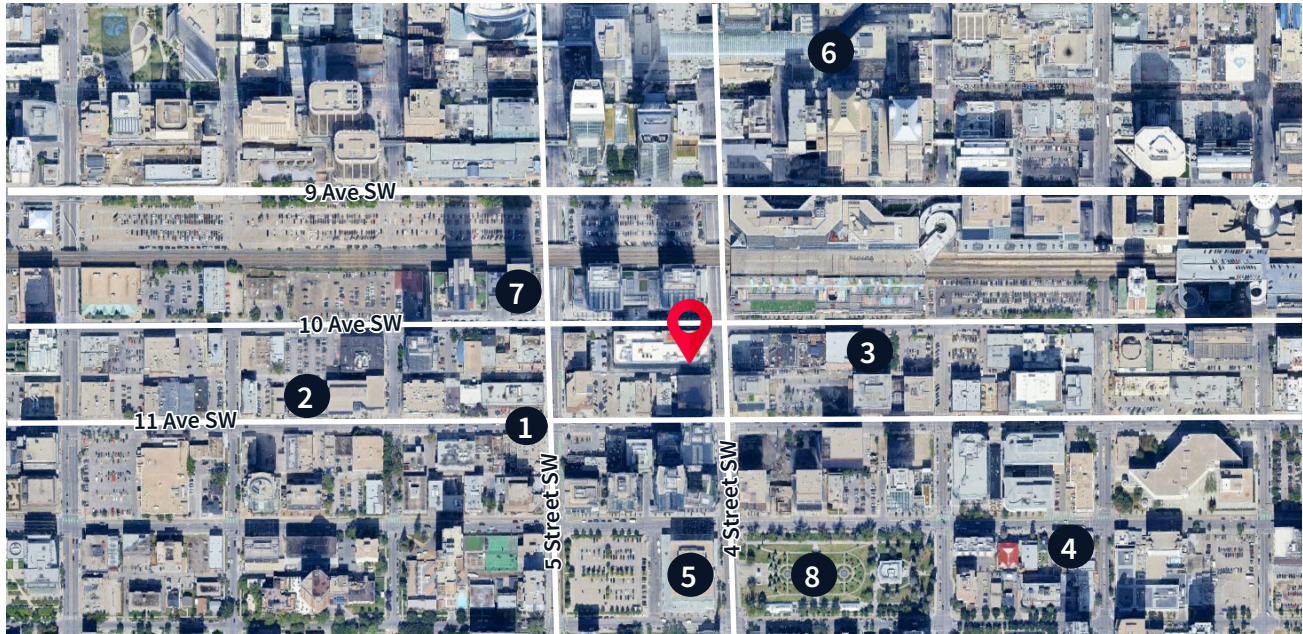

- |                                |  |
|--------------------------------|--|
| <b>1</b> Last Best Brewing     | <b>5</b> Sheldon M. Chumuir Health Center  |
| <b>2</b> Noble Pie             | <b>6</b> CORE Shopping Centre              |
| <b>3</b> Toscana Italian Grill | <b>7</b> Residence Inn by Marriott Calgary |
| <b>4</b> Ten Foot Henry        | <b>8</b> Central Memorial Park             |

**For more information please contact**

**Kara Dusseldorp**  
Associate Vice President  
403 456 2348  
[kara.dusseldorp@jll.com](mailto:kara.dusseldorp@jll.com)

**James McKenzie**  
Vice President  
403 456 8100  
[james.mckenzie@jll.com](mailto:james.mckenzie@jll.com)

Although information has been obtained from sources deemed reliable, neither Owner nor JLL makes any guarantees, warranties or representations, express or implied, as to the completeness or accuracy as to the information contained herein. Any projections, opinions, assumptions or estimates used are for example only. There may be differences between projected and actual results, and those differences may be material. The Property may be withdrawn without notice. Neither Owner nor JLL accepts any liability for any loss or damage suffered by any party resulting from reliance on this information. If the recipient of this information has signed a confidentiality agreement regarding this matter, this information is subject to the terms of that agreement.

©2026 Jones Lang LaSalle IP, Inc. All rights reserved.