

FOR LEASE

831
LATOUR
COURT

BROKER INCENTIVE: FULL MARKET FEE +

2 tickets to Hawaii for any lease signed by June 30th, 2026.

**Contact broker for details.*



±6,550 SF INDUSTRIAL SUITE
NAPA COMMONS BUSINESS PARK | NAPA, CA

831 Latour Court, Suite D

- ±6,550 SF industrial suite
- ±950 SF of office space including reception, break room/lab, two bathrooms and whse sink
- Corner location with ample parking
- 200 amps, 277/480v electrical service
- One combined dock and grade door
- LED lighting in office and warehouse
- 10-ton warehouse mechanical cooling unit
- New office HVAC unit

BUILDING FEATURES:

- ±37,631 SF multi-tenant light industrial bldg
- 60-mil TPO insulated roof
- Attractive exterior elastomeric repainting
- 20' warehouse ceiling clear height
- 3.5 per 1,000 parking ratio
- Extensive glass line & mature landscaping
- City of Napa water/sewer/zoning

Napa Location Map

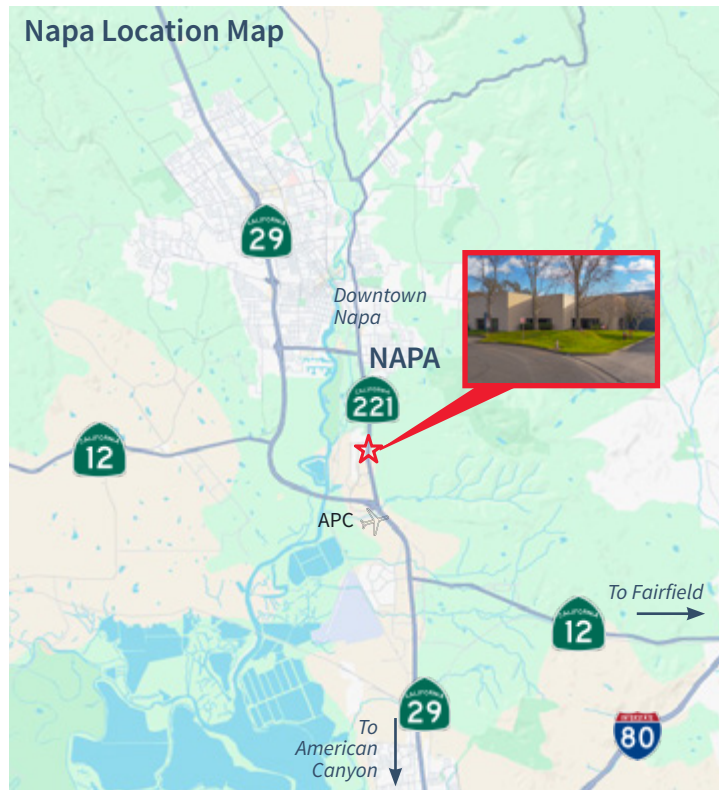

To Schedule a Tour or For More Information, Please Contact:



CHRIS NEEB
chris.neeb@jll.com
(707) 495 7777
RE License No: 01324612

MATT BRACCO
matt.bracco@jll.com
(925) 200 3537
RE License No: 01185434

GLEN DOWLING
glen.dowling@jll.com
(707) 227 7800
RE License No: 00890450

SITE PLAN

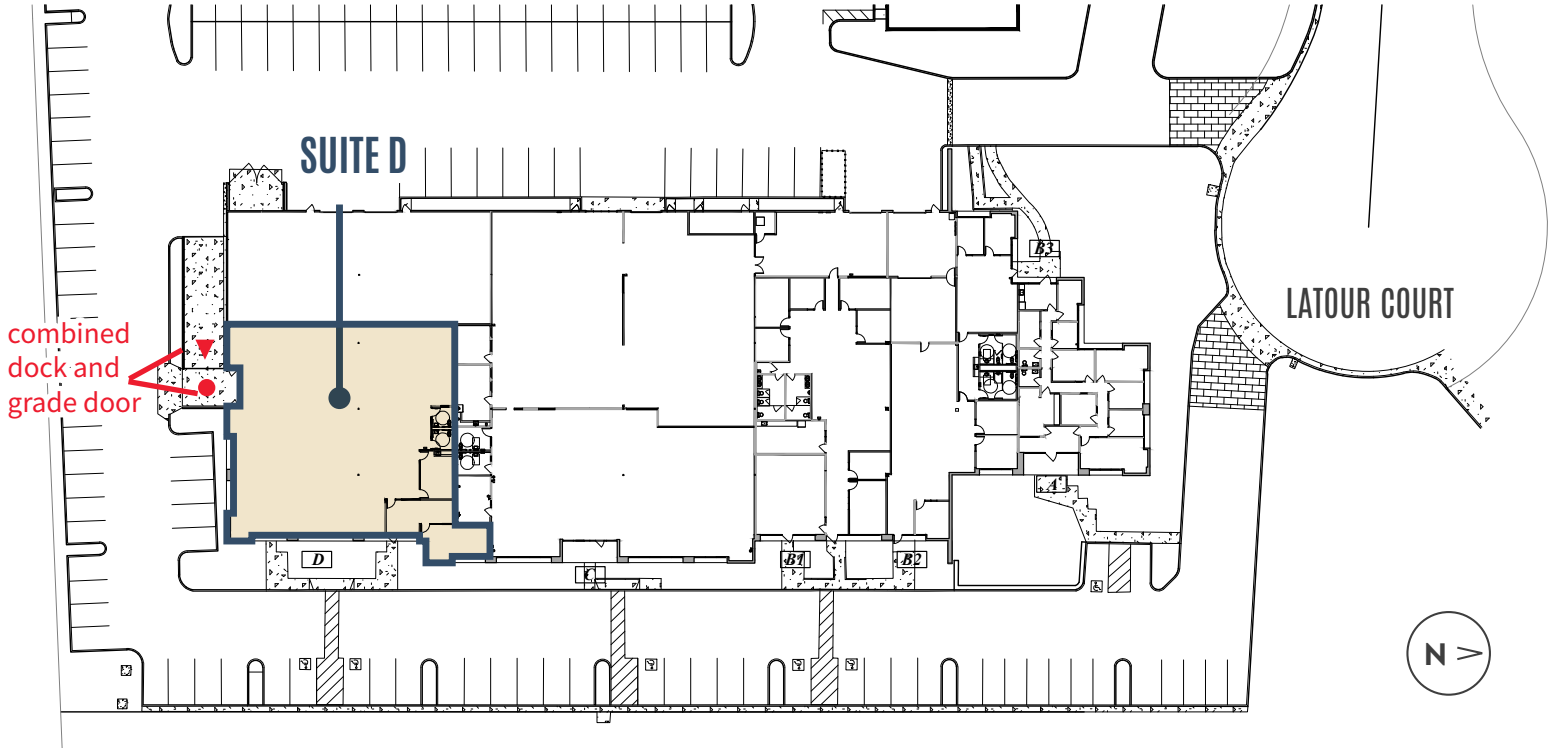

FLOOR PLAN | ±6,550 SF Industrial Suite



To Schedule a Tour or For More Information, Please Contact:

www.JLL.com



CHRIS NEEB
chris.neeb@jll.com
(707) 495 7777
RE License No: 01324612

MATT BRACCO
matt.bracco@jll.com
(925) 200 3537
RE License No: 01185434

GLEN DOWLING
glen.dowling@jll.com
(707) 227 7800
RE License No: 00890450