

9051 SIEMPRE VIVA ROAD

AVAILABLE SUITES

SUITE	TOTAL SF	% WAREHOUSE	% OFFICE	LEASE RATE	# OF DOCK DOORS	# OF GRADE DOORS	COMMENTS
A	21,974 SF	18,323 SF (83%)	3,651 SF (17%)	\$1.15-\$1.25 NNN	10	1	Available Now

LEGEND

- = AVAILABLE FOR LEASE
- = LEASED
- D = DOCK HEIGHT LOADING DOOR
- DD = DOUBLE -WIDE DOCK HEIGHT LOADING DOOR
- G = GRADE LEVEL LOADING DOOR

OPERATING EXPENSES:
CURRENTLY ESTIMATED TO BE \$0.33 NNN/SF MONTH

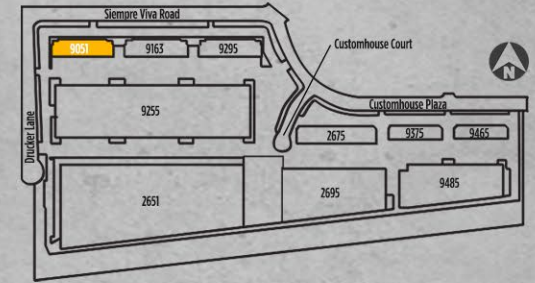

FRONTERA
BUSINESS PARK

9051 AVAILABILITY

SECOND FLOOR

