

# 3011 SMALLMAN STREET

Pittsburgh, PA 15201

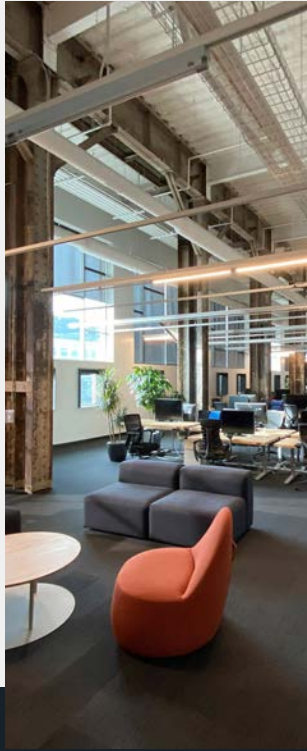



# EXPERIENCE

## 3011 SMALLMAN STREET

Sitting in the middle of Pittsburgh's bustling Strip District's Robotics Row, 3011 Smallman Street presents the users a rare opportunity to be in an office building that flawlessly blends historical elements with contemporary finishes. From exposed steel beams to polished concrete floors, the building pays homage to its previous days of housing the Crucible Steel Company facility. While 3011 Smallman has already come a long way from its blue-collar history, more improvements are on the way, including a renovated fitness center with showers, an updated entrance/lobby, and an all-hands amenity space.



3-story, 110,000 SF office building



Planned common area and amenity improvements



Steps away from various retail options



Historical elements throughout the building



Move-in ready availabilities

# THE EPICENTER OF THE STRIP DISTRICT'S CREATIVE ENERGY

3011 Smallman Street, sitting right off of the 31st Street Bridge, is surrounded by some of Pittsburgh's best mom-and-pop shops, authentic cuisine restaurants, and tech-leader headquarters.

5

Minutes to  
Downtown Pittsburgh

100+

Retailers within the  
Strip District

4,800+

Multi-family  
units planned/  
completed within  
the Strip District

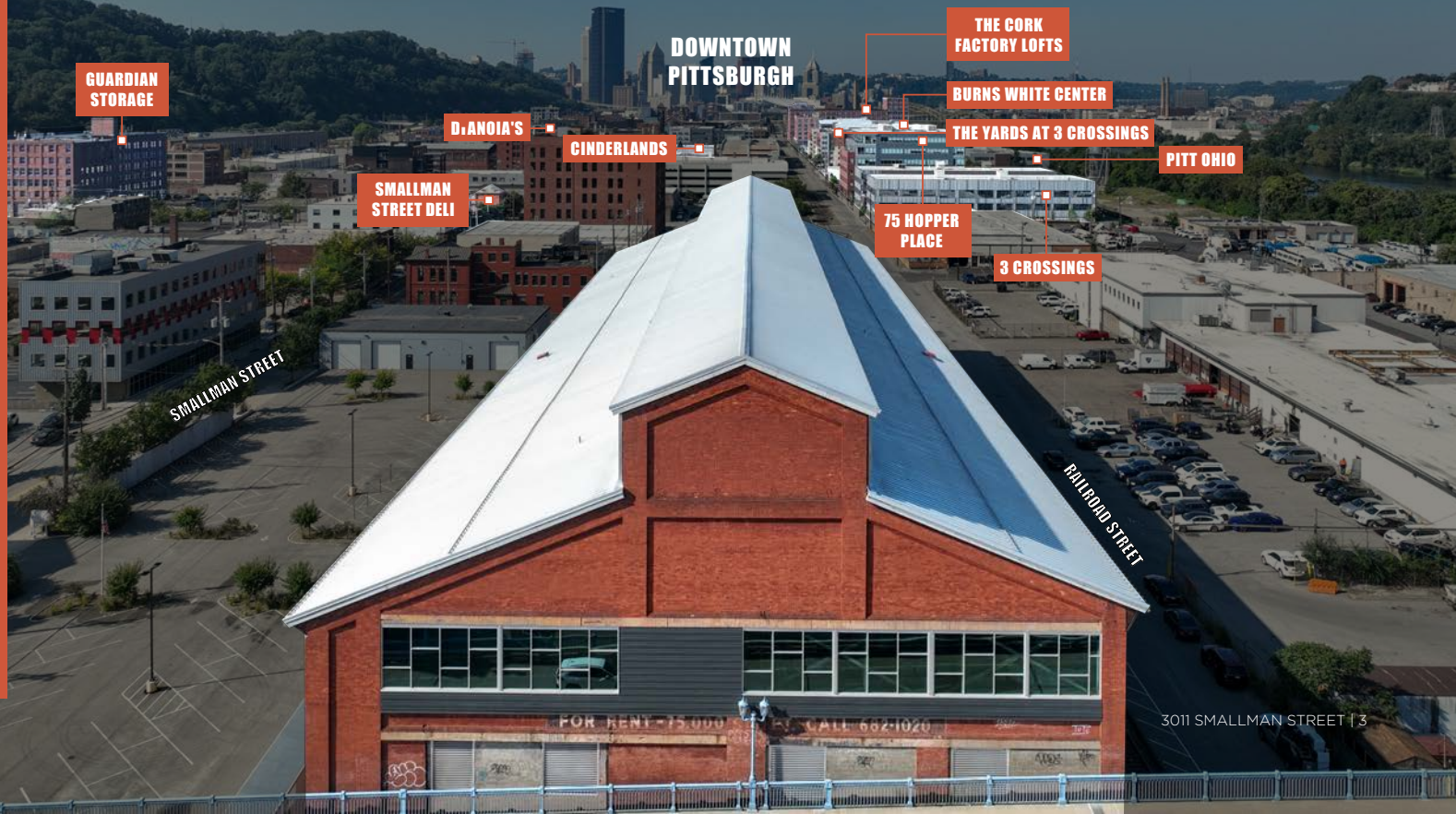

# CURRENT AVAILABILITIES

14,238 - 16,251 RSF

- Shared All-Hands Amenity Space
- Fitness Center & Shower Facilities
- Shared Board Room

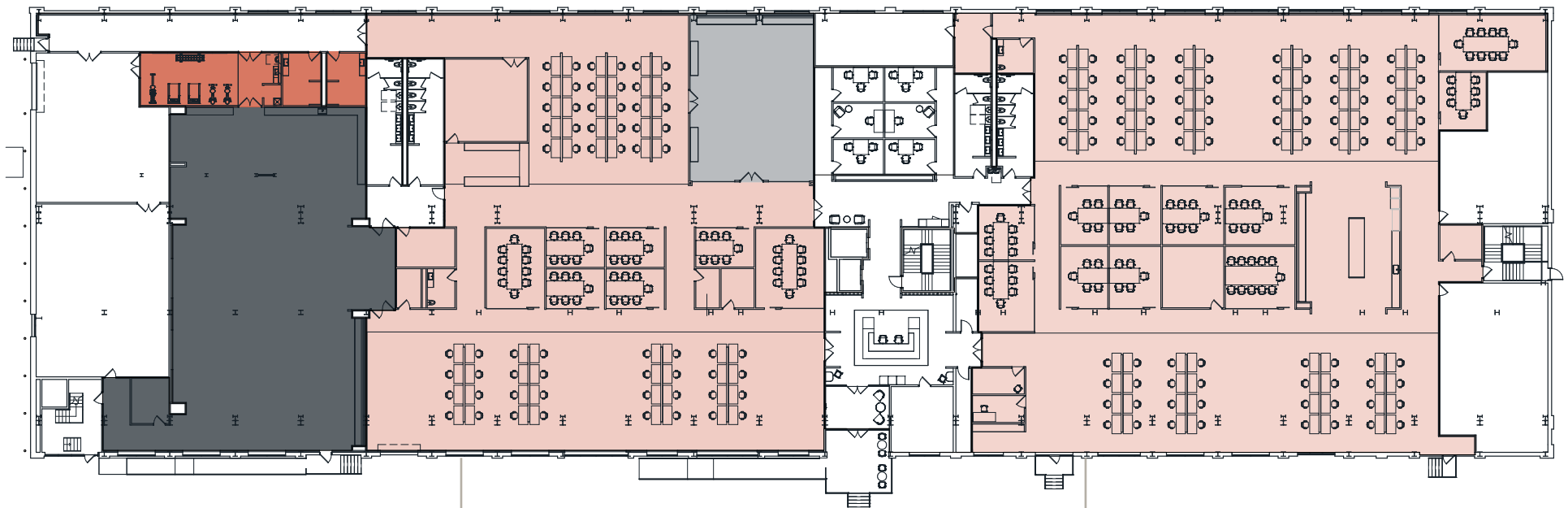

14,238 RSF

16,251 RSF

# UNMATCHED ACCESSIBILITY

The Strip District provides convenient access to Downtown Pittsburgh, Lawrenceville, and convenient access to Route 28 which connects the property to broader suburban areas.

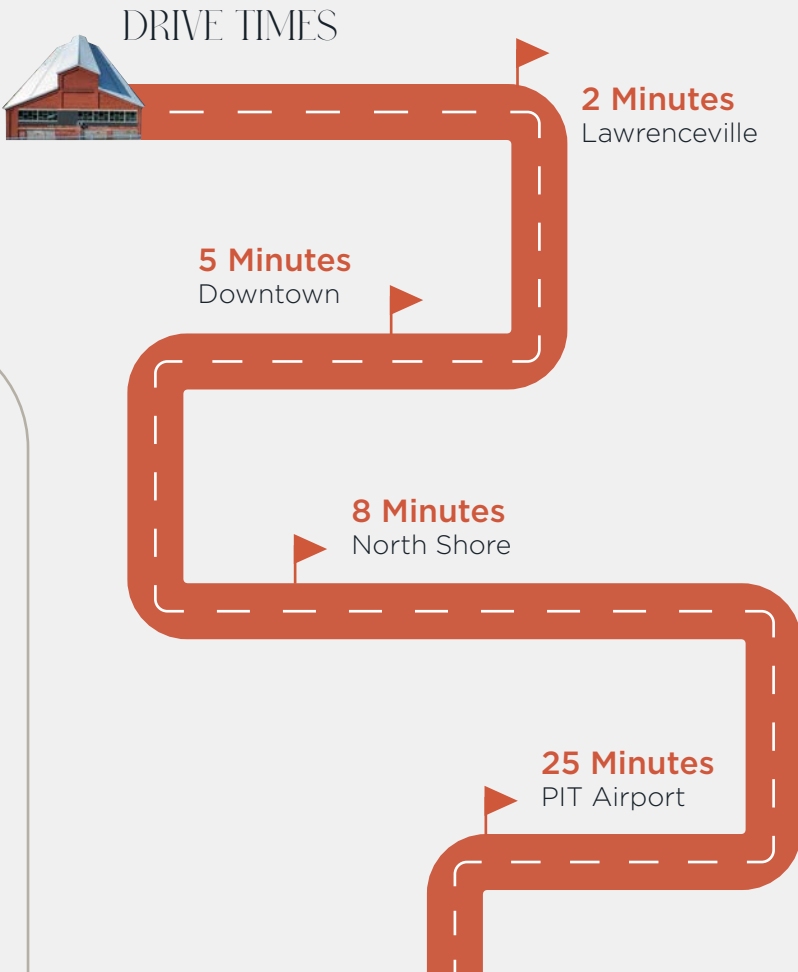

**CLOSEST  
BUS STOPS**

Buses:  
54, 86, 87, 88, 91

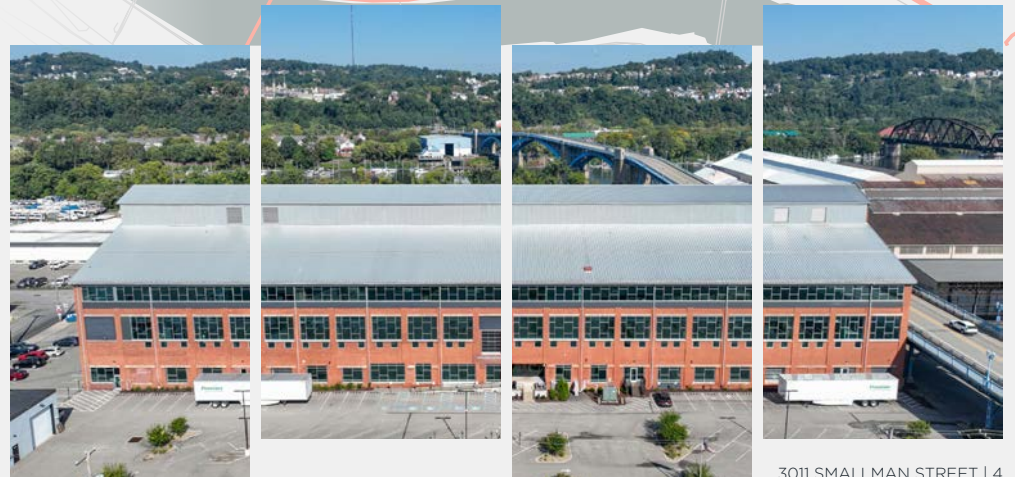

# WALKABLE AMENITIES

That immerse you in the culture of the Strip

 within a 20-minute walk

## RESTAURANTS



## RETAIL/ENTERTAINMENT



# 3011 SMALLMAN STREET

Pittsburgh, PA 15201

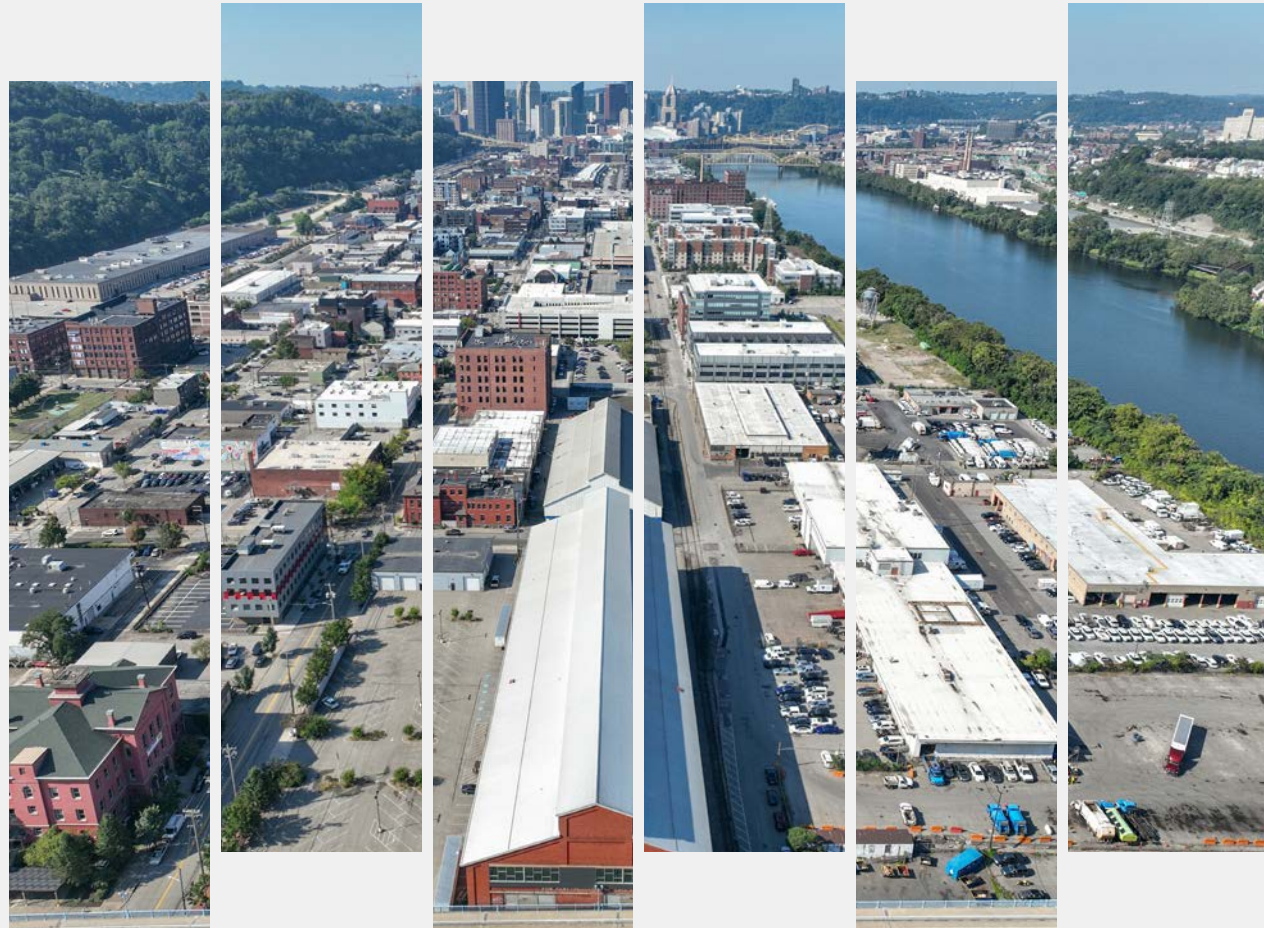

## BROKER CONTACTS

**JEFF ADAMS**

+1 412 208 1404

jeff.adams@jll.com

**JASON STEWART**

+1 412 208 1402

jason.stewart@jll.com

Although information has been obtained from sources deemed reliable, JLL does not make any guarantees, warranties or representations, express or implied, as to the completeness or accuracy as to the information contained herein. Any projections, opinions, assumptions or estimates used are for example only. There may be differences between projected and actual results, and those differences may be material. JLL does not accept any liability for any loss or damage suffered by any party resulting from reliance on this information. If the recipient of this information has signed a confidentiality agreement with JLL regarding this matter, this information is subject to the terms of that agreement. ©2026 Jones Lang LaSalle Brokerage, Inc. All rights reserved.

