

24147 6TH STREET
SAN BERNARDINO, CA

±41,955 SF
SITUATED ON ±5.89 ACRES
FOR SALE



PROPERTY FEATURES

- » ±41,955 SF on ±5.89-acres of land
 - » Building 1: ±32,797 SF Industrial Building
 - » ±8,564 SF of Office Space
 - » 16 standard grade level doors
 - » 7 oversized grade level doors
 - » Building 2: ±9,198 SF Industrial Building
 - » 38 standard grade level doors
 - » 2 oversized grade level doors
 - » Partially fenced & secured
- » 600 Amps power
- » Jurisdiction: County of San Bernardino
- » Located in an Opportunity Zone
- » 1.7mi from I-215, with immediate access as well to the I-10 and SR-210 Freeways.
- » Minutes from San Bernardino Int'l Airport
- » APN: 0279-011-40

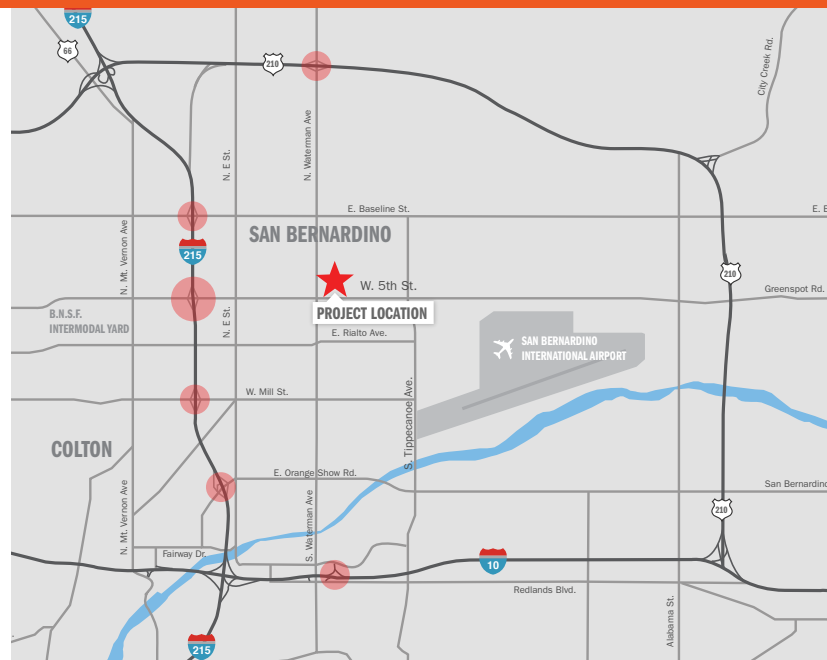

PATRICK WOOD

patrick.wood@jll.com
+1 909 467 6857
RE License #01776274

CODY CLAYTON

cody.clayton@jll.com
+1 909 467 6864
RE License #02006423

SCOTT COYLE

scott.coyle@jll.com
+1 909 467 6870
RE License #02066670

CHASE BERRY

chase.berry@jll.com
+1 909 467 6877
RE License #02196093

24147 6TH STREET
SAN BERNARDINO, CA

±41,955 SF
SITUATED ON ±5.89 ACRES
FOR SALE

SITE PLAN

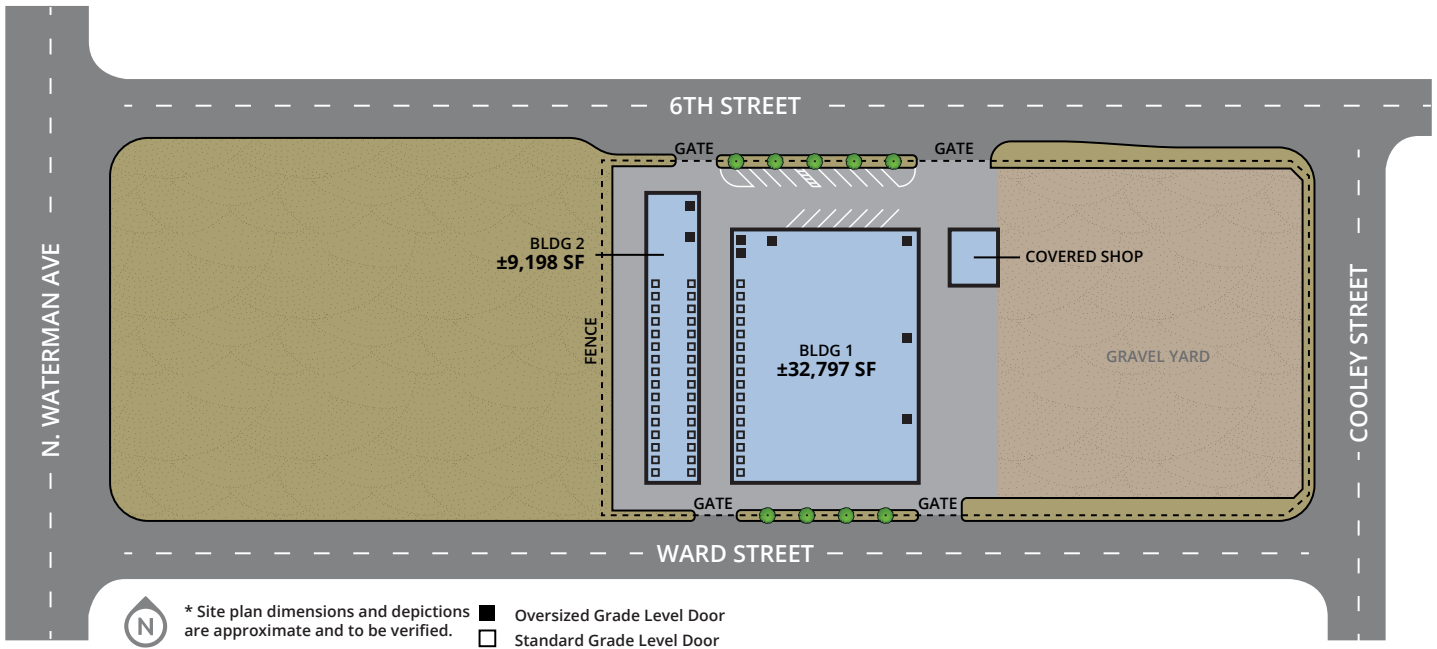

PATRICK WOOD

patrick.wood@jll.com
+1 909 467 6857
RE License #01776274

CODY CLAYTON

cody.clayton@jll.com
+1 909 467 6864
RE License #02006423

SCOTT COYLE

scott.coyle@jll.com
+1 909 467 6870
RE License #02066670

CHASE BERRY

chase.berry@jll.com
+1 909 467 6877
RE License #02196093