

9750 Irvine Boulevard
Irvine, CA 92618

LEASED BY:



Kurv Irvine Orange County



43,971 SF

Available Space

Available
Immediately

KURVINDUSTRIAL.COM

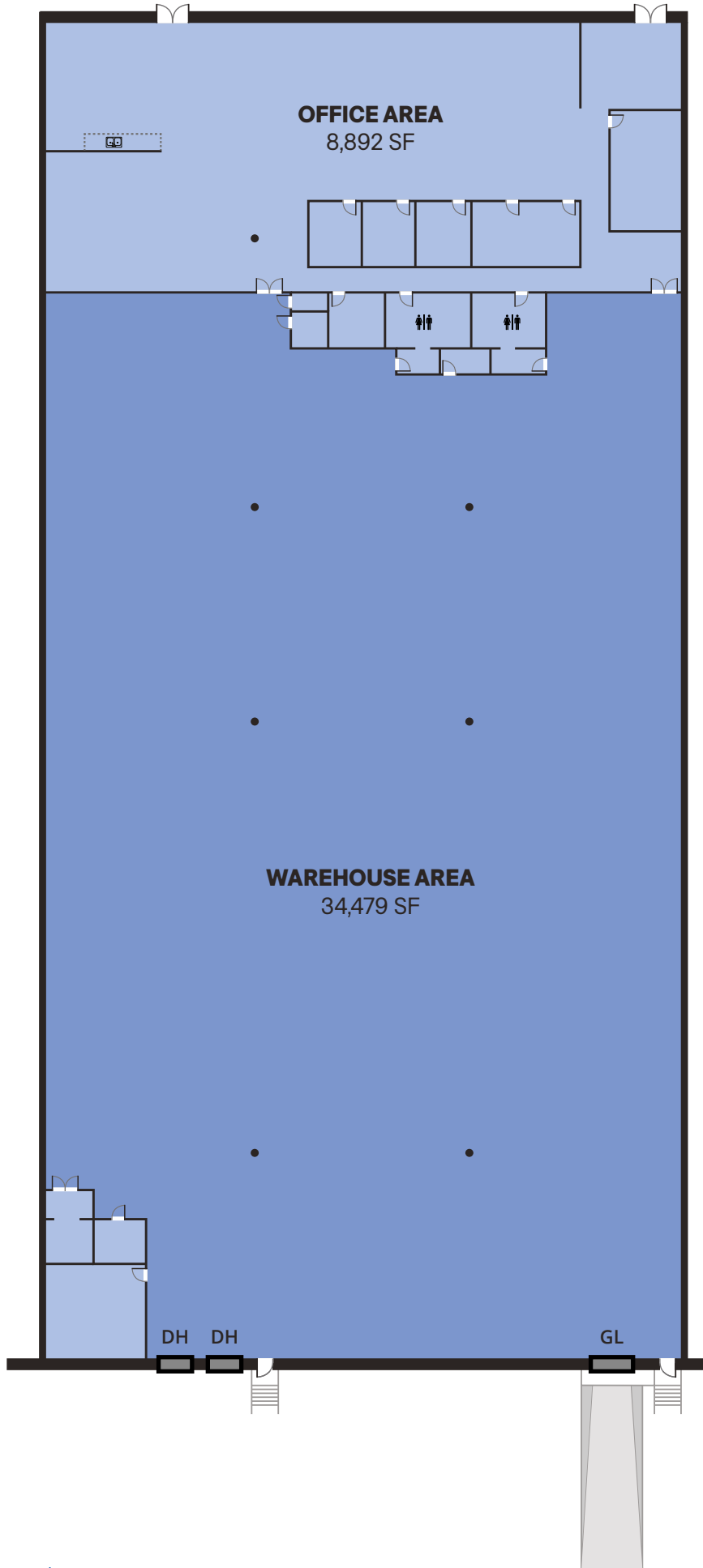

Building Specs

ADDRESS

9750 Irvine Blvd
Suite 106
Irvine, CA 92618

EXTERIOR DOCKS

2

AVAILABLE SF

43,971

DRIVE-IN DOORS

1

TOTAL SF

348,230

CLEAR HEIGHT

±24' minimum

OFFICE SPACE SF

8,892

COLUMN SPACING

48'x48'

TRAILER PARKING

Two @ Parking Positions

PARKING

Auto: 44 stalls

POWER

400 Amps
227/480 Volt

LIGHTING

LED

FIRE SPRINKLER

Calculated

Strategic Logistics Location

State-of-the-art construction and move-in ready.

- Remarkable proximity to the 5 & 405 freeways and thousands of affluent roof-tops
- Completely renovated in 2020 and professionally owned/managed by Curv Industrial
- Excellent frontage/visibility on corner of Irvine BLVD. & Fairbanks

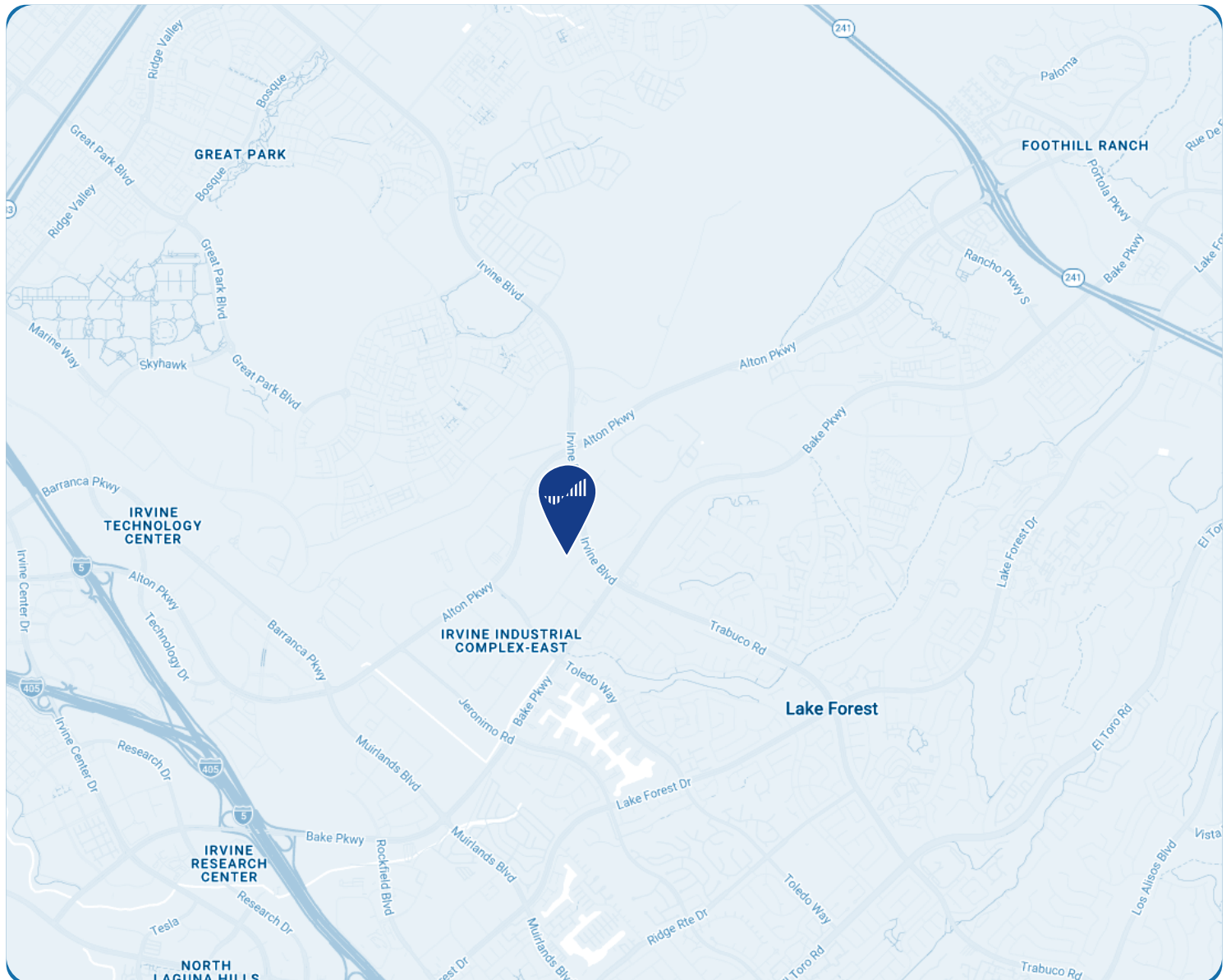

Blue chip corporate neighbors

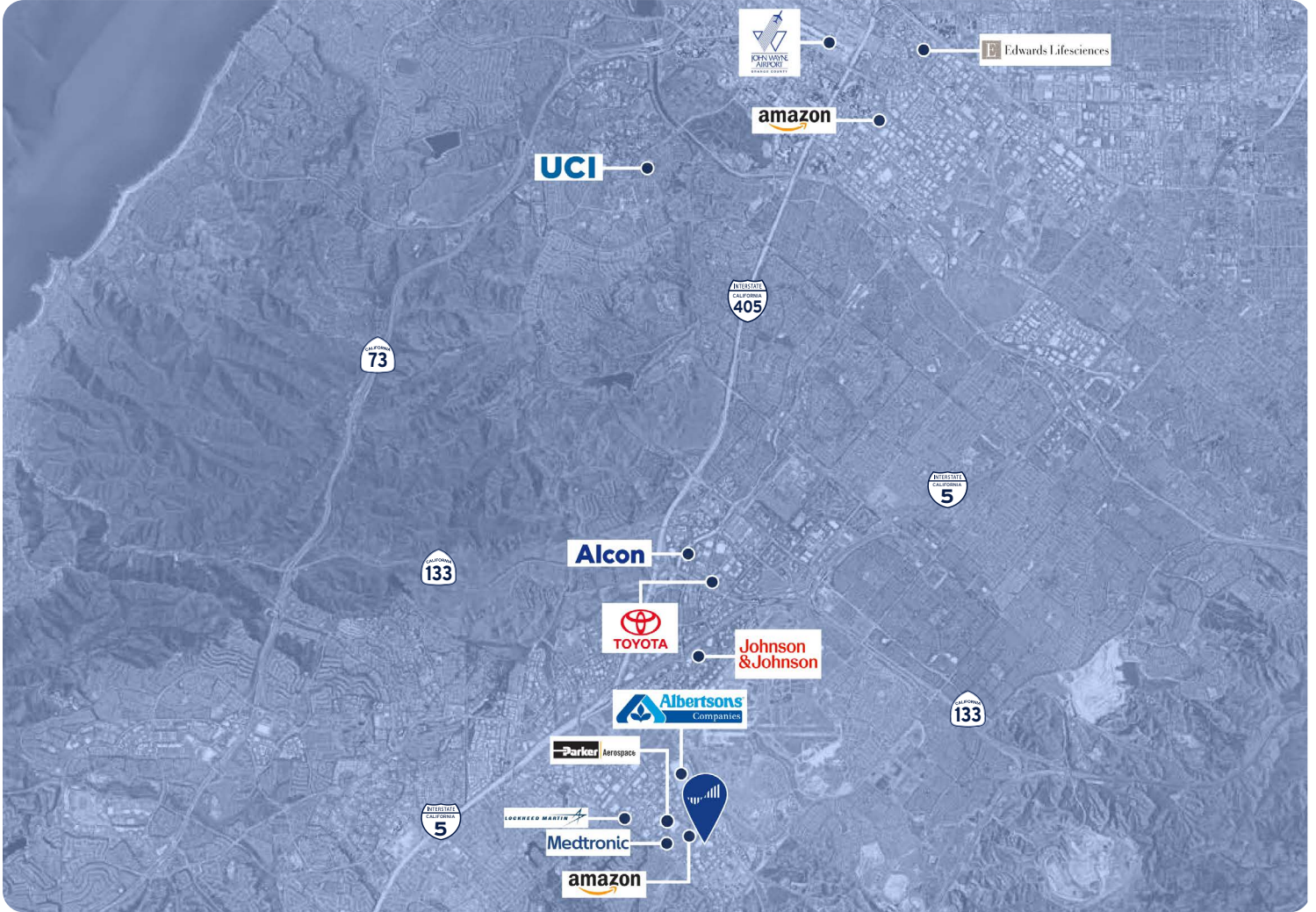

Chicago • Dallas • Los Angeles • Miami • New Jersey • Seattle



76M+ SF

Acquired & Developed
since 2000

Kurv Industrial is a vertically integrated industrial real estate investment and operating platform. The firm acquires, develops, and operates institutional-quality assets in the high-barrier, supply-constrained markets of Chicago, Dallas, Miami, Los Angeles, New Jersey, and Seattle.

Grounded in a tradition of excellence and driven by a forward-looking vision, Kurv leverages local market insight, operational rigor, and disciplined execution to create value for investors, partners, and communities. Since its inception in 2000, Kurv has successfully acquired and developed over 76 million square feet of industrial facilities.

Our Commitment to Sustainability

As stewards of sustainability, resilience, and regeneration, our vision is to deliver exceptional value for our investors, employees, tenants, and communities through superior ESG performance.



TERMS

Available on a new lease direct from the landlord.

LEASING INFORMATION

Please contact listing agents below.



Steve Wagner
Senior Managing Director
949.885.2923
steve.wagner@jll.com
RE License #01314652

Zach Niles
Senior Managing Director
949.885.2922
zach.niles@jll.com
RE License #01311756

Louis Tomaselli
Executive Managing Director
949.885.2985
louis.tomaselli@jll.com
RE License #00904844