

# 2151-2165

Shattuck Ave, Berkeley



RETAIL SPACE FOR LEASE



Downtown Berkeley Retail opportunity  
4,740 SF & 1,815 SF available



# THE MARKET

Downtown Berkeley is the city's vibrant urban hub, home to global restaurants, trendy coffee shops, cultural institutions, and the busiest public transit stop (BART) outside of downtown San Francisco. The thriving retail core services Berkeley's eclectic mix of families, residents, CAL Berkeley students and faculty, and dense downtown office base.



Located in "Main & Main" downtown



In the heart of the retail and restaurant scene in downtown Berkeley



Across the street from Berkeley Downtown BART stop **14,000 exits per day**



**1 Block** from UC Berkeley



**Large student population** in the area



UC Berkeley **66,000** students and staff

Berkeley High **3,400**

Berkeley City College **8,000** students and staff

Map data ©2026 Google

# 4,740 SF

2151 Shattuck Ave

Former renovated Bank of America

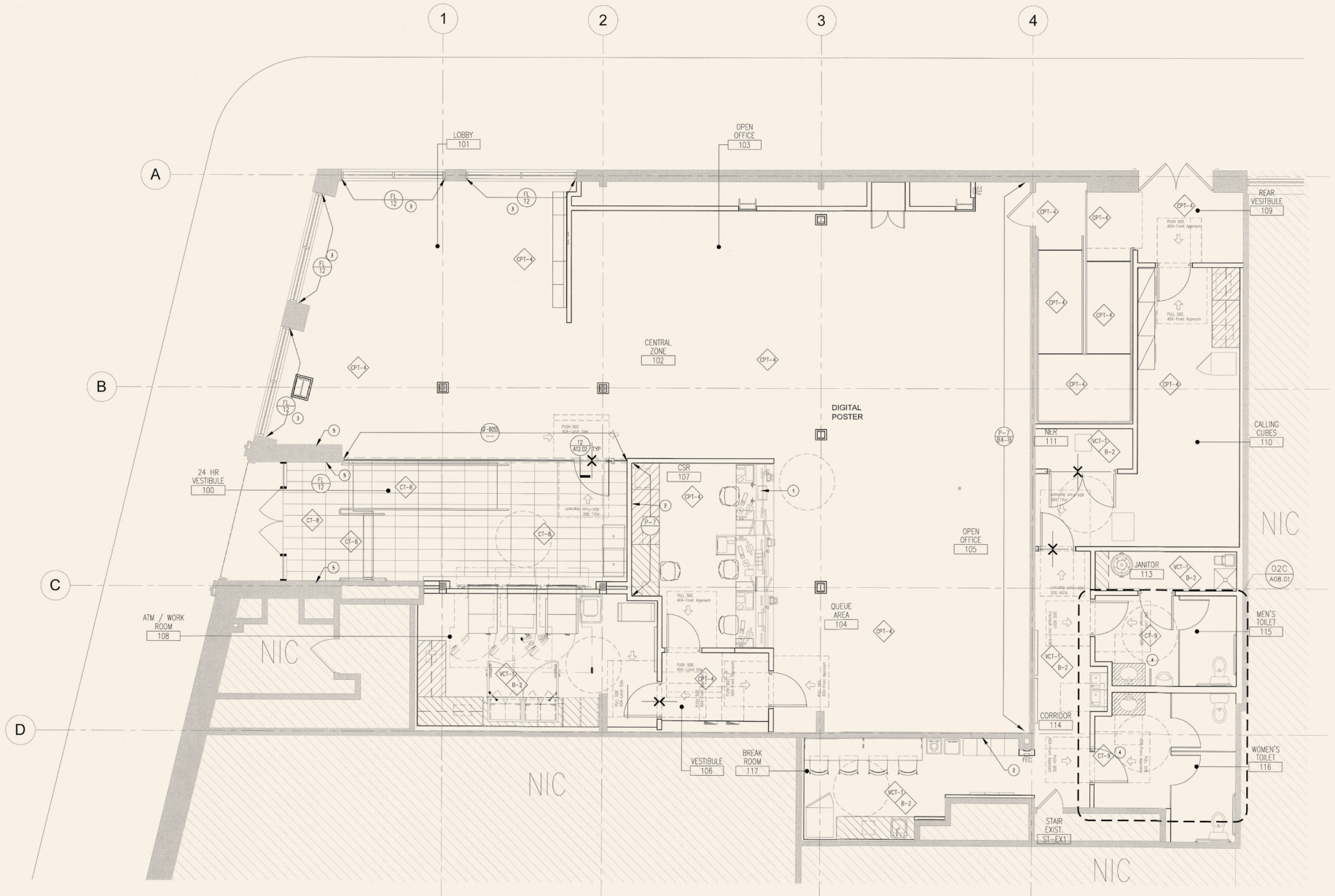

**4,740 SF**

2151 Shattuck Ave



# 1,815 SF

2165 Shattuck Ave

Additional 1,931 SF of basement available

## Existing entry level floor plan

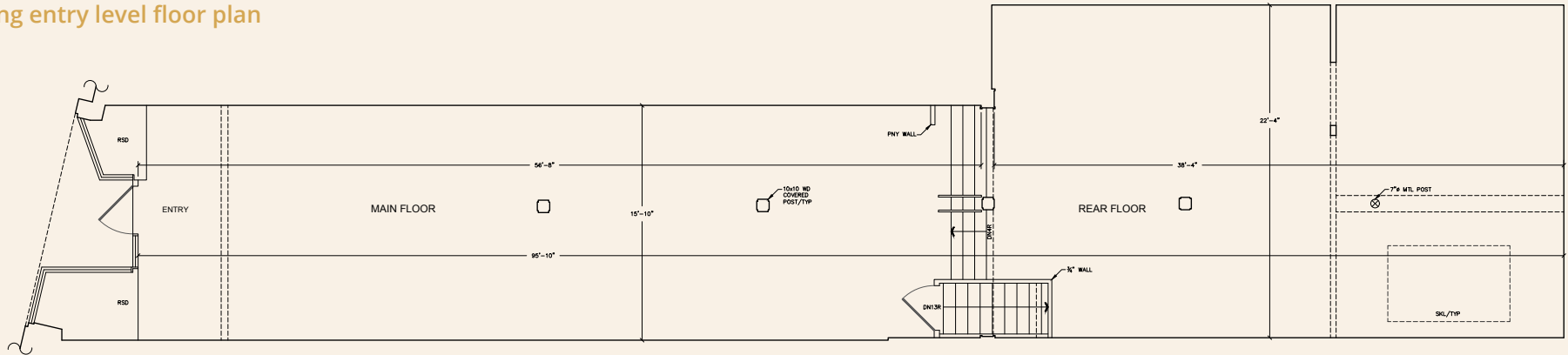

## Existing basement level floor plan

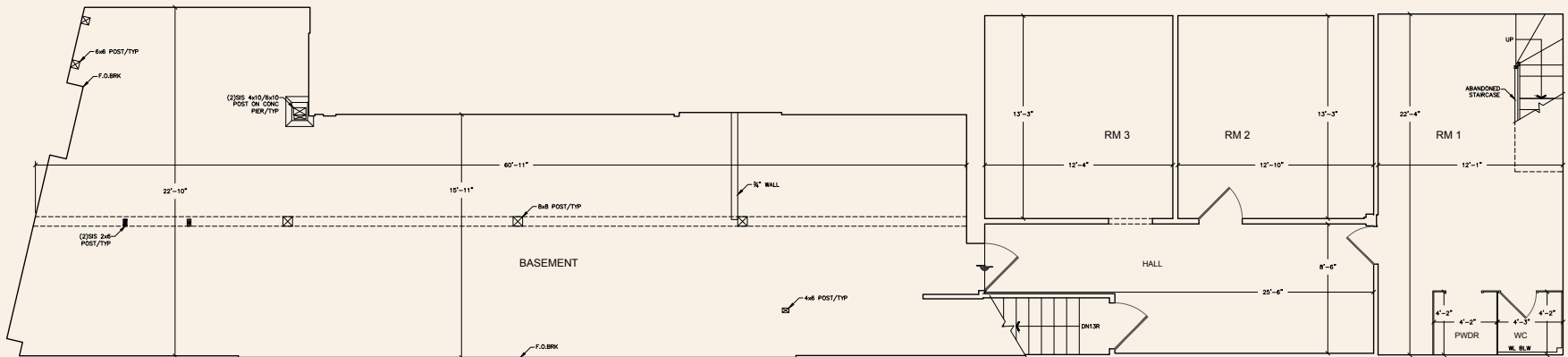



# 2151-2165

Shattuck Ave, Berkeley

**Justin Choi**

Associate

+1 415 395 7262

[justin.choi@jll.com](mailto:justin.choi@jll.com)

CA #02107928

**Jeff Badstubner**

Managing Director

+1 925 872 4550

[jeff.badstubner@am.jll.com](mailto:jeff.badstubner@am.jll.com)

CA #01155279



Although information has been obtained from sources deemed reliable, neither Owner nor JLL makes any guarantees, warranties or representations, express or implied, as to the completeness or accuracy as to the information contained herein. Any projections, opinions, assumptions or estimates used are for example only. There may be differences between projected and actual results, and those differences may be material. The Property may be withdrawn without notice. Neither Owner nor JLL accepts any liability for any loss or damage suffered by any party resulting from reliance on this information. If the recipient of this information has signed a confidentiality agreement regarding this matter, this information is subject to the terms of that agreement. ©2026. Jones Lang LaSalle IP, Inc.

All rights reserved.