

3,094 SF
AVAILABLE NOW



11095 Flintkote Street, Suite E



Exclusive leasing agents:

Chad Urie
tel +1 858 410 1187
chad.urie@jll.com
RE license #01261962

Grant Schoneman
tel +1 858 410 1252
grant.schoneman@jll.com
RE license #01516695

Michelle Westoby
tel +1 858 410 1190
michelle.westoby@jll.com
RE license #01377091

11095 FLINTKOTE AVENUE

SUITE E: 3,094 SF | AVAILABLE NOW

50% LAB | 50% OFFICE

Lab: 3 lab benches, 3 fume hoods (1 six foot and 2 eight foot), 1 lab support room, walk-in cold room

Office: 1 private office, 10 workstations, 1 conference room, break room

Can be combined with adjacent Suite D space to total 7,168 SF

*Furniture not included.

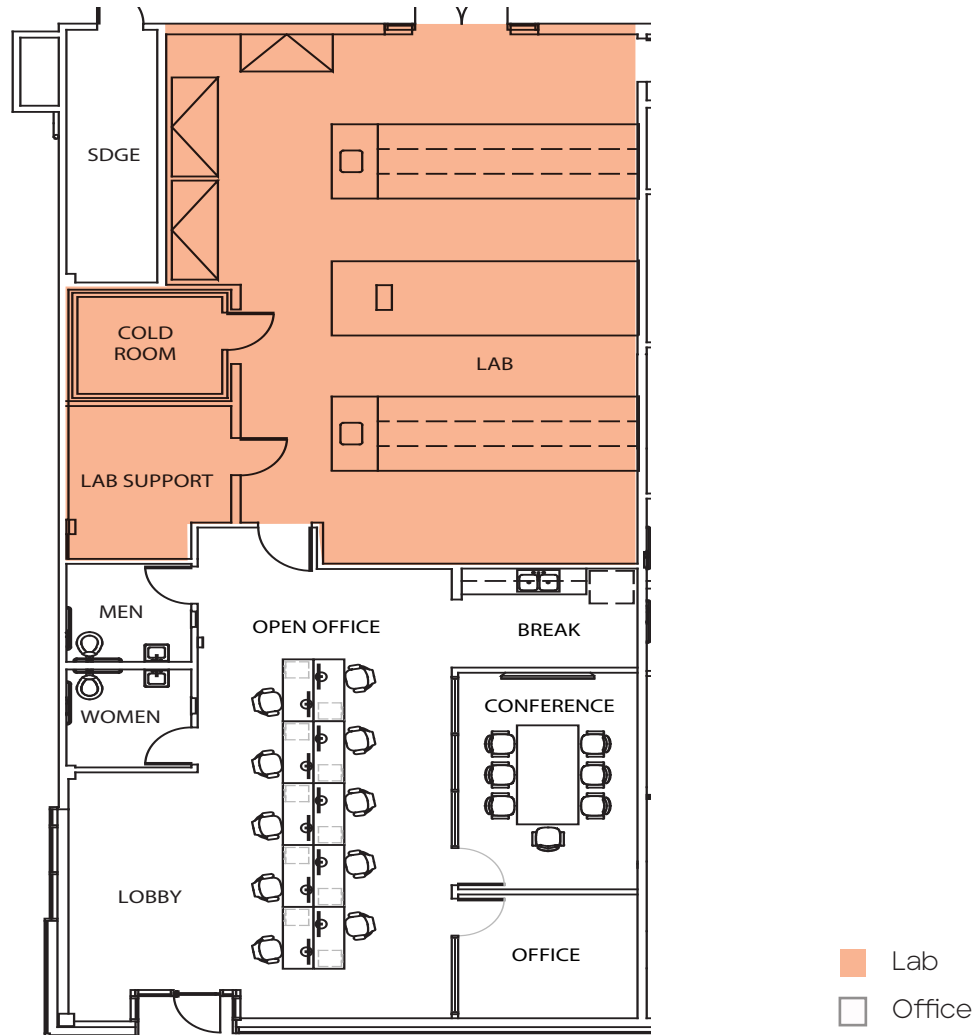

AMENITIES

- Fully Amenitized Campus
- Soma Cafe & Deli
- Conference Center
- Fitness Center
- Collaboration Lounge
- Catering Kitchen
- Restrooms/locker rooms
- Bike Storage
- Cafe
- Training Room
- Gym



Amenity Building



Cafe

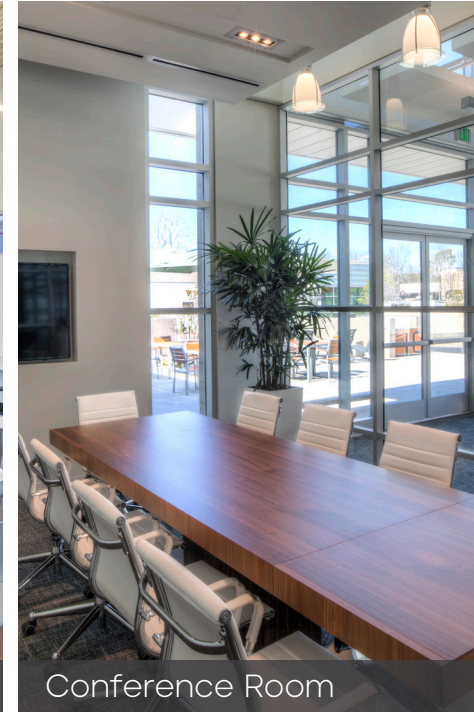

Conference Room



Training Room



Gym



Game Room