



*Image is artists rendering of conceptual renovation for marketing purposes only. Property to be sold as-is.

FOR SALE

1342 N. KNOLLWOOD CIRCLE, ANAHEIM

±7,446 SF Industrial Building on 0.40 Acres with Secure Fenced Yard

Zach Niles
Senior Managing Director

O +1 949 885 2922
zach.niles@jll.com
CA Lic. # 01311756

Brendan Brady
Senior Associate

O +1 949 930 7975
brendan.brady@jll.com
CA Lic. # 02147986

Steve Wagner
Senior Managing Director

O +1 949 885 2923
steve.wagner@jll.com
CA Lic. # 01314652



Jones Lang LaSalle Brokerage, Inc. RE lic. #01856260

Offering Plan & Specifications



***Image is artists rendering of conceptual renovation for marketing purposes only. Property to be sold as-is.**

PROPERTY SPECIFICATIONS

Address	1342 N. Knollwood Circle
City, State	Anaheim, California
APN	070-801-22
Building Area	±7,446 sf total
Office Area	±2,000 sf
Land Area	±0.40 acres
Bonus Mezz	Yes
Whse Clear	16' minimum clearance
GL Doors	2 ground level loading doors
Power Supply	400 Amps, 3-Phase, 120/208 Volt
Parking	2.1/1000 (16 stalls)
Yard	Fenced & secured yard
Zoning	I – Industrial
Type / Year	CTU / 1978
Freeway	Immediate 5 / 91 freeway access

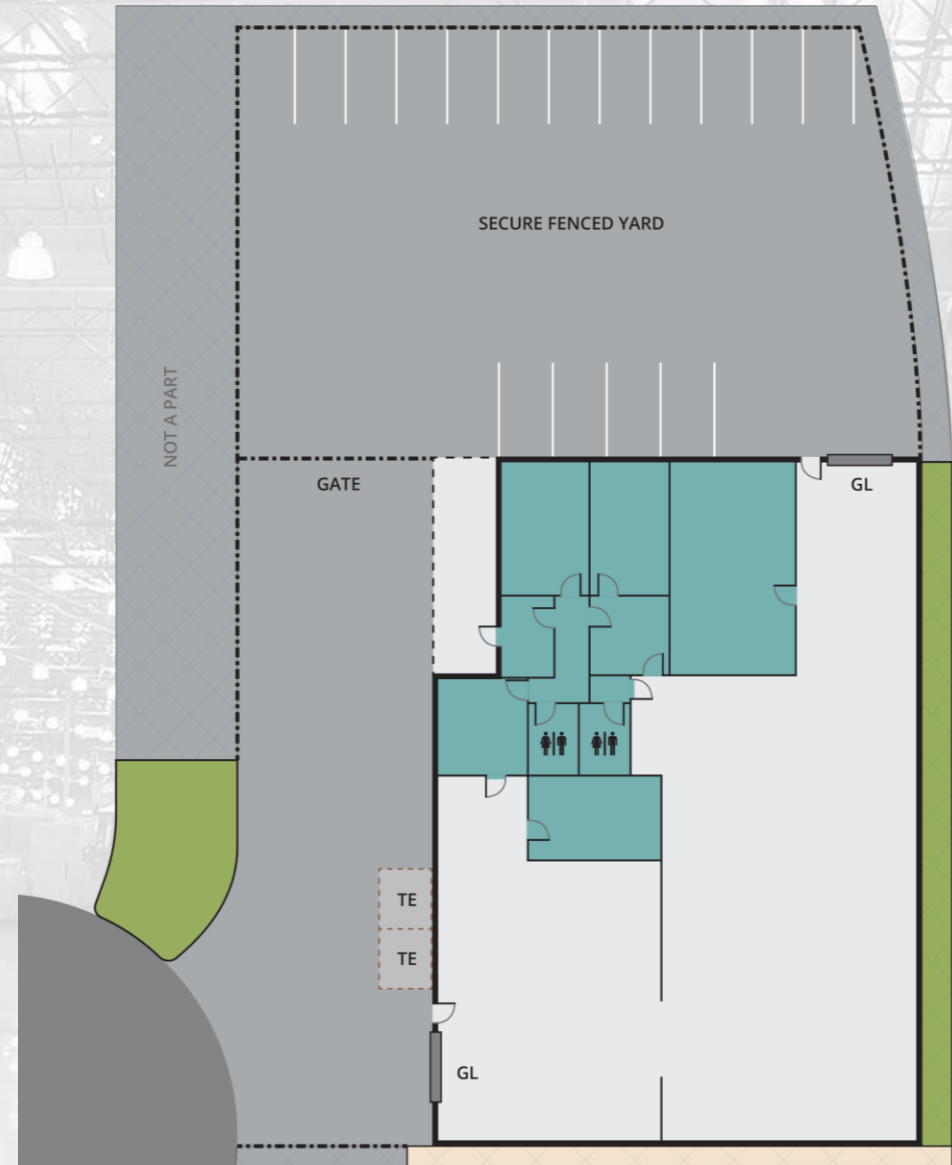

* All building, site and parking areas are approximate and to be verified.

* For illustration purposes only. All information to be independently verified.

Access

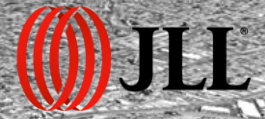

Site

I-5 & R-91
On/Off Ramp
0.5 Miles

I-5 via La Palma Ave.
On/Off Ramp
1.2 Miles



La Palma Ave.
Magnolia Ave.

 Center of Gravity (COG) access to SoCal's 23+ million residents

Location



 Center of Gravity for
SoCal's 23+ million residents

0.5 MI

0.5 MI

6.5 MI

POLA / POLB

21.1 MI

John Wayne

16.8 MI

Long Beach

11.8 MI

LAX

30.6 MI

Ontario

34.5 MI

Total SoCal
23+M
Population

Contacts

ASSET ADVISORS

Zach Niles

Senior Managing Director

O +1 949 885 2922

zach.niles@jll.com

CA Lic. # 01311756

Brendan Brady

Senior Associate

O +1 949 930 7975

brendan.brady@jll.com

CA Lic. # 02147986

Steve Wagner

Senior Managing Director

O +1 949 885 2923

steve.wagner@jll.com

CA Lic. # 01314652



17877 Von Karman Avenue, Suite 500 | Irvine, CA 92614

www.us.jll.com

DISCLAIMER

Materials contained in this Offering Memorandum are confidential, furnished solely for the purpose of considering the purchase of 2351 W. Woodland Drive, Anaheim, California (the "Property"), described herein; and are not to be used for any other purpose or to be made available to any other person without the express written consent of Jones Lang LaSalle ("JLL"). The material is based, in part, upon information supplied by Owner and, in part, upon information obtained by JLL from sources they deem to be reliable. Summaries contained herein of any legal documents are not intended to be comprehensive statements of the terms of such documents, but rather are outlines of some of the principal provisions contained therein. No warranty or representation, expressed or implied, is made by Owner, JLL or any of their related entities as to the accuracy or completeness of the information contained herein. Prospective buyers and/or investors should make their own investigations, projections and conclusions. Interested parties should be aware that the Owner is offering the Property in "AS IS" CONDITION WITH ALL FAULTS, WITHOUT REPRESENTATIONS OR WARRANTIES OF ANY KIND OR NATURE. It is expected that interested parties will conduct their own independent due diligence concerning the Property, including, without limitation, such engineering and environmental inspections as they deem necessary to determine the condition of the Property and the existence or absence of any potentially hazardous materials used in the construction or maintenance of the Property. No representations, expressed or implied, are made as to the foregoing matters by Owner, JLL or any of their officers, trustees, employees, affiliates and/or agent. Information contained in this Offering Memorandum may further be governed by a Confidentiality Agreement.