



171 East Liberty Street

Retail for Lease



Area Overview

Set in the heart of one of Toronto's most dense residential nodes, the Liberty Market Building offers retailers the opportunity to capitalize on a steady stream of local and visiting clientele. Liberty Village provides an unparalleled opportunity to the neighbourhood's demographic of young professionals and the close proximity to Toronto's downtown core.

Within over 100,000 SF of ground floor retail, the property acts as Liberty Village's landmark for live, work and play. This brick and beam-style asset features strong daytime and evening traffic with 300,000 SF of office onsite, and over 10,000 residential units in the immediate area.



Demographics

	Total Population	41,951
	Daytime Population	17,451
	Growth Rate over next 5 Years	2.2%
	Avg. Household Income	\$127,086
	Median Age	38.5

Walk score
97

Transit score
100



Source: Environics, 2026

Property Details

Unit 123: 1,210 SF

Unit 137: 1,870 SF

Available: Immediately

Term: 5 - 10 Years

Net Rent: Negotiable

Additional Rent: \$21.36 PSF (est. 2026)



Property Highlights

- Renovated mixed-use development in the heart of Liberty Village
- Total complex comprised of over 400,000 SF of office and retail space
- Ceiling heights of ~15 FT
- Tenants include LOCAL Public Eatery, BMO, OEB Breakfast Co, Aloette, Liberty Soho and Bulk Barn
- Excellent TTC and GO Station access
- Public parking on site
- Green 'P' surface parking immediately west of the property
- Close proximity to BMO Field and RBC Ampitheatre



Site Map

UNIT 100	LOCAL Public Eatery	UNIT127B	Pizzaville
UNIT 101	STRONG Pilates	UNIT 130	COTY
UNIT 102	Village Family Health	UNIT 131	Island Caribbean
UNIT 104	Dollarama	UNIT 133	Body In Tune
UNIT 106	Dollarama	UNIT 135	Carnabys Jewellers
UNIT 107	Merci Mon Ami	UNIT 136	See & Be Seen Eyecare
UNIT 108	Bank of Montreal	UNIT 137	Available
UNIT 109	Tim Hortons	UNIT 137B	Luxe Destination Weddings
UNIT 110	Bulk Barn	UNIT 138	Portrait Dental
UNIT 111	LEASED	UNIT 139	Luxe Travel Company
UNIT 113	Home Hardware	UNIT 140	LEASED
UNIT 115	Telus	UNIT 141	Cures Studio
UNIT 116	Salon Tocci	UNIT 142	Luxe Tanning and Swimwear
UNIT 117	LEASED	UNIT 143	Chatime
UNIT 118	180 Smoke	UNIT 144	Chiang Mai
UNIT 120	Animal Hospital	UNIT 145	Canvas Cannabis
UNIT 121	Wok Boyz	UNIT 146	KIBO Sushi House
UNIT 122	Heartless Ink	UNIT 147	COBS Bread
UNIT 123	Available	UNIT 149	RISE Cycle
UNIT 124	F45 Liberty Village	UNIT BH1	Brazen Head Irish Pub
UNIT 125	3 Apples High	UNIT BH2	Osmows & Wings Up!
UNIT 126	Oxygen Yoga		
UNIT 127A	Aloette		

Area Map

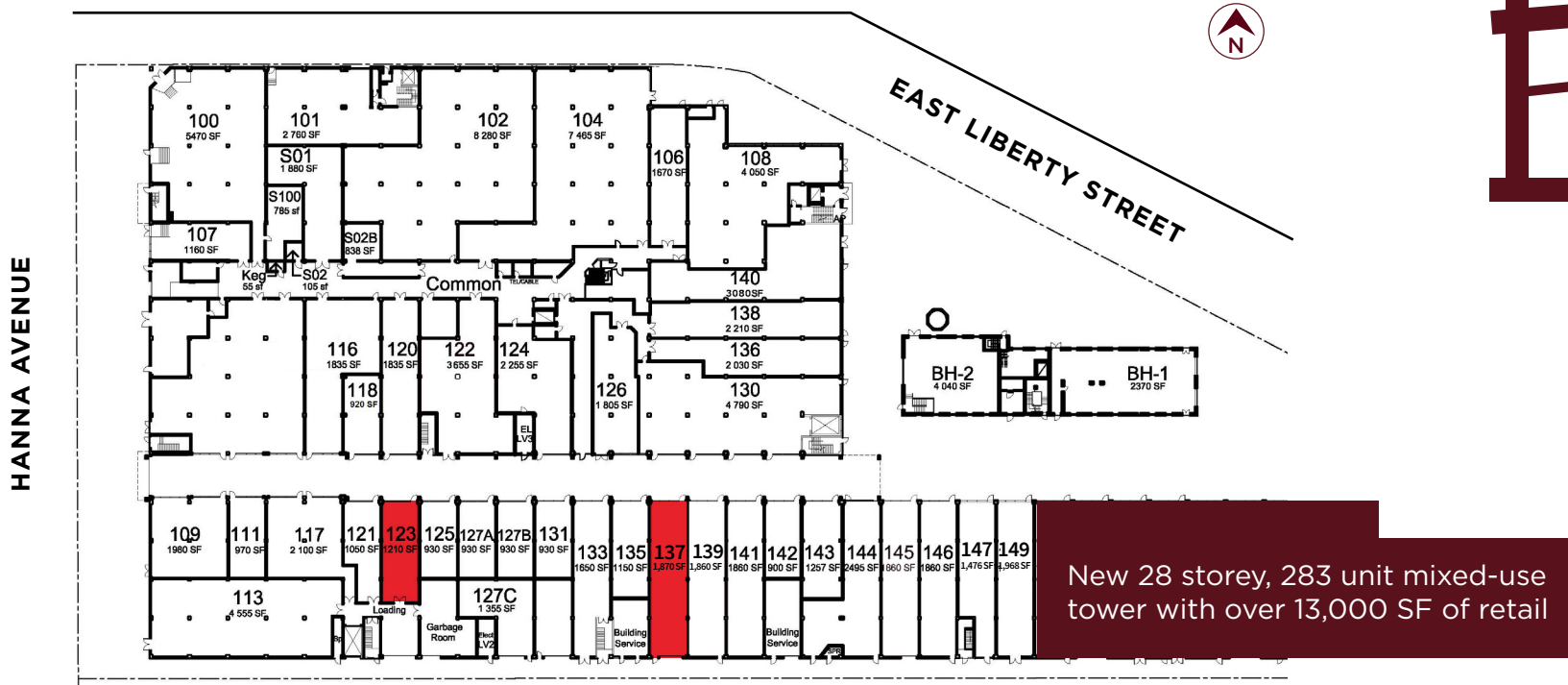
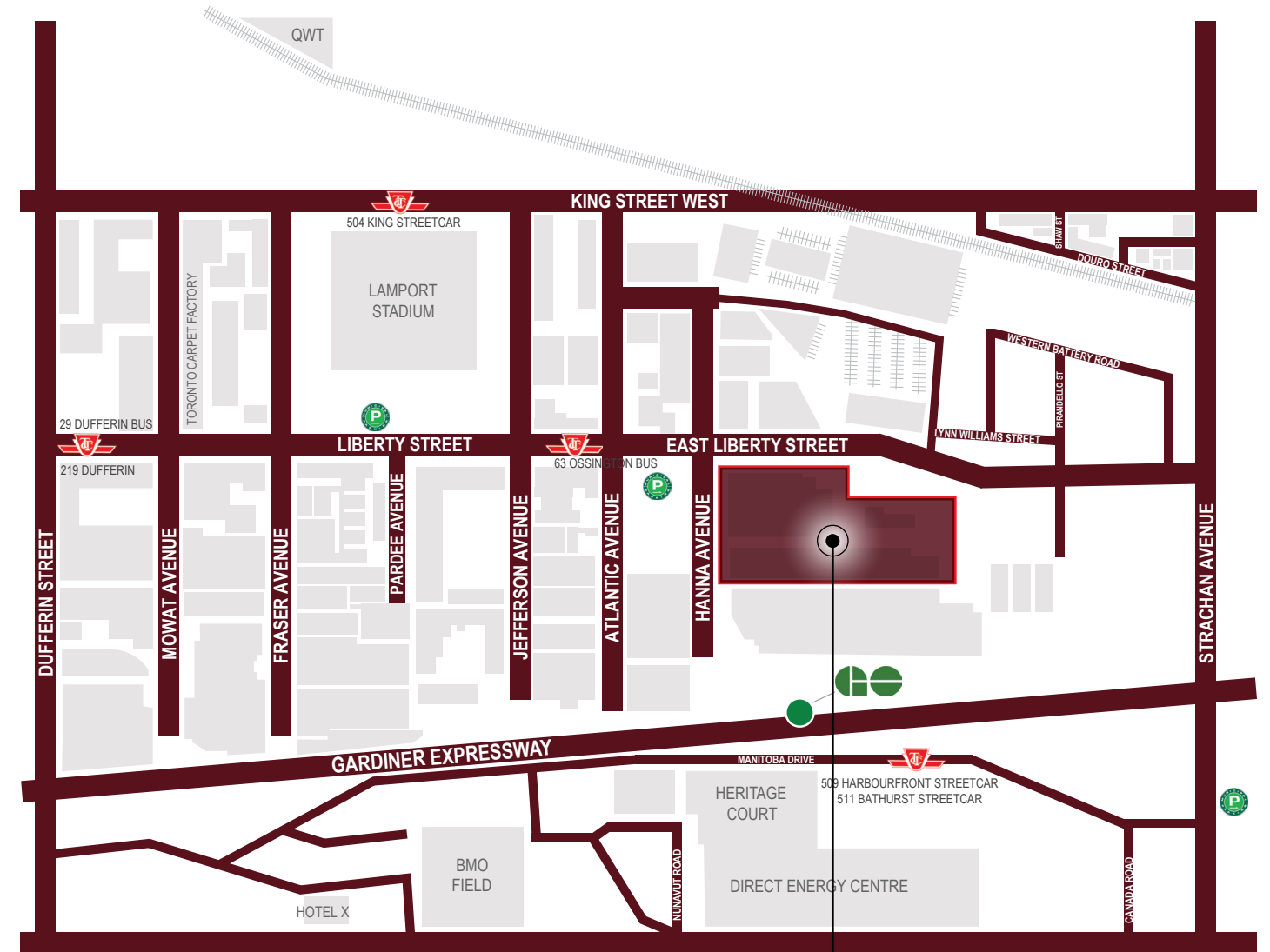

Liberty Village

LIBERTY VILLAGE



Liberty Village is located between Strachan Avenue and Dufferin Street lining the Gardiner Expressway and King Street West. The neighbourhood is one of Toronto's fastest growing communities

and has turned into a thriving mixed-use community that caters to the increasing number of residents in the area. With over two and a half million square feet of office space, the node has become a destination point for a variety of industries.

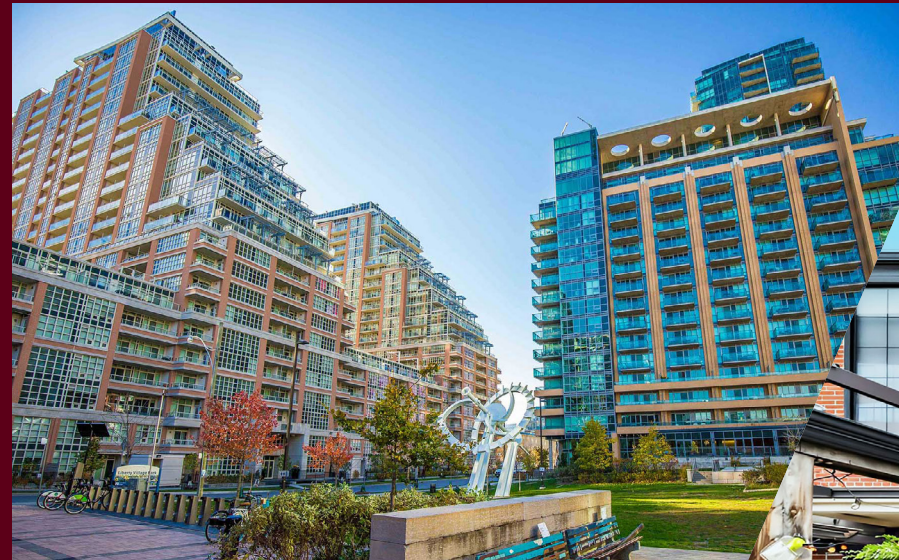

History

The neighbourhood's history mainly lies with its strong industrial ties. In 1858, Liberty Village became the site of Toronto's Industrial Exhibition that later moved south and is now known as the Canadian National Exhibition. In the 1880's the province built a prison where the inmates were put to work to generate profits for the government. In the years following, the heavily concentrated industrial area became munitions factories during the world wars to support the country's war efforts abroad.

Transportation

The Liberty Market Building offers public transit from the King Street West streetcar (504), Ossington bus line (63, 63A and 316), and the Exhibition Place GO Station for commuters. The Dufferin Street bus line (29, 29A, 29D and 329) is also easily accessible to those who work in Liberty Village.

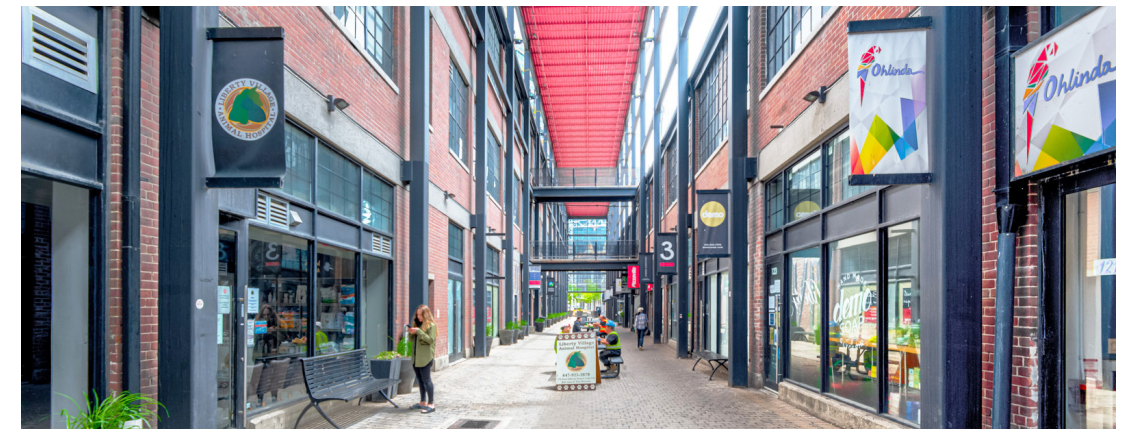



171 East Liberty Street

Retail for Lease

Although information has been obtained from sources deemed reliable, neither Owner nor JLL makes any guarantees, warranties or representations, express or implied, as to the completeness or accuracy as to the information contained herein. Any projections, opinions, assumptions or estimates used are for example only. There may be differences between projected and actual results, and those differences may be material. The Property may be withdrawn without notice. Neither Owner nor JLL accepts any liability for any loss or damage suffered by any party resulting from reliance on this information. If the recipient of this information has signed a confidentiality agreement regarding this matter, this information is subject to the terms of that agreement. ©2026 Jones Lang LaSalle IP, Inc. All rights reserved. **Broker. *Sales Representative.

BRANDON GORMAN**
Executive Vice President
+1 416 855 0907
Brandon.Gorman@jll.com

GRAHAM SMITH*
Executive Vice President
+1 416 855 0914
Graham.Smith@jll.com

AUSTIN JONES**
Associate Vice President
+1 416 304 6050
Austin.Jones@jll.com

MATTHEW MARSHALL*
Associate Vice President
+1 416 238 9925
Matthew.Marshall@jll.com