



The Shoppes at Renaissance

141 Route 70
Marlton, NJ 08053



15,750 SF available for lease

Property Highlights

- The Shoppes at Renaissance is a Class A 83,000 SF unique office space within a complex consisting of multiple retail spaces and 330 apartment units
- Easy access to heavily traveled Route 70 in Marlton, NJ
- Direct access into available spaces
- On-site parking with 300+ available spaces
- Building signage available

Availabilities

15,700 SF available for lease

Suite 300 - 3,500 SF

Suite 301 - 12,200 SF

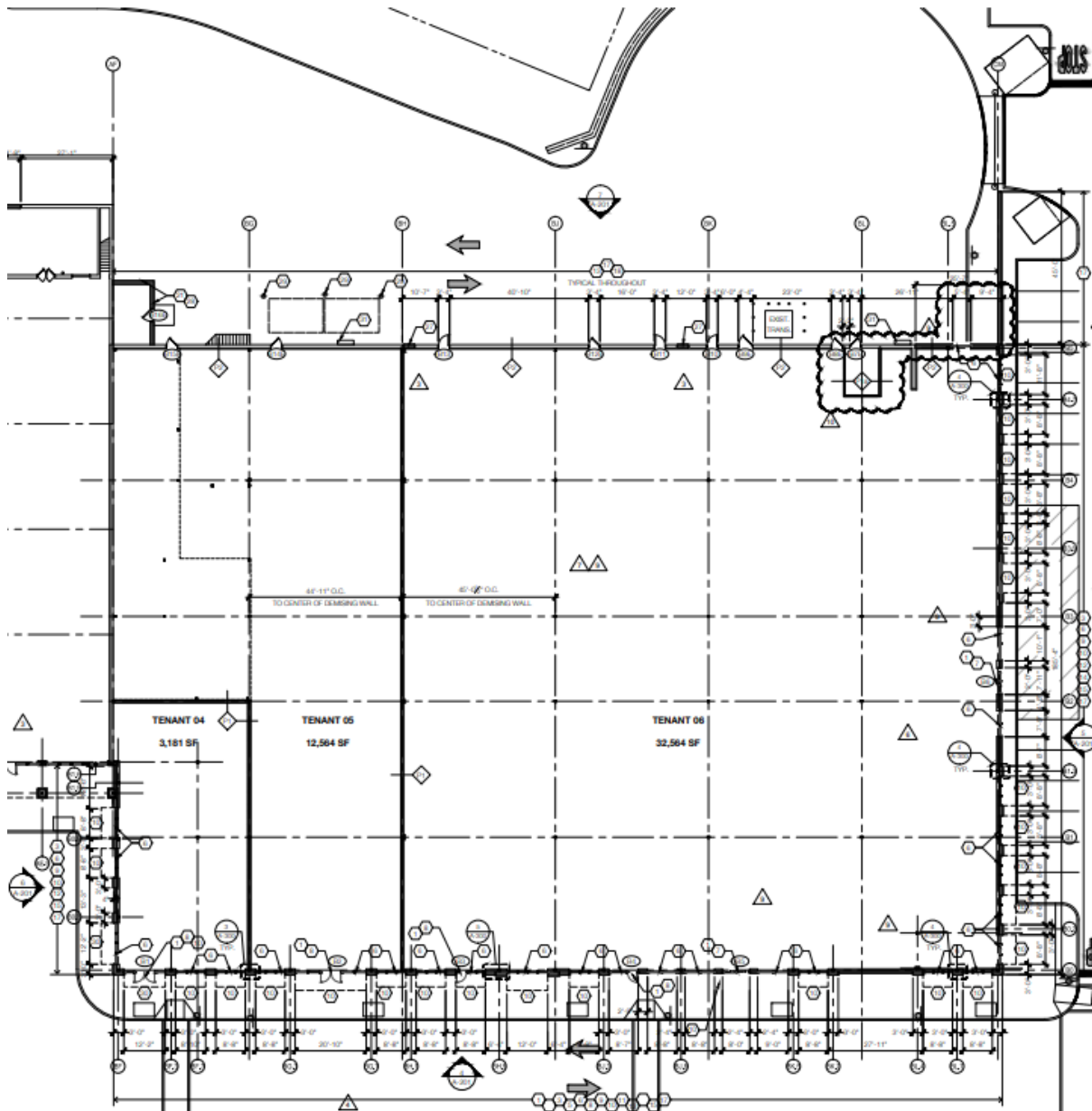

Location Overview

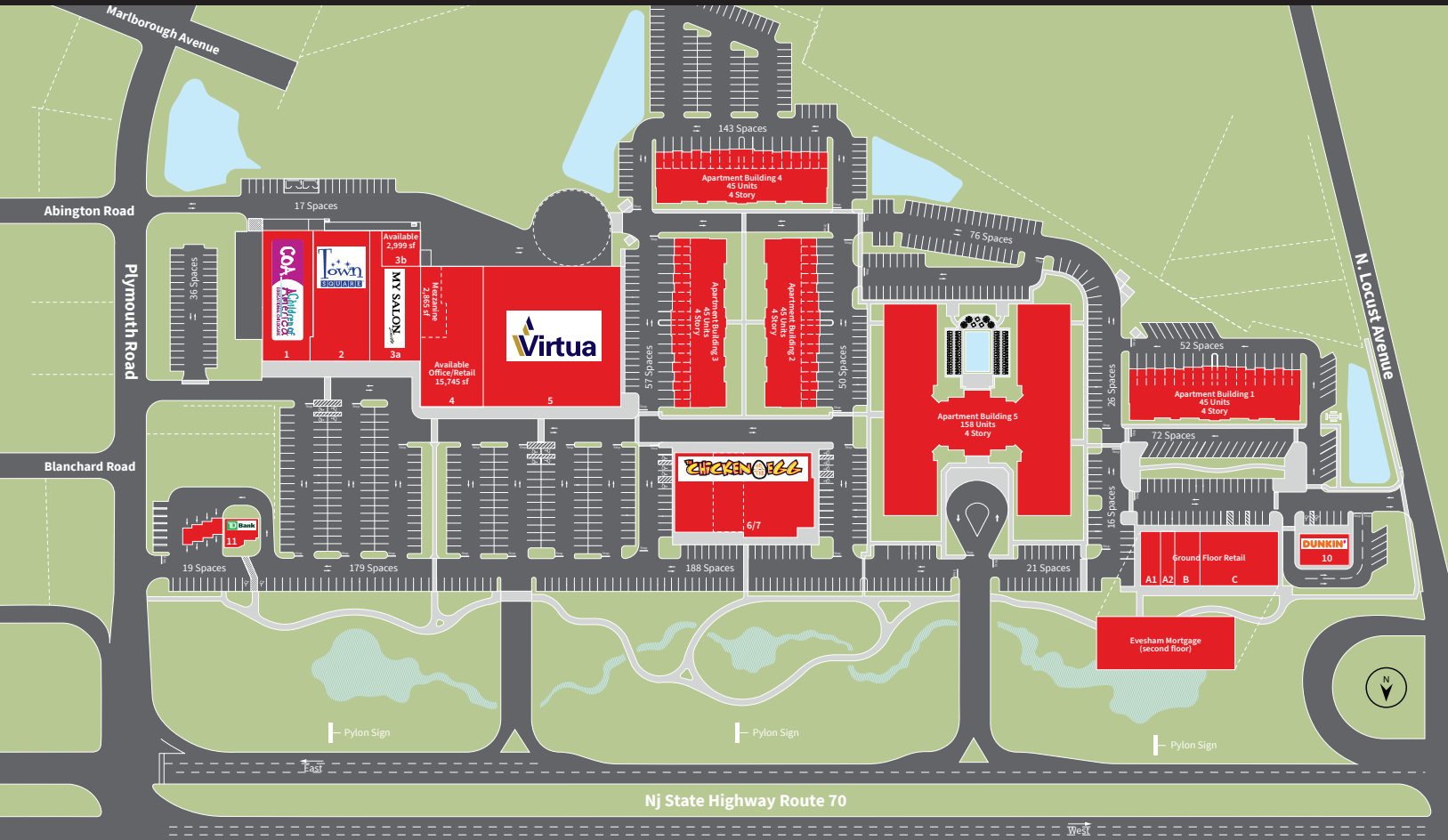

Tenant Key

1.	Children of America	10,000 sf
2.	Senior Helpers Town Square	13,189 sf
3a.	My Salon Suite	7,307 sf
3b.	Available (58.22' x 51.51')	2,999 sf
4.	Available Office/Retail Mezzanine (83.8' x 185' irr.)	15,745 sf
5.	Virtua Medical Group	2,865 sf
6/7.	The Chicken Or The Egg Restaurant & Beer Garden	
	• Main Building	32,568 sf
	• Partially Enclosed Terrace	9,449 sf
	• Uncovered Garden area	3,014 sf
8.	Ground Floor Strip	5,058 sf
	A1. Gaetano's Cheese Steak and Pizza	2,070 sf
	A2. Canvas Salon	1,050 sf
	B. Pink Petal Mani	1,984 sf
	C. Keller Williams Real Estate	6,387 sf
9.	Evesham Mortgage	12,753 sf
10.	Dunkin Donuts	2,600 sf

Residential Key

Apartment Building 1	45 Units
Apartment Building 2	45 Units
Apartment Building 3	45 Units
Apartment Building 4	45 Units
Apartment Building 5	158 Units
Total Apartments	338 Units



The Shoppes at Renaissance

State Highway 70 and N. Locust Ave
Marlton, NJ 08053



For leasing information, contact

Chris Henderson
+1 856 905 9245
Chris.henderson@jll.com

Keith McClure
+1 856 324 5307
Keith.mcclure@jll.com

Jones Lang LaSalle Brokerage, Inc.
220 Lake Drive East, Suite 102
Cherry hill, NJ 08002
+1 610 249 2255

