

PROPERTY OVERVIEW

Building 500 - ± 29,000 SF Available

Space Park S Drive
Nashville, TN 37211



Building Specs

Address	501 Space Park S Drive
City, State	Nashville, TN
Year Built	1978
Building Size	±139,000

Suite Specs

Suite Number	520
Available SF	29,000
Office SF	±1,000
Clear Height	19' - 28'
Column Spacing	25' x 40'
Sprinkler	Wet
Loading Docks	8
Drive-In Doors	0
Lighting	LED

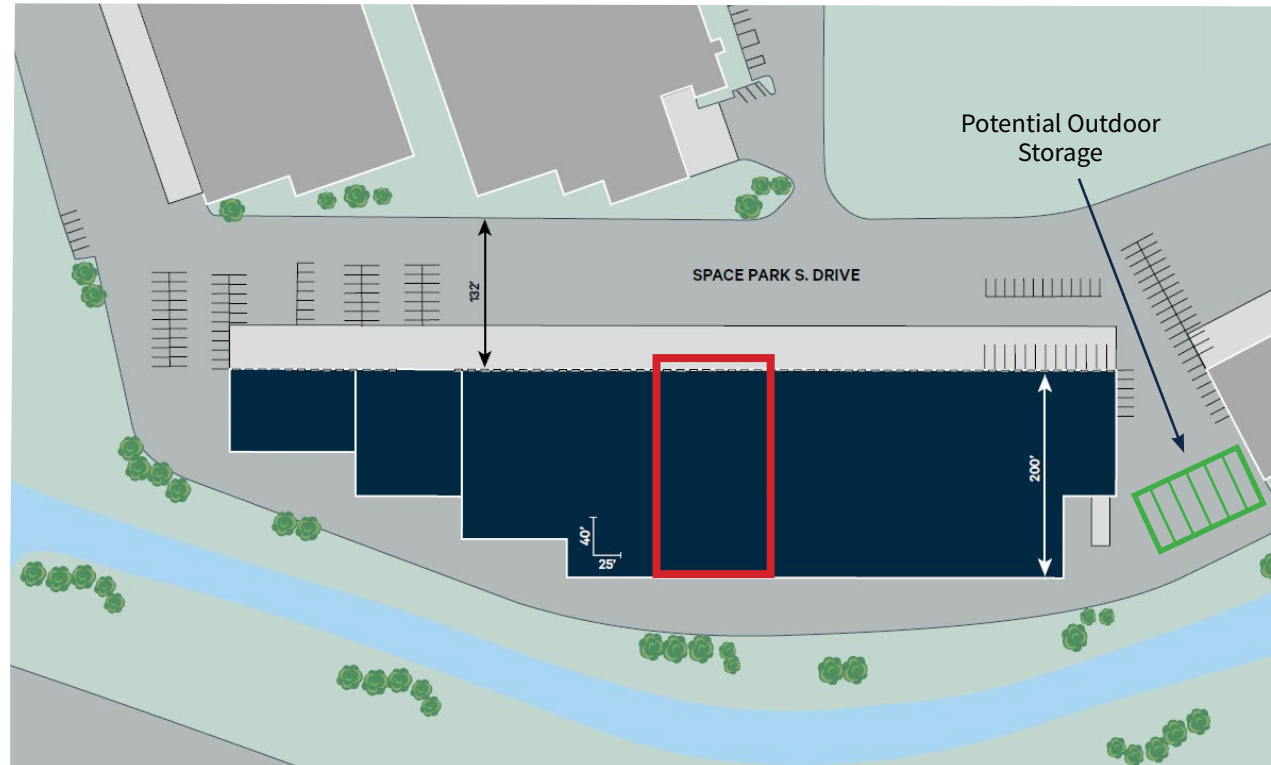

For property leasing information, please contact:

Ben
Mosley, MRICS

+1 615 364 7015
ben.mosley@jll.com

Chris
Gaw

+1 615 218 0009
christopher.gaw@jll.com

Kelsey
Johnson

+1 509 688 5559
kelsey.johnson@jll.com

Carly
Seaman

+1 352 812 1416
carly.seaman@jll.com

FLOOR PLAN

SUITE 520 - ±29,000 SF

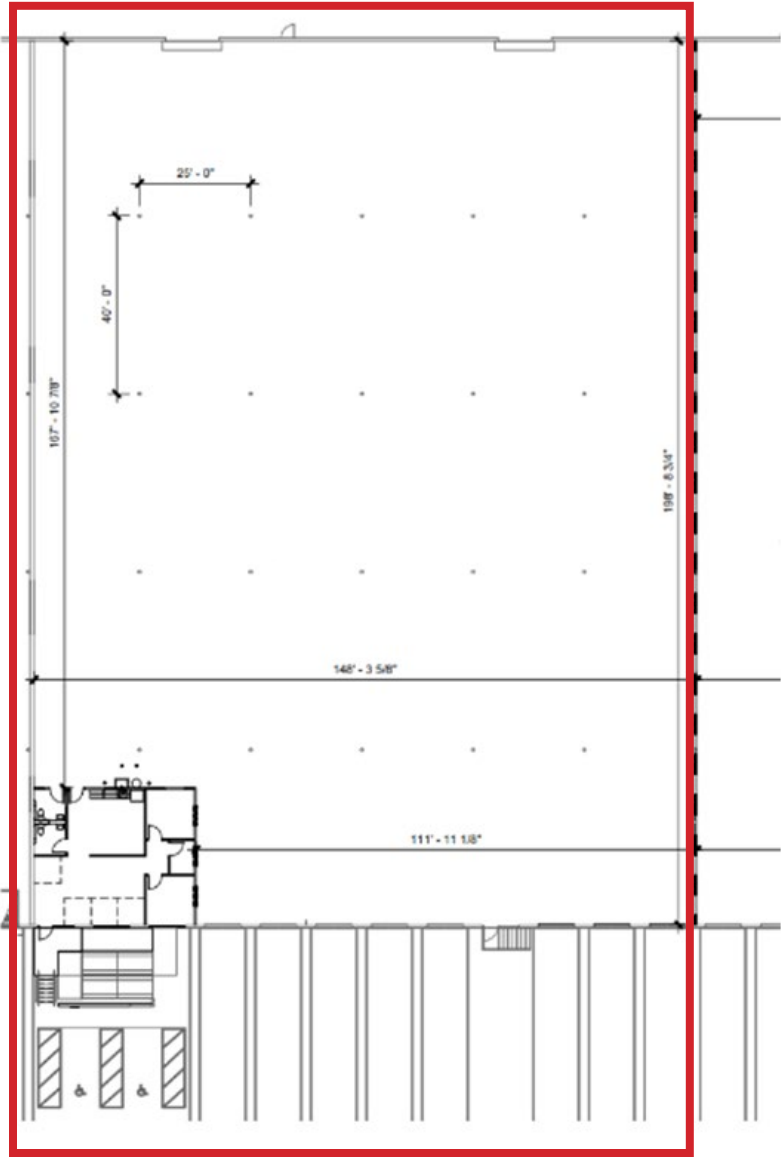

Although information has been obtained from sources deemed reliable, neither Owner nor JLL makes any guarantees, warranties or representations, express or implied, as to the completeness or accuracy as to the information contained herein. Any projections, opinions, assumptions or estimates used are for example only. There may be differences between projected and actual results, and those differences may be material. The Property may be withdrawn without notice. Neither Owner nor JLL accepts any liability for any loss or damage suffered by any party resulting from reliance on this information. If the recipient of this information has signed a confidentiality agreement regarding this matter, this information is subject to the terms of that agreement. ©2024 Jones Lang LaSalle IP, Inc. All rights reserved.