

# Turning Basin Industrial Park

2015 Turning Basin, Houston, TX 77029



Turning Basin Industrial Park | 2015 Turning Basin, Houston, TX 77029

TURNING BASIN INDUSTRIAL PARK



## Highlights

- ±143,029 SF Available (will subdivide)
- ±3,739 SF Office
- Fifty-one (51) 10' x 10 Dock-High Doors
- Two (2) 9' x 20' OH Door
- Column Spacing 45'x44'
- 24' Clear Height
- Wet-pipe Sprinkler
- Rail Service Possible via PTR
- Outside storage available – up to 1.45 acres



# Turning Basin Industrial Park

2015 Turning Basin, Houston, TX 77029

Turning Basin Industrial Park | 2015 Turning Basin, Houston, TX 77029

WEST LOOP BUSINESS PARK

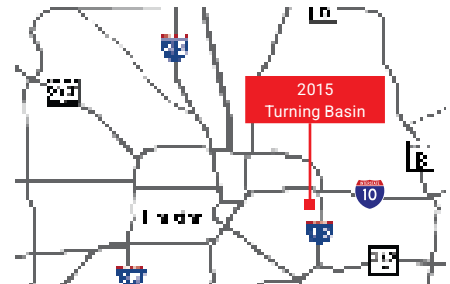
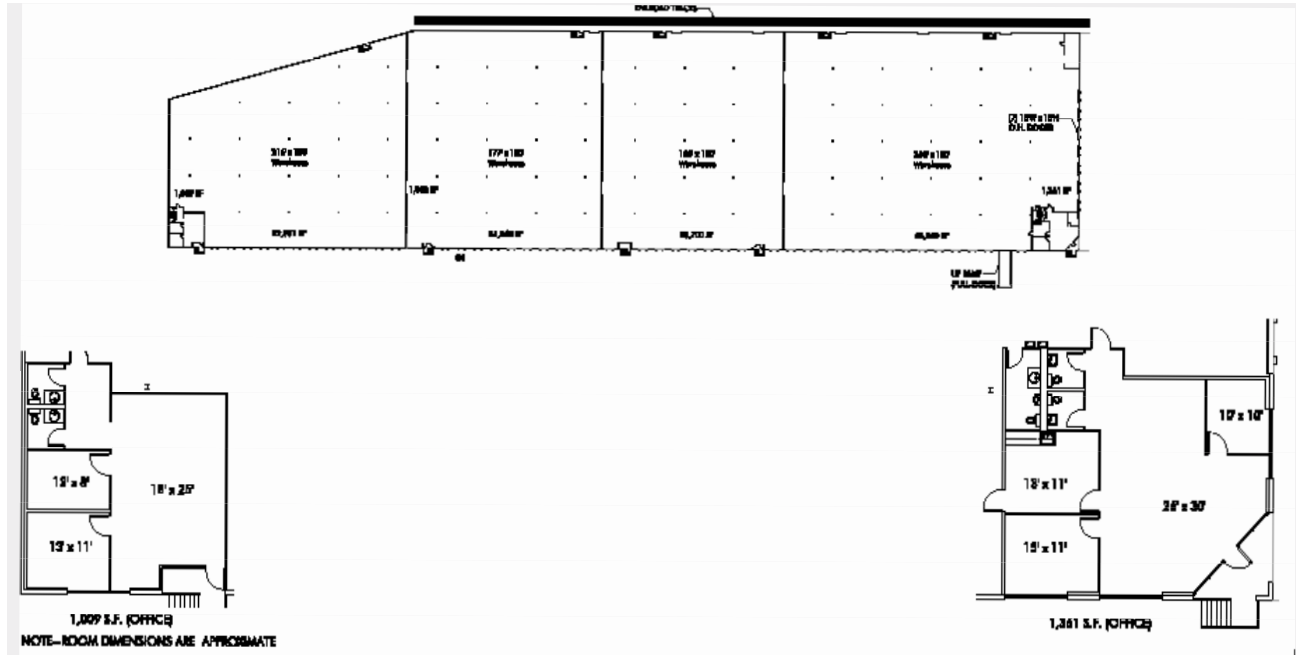

Richard Quarles, SIOR  
713.888.4019  
richard.quarles@jll.com

Joseph Berwick  
713.425.5842  
joseph.berwick@jll.com

Eliza Klein  
713.425.1816  
eliza.klein@jll.com



Danielle Radtke  
630.586.8146  
dradtke@centerpoint.com

[centerpoint.com](http://centerpoint.com)

## Key Distances

- 610** - Immediate access
- I-10** - 3 Minutes
- I-45** - 7 Minutes
- Hwy 90** - 5 Minutes
- Hobby Airport** - 10 Minutes
- IAH** -25 Minutes
- Barbours Cut** - 25 Minutes
- Bayport Terminal** - 35 Minutes