



FOR SUBLEASE

4025 Whipple Road, Bldg. H, Union City, CA 94587

±24,756 SF Available

Term through July 2034

Jones Lang LaSalle Brokerage, Inc. RE lic. #01856260



PROPERTY SPECIFICATIONS

AVAILABLE SF	±24,756 SF
OFFICE SF	±2,560 SF
BUILDING SF	202,451 SF
BUILT YEAR	1996
CLEAR HEIGHT	24'
COLUMN SPACING	62'W X 62'D
DOCK HIGH DOORS	8 (2 oversized)
DRIVE IN DOORS	1 ramped
TRUCK COURT DEPTH	120'
POWER	To Confirm
PARKING RATIO	1.50/1,000
Master Lease Term	Through July 2034

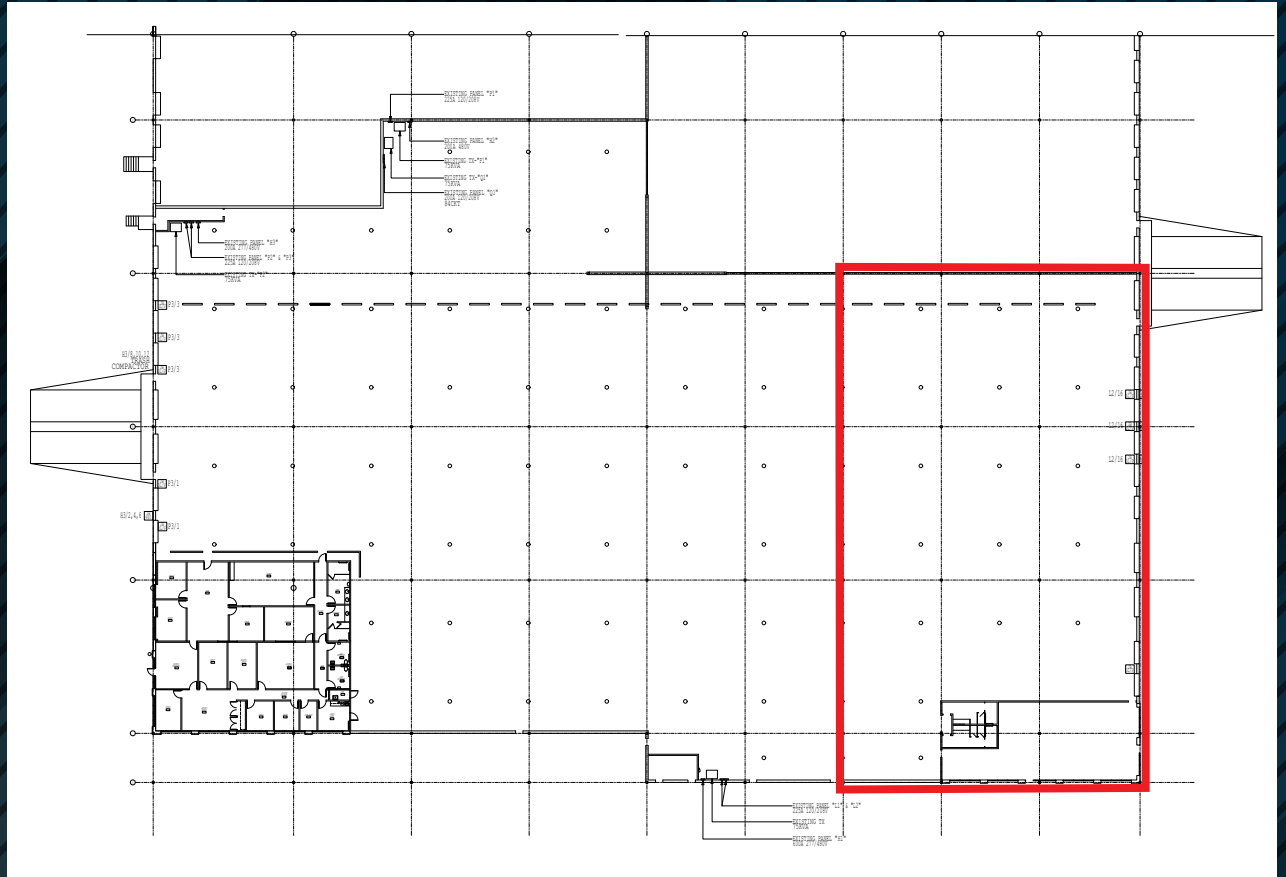

LOCATION OVERVIEW

3 Miles 

131,033

TOTAL POPULATION

\$152,859

HOUSEHOLD INCOME

44,059

TOTAL DAYTIME
EMPLOYMENT

5 Miles 

296,023

TOTAL POPULATION

\$156,366

HOUSEHOLD INCOME

93,136

TOTAL DAYTIME
EMPLOYMENT

10 Miles 

732,414

TOTAL POPULATION

\$157,185

HOUSEHOLD INCOME

241,544

TOTAL DAYTIME
EMPLOYMENT





CONTACT

PATRICK METZGER

CA LIC #01888895

+1 510 285 5362

PATRICKJ.METZGER@JLL.COM

MATT KUJAWA

CA LIC # 02442286

+1 650 868 3206

MATTHEW.KUJAWA@JLL.COM

Although information has been obtained from sources deemed reliable, neither Owner nor JLL makes any guarantees, warranties or representations, express or implied, as to the completeness or accuracy as to the information contained herein. Any projections, opinions, assumptions or estimates used are for example only. There may be differences between projected and actual results, and those differences may be material. The Property may be withdrawn without notice. Neither Owner nor JLL accepts any liability for any loss or damage suffered by any party resulting from reliance on this information. If the recipient of this information has signed a confidentiality agreement regarding this matter, this information is subject to the terms of that agreement.

©2026 Jones Lang LaSalle Brokerage, Inc. RE Lic. #01856260. All rights reserved.