 **JLL** SEE A BRIGHTER WAY

For lease, BTS, or Sale

*High Profile Opportunity on
Kimberly Road*

.77-1.55ac

520 W Kimberly Road
Davenport, Iowa 52806

Property Overview

- Lease Rate/Sale Price: Please Inquire
- Current Building Available For Lease
- Size: 17,539 SF
- Former Auto Dealership
- Adjacent to both NorthPark Mall and Village Shopping Center, with combined 5.4m Annual Visits.
- Adjacent to National, Regional, and Local Retailers and Restaurants

Nick Anderson

Associate

nicholas.anderson@jll.com

+1 515 729 6015

Meredith Hedstrom

Vice President

meredith.hedstrom@jll.com

+1 515 419 2963

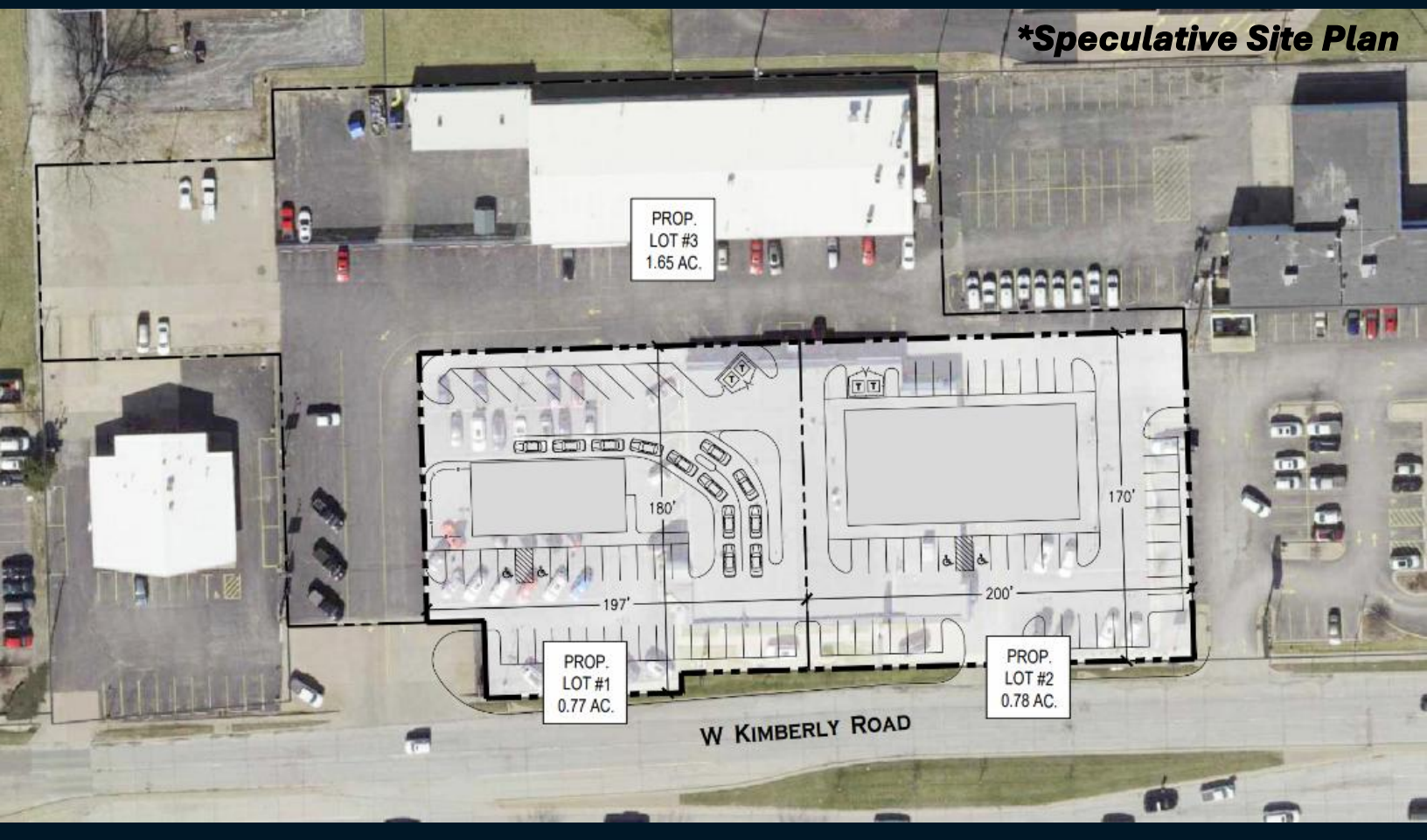
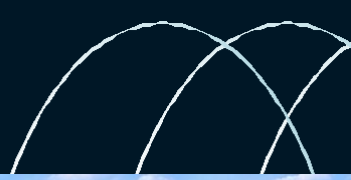

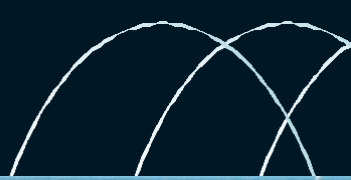

520 W Kimberly Road
Davenport, Iowa 52806



Demographics

	1 mi	3 mi	5 mi
Population	8,983	83,682	148,514
Households	4,156	35,768	62,885
Median HH income	\$71,131	\$66,680	\$68,403

Traffic counts

W Kimberly Road 30,400 VPD

Nick Anderson

Associate

nicholas.anderson@jll.com

+1 515 729 6015

Meredith Hedstrom

Vice President

meredith.hedstrom@jll.com

+1 515 419 2963