

# For lease

9200 E 146th Street  
Noblesville, IN 46060



## Location

The property is located in Hamilton County, about 20 miles northeast of Indianapolis. The site sits along 146th Street with good access to I-69 and SR37. The location offers proximity to Indianapolis International Airport and access to the broader Indianapolis metro industrial market, which serves manufacturing, distribution, and logistics operations



# Space highlights

<b>Available s.f.</b>	115,315 s.f. (divisible)	<b>Dock doors</b>	25
<b>Clear height</b>	18'	<b>Drive-in doors</b>	6
<b>Building depth</b>	238'	<b>Auto parking</b>	±120
<b>Office s.f. total</b>	8,656 s.f.	<b>Zoned</b>	Light Industrial
<b>Power</b>	1600 Amp   208 V		

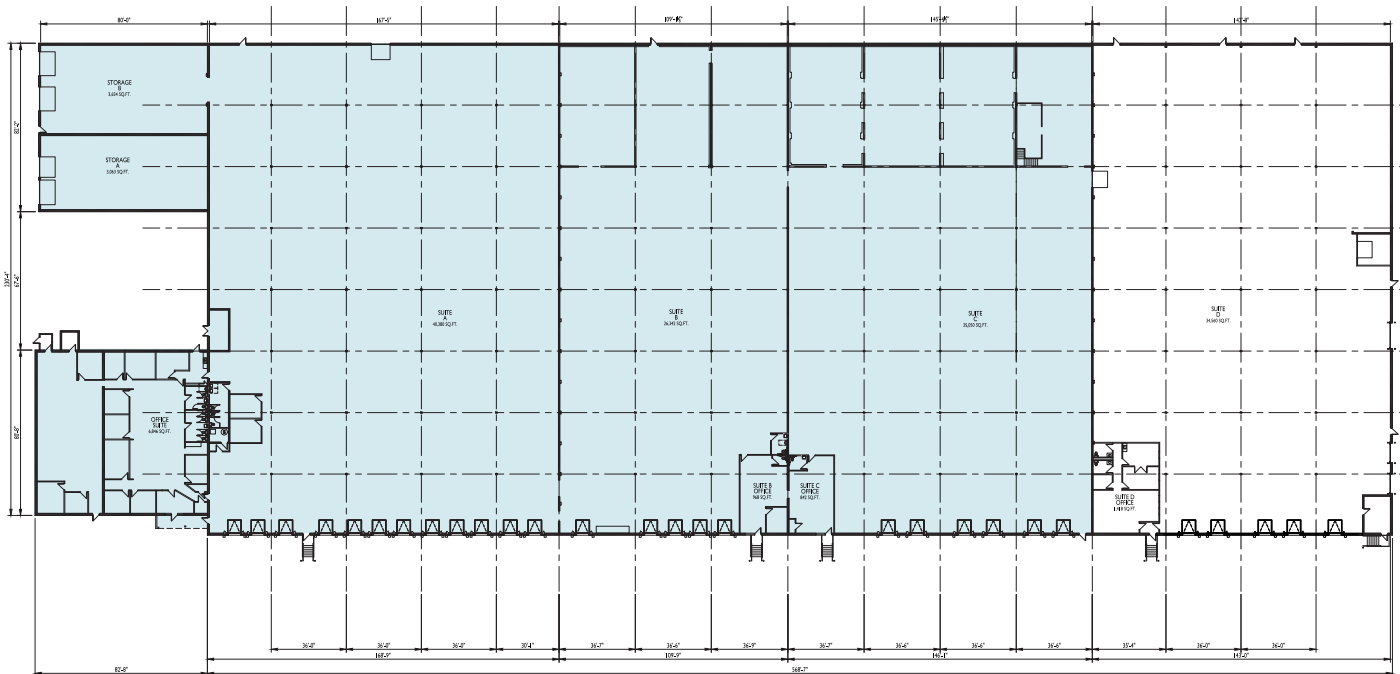

## Suite A

**53,923 s.f. total**  
 6,846 s.f. office  
 12 dock doors  
 4 drive-in doors

## Suite B

**26,342 s.f. total**  
 968 s.f. office  
 5 dock doors  
 1 drive-in door

## Suite C

**35,050 s.f. total**  
 842 s.f. office  
 6 dock doors  
 1 drive-in door

**Brian Buschuk**  
 Executive Managing Director  
 + 1 317 810 7180  
 brian.buschuk@jll.com

**Brian Seitz, SIOR**  
 Executive Managing Director  
 + 1 317 810 7184  
 brian.seitz@jll.com

**Griffin Seitz**  
 Associate  
 + 1 317 810 7175  
 griffin.seitz@jll.com

[jll.com](http://jll.com)

Although information has been obtained from sources deemed reliable, JLL does not make any guarantees, warranties or representations, express or implied, as to the completeness or accuracy as to the information contained herein. Any projections, opinions, assumptions or estimates used are for example only. There may be differences between projected and actual results, and those differences may be material. JLL does not accept any liability for any loss or damage suffered by any party resulting from reliance on this information. If the recipient of this information has signed a confidentiality agreement with JLL regarding this matter, this information is subject to the terms of that agreement. ©2026. Jones Lang LaSalle IP, Inc. All rights reserved.