



# For lease

**Warehouse industrial spaces available now**

- Suite 2434: ±1,371 RSF
- Excellent Otay Mesa location, within close proximity to Otay Mesa Port of Entry/US Customs facility
- Easy access to Siempre Viva Road, SR-905, SR-125 & SR-11 via Enrico Fermi
- ±18' clear height
- Fire sprinklers
- 100 Amps / 3-phase power
- Asking rate: \$1.45/SF G + \$50.00/month water/ sewer

**Otay Marconi Properties**  
**10055 Marconi Drive**  
**Otay Mesa, CA 92154**

---

**Joe Anderson**

+1 858 410 6360

joe.anderson@jll.com

RE License #01509782

**Greg Moore**

+1 858 410 6367

greg.moore@jll.com

RE License #02068852

---



Jones Lang LaSalle Brokerage, Inc.  
RE License #01856260

# 10055 Marconi Drive

Suite 2434 | 1,371 RSF

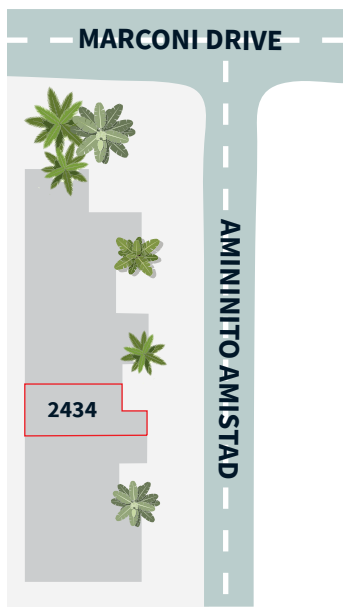
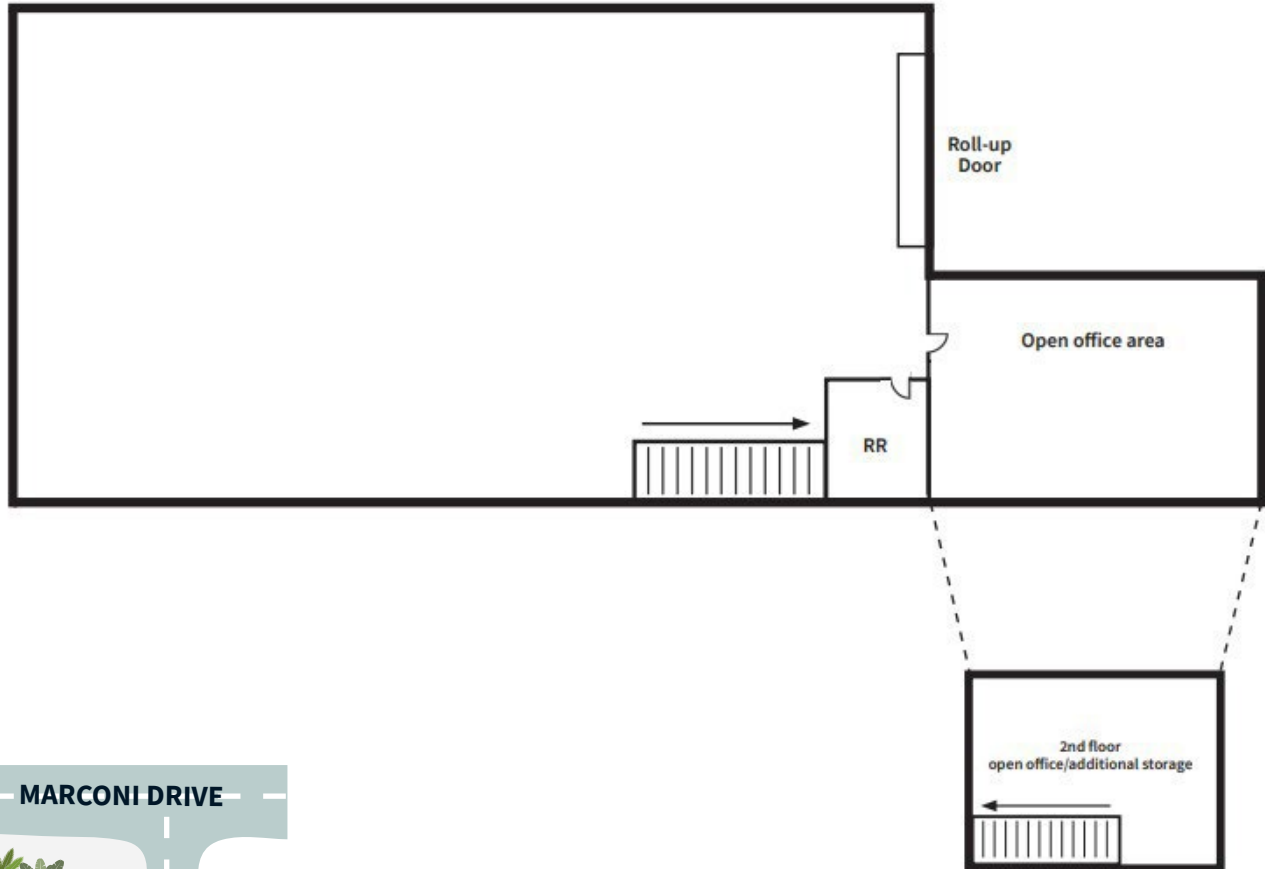

**Joe Anderson**  
+1 858 410 6360  
joe.anderson@jll.com  
RE License #01509782

**Greg Moore**  
+1 858 410 6367  
greg.moore@jll.com  
RE License #02068852

# OTAY MESA EAST



- Outbound
- Inbound
- Int'l Truck Route



**Joe Anderson**  
+1 858 410 6360  
joe.anderson@jll.com  
RE License #01509782

**Greg Moore**  
+1 858 410 6367  
greg.moore@jll.com  
RE License #02068852

Although information has been obtained from sources deemed reliable, neither Owner nor JLL makes any guarantees, warranties or representations, express or implied, as to the completeness or accuracy as to the information contained herein. Any projections, opinions, assumptions or estimates used are for example only. There may be differences between projected and actual results, and those differences may be material. The Property may be withdrawn without notice. Neither Owner nor JLL accepts any liability for any loss or damage suffered by any party resulting from reliance on this information. If the recipient of this information has signed a confidentiality agreement regarding this matter, this information is subject to the terms of that agreement. ©2025. Jones Lang LaSalle IP, Inc. All rights reserved.