

7482 - 7508 E. Main Street

Reynoldsburg, Ohio 43068

**2 suites (1,950 s.f. each) for lease
office / warehouse**

*Multi-tenant industrial building located
on US 40 and two miles from I-270*



Tim Davis
+1 614 460 4416
tim.davis@jll.com

Kourt Williams II
+1 614 460 4423
kourt.williams@jll.com

Josh Weithman
+1 614 460 4410
josh.weithman@jll.com



Property Specifications



	Building One	Building Two
Building size	15,600 SF	15,600 SF
Suite	7486	7508
Available s.f.	1,950 SF	1,950 SF
Clear height	14'	14'
Dock door	1	1
Grade level door	1 (8'x11')	1 (8'x11')
Auto parking	ample	ample
Zoning	Industrial	Industrial

Building One

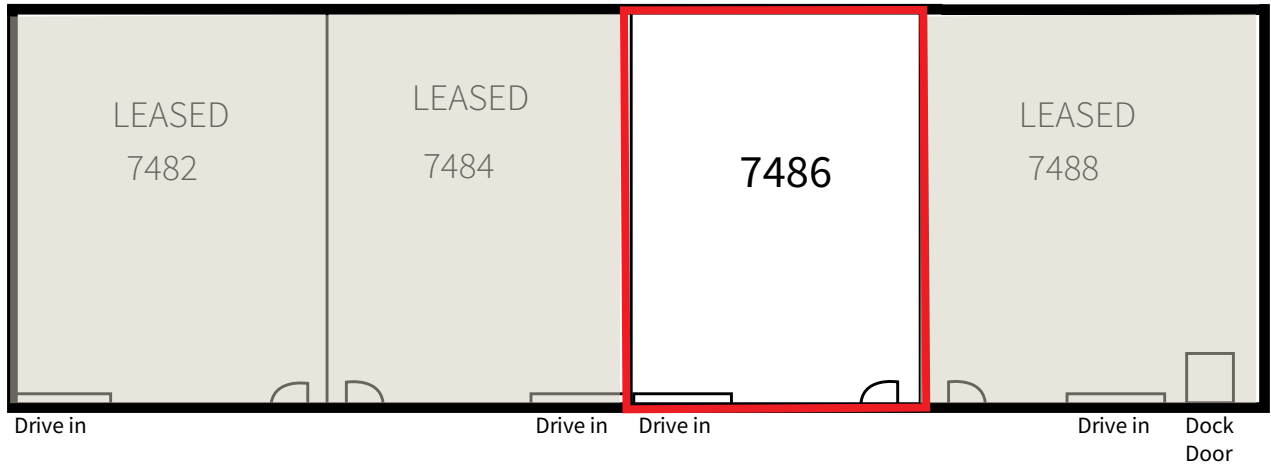

Building Two

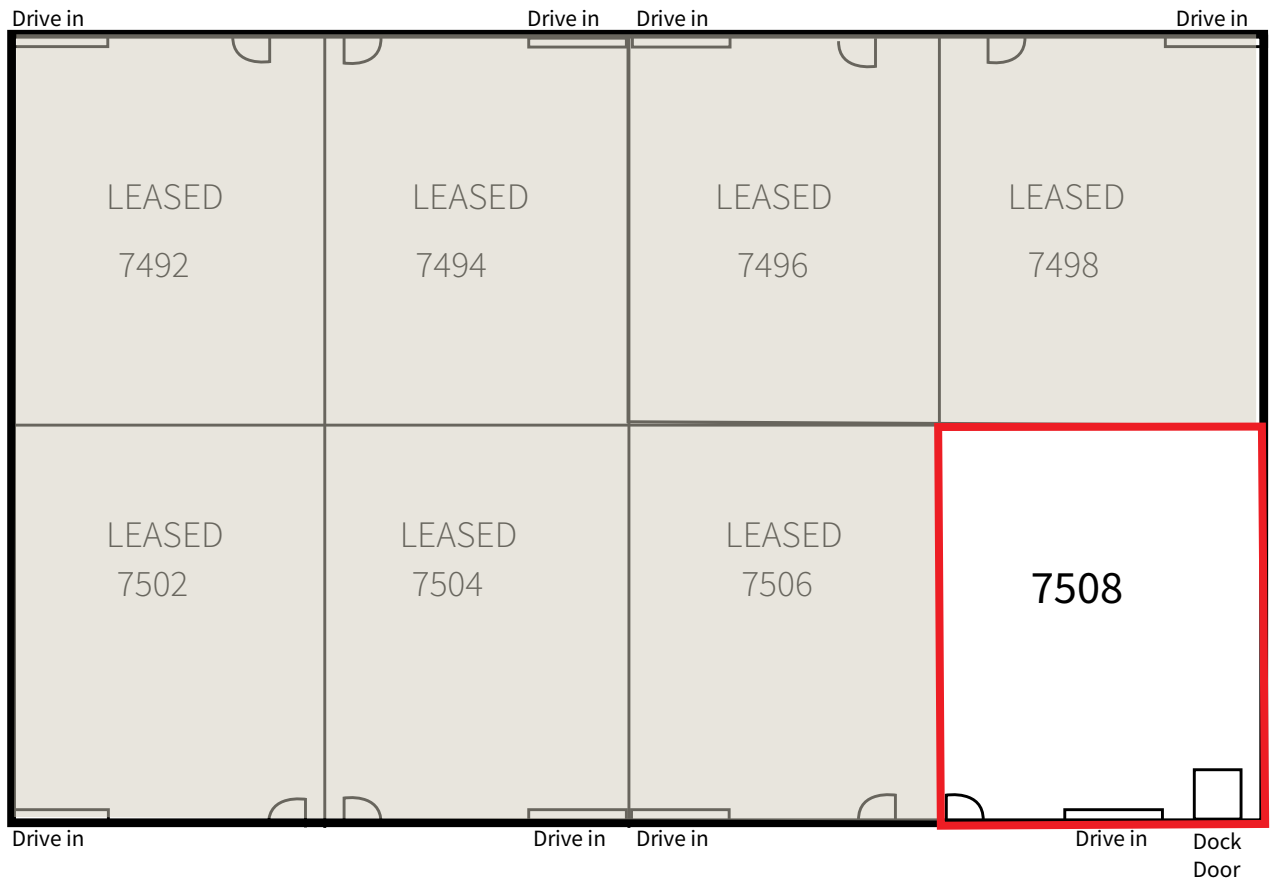

7482 - 7508 E Main Street
Reynoldsburg, OH 43068

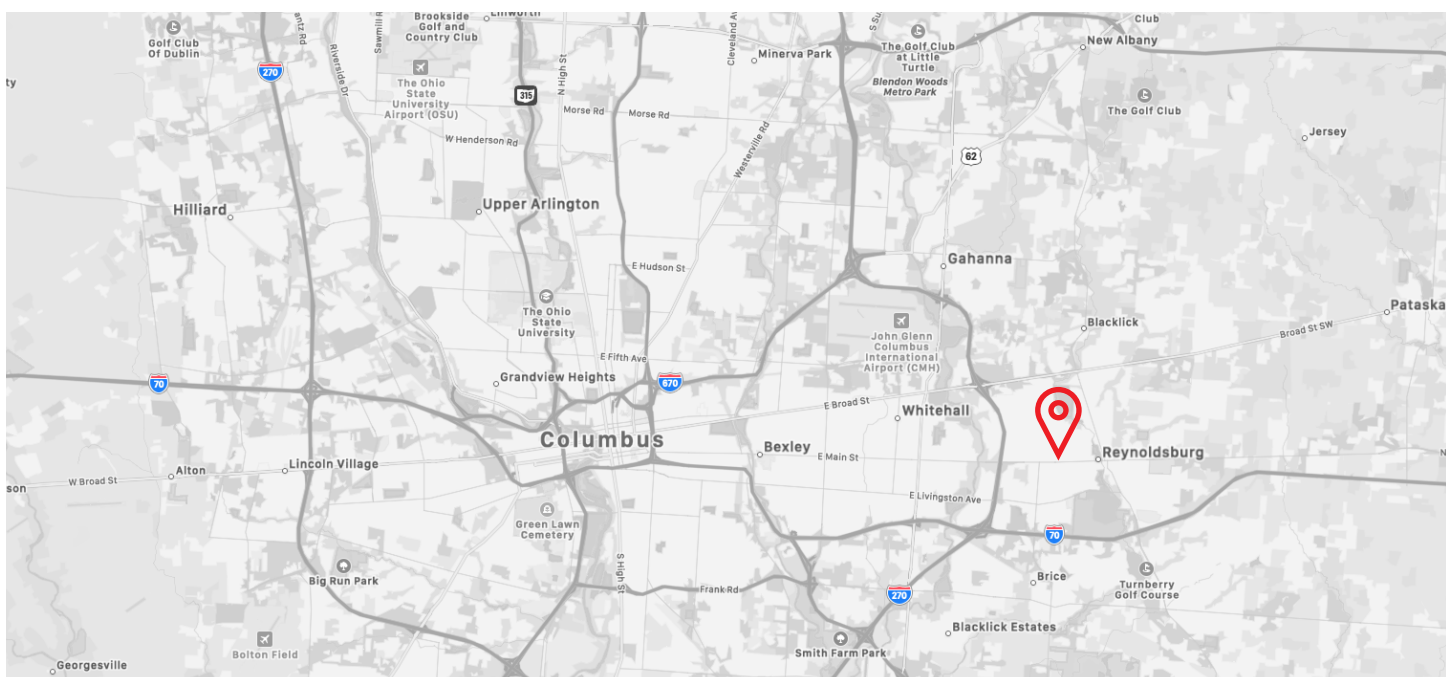

Tim Davis
+1 614 460 4416
tim.davis@jll.com

Kourt Williams II
+1 614 460 4423
kourt.williams@jll.com

Josh Weithman
+1 614 460 4410
josh.weithman@jll.com

Although information has been obtained from sources deemed reliable, JLL does not make any guarantees, warranties or representations, express or implied, as to the completeness or accuracy as to the information contained herein. Any projections, opinions, assumptions or estimates used are for example only. There may be differences between projected and actual results, and those differences may be material. JLL does not accept any liability for any loss or damage suffered by any party resulting from reliance on this information. If the recipient of this information has signed a confidentiality agreement with JLL regarding this matter, this information is subject to the terms of that agreement. ©2022. Jones Lang LaSalle IP, Inc. All rights reserved.

