

7031 Columbia Gateway Drive
Columbia, MD 21046



Jones Lang LaSalle Americas, Inc. License # 01856260



SPACE AVAILABILITY

Floor 2- 52,027 SF

Floor 3- 10,466 SF

Floor 4- 23,021 SF

Floor 5- 50,624 SF

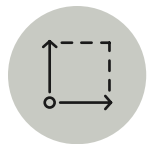

Core factor is 15%



Asking rent
\$24.00/SF FS



Flexible Term



Furniture
available



Parking ratio is 4/1000



Tenant Amenities -
Full service café,
meeting rooms and
fitness center on the
ground floor

All SF are approximate and subject to further verification.

FLOOR 2 - 52,027 SF

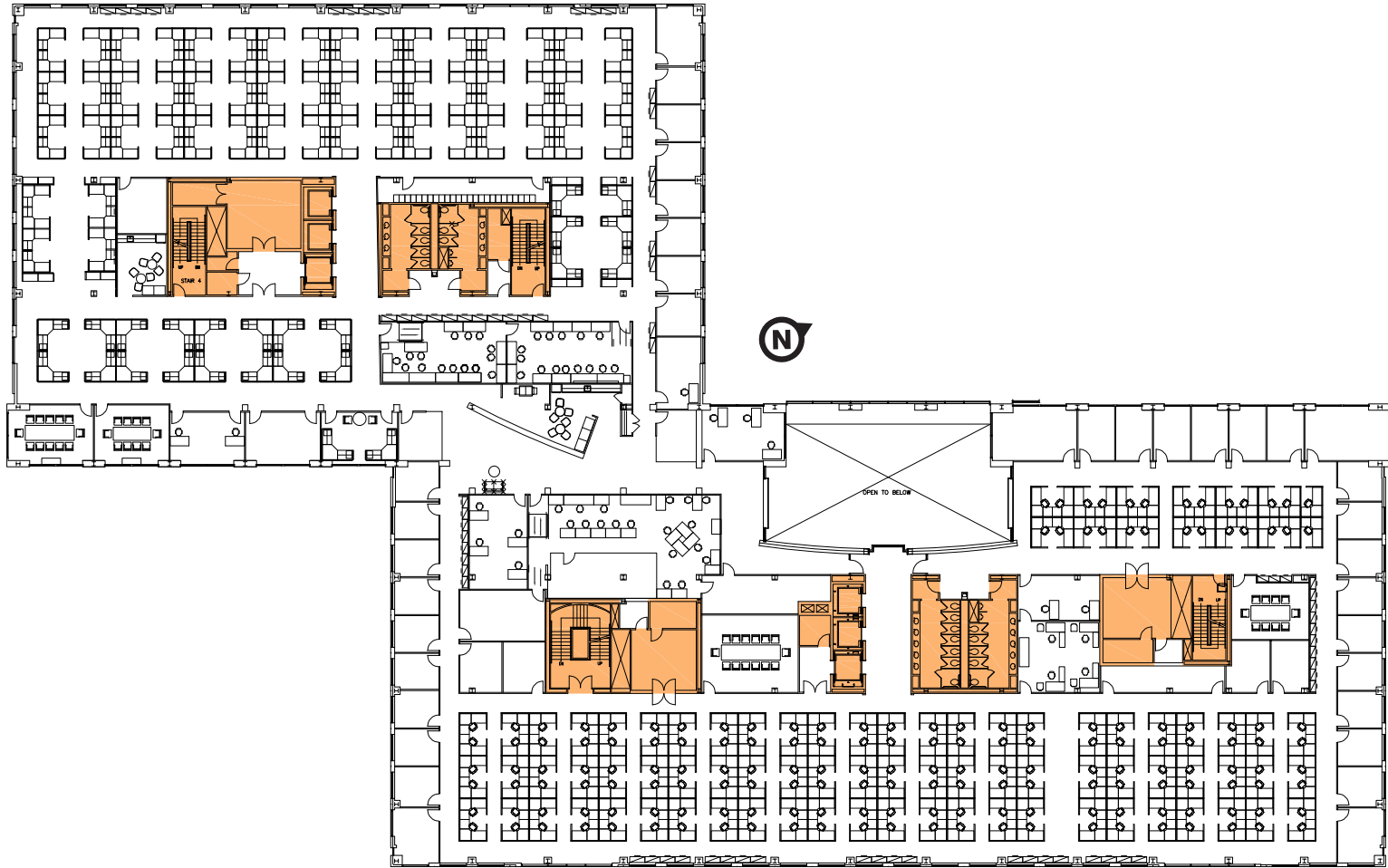

Not to scale



Building
core

FLOOR 3 - 10,466 SF

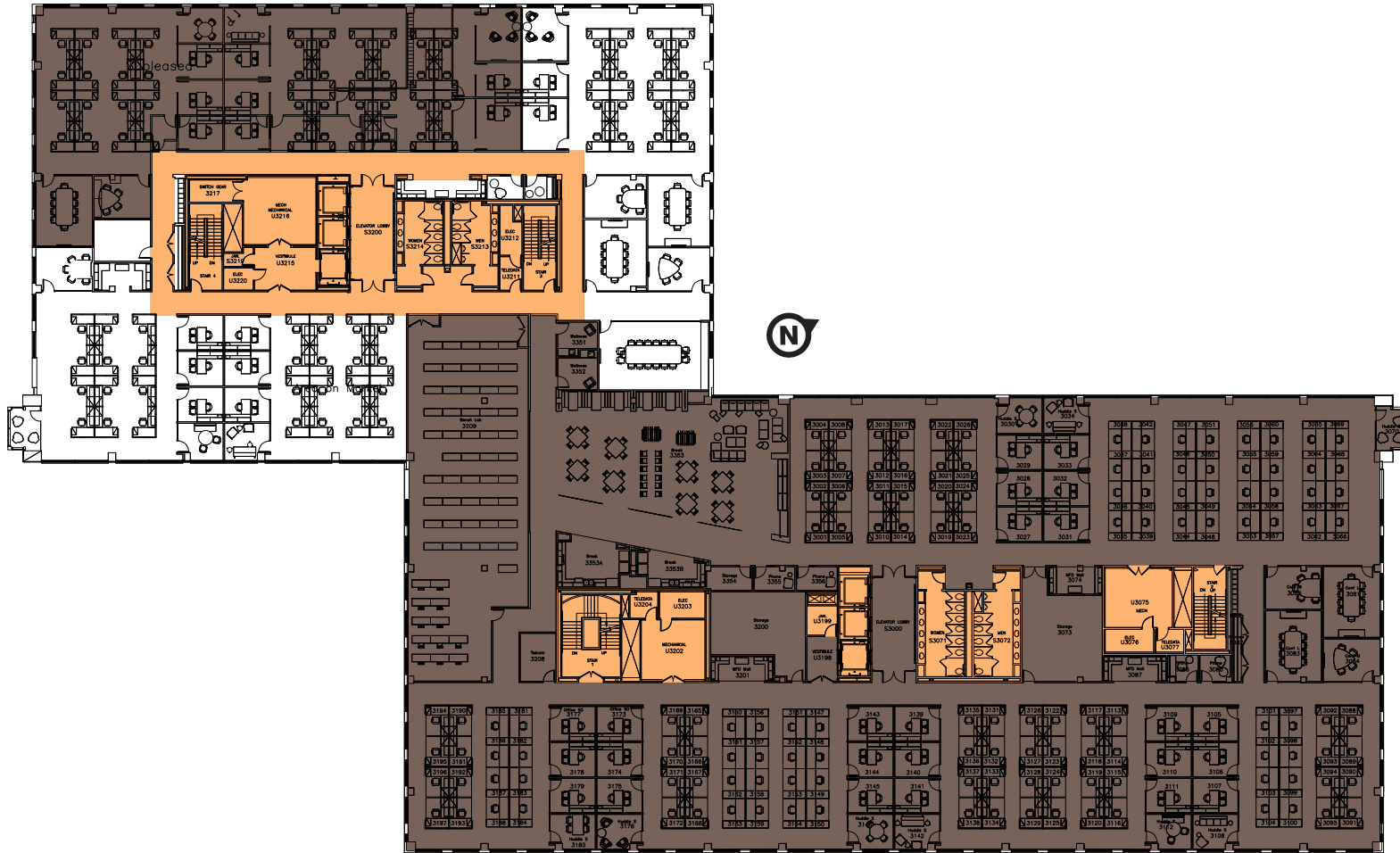

Occupied

Not to scale

All SF are approximate and subject to further verification.

FLOOR 4 - 23,021 SF

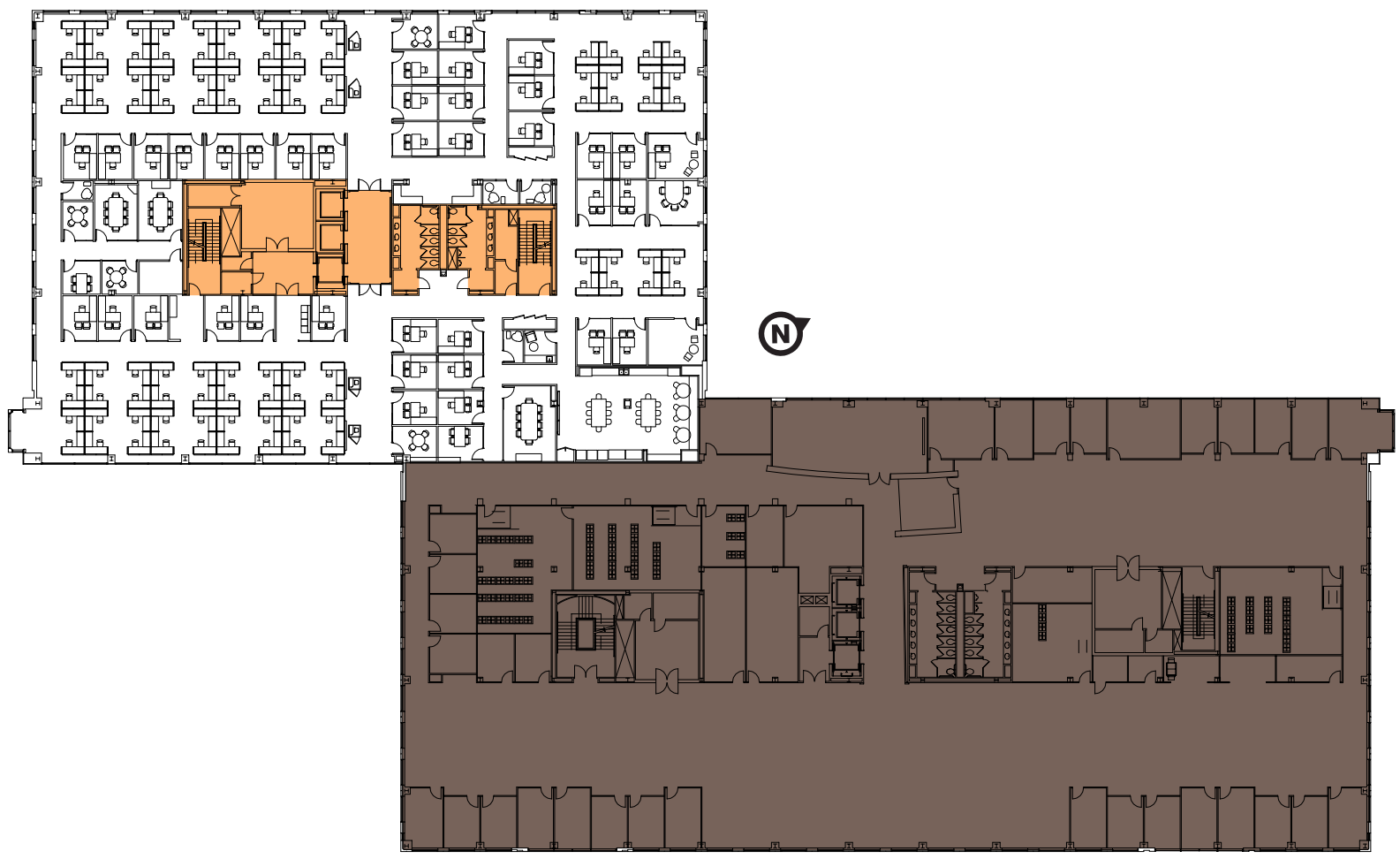

Not to scale



Occupied

FLOOR 5 - 50,624 SF

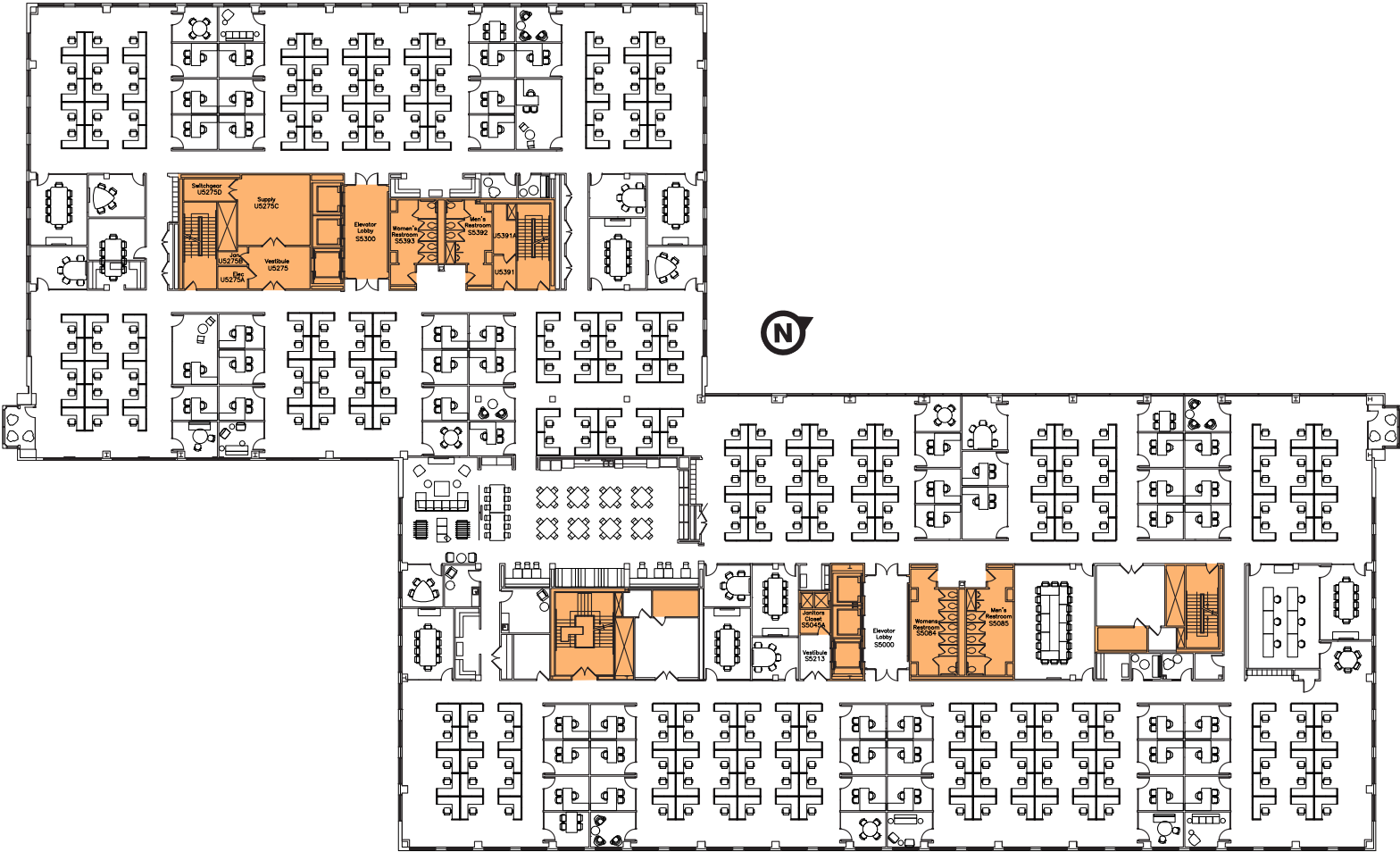



Not to scale

 Building core

All SF are approximate and subject to further verification.

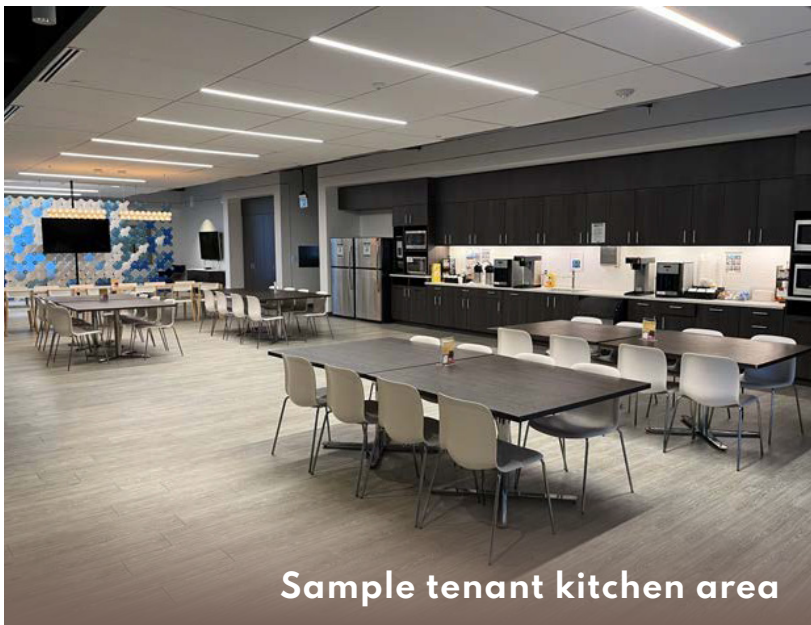
INTERIOR PHOTOS



Sample tenant kitchen area

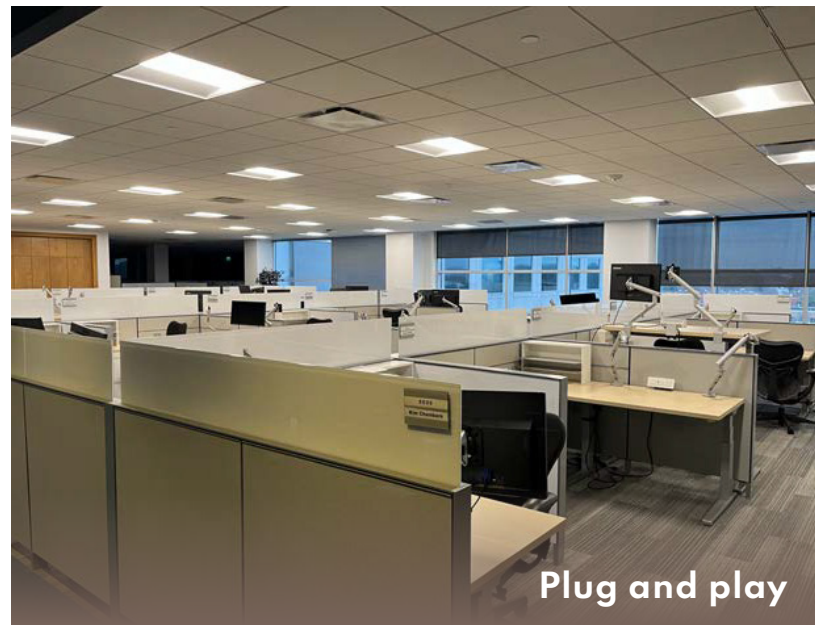

Plug and play



Cafe



Collaborative space

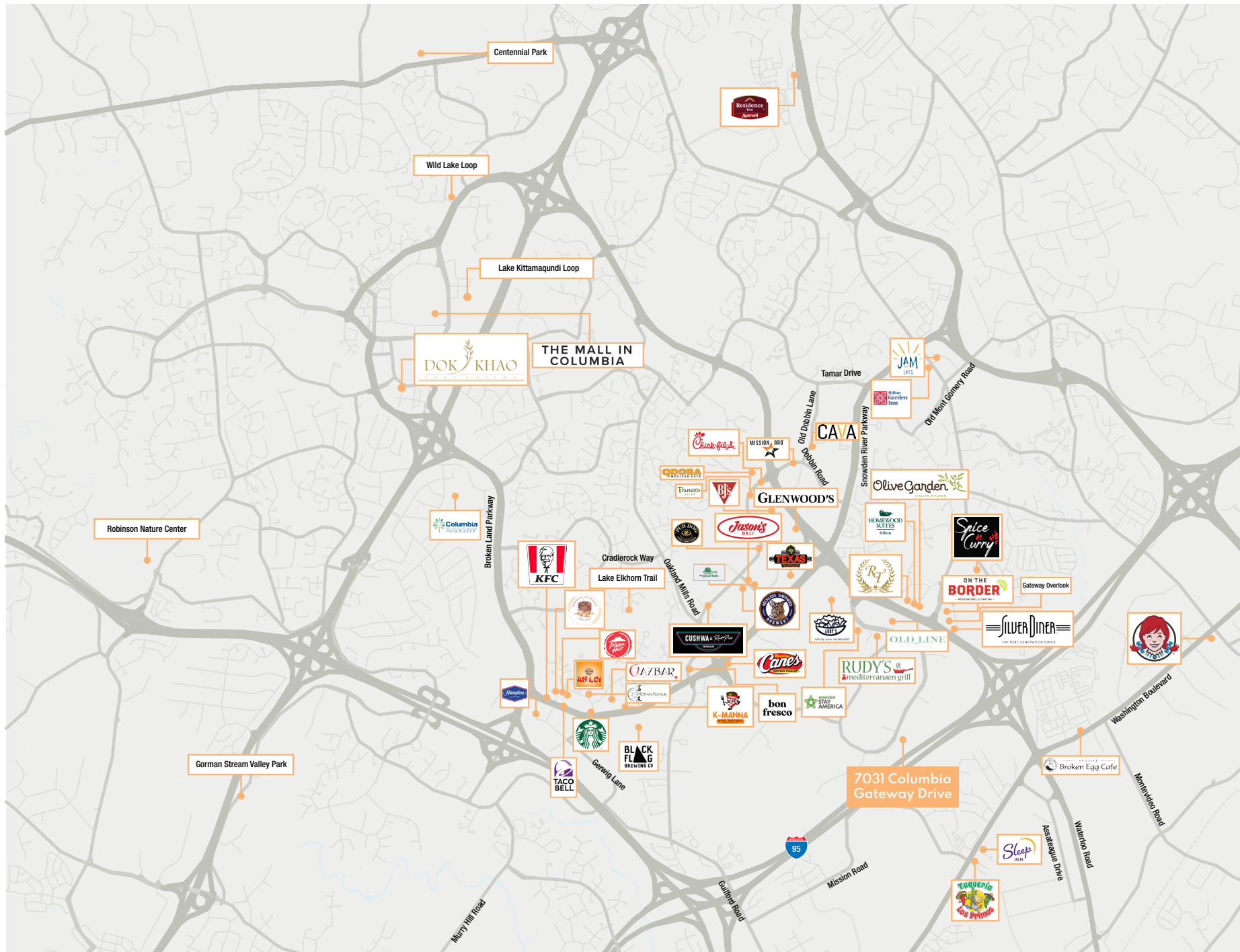

All SF are approximate and subject to further verification.



Rob Freedman

rob.freedman@jll.com
+1 410 952 9444

Dominic Digiovannantonio

dom.digi@jll.com
+1 443 452 1505



Jones Lang LaSalle Americas, Inc. License #: 01856260

Although information has been obtained from sources deemed reliable, JLL does not make any guarantees, warranties or representations, express or implied, as to the completeness or accuracy as to the information contained herein. Any projections, opinions, assumptions or estimates used are for example only. There may be differences between projected and actual results, and those differences may be material. JLL does not accept any liability for any loss or damage suffered by any party resulting from reliance on this information. If the recipient of this information has signed a confidentiality agreement with JLL regarding this matter, this information is subject to the terms of that agreement. ©2025 Jones Lang LaSalle Brokerage, Inc. All rights reserved.