

PINNACLE
SKYTOWER



Pinnacle Skytower
YONGE **1** STREET

Premium Retail for Lease



PINNACLE SKYTOWER

PROPERTY DETAILS

UNIT 1	1,339 SF
UNIT 2	6,346 SF
AVAILABLE	Q4 2026
NET RENT	Please Contact Listing Agents
ADDITIONAL RENT	\$22.00 PSF (est. 2026)

HIGHLIGHTS

- Tallest residential tower in Canada
- A new landmark transforming Toronto's skyline
- 2.5 acres of future Lower Yonge Precinct Park
- Opening January 2027, Le Méridien Toronto Pinnacle Hotel offers timeless chic accommodations with stunning views and curated wellness amenities
- Prime access to the CN Tower, Union Station, and downtown Toronto's vibrant cultural scene



AREA OVERVIEW





A Landmark Community in Downtown Toronto

Pinnacle One Yonge is a prestigious master-planned community by Pinnacle International, featuring Canada's tallest residential towers. Located at Yonge Street and Lake Shore Boulevard, Pinnacle One Yonge places residents steps from Toronto's waterfront, Harbourfront Centre, and Union Station. The development offers direct access to streetcar transit, the Financial and

Entertainment Districts, and Toronto's underground PATH system, alongside 160,000 square feet of retail space.

SkyTower, the flagship tower at One Yonge Street, rises as Canada's tallest residential building. Residents enjoy unparalleled proximity to boutique shopping, acclaimed restaurants, cafés, and cultural attractions—all seamlessly connected through the PATH network and Union Station.

DEMOGRAPHICS - 1KM

	POPULATION	51,211
	DAYTIME POPULATION	180,178
	GROWTH RATE (NEXT 5 YEARS)	37.6%
	AVG. HOUSEHOLD INCOME	\$156,396
	MEDIAN AGE	34.3

Source: Environics, 2026



WALK SCORE
94



TRANSIT SCORE
100



SITE PLAN

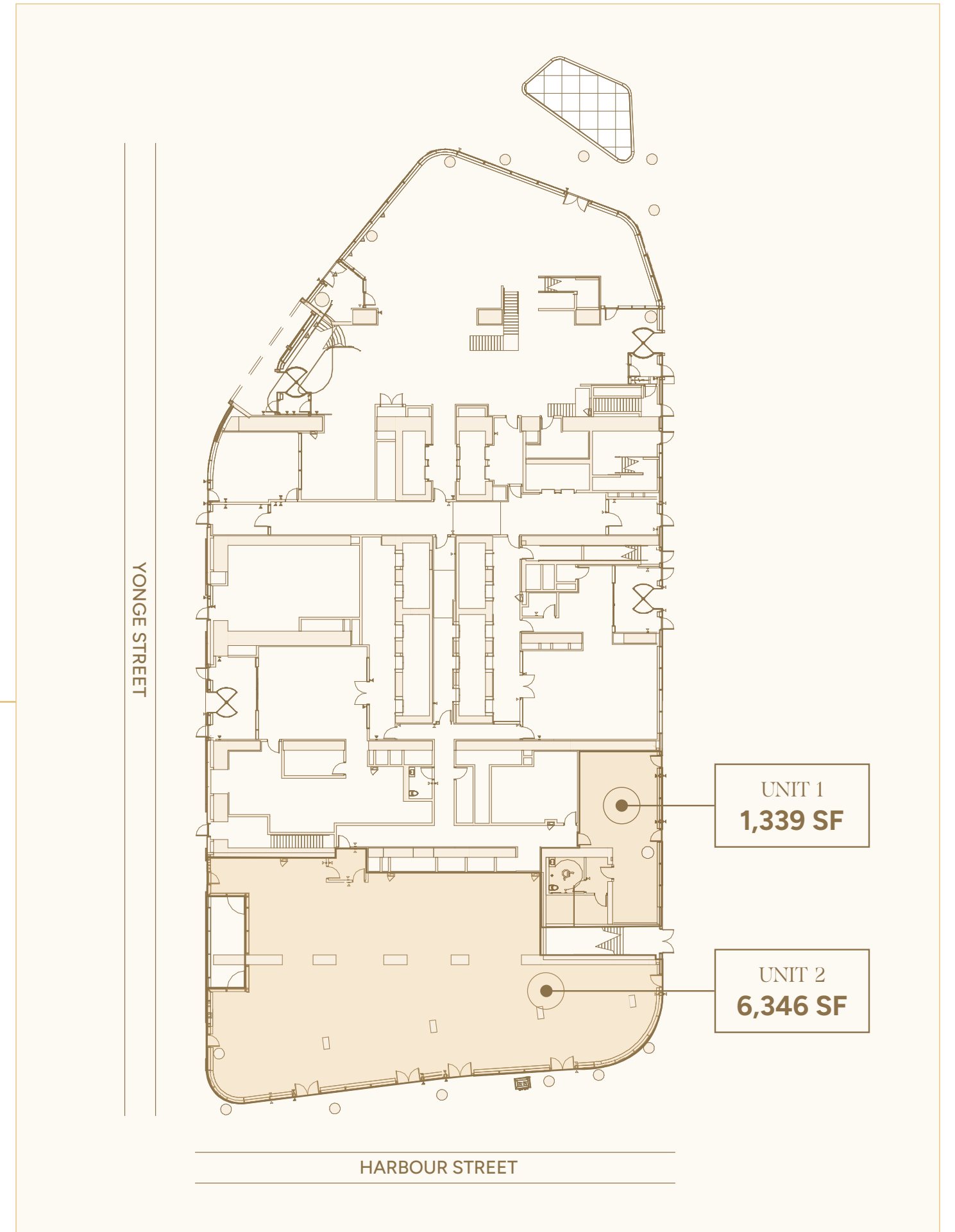

NEIGHBOURHOOD

● RETAILERS

1. FIRKIN ON HARBOUR
2. FRESHII
3. NBA COURTSIDE RESTAURANT
4. SCOTIABANK
5. FARMBOY
6. LCBO
7. LOBLAWS
8. WINNERS
9. NATURE'S EMPORIUM
10. LONGOS
11. ALOETTE
12. THE KEG
13. CHOTTO MATTE
14. SHOPPERS DRUG MART

● LANDMARKS

1. ROGERS CENTRE
2. CN TOWER
3. SCOTIABANK ARENA
4. CIBC SQUARE
5. METRO TORONTO CONVENTION CENTRE

● TTC STATION



PINNACLE SKYTOWER



Pinnacle Skytower YONGE 1 STREET

BRANDON GORMAN**
Executive Vice President
+1 416 855 0907
Brandon.Gorman@jll.com

GRAHAM SMITH*
Executive Vice President
+1 416 855 0914
Graham.Smith@jll.com

AUSTIN JONES**
Associate Vice President
+1 416 304 6050
Austin.Jones@jll.com

MATTHEW MARSHALL*
Associate Vice President
+1 416 238 9925
Matthew.Marshall@jll.com

PINNACLE
SKYTOWER | 

Although information has been obtained from sources deemed reliable, neither Owner nor JLL makes any guarantees, warranties or representations, express or implied, as to the completeness or accuracy as to the information contained herein. Any projections, opinions, assumptions or estimates used are for example only. There may be differences between projected and actual results, and those differences may be material. The Property may be withdrawn without notice. Neither Owner nor JLL accepts any liability for any loss or damage suffered by any party resulting from reliance on this information. If the recipient of this information has signed a confidentiality agreement regarding this matter, this information is subject to the terms of that agreement. ©2026 Jones Lang LaSalle IP, Inc. All rights reserved. **Broker. *Sales Representative.