



For Lease

PK111 Multi-Tenant

16645 -16653 111 Avenue | Edmonton, AB

±2,581 SF Grade loading warehouse bay

- Functional grade loading bay with modern office finishes
- Paved yard area available on site
- Prominent location with easy access to main arterials such as 170th Street and 111th Avenue

For more information contact:

Kent Simpson

Vice President

780 203 0425

Kent.Simpson@jll.com



Property Details

Municipal Address	16651 111 Avenue
Zoning	IM - Medium Industrial
Market	West Sheffield Industrial
Available Area	±2,581 SF
Year Built	1969
Construction	Concrete block with metal cladding
Bay Depth	98'
Power	100 Amp, 120/240 Volt (TBC by Tenant)
Ceiling Height	14'8"
Heating	Forced air in warehouse

Lighting	LED & Fluorescent
Sump	Yes
Loading	Grade
Yard	Paved yard area is available on site
Lease Rate (PSF)	\$14.00
Op. Costs (PSF)	\$5.50 (2026 estimate)
Occupancy	Immediate

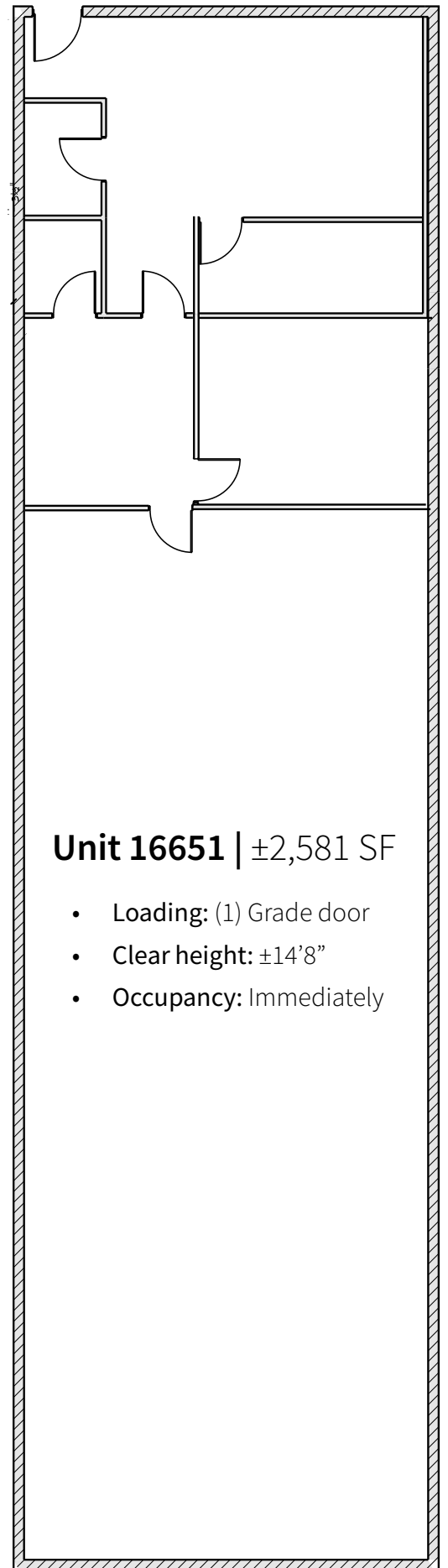
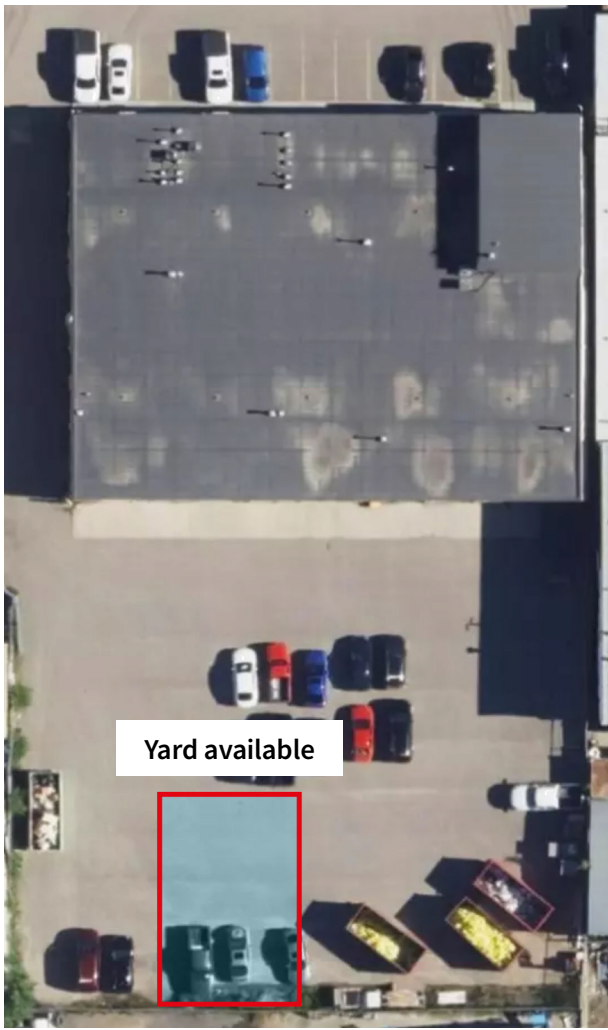

Unit 16651 | ±2,581 SF

- Loading: (1) Grade door
- Clear height: ±14'8"
- Occupancy: Immediately

** Floor plan is for representation purposes and not to scale*

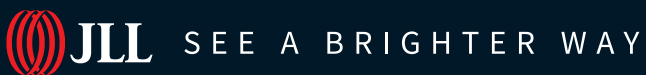
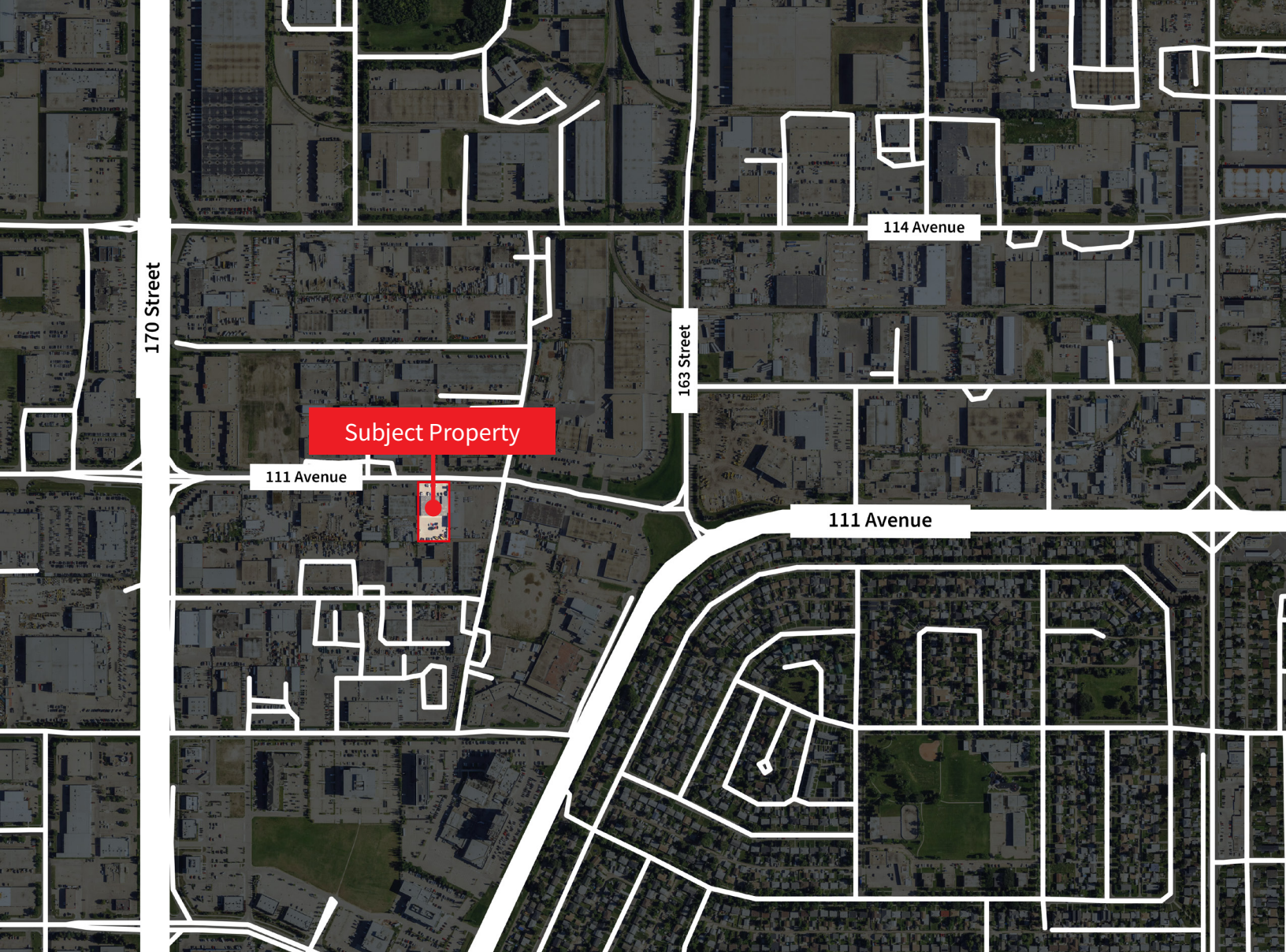

Darryl McGavigan

Executive Vice President
+1 780 328 0064
Darryl.McGavigan@jll.com

Adam Butler

Executive Vice President
+1 780 328 0065
Adam.Butler@jll.com

Bronwyn Scrivens

Vice President, SIOR
+1 780 807 4564
Bronwyn.Scrivens@jll.com

Kent Simpson

Vice President
+1 780 203 0425
Kent.Simpson@jll.com

Mackenzie York

Associate Vice President
+1 780 920 8463
Mackenzie.York@jll.com

Rory Wutzke

Associate (*unlicensed*)
+1 780 328 2578
Rory.Wutzke@jll.com

Kailee Campbell

Senior Transaction Analyst
+1 780 328 0069
Kailee.Campbell@jll.com

Leonardo Triana

Senior Marketing Associate
+1 587 412 1755
Leonardo.Triana@jll.com

JLL Edmonton Industrial | National Bank Centre - 3560, 10180 101 Street NW, Edmonton, AB, T5J 3S4

DISCLAIMER: ©2026 Jones Lang LaSalle IP, Inc. All rights reserved. All information contained herein is from sources deemed reliable; however, no representation or warranty is made to the accuracy thereof. The Property may be withdrawn without notice. Neither Owner nor JLL accepts any liability for any loss or damage suffered by any party resulting from reliance on this information. Jones Lang LaSalle Real Estate Services, Inc.