

Move-In Ready Sublease Available at

633 FOLSOM

5TH FLOOR & 6TH FLOOR
55,668 RSF Total | Through 10/2033



THE OFFERING

- 5TH FLOOR:
27,834 RSF | Room for 192 desks
- 6TH FLOOR:
27,834 RSF | Room for 202 desks
- Term through 10/2033
- On-site gym at additional cost
- Culinary service at additional cost
- Easy access to public transit

5TH FLOOR

27,834 rsf | Term Through 10/2033



Capacity for 192 Desks
(Current desk count: 174)



21 Meeting Rooms



Kitchen



Multiple Break Areas



Great Natural Light

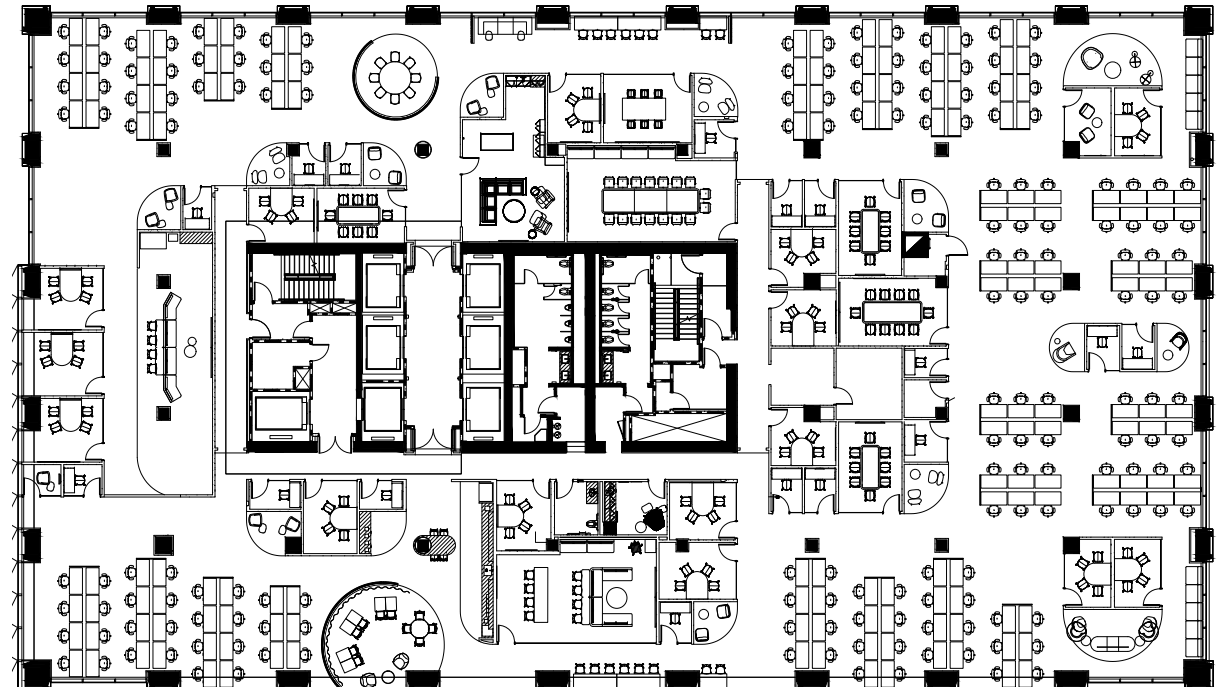

6TH FLOOR

27,834 rsf | Term Through 10/2033



Capacity for 202 Desks
(Current desk count: 174)



23 Meeting Rooms



Kitchen



Multiple Break Areas



Great Natural Light

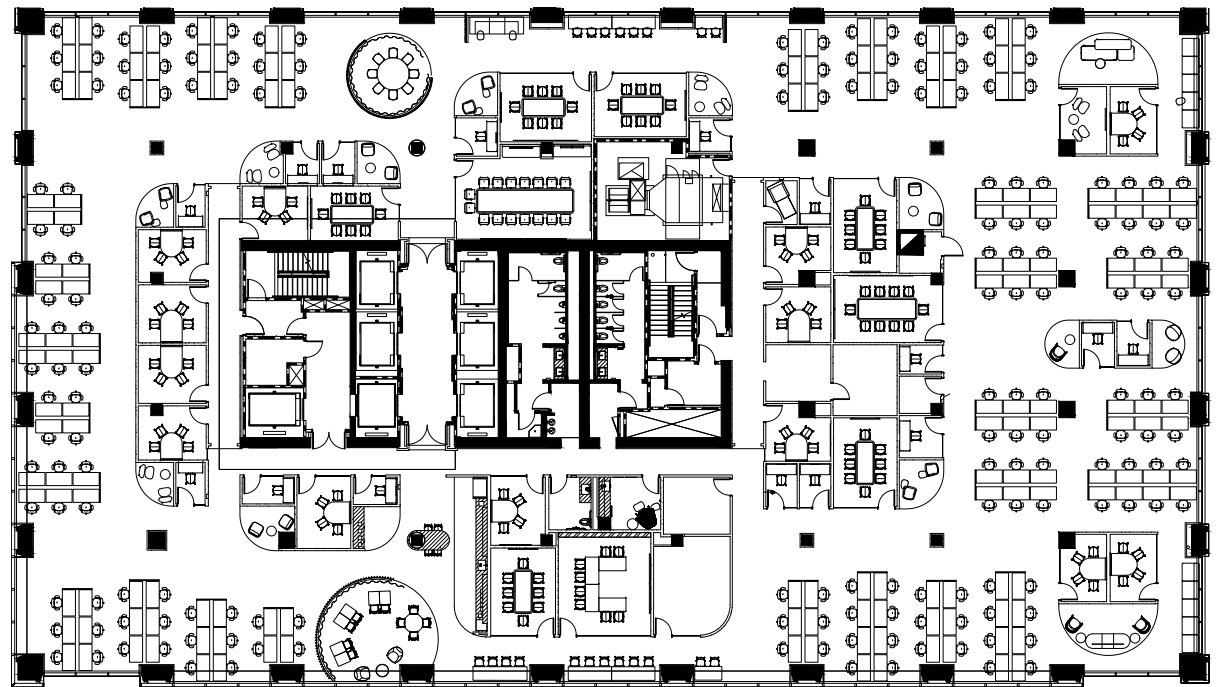



WELCOME TO THE NEIGHBORHOOD

Located in SoMa, 633 Folsom is a reimagined Class A office destination combining award-winning architecture, transit access, and sustainability-forward design. The LEED Gold and WELL Silver building features modern systems, abundant daylight, a distinctive solar-shaded facade, and an elevated workplace environment.



MOSCONE CENTER



BLUE BOTTLE COFFEE



sweetgreen



633 FOLSOM



Jonathan Allen

415 867 4221
jonathan.allen@jll.com
RE Lic. #: 01322637

Griggs Ziesing

415 228 3077
griggs.ziesing@jll.com
RE Lic. #: 01914746

Mike Iino

408 394 9973
mike.iino@jll.com
RE Lic. #: 01831886

Rich Duff

303 547 7979
rich.duff@jll.com
RE Lic. #: 02240604

Hugh Scott

650 468 8688
hugh.scott@jll.com
RE Lic. #: 01414759



Although information has been obtained from sources deemed reliable, neither Owner nor JLL makes any guarantees, warranties or representations, express or implied, as to the completeness or accuracy as to the information contained herein. Any projections, opinions, assumptions or estimates used are for example only. There may be differences between projected and actual results, and those differences may be material. The Property may be withdrawn without notice. Neither Owner nor JLL accepts any liability for any loss or damage suffered by any party resulting from reliance on this information. If the recipient of this information has signed a confidentiality agreement regarding this matter, this information is subject to the terms of that agreement. ©2026. Jones Lang LaSalle IP, Inc. All rights reserved.