

# Rigid Kitchen Unit Carcass Specifications

---

## Wall Units Diagonal Corner Wall Units Top Boxes

Supplied with steel wall hangers and plates.

Each unit can be supplied with the appropriate clip on soft close hinges. These can be added in the door hinges option on each product.

18mm solid back.

20mm service void.

18mm matching shelves.

Units are 18mm thick colour coordinated Egger board.

0.8mm ABS edged with PUR glue for a strong water resistant finish.

Cam and dowel construction.

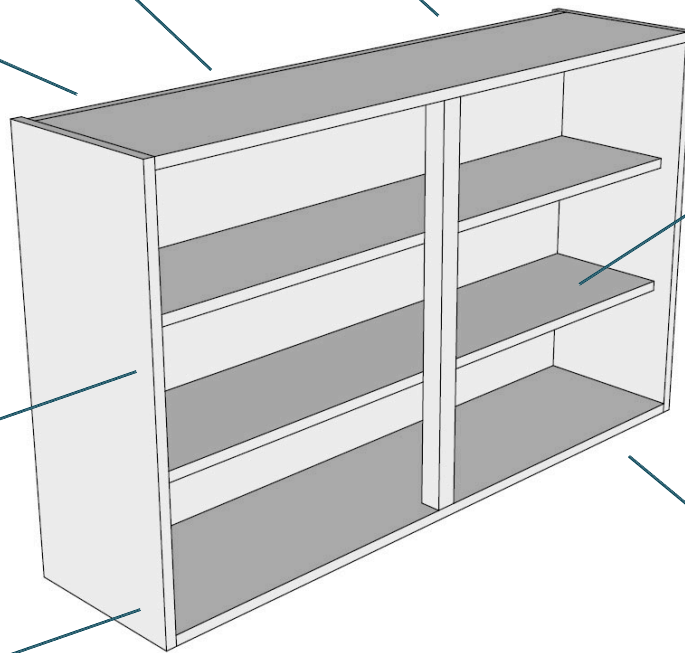

Units are supplied pre-built for durability and easy installation.

# LARK&LARKS

Quality kitchens and bedrooms online

[www.larkandlarks.co.uk](http://www.larkandlarks.co.uk)

T: 0330 135 9090 E: [sales@larkandlarks.co.uk](mailto:sales@larkandlarks.co.uk)