

# LENOXX®

## Electric Food Waste Composter



Model: CMP380 | Batch: PR5196

Carefully read all instructions before use and save for future reference.



# SAFETY INSTRUCTIONS

This instruction manual will help you familiarise yourself with the features and functions of your appliance. It also provides guidance on how to use and care for the appliance. To ensure safe and effective use, please read this manual before operating the appliance.

This product is intended for household use only. Please follow these basic safety guidelines when using the appliance:

1. Keep all electrical components (plugs, cords) away from water or other liquids to prevent electric shock.
2. The appliance is not intended for use by persons (including children) with physical, sensory, or mental impairments, or those lacking experience and knowledge.
3. Switch off and unplug the appliance from the socket when not in use, during servicing, or when adding/removing parts. To unplug, grasp the plug—not the cord—and pull it out of the socket.
4. Allow the unit to cool before assembling, disassembling, or cleaning to avoid burns.
5. Do not use the appliance if the power cord or plug is damaged, or if the appliance shows signs of malfunction or has been dropped.
6. Do not operate the appliance outdoors.
7. Do not use the appliance in freezing temperatures.
8. Keep the power cord away from heat sources and sharp objects.
9. The appliance must be plugged into a properly grounded outlet.
10. Do not place the appliance on or near hot gas or electric burners.
11. Use the appliance only for its intended purpose. Do not disassemble, alter, or modify the appliance in any way.
12. Do not immerse the appliance in water or any other liquid.
13. Keep the appliance and power cord out of the reach of children.
14. When opening and closing the cover, ensure the surface of the unit is free of foreign objects.
15. Be cautious when touching the drum during or immediately after the cycle, as the drum may still be hot.
16. Avoid touching any parts still in operation. Do not attempt to override any safety locking mechanisms of the device.

## **Common Error Codes:**

OPEN: Lid is open.

E01: No food waste bin detected.

# COMPONENTS

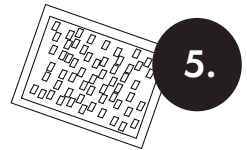
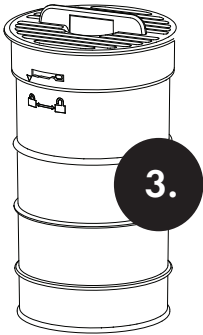
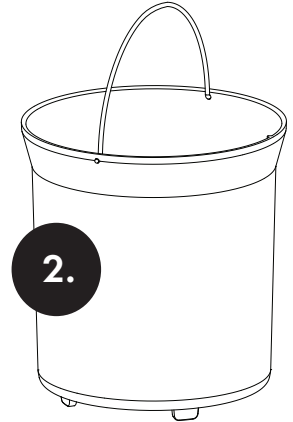

1. Composter
2. Inner Bucket
3. Filter 1
4. Filter 2
5. Activated Charcoal Packet

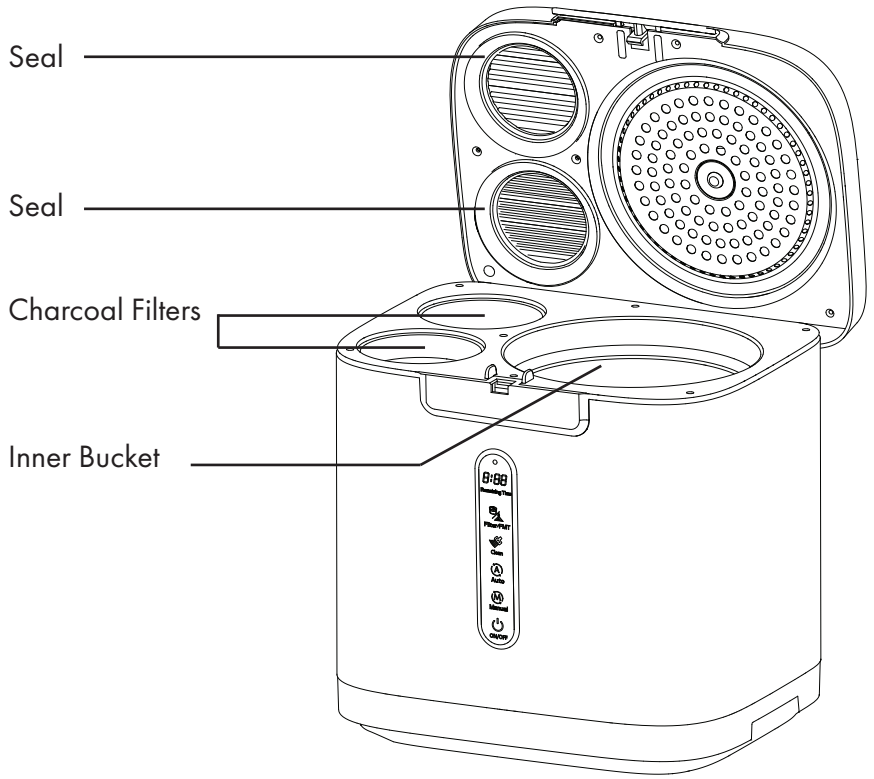
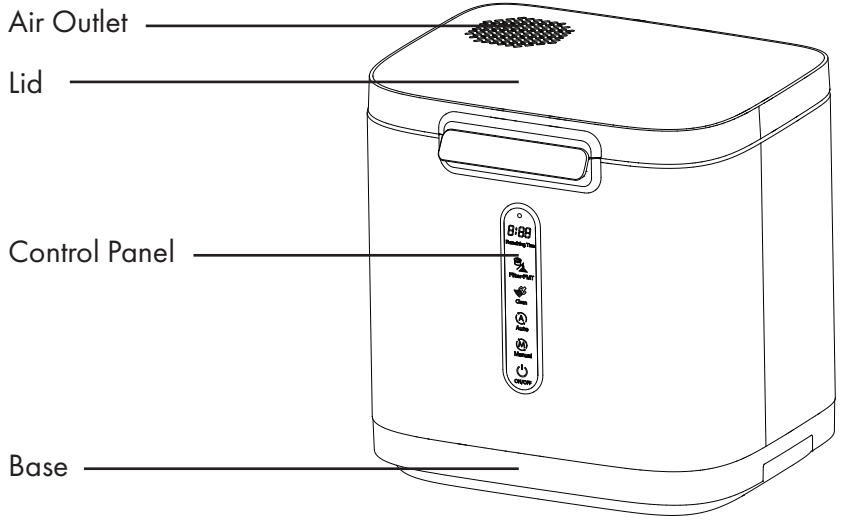

# CONTROL PANEL

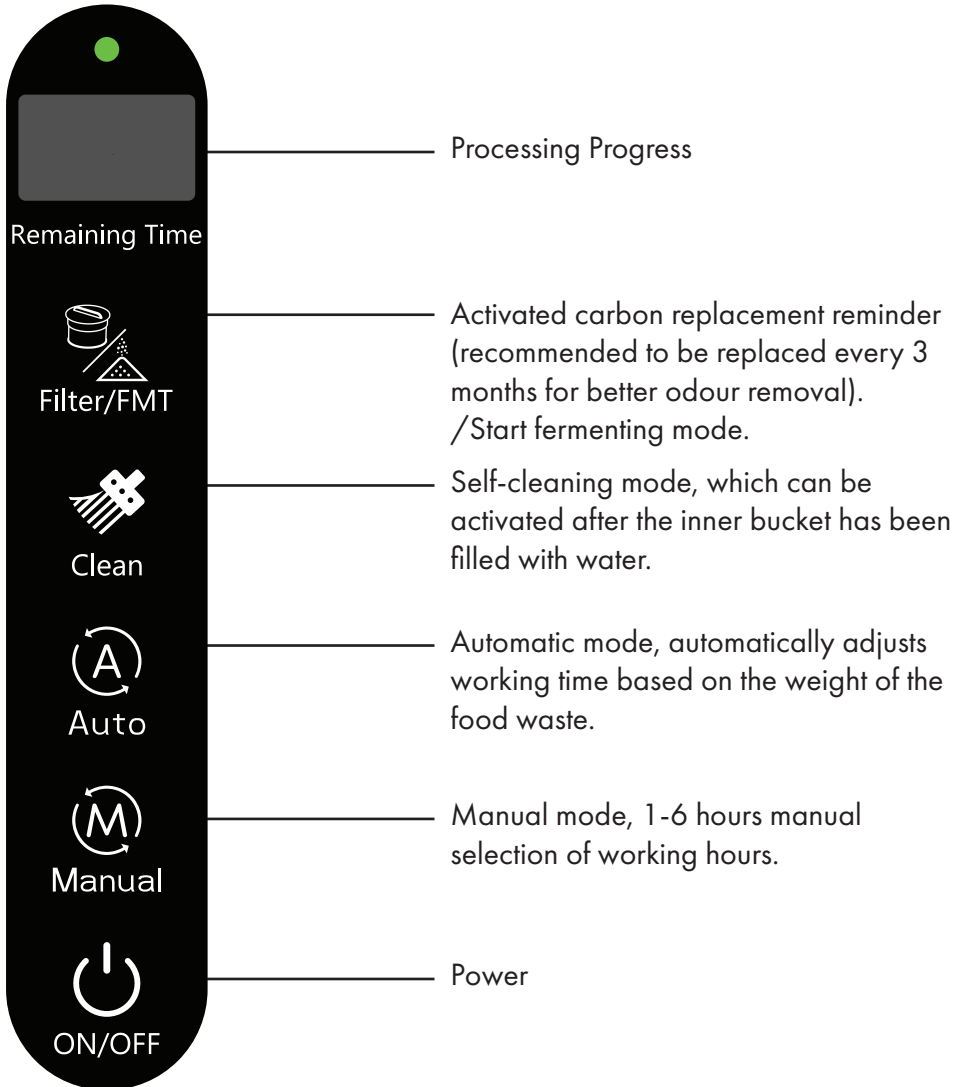

# USING YOUR COMPOSTER

Step 1: Connect the main unit to the power supply. Gently pull the latch upwards to open the lid.

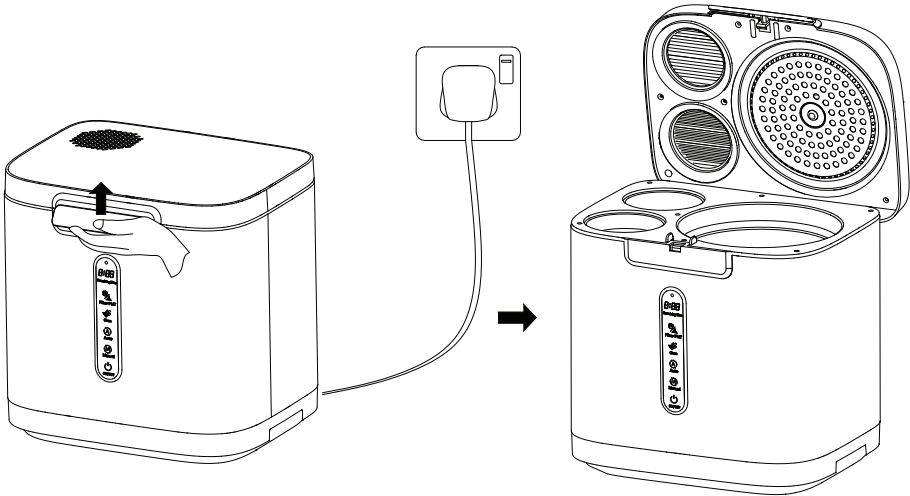

Step 2: Remove the filters, open their lids, and fill each with the appropriate amount of charcoal pellets. Secure the lids by twisting left to open and right to lock.

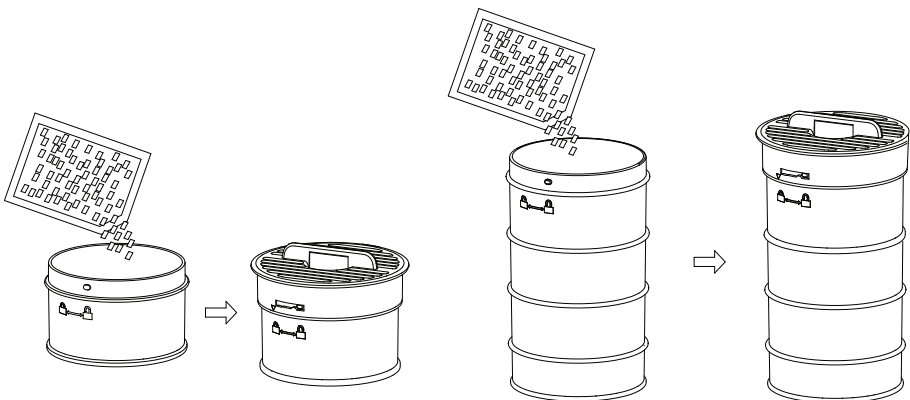

Step 3: Reinsert the filters with the charcoal pellets. Add food waste into the food waste bucket and place it in the corresponding cavity of the main unit.

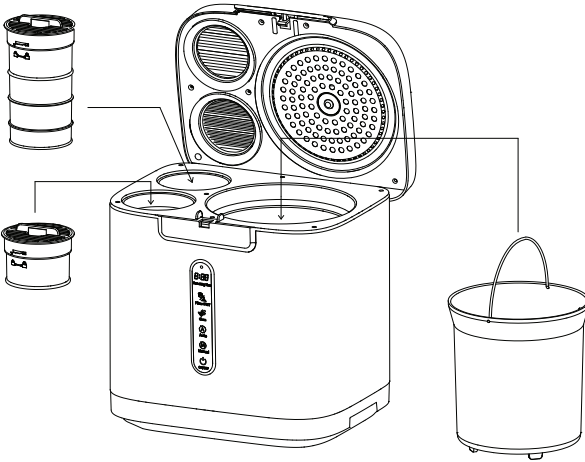

Note: Gently rotate the inner bucket left or right. Once you hear a “click” and the bucket drops noticeably, it is securely installed and flush with the chamber surface.

Step 4: Close the lid and press down until you hear a “click,” indicating the flap is secure. Tap the power key on the control panel to turn on the machine. After 3 seconds of initialisation, select your desired working mode (automatic or manual) to start the machine. When the processing is complete, wait for the food waste bucket to cool down naturally before removing it (take care as it may still be hot).

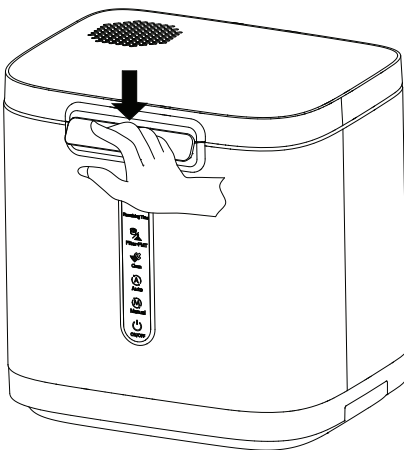



**Manual Mode:** Select the desired duration (1-6 hours), then press the power button to confirm and start the process.



**Automatic Mode:** The system will automatically determine the duration based on the weight of the food waste. Activate this mode by pressing the  button.



**Note:** It's normal to have residue in the kitchen waste bucket, and it will not affect performance. To clean, add 1/3 of water into the bucket, start the self-cleaning mode, and the water will be automatically heated. The hot water, combined with stirring, will effectively clean the bucket.

## MAINTENANCE



### Activated Carbon Replacement

The machine has an activated carbon replacement prompt function (it's recommended to replace the carbon every 3 months for better odour removal performance).

When the  flashes, it's time to replace the activated carbon. To do so, follow these steps:

- Remove the charcoal filter.
- Unscrew the lid and replace the charcoal pellets with new ones.
- Place the filters into the corresponding cavities of the main unit.
- Once the replacement is complete, press and hold the  until the light goes out.

## Unit Maintenance and Cleaning

Regularly wipe the inside and outside of the lid and the main body of the machine with a soft cloth to effectively prevent odour buildup.

Note: Do not rinse the entire machine directly with water. Always unplug the machine before cleaning the surfaces with a soft cloth.

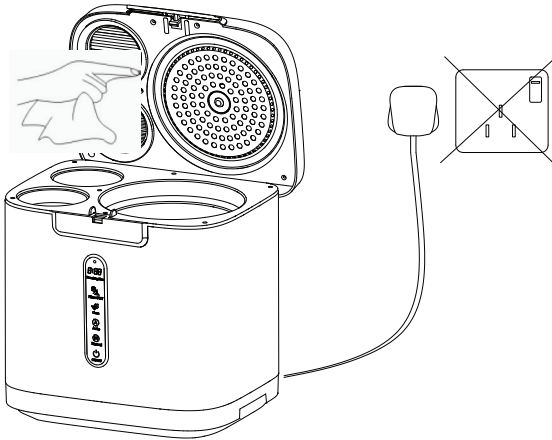

## Food Waste Tank Cleaning and Maintenance

For a more thorough cleaning of the food waste bucket, you can remove the mixing paddle as follows:

Step 1: Hold the lock cover with your fingers and pull it up to release the locking mechanism inside.

Step 2: Turn the lock cover 90 degrees to loosen it. Then, rotate the lock cover 90 degrees to the left and remove it when the lock seat slot is loosened.



Step 3: After removing the lock seat, you can take out the mixing paddle inside.

Step 4: After cleaning, reinstall the mixing paddle first, followed by the lock seat. Turn it 90 degrees to the right and press the lock cover flat. When you hear a click sound, the locking mechanism installation is complete.

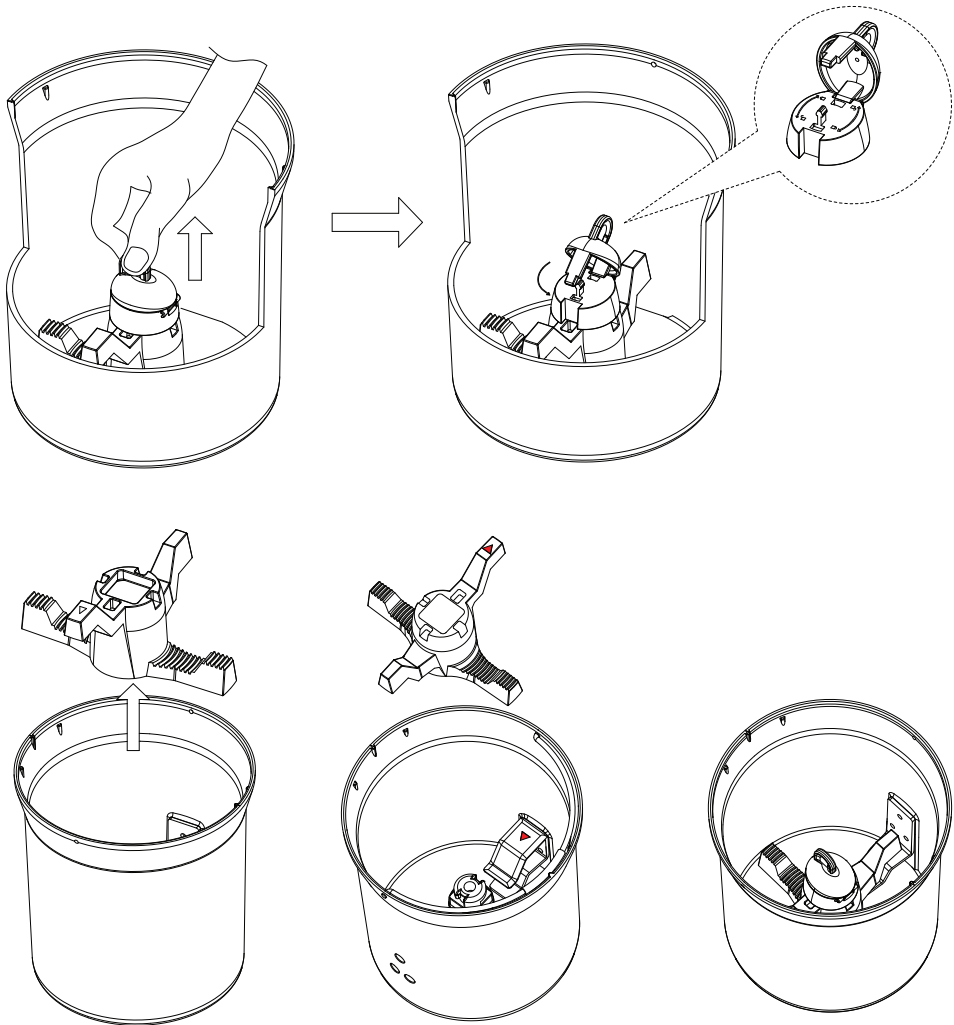
Note: It is recommended to use the machine's self-cleaning function regularly. The removal of the mixing paddle should only be done when necessary.



# COMPOSTING GUIDELINES

1. When you have food waste to dispose of, simply place it into the bucket.
2. Press the  button, and the machine will automatically determine the required operating time based on the weight of the waste. It will maximize power savings and then switch to standby mode (4-6 hours) once completed. If you need to add more food waste during the process, open the top lid, add the waste, and close the lid. The system will continue from the planned time until completion. (You can also manually increase the time for optimal processing results).
3. After a single treatment, the waste can be stored in a sealed bag (it can also be disposed of directly as dry waste). If you wish to make compost, follow these steps:
  - a. Add 50% water (400g) to 800g of treated food waste.
  - b. Press  to start the composting mode.
  - c. After 3 hours of operation, add microorganisms (yeast) to accelerate the maturation process.
  - d. The curing process takes approximately 12 hours to complete. After curing, store the compost in a sealed container for 1 week. Mix the compost with soil in a 1:10 ratio before planting. Avoid root burning.

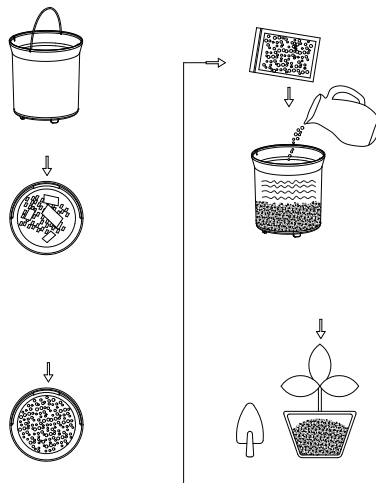

# Composting Compatibility Chart

## Can be handled directly

## Cut to pieces before handling

## Small amount (not more than 60g)

## Unprocessable

Vegetable leaves

Whole corn

Starch

Cooking oil

Melon peel, fruit peel, potato peel

Whole celery

Rice (cooked)

Large bones

Fish, fish bones, chicken bones

Whole carrots

Breads

Beef bones

Eggs, eggshells

Big leaves, flowers and plants

Pasta

Clams

Coffee grounds, tea grounds

Biodegradable tableware

Jams

Oyster shells

Legumes

Biodegradable bags

Dairy products

Snails

Weeds, dead leaves

Jellies

Confectionery

Corn pieces, corn husks

Chewing gums

Fibrous plants

Coffee capsules

Vegetables and fruits

Non-biodegradable tableware

Whole chilli

Chipboard

Prawn shells, seafood shells

# FREQUENTLY ASKED QUESTIONS

## 1. How should the equipment be placed?

The unit can be placed in any area of the house (including the basement) where there is an electrical outlet and sufficient space. Ensure the unit is on a flat, dry surface—avoid areas prone to water accumulation. Do not place the appliance next to heaters or kitchen appliances that generate excessive heat. The unit should not be stored outdoors or in places exposed to moisture or freezing temperatures. Do not use the unit in environments above 40°C or below 0°C. Ensure adequate ventilation around the appliance, and do not block any air outlets during operation. Avoid placing any objects on top of the appliance.

## 2. What types of food waste can the equipment treat?

This machine works best with a diverse mix of food waste. For optimal results, include various types of food waste in each cycle. Greasy or hard-to-process ingredients can be mixed with lighter or drier ones for the best outcome.

Avoid placing large quantities of the following kitchen waste alone:

- Starch (e.g., bread, cakes, rice, noodles, mashed potatoes, stuffing)
- Condiments, dressings, sauces, and large amounts of grease
- Nut butters, jellies

Due to their high starch content, these foods tend to solidify and stick to the mixing paddle. If this happens, the machine will stop processing and switch to self-protection mode (error code displayed). Clean off the cured starch to continue.

## 3. What should you not put into the device?

Do not attempt to treat non-food items such as glass, metal, or wood.

Avoid placing large pork or beef bones, candy, or chewing gum. These can damage the unit or overload the motor, causing it to enter self-protection mode.

Do not add cooking oil, flammable materials, or compounds, as they are beyond the intended use of the appliance.

#### **4. Is it normal to hear “knocking” or “squeaking” when the machine is running?**

Yes, the knocking sound is a normal part of the machine’s food waste processing. It occurs as the machine chops up food waste. The noise may increase when handling particularly hard or stemmed foods.

# LENOXX



1300 666 848

[service@lenoxx.com.au](mailto:service@lenoxx.com.au)

[www.lenoxx.com.au](http://www.lenoxx.com.au)



LenoxxElectronics



LenoxxElectronics