

KITCHEN PRO

PREP

Mason Jar Vacuum Sealer Kit

Owner's Manual



IMPORTANT

This instruction manual contains important information necessary for the proper assembly and safe use of the appliance.

Read and follow all warnings and instructions before assembling and using the appliance.

Keep this manual for future reference.

The Kitchen Pro Prep Mason Jar Vacuum Sealer Kit creates an airtight vacuum seal on both regular and wide mouth mason jars, keeping your food fresh for longer. By sealing out oxygen, it helps prevent spoilage, oxidation, and flavour loss, extending the shelf life of ingredients while preserving their original taste.

PRODUCT FEATURES

- Portable automatic vacuum sealer for mason jars
- Helps to reduce food waste and extend storage time and freshness
- Auto shut off feature
- One touch operation
- USB-C rechargeable

SAFETY PRECAUTIONS

When using this electrical appliance, basic safety precautions should always be followed including:

1. Read all instructions carefully before use.
2. Do not overfill the mason jar with food or liquid. Overfilling the jar reduces the air pressure and the jar will not seal properly. We recommend you leave 1.5cm between the top of the jar and the contents before sealing.
3. Before you start vacuum sealing, press the sealing machine onto the top of the jar with force to ensure it fits tightly onto the bottle cap.

4. It is recommended you run the vacuum sealer for a minimum of 30 seconds to ensure a proper seal is created.
5. When the power display is lower than 20%, recharge the battery.
6. The appliance is not waterproof, so never immerse it in water or any other liquid.

GET TO KNOW THE KITCHEN PRO PREP MASON JAR VACUUM SEALER KIT

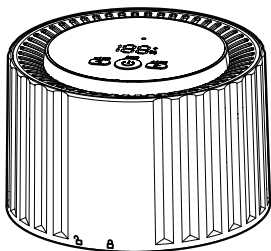

Wide mouth suction end

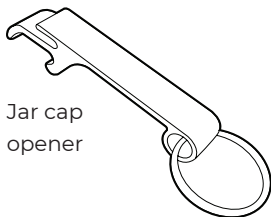

Jar cap
opener

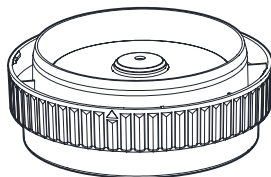

Regular mouth suction end
convertor

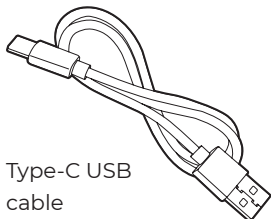

Type-C USB
cable

OPERATING INSTRUCTIONS

Before use, select the required suction end, as per the above diagram, based on the size of the mouth of the jar ('regular mouth' or 'wide mouth').

To remove the 'regular mouth suction end convertor' from the host, rotate it clockwise until you hear a 'click' sound and then pull the two pieces apart. The smaller part is for 'regular mouth' mason jars and the larger part is for 'wider mouth' mason jars.

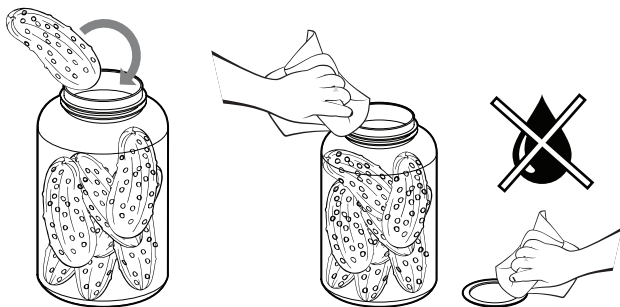

1. Place your ingredients into the mason jar, making sure you leave at least 1.5cm at the top of the jar. Caution: If the jar is too full, the lid will not seal correctly.
2. Wipe both the jar mouth and the lid clean and make sure they are both dry before applying the vacuum sealer.

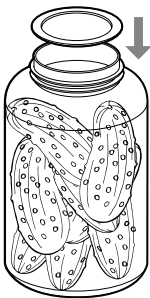

3. Align the lid with the jar mouth and then place the lid on the jar mouth.

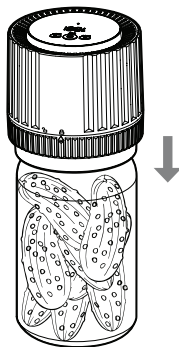

4. Align the sealer with the jar mouth and press the sealer down firmly.

NOTE: The default sealing time is 30 seconds. The minimum adjustable time is 20 seconds and the maximum is 150 seconds. Long pressing the power button will set the sealing time to 150 seconds automatically. The timer will count up from 0 to 150.

5. Press the power key to start the sealing process. If you want to add/reduce time during the sealing, just press +10s or -10s. The process will be completed after 30 seconds and the sealer will stop automatically.

Caution: Sealing will automatically shut off if the power key is pressed after the sealing process has started.

CHARGING THE VACUUM SEALER

1. During the sealing process, if the power indicator light flashes several times and the sealer stops working, it means the device has low battery power. Please charge the device with the included USB-C cable.
2. The green charging indicator light will flash when the device is charging.

CLEANING AND MAINTENANCE

To clean the vacuum sealer, simply wipe it with a damp cloth and dry thoroughly before storing. Do not use abrasive sponges, cleaners or corrosive liquids (such as gasoline, acetone, etc.).

TROUBLESHOOTING

Problem	Resolution
<p>Wide mouth mason jars are not sealing</p>	<ol style="list-style-type: none"><li data-bbox="529 363 938 428">1. Check for any dirt or liquid on the bottle mouth and lid.<li data-bbox="529 458 938 560">2. Check that the sealing rubber rings of the wide port are not offset.<li data-bbox="529 591 938 843">3. When using, check that the sealer has been firmly attached to the jar and pressed to the bottom. If you are not sure, please try to align and press again until the sealer is pressed to the bottom.<li data-bbox="529 874 938 1127">4. Ensure you have not overfilled the jar. Make sure that the food does not exceed the thread line/neck of the jar. It's recommended that you leave approximately 1.5cm free at the top of the jar.

Problem	Resolution
Regular mouth mason jars cannot be sealed	<ol style="list-style-type: none"><li data-bbox="529 217 919 278">1. Please check the above four points firstly and try again.<li data-bbox="529 312 930 563">2. Check that the regular port converter is fully inserted into the sealing rubber ring of the wide port. If you are unsure, repeat the action to make sure it is done as required.

WARRANTY

Our goods come with guarantees that cannot be excluded under the Australian Consumer Law. You are entitled to a replacement or refund for a major failure and for compensation for any other reasonably foreseeable loss or damage. You are also entitled to have the goods repaired or replaced if the goods fail to be of acceptable quality and the

failure does not amount to a major failure.

The benefits of this warranty are in addition to any rights and remedies imposed by Australian State and Federal legislation that cannot be excluded. Nothing in this warranty excludes, restricts or modifies any State or Federal legislation applicable to the supply of goods which cannot be so excluded, restricted or modified.

Guarantee

We warrant that, subject to the exclusions and limitations below, the Product will be free from defects in materials and workmanship under normal domestic household use for the 12 month warranty period. The warranty period commences on the date of sale by the original retailer to the original purchaser. The warranty applies only while the Product is owned by the original purchaser.

Use of the Product in a commercial capacity will void this warranty. If a defect appears in the Product before the end of the warranty period and we find the Product to be defective in materials or workmanship, we will replace the Product with a product comparable in quality and value.

We reserve the right to change or discontinue our product ranges at any time without notice and without liability.

Exclusions

This warranty does not apply if proper care and/or usage instructions are not followed. This warranty does not cover scratches, stains, discoloration or damage caused by misuse.

How to claim

If a fault/defect is identified cease using the Product immediately. To make a claim on this guarantee, take the Product, proof of purchase and full details of the alleged defect to a Kitchen Warehouse store.

Limitations

We make no express warranties or representations other than as set out in this guarantee. The replacement of the product or the refund of the purchase price is the absolute limit of our liability under this guarantee.