

magivaac[®]

Spot Cleaner



Model: SPC450 | Batch: PR5114

Carefully read all instructions before use and save for future reference.

SAFETY INSTRUCTIONS

Read and understand this entire manual before using this product. Keep these instructions for future reference.

General Instructions:

- Use water under 40°C to clean the unit effectively.
- Avoid cleaning delicate items such as arts and crafts, fibres, or surfaces that can be easily damaged (like floors or tables).
- Do not tilt the machine if there is water in the tank, as it could spill and wet the floor.
- Empty the dirty water tank when it reaches the full line to prevent overflow.
- Ensure the detergent used is safe for the items you are cleaning.
- Carpet cleaning: If used on a long-haired carpet, the machine may stop due to a blocked air outlet. Stop the machine if excess foam or dirty water escapes, and empty the dirty water tank before continuing.
- Do not use foam detergents.
- Supervise users who need assistance (including children) when they operate the machine.
- Do not use the machine with liquids such as pesticides, hair dyes, or lubricants.
- Do not pick up flammable objects, hot liquids, or dry dust.
- Inspect the hose for damage before use. Avoid bending, stepping on, or pulling the hose forcefully.
- Do not block the air outlet, as this affects heat dissipation.
- Stop using the machine immediately if you hear unusual noises or detect strange smells.
- Do not disassemble or repair the machine yourself.
- Avoid using the machine in heavy wind or rain.
- Do not immerse the machine in water or any liquid to avoid fire or electric shock.

- Do not pick up hazardous dust that may pose a health risk.
- Ensure the dirty water tank is in place before use.
- If the power cord is damaged, it must be replaced by the manufacturer or a qualified professional to avoid a hazard.

Safety Guidelines:

- This appliance can be used by children aged 8 and above and by persons with reduced physical, sensory, or mental capabilities if they are supervised or instructed on safe use. Children should not play with the appliance. Cleaning and maintenance should not be done by children without supervision.
- The appliance operates at either 50Hz or 60Hz, and the frequency does not need adjustment.
- This machine is primarily for wet use and should not be used to pick up large amounts of dust.
- If the temperature is very low, dry the dirty & clean water tanks and hose to prevent freezing.
- Clear any blockages in the hose before using it again.

Power Cord and Plug Usage:

- Clean the plug regularly.
- Ensure the plug is inserted properly when using the machine.
- Unplug the machine when not in use for extended periods or before performing maintenance, checks, or moving it.
- Never plug in or unplug the machine with wet hands.
- Keep the plug away from children.
- Do not damage the power cord. Avoid

pulling the plug violently when moving the machine.

- Do not use the machine if the power cord or plug is damaged.
- Do not use an overloaded socket.
- If any issues occur, disconnect the power and unplug the machine immediately.

Do Not Pick Up the Following:

- Dry dust
- Large amounts of powder
- Large amounts of sand or stones
- Large amounts of rubbish
- Metal objects such as needles or pins
- Large plastic bags or stockings
- Items that could clog the machine

Caution:

Use only for cleaning; do not use the machine for any other purpose.

This machine is for household use only.

Keep away from fire or heating equipment.

Stop using the machine if the water spray nozzle becomes blocked.

Stop using the machine if foreign objects are sucked in.

Empty the tanks and clear any blockages before resuming use.

Do not tilt or ride on the machine.

Keep out of reach of children and do not allow them to use it.

Not for outdoor use.

Do not continue using the machine if the suction inlet is blocked.

Model	SPC450
Rated Power	600W
Suction	up to 15KPa
Clean Water Tank	1500ml
Dirty Water Tank	800ml

PRODUCT OVERVIEW

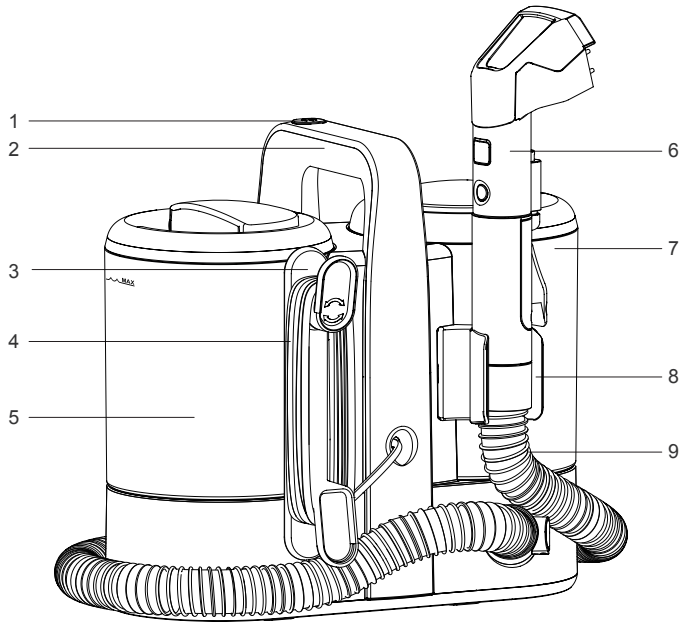

6

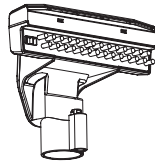

10

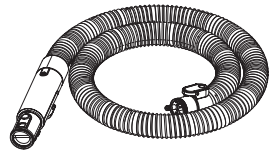

9



11



8

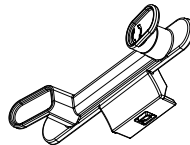

3

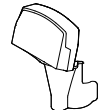

12

1. Switch 2. Handle 3. Power cord hook 4. Power Cord 5. Clean water tank
6. Small brush 7. Dirty water tank 8. Brush hook 9. Hose 10. Big brush
11. Hose hook 12. Self-cleaning brush attachment

PREPARATIONS BEFORE USE

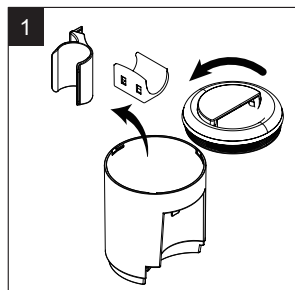

1 Open the clean water tank by turning the cover anticlockwise and remove the accessories.

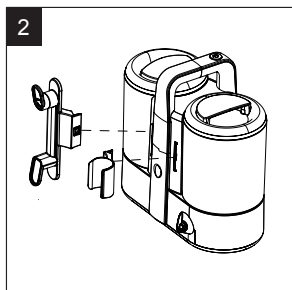

2 Insert the handle and cable hook into the machine securely.

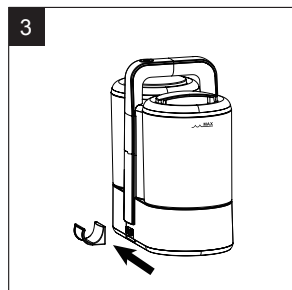

3 Position the hose hook correctly and push it from right to left. You will hear a locking sound when it's fixed properly.

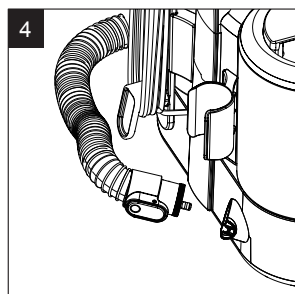

4 Insert the hose into the machine, ensuring the lock tab is securely fastened.

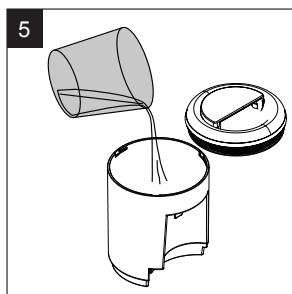

5 Fill the clean water tank with the appropriate amount of water. **WARNING: Do not exceed the maximum water level line.**

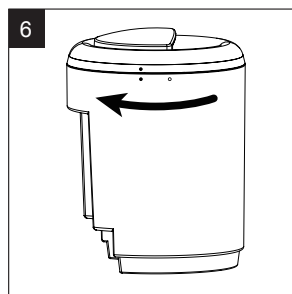

6 Close the tank cover by aligning the solid circle with the hollow circle, then rotate it clockwise until you hear a locking sound, and insert it back into the machine.

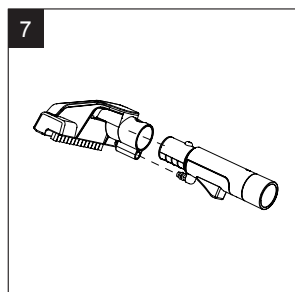

7 Assemble the brush according to your preference.

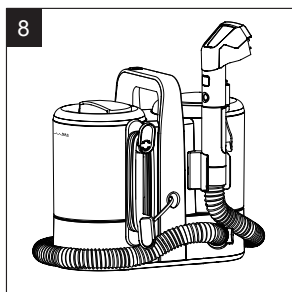

8 Wrap the hose around the base and secure it with the hook.

USING THE SPOT CLEANER

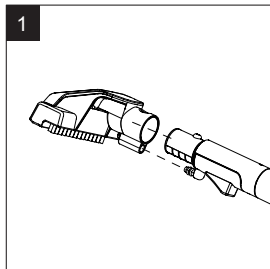

Select the appropriate brush for the flooring or surface, and attach it to the hose handle.

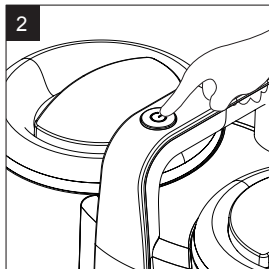

Plug in the power cord and press the ON/OFF button to start.

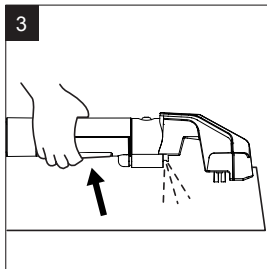

Press the water-spray button to spray water onto the surface.

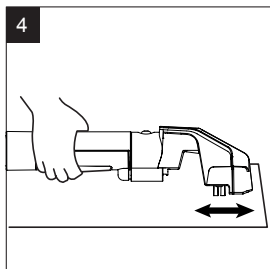

Brush back and forth to clean stains.

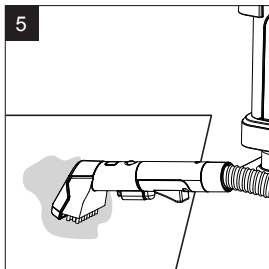

For spills, always remove excess liquid before applying water or cleaning solution.

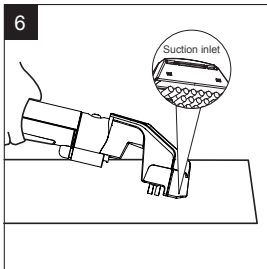

Press the brush over the stained area to suck up all the dirty water.

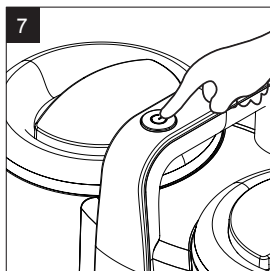

Turn off the machine after cleaning. Wrap the hose around the base and secure it with the hook.

Notice: Clean the dirty water tank after every use to prevent unpleasant odours.

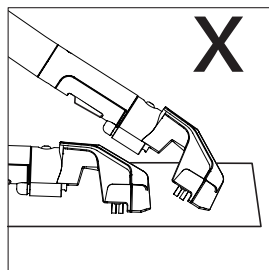
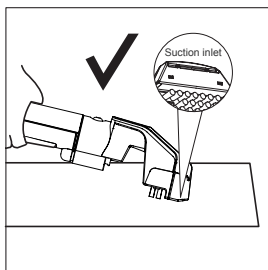

IMPORTANT: Over-tilting or under-tilting the hand tool may result in poor water suction.

TO CLEAN STUBBORN STAINS

Use fabric detergent to clean stubborn stains. Mix water and detergent in the correct proportion and fill the clean water tank up to the full line. Then, install the clean water tank back onto the machine.

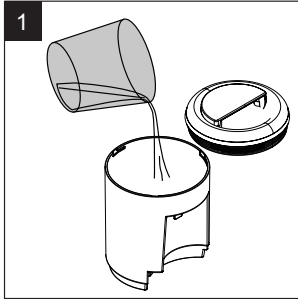

Open the clean water tank and fill with water.

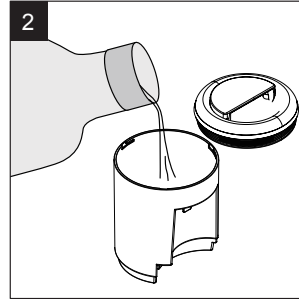

Add the detergent.

CLEANING AND MAINTENANCE

To prolong the life of your spot and stain cleaner and prevent blockages or other issues, follow this guide:

- Always clean the unit after it has been switched off for a short period.
- **CAUTION:** Never clean the cleaner or any of its parts while it is plugged into a power outlet.
- Wipe the appliance with a damp soft cloth to keep the exterior free of dirt and dust. Use a dry cloth to clean the power cord.
- To prevent unpleasant damp smells, clean both tanks and ensure they are completely air-dried before storing and after every use.

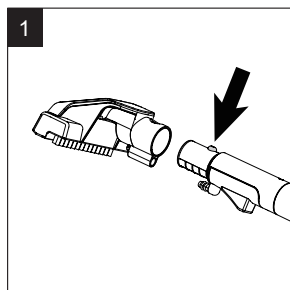

Press the wash tool release button and pull to remove the tool from the hose.

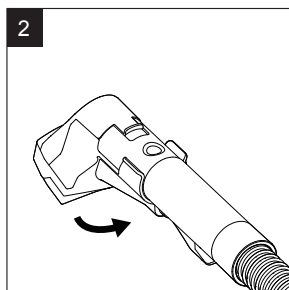

Ensure the clean water tank has enough water. Insert the self-cleaning part into the handle, start the machine, and press the water spray button.

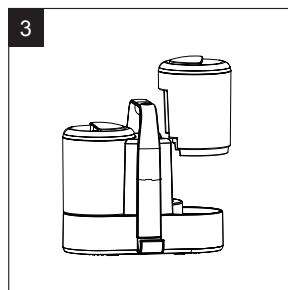

Remove the clean water tank from the main cleaner.

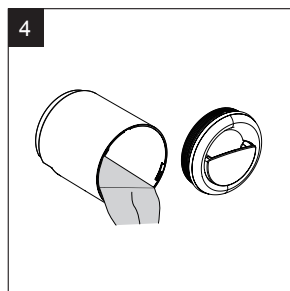

Pour out the water from the tank.

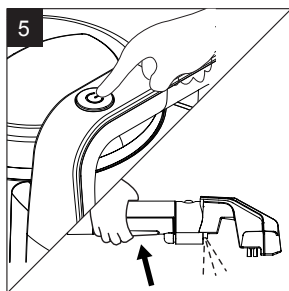

Re-install the empty clean water tank, power on the machine, and press the water spray button to remove any excess water from the tank.

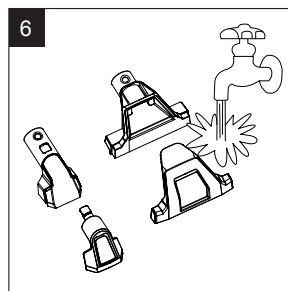

Remove the wash tool brush cover and rinse it under the tap. To replace, align the cover with the wash tool and press it until it clicks into place.

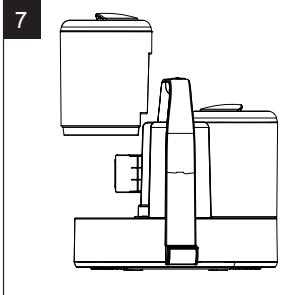

7 Remove the dirty water tank from the main cleaner.

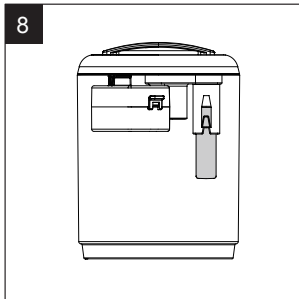

8 Empty the dirty water tank after every use, or when the water level reaches the maximum fill line. The float inside will prevent suction if the tank is full.

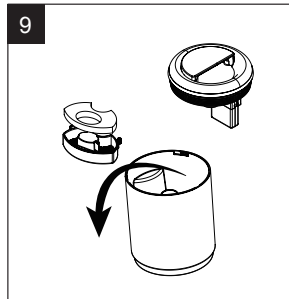

9 Open the dirty water tank and remove the cover and filter.

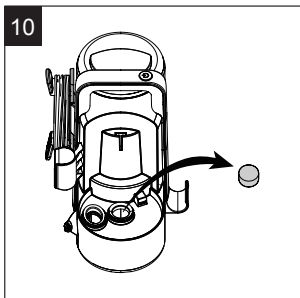

10 Remove the small foam filter and rinse it under the tap. Ensure it is fully dry before replacing it in the appliance.
TIP: Place it near a radiator to dry quickly.



11 Clean all parts with warm water only. Do not use washing-up liquids or other chemicals.

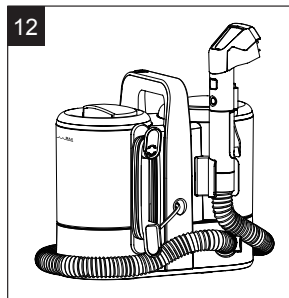

12 Reinstall the dirty water tank back into the cleaner.

TROUBLESHOOTING

If the device isn't working properly, try to fix the problem using the steps below. If the issue persists, contact customer service. Never attempt to repair an electrical device yourself.

Problem	Cause	Solution
Cleaner not working after turning on	The plug isn't plugged in properly	Turn it off and try to plug in again
	The cord is damaged	
No water comes out or little water comes out after pressing the water-spray button	Spray water opening is blocked	Try cleaning the brush, especially around the opening
	The handle or the pump is damaged	
No suction or weak suction power	The machine is not turned on	Turn on the power.
	The dirty water tank is full	Clean the dirty water tank.
	The hose is damaged	Check the hose.
	The filter is blocked	Clean the filter.

LENOXX

www.lenoxx.com.au



1300 666 848



LenoxxElectronics



LenoxxElectronics

service@lenoxx.com.au