

WOLSTEAD

Crystal Ice Maker 12Kg

Owner's Manual



IMPORTANT:

This instruction manual contains important information necessary for the proper assembly and safe use of the appliance.

Read and follow all warnings and instructions before assembling and using the appliance. Keep this manual for future reference.

WOLSTEAD Crystal Ice Maker 12Kg 633664

SPECIFICATIONS

Power supply: 220-240V ac 50/60Hz

Power consumption: 130W

Bullet ice size: 25 × 30mm

Water tank capacity: 1.3L

Ice storage capacity: 60 pcs

PRODUCT FEATURES

1. Makes nine bullet shaped ice cubes every nine minutes.
2. 12 kilograms every 24 hours.
3. Two ice modes: Crystal clear and normal.
4. Compact and portable design.
5. Automatic cleaning function.
6. Quiet operation.
7. Transparent lid to monitor progress and water level.
8. Includes an ice scoop for easy serving.
9. Makes 25mm x 30mm bullet ice cubes.
10. Removable ice basket.
11. Removable silicone plug to drain water.

SAFETY PRECAUTIONS

When using this electrical appliance, basic safety precautions should always be followed to reduce the risk of fire, electric shock, and/or injury, including the following:

1. Read all instructions before using.
2. Do not upend this product or incline it over a 10° angle.
3. Remove all packaging and carefully check your ice maker to ensure it is in good condition and that there's no damage to the appliance or power cord and plug.
4. If the supply cord is damaged, it must be replaced by the manufacturer or its service agent or a similarly qualified person in order to avoid a hazard.
5. Before using the ice maker for the first time, please wait two hours after positioning it, and keep the transparent lid open for at least two hours.
6. We recommend you use filtered water when using the crystal ice mode.
7. Ensure the voltage is compliant with the voltage range stated on the rating label, and ensure the earthing of the socket is in good condition.
8. To protect against risk of electric shock, do not pour water on the cord or ventilation openings, or immerse the appliance in water or any other liquid.
9. Unplug the appliance after using and before cleaning.
10. Keep the appliance 30cm from the wall and other objects to ensure good ventilation.

11. When positioning the appliance, ensure the supply cord is not trapped or damaged.
12. Only use the appliance with the included accessories.
13. This appliance is not intended for use by persons (including children) with reduced physical, sensory or mental capabilities, or lack of experience and knowledge, unless they have been given supervision or instruction concerning use of the appliance by a person responsible for their safety. Children should be supervised to ensure that they do not play with the appliance.
14. Do not use the appliance close to flames, hot plates or stoves.
15. Do not turn the power on and off again repeatedly (ensure five minute intervals between switching on and off), to avoid damaging the compressor.
16. Never clean with scouring powders or hard implements.
17. **Warning:** Do not store explosive substances such as aerosol cans with a flammable propellant in this appliance.
18. This appliance is intended to be used in household and similar applications such as
 - a. staff kitchen areas in shops, offices and other working environments;
 - b. farmhouses and by clients in hotels, motels and other residential type environments;
 - c. bed and breakfast type environments;
 - d. catering and similar non-retail applications.
19. Do not locate multiple portable socket-outlets or portable power supplies at the rear of the appliance.
20. The refrigerant and insulation blowing gas is flammable, when disposing of the appliance, do so only at an authorised waste disposal centre. Do not expose yourself to flame.
21. Do not use outdoors.

Warning

- Do not obstruct ventilation openings.
- Do not use mechanical devices or other means to accelerate the defrosting process, other than those recommended by the manufacturer.
- Do not damage the refrigerant circuit.
- When disposing of the appliance, do so only at an authorised waste disposal centre.
- It is normal for the compressor and condenser surface to reach temperatures between 70°C and 90°C during operation and surrounding areas may be very hot.
- Due to fast freezing, ice cubes may appear 'cloudy'. This is air trapped in the water and will not affect the quality or taste of ice.

Caution: Risk of fire



The refrigerant isobutene (R600a) is contained within the refrigerant circuit of the appliance, a natural gas with a high level of environmental compatibility, which is nevertheless flammable. During transportation and installation of the appliance, ensure that none of the components of the refrigerant circuit become damaged. The refrigerant (R600a) is flammable.

If the refrigerant circuit is damaged:

- Avoid open flames and sources of ignition.
- Thoroughly ventilate the room in which the appliance is situated.

GET TO KNOW THE WOLSTEAD CRYSTAL ICE MAKER

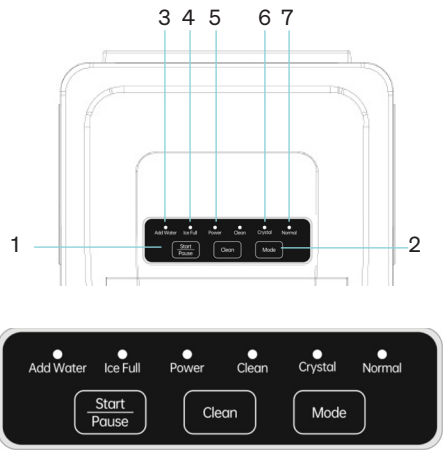
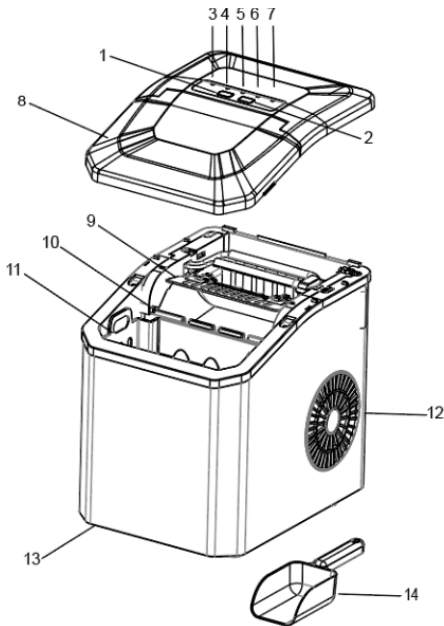

1. ON/OFF switch
2. Select: To select crystal ice or normal ice
3. Add water light
4. Ice full light
5. Power light
6. Transparent ice light
7. Normal ice light
8. Top lid
9. Ice shovel board
10. Infrared sensor: When ice reaches the height of the sensor, the ice full light will be on.
11. Ice basket
12. Air vent: Keep 30cm distance from other products
13. Water drain: Take out the plug to drain the water
14. Ice scoop

BEFORE FIRST USE

1. During transportation, the incline angle of the appliance should not be over 45°. Do not turn the appliance upside down as this may damage the compressor and sealed system.
2. Remove all packing material and check your appliance to ensure it is in good condition.
3. The appliance should be placed horizontally on a level surface. To ensure proper ventilation, position it 30cm away from the wall and other appliances and objects.
4. Do not install the appliance near an oven, radiator, or any other heat source.
5. Before using the appliance for the first time, please wait two hours after positioning it, and keep the front lid open for at least two hours.
6. Make sure the silicone stopper is well inserted before first use.

OPERATING INSTRUCTIONS

1. Open the lid and fill the water reservoir with water. Make sure the water level in the water reservoir is not above the MAX fill line. Note: If you are using the crystal mode, for best results we recommend using filtered water as the transparency of the ice can be affected by water hardness levels in tap water.
2. Connect to the power. The POWER light will flash.
3. Press the START/PAUSE button to turn the unit on. To start making ice, press MODE and select crystal or normal mode. The cycle will start automatically.
4. Each ice making cycle lasts for six to 13 minutes, depending on ice size, environmental temperature and water temperature.
5. The water level needs to be checked regularly, if the pump can not get water, the ice maker will stop, and the ADD WATER light will come on. Refill the water, and press START/PAUSE to restart the machine.
6. When the ice basket is full, the red ICE FULL light will come on, and the machine will stop automatically. Remove some of the ice cubes. When the ice level falls below the detection of the infrared sensor, the machine will restart. (Note: Do not expose the machine to strong sunlight, as it may affect the infrared sensor).
7. Change the water every 24 hours to make sure it remains fresh and clean, and drain the water if the machine will not be used for some time.
8. To run the automatic cleaning cycle, turn the power on and press CLEAN. The cycle will begin and will run for 20 minutes before stopping automatically. The power light and the clean light will remain on during the cleaning cycle.

CARE AND MAINTENANCE

1. Clean the inner ice basket, water tank, ice shovel and evaporator frequently. When cleaning, unplug the appliance, remove the ice cubes and empty the water reservoir using the silicone plug underneath the machine.
2. Use a diluted solution of water and vinegar to clean the inside and the outside surface of the ice maker. Do not spray the ice maker with chemicals or diluted agents such as acids, gasoline or oil. Rinse thoroughly before using the appliance again.
3. Do not use mechanical devices or other means to accelerate the defrosting process.
4. Always use fresh water before starting ice production either at initial installation or after a long shut-off period. Filtered water is recommended if you are using the crystal ice mode.
5. Before storing the ice maker when not in use, run the automatic cleaning function, then empty the water reservoir and dry the appliance thoroughly both inside and out to prevent mould.

AUTO CLEAN FUNCTION

In the auto cleaning cycle, the water will run through the whole system, mimicking the ice making function, and then go back to the water tank. The cycle runs for 20 minutes before stopping automatically. Drain the water via the plug on the bottom of the ice maker after the cleaning function has finished.

Note: The compressor will not work in the cleaning function.

TROUBLESHOOTING

Problem	Possible Cause	Suggested Solution
ICE FULL light on	Too many ice cubes in the basket	Take some ice cubes out
	Sensor affected by strong sunlight	Reposition the machine out of direct sunlight
ICE FULL light flashes	Ice shovel board jammed	Removed jammed ice
Ice is stuck	Ice making cycle too long	Stop the machine. After ice melts, restart the machine
	Water temperature is too low	Better with water at 8 to 32°C
Ice maker is not making any ice	Environment temperature too high	Use machine in a location under 32°C
	Water temperature too high	Add some cold water
	Cooling system jammed	Contact Kitchen Warehouse Customer Service
The compressor works abnormally with a buzzing noise	The voltage is lower than recommended	Stop the ice maker and do not restart until the voltage is normal
	The compressor is damaged during transportation	Stop right away, and keep it on a flat surface for 24 hours, then restart
ADD WATER indicator lights up	There is not enough water	Fill water to the MAX line, then press the start button to restart
	The pump is blocked	Clean the water pump after removing it
	The pump is broken	Contact Kitchen Warehouse Customer Service
	The filter in the water cabinet is jammed	Clean the cabinet
Indicator lights on display are not on	No power	Turn power on

WARRANTY

90 day money back guarantee

We promise you a full refund within 90 days if your Wolstead product does not fulfil your expectations. This guarantee applies to qualified purchases of all Wolstead branded products from participating stockists online and in-store from eligible delivery locations. The qualified product must be returned within 90 days from the date of purchase. We shall issue a full refund when the customer presents proof of purchase. We shall issue a store credit when proof of purchase is unavailable. The product packaging is not required to avail of the refund. The amount refunded will be the price of the products in the currency shown on the proof of purchase.

Warranty

Our goods come with guarantees that cannot be excluded under the Australian Consumer Law. You are entitled to a replacement or refund for a major failure and for compensation for any other reasonably foreseeable loss or damage. You are also entitled to have the goods repaired or replaced if the goods fail to be of acceptable quality and the failure does not amount to a major failure.

The benefits of this warranty are in addition to any rights and remedies imposed by Australian State and Federal legislation that cannot be excluded. Nothing in this warranty excludes, restricts or modifies any State or Federal legislation applicable to the supply of goods which cannot be so excluded, restricted or modified.

Guarantee

We warrant that, subject to the exclusions and limitations below, the Product will be free from defects in materials and workmanship under normal domestic household use for the 12 month warranty period. The warranty period commences on the date of sale by the original retailer to the original purchaser. The warranty applies only while the Product is owned by the original purchaser.

Use of the Product in a commercial capacity will void this warranty. If a defect appears in the Product before the end of the warranty period and we find the Product to be defective in materials or workmanship, we will replace the Product with a product comparable in quality and value.

We reserve the right to change or discontinue our product ranges at any time without notice and without liability.

Exclusions

This warranty does not apply if proper care and/or usage instructions are not followed. This warranty does not cover scratches, stains, discoloration or damage caused by misuse.

How to claim

If a fault/defect is identified cease using the Product immediately. To make a claim on this guarantee, take the Product, proof of purchase and full details of the alleged defect to a Kitchen Warehouse store.

Limitations

We make no express warranties or representations other than as set out in this guarantee. The replacement of the Product or the refund of the purchase price is the absolute limit of our liability under this guarantee.