

WOLSTEAD

Prime Waffle and Jaffle Maker

Owner's Manual



IMPORTANT:

Read and follow all warnings and instructions before assembly and use.
Keep this manual for future reference.

SPECIFICATIONS

- Model number: 678903
- Voltage: 220-240V ~ 50/60Hz
- Wattage: 1000W

PRODUCT FEATURES

Double the delight with the Wolstead Prime Waffle and Jaffle Maker, your all-in-one solution for golden waffles and crispy jaffles at home. With removable, magnetic plates for both, it's easy to switch between breakfast favourites in seconds. Choose from five preset waffle programs, including Belgian, classic, custom, chocolate and buttermilk, plus five adjustable browning levels for perfect results every time.

- Features two sets of removable plates to make waffles and jaffles
- Five preset waffle programs: Belgian, classic, custom, chocolate and buttermilk
- Five adjustable browning controls
- Magnetic plates feature Ceramax™ non-stick ceramic coating so food releases easily, no oil, no fuss
- LCD control panel and digital display let you monitor time and temperature with precision
- Wide moat around the edge of the plates catches overflow

CERAMAX NON-STICK COATING

The magnetic waffle and jaffle plates feature a hard, durable, ceramic non-stick coating called Ceramax™ which is more environmentally friendly than traditional non-stick. Ceramax™ is thermo-resistant, easy to clean, and free from lead, cadmium, PFOA and PFAS.

SAFETY PRECAUTIONS

When using this electrical appliance, basic safety precautions should always be followed to reduce the risk of fire, electric shock, and/or injury, including the following:

1. Read all instructions before using.
2. Ensure the voltage is compliant with the voltage range stated on the rating label.
3. If the electrical cord is damaged, it must be replaced by the manufacturer or its service agent or a similarly qualified person in order to avoid a hazard.
4. This appliance is not intended for use by persons (including children) with reduced physical, sensory or mental capabilities, or lack of experience and knowledge, unless they have been given supervision or instruction concerning use of the appliance by a person responsible for their safety.
5. Children should be supervised to ensure that they do not play with the appliance.

6. This appliance is intended to be used in household and similar applications such as:
 - a. Staff kitchen areas in shops, offices and other working environments.
 - b. Farmhouses.
 - c. By clients in hotels, motels and other residential type environments.
 - d. By bed and breakfast type environments.
7. To protect against electric shock, do not place the cord, plug or the base of the appliance in water or any other liquid.
8. Do not use attachments or accessories which are not recommended by the manufacturer.
9. The product is only suitable for the purpose indicated in this manual. Do not use this product or any part for other purposes. If it is operated incorrectly, it may cause injury.
10. Always use the appliance on a firm and stable surface and keep it 30cm from other objects and the wall to ensure heat is easily released.
11. Do not place the appliance on or near a hot surface, including a gas or electric stove, or in a heated oven.
12. Do not move the appliance when in use.
13. Not suitable for use with external timers or remote controls.
14. For indoor household use only.
15. Do not place anything on top of the appliance while in operation or when storing.
16. Appliance surfaces can get hot during and after operation. To prevent burns or personal injury always use heat resistant oven mitts or gloves when opening the lid of the appliance or removing the cooking plates.
17. Allow the appliance to cool before cleaning, disassembling, putting in or taking out parts, and storing.
18. Do not operate without the waffle or jaffle plates.

GET TO KNOW THE WOLSTEAD PRIME WAFFLE AND JAFFLE MAKER



Jaffle plate



Waffle plate

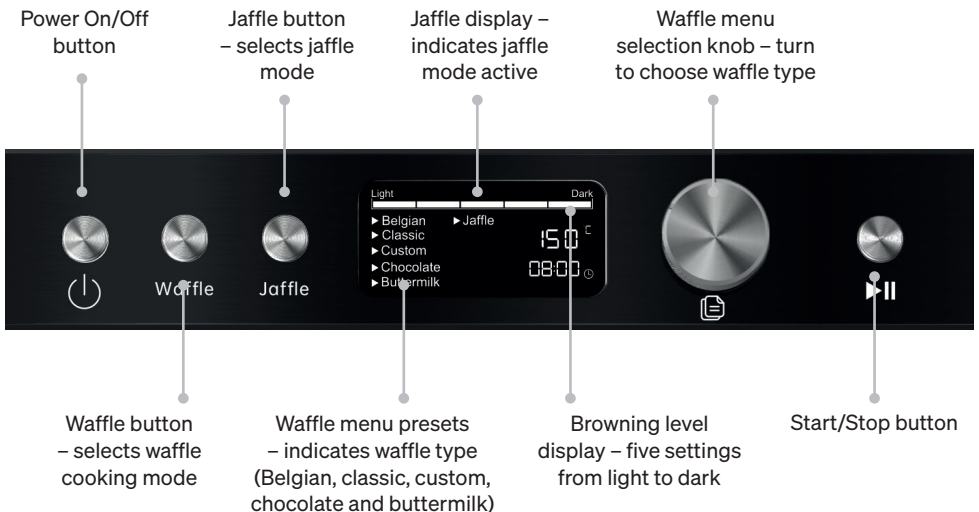

OPERATING INSTRUCTIONS

1. Remove all packaging materials, promotional labels and tapes from the appliance.
2. Remove all accessories and read this manual carefully. Pay close attention to the operation instructions, warnings and safety guidelines to avoid injury or property damage.
3. Detach and clean the waffle and jaffle plates with warm water and mild detergent. Dry thoroughly. Never wash the main unit in the dishwasher or immerse in water.
4. Insert the desired plate (waffle or jaffle) securely into place.

Tips

- Press the Start/Stop button at any time to pause or stop cooking.
- To resume, press the button again.
- The unit will automatically shut off after 15 minutes of inactivity.
- Keep the lid closed during preheating to speed up the process.
- Always use the handle to open/close the lid.
- Caution: The top housing becomes very hot during operation. Always use oven mitts or gloves to open and close the lid and to remove plates after use.

To cook waffles

1. Plug the appliance into power.
2. Insert the waffle plate.
3. Press the power button. Then press the waffle button. The waffle menu presets will display.
4. Turn the waffle menu selection knob to select the waffle type (e.g. Belgian, Classic, Custom, Chocolate, Buttermilk).
5. Press the knob to confirm your selection.
6. Rotate the knob again to set the browning level (light to dark).
7. Press the Start/Stop button. 'PRE' will appear on the display to indicate preheating.
8. When preheating is complete, the unit will beep and the display will flash.
9. Open the lid and pour batter evenly into the waffle plates and close the lid.
10. Press start again to begin cooking. The cooking time will begin counting down.
11. When done, the unit beeps five times and displays 'DONE'.
12. Note: To reset or select a different waffle menu while cooking, first press the power button to turn off the appliance. Then, press the power button twice to turn it back on and begin the selection process again.
13. To switch off the appliance or stop cooking at any time, simply press the power button. Press the power button twice to restart the appliance.

To cook jaffles

1. Plug the appliance into power.
2. Insert the jaffle plate.
3. Press the power button. Then press the 'jaffle button'.
4. Turn the knob to adjust the temperature. Press the knob to select the temperature.
5. Turn the knob to the desired time and press it once to select.
6. Press start. The display will show 'PRE' during preheating.
7. When preheating finishes, the unit will beep five times and the display will flash.
8. Open the lid, place food inside, close the lid, and press start to begin cooking.
9. The cooking time will begin counting down.
10. When done, the unit beeps five times and displays 'DONE'.
11. Cooking can be paused at any time by pressing the start/pause button.
12. To turn the appliance off or to stop the cooking process, press the power button. To turn the appliance back on, press the power button twice.

Cleaning and maintenance

Clean the appliance thoroughly after each use. Always allow it to cool down before cleaning.

1. Unplug the appliance and let it cool for at least 30 minutes before cleaning.
2. The magnetic waffle and jaffle plates are dishwasher safe.
3. Remove the plates and clean with warm soapy water or place them in the dishwasher.
4. Use a silicone or wooden scraping tool to remove any stuck on food residue from the plates.
5. Do not use metal utensils on the plates as this can damage the non-stick coating.
6. Wear oven mitts when handling hot components.
7. Wipe the outside of the appliance clean with a damp cloth. Do not submerge in water or put it in the dishwasher.

Troubleshooting

Error message	Possible solution
E1	Temp sensor open circuit. The appliance is not functioning properly. Please contact Kitchen Warehouse Customer Service for assistance.
E2	Temp sensor short circuit. The appliance is not functioning properly. Please contact Kitchen Warehouse Customer Service for assistance.

WARRANTY

Get in touch with Customer Service

If you experience any issues with your Wolstead Prime Waffle and Jaffle Maker, get in touch with our Customer Service team by email at customerservice@kitchenwarehouse.com.au or by phone on 1800 332 934 between the hours of 9am and 7pm (AEST) Monday to Friday. Alternatively you can use the Live Chat function on our website by visiting www.kitchenwarehouse.com.au/contact-us

90 day money back guarantee

We promise you a full refund within 90 days if your Wolstead product does not fulfil your expectations. This guarantee applies to qualified purchases of all Wolstead branded products from participating stockists online and in-store from eligible delivery locations. The qualified product must be returned within 90 days from the date of purchase. We shall issue a full refund when the customer presents proof of purchase. We shall issue a store credit when proof of purchase is unavailable. The product packaging is not required to avail of the refund. The amount refunded will be the price of the products in the currency shown on the proof of purchase.

Exclusions

This warranty does not apply if proper care and/or usage instructions are not followed. This warranty does not cover scratches, stains, discoloration or damage caused by misuse.

How to claim

If a fault/defect is identified cease using the Product immediately. To make a claim on this guarantee, take the Product, proof of purchase and full details of the alleged defect to any Kitchen Warehouse store.

Limitations

We make no express warranties or representations other than as set out in this guarantee. The replacement of the Product or the refund of the purchase price is the absolute limit of our liability under this guarantee.

Warranty

Our goods come with guarantees that cannot be excluded under the Australian Consumer Law. You are entitled to a replacement or refund for a major failure and for compensation for any other reasonably foreseeable loss or damage. You are also entitled to have the goods repaired or replaced if the goods fail to be of acceptable quality and the failure does not amount to a major failure.

The benefits of this warranty are in addition to any rights and remedies imposed by Australian State and Federal legislation that cannot be excluded. Nothing in this warranty excludes, restricts or modifies any State or Federal legislation applicable to the supply of goods which cannot be so excluded, restricted or modified.

Guarantee

We warrant that, subject to the exclusions and limitations below, the Product will be free from defects in materials and workmanship under normal domestic household use for the 12 month warranty period. The warranty period commences on the date of sale by the original retailer to the original purchaser. The warranty applies only while the Product is owned by the original purchaser.

Use of the Product in a commercial capacity will void this warranty. If a defect appears in the Product before the end of the warranty period and we find the Product to be defective in materials or workmanship, we will replace the Product with a product comparable in quality and value.

We reserve the right to change or discontinue our product ranges at any time without notice and without liability.

WOLSTEAD

Distributed by Kitchen Warehouse.

Wolstead is a registered trademark of Kitchen Warehouse Pty Ltd. The printed material appearing in this document and related packaging is protected by copyright.

Kitchen Warehouse Pty Ltd
1 Pensioner Guard Road
North Fremantle, WA, 6159
www.kitchenwarehouse.com.au
1800 332 934
customerservice@kitchenwarehouse.com.au