

TALO.YOU SINGLE AND TEAM WORKSTATION

TALO.YOU

- + **Can be configured for all applications:**
Single workstation, bench, and
conference, meeting or nesting tables
- + Leg frame design round or square tube
- + A-leg frame, also on castors
- + **Height adjustment:**
Height adjustment from 650 to 850 mm
Motorised height adjustment from
640 to 1300 mm
Gas lift adjustment from 680 to 1,180 mm
- + Metal cable tray/clip-down cable tray,
plastic clip-down cable tray
- + Variety of extensions and accessories
- + Wide range of desktop electrics options, cable slot
- + Optional: delivery in component form, boxed



Individual desk



Gas lift table

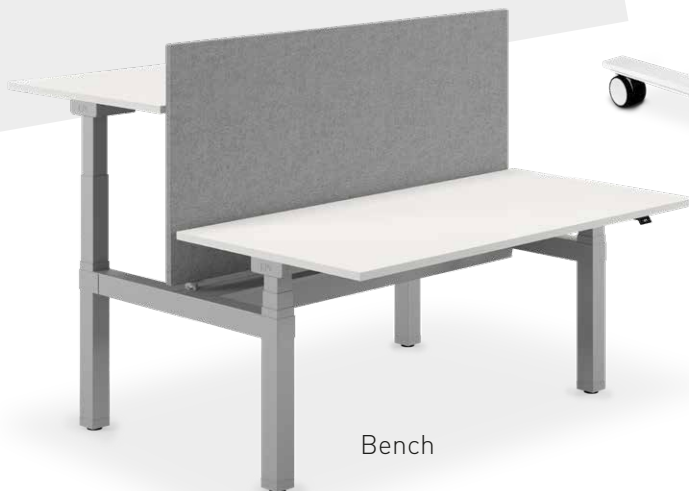

Bench



SYSTEM OVERVIEW SINGLE WORKSTATION

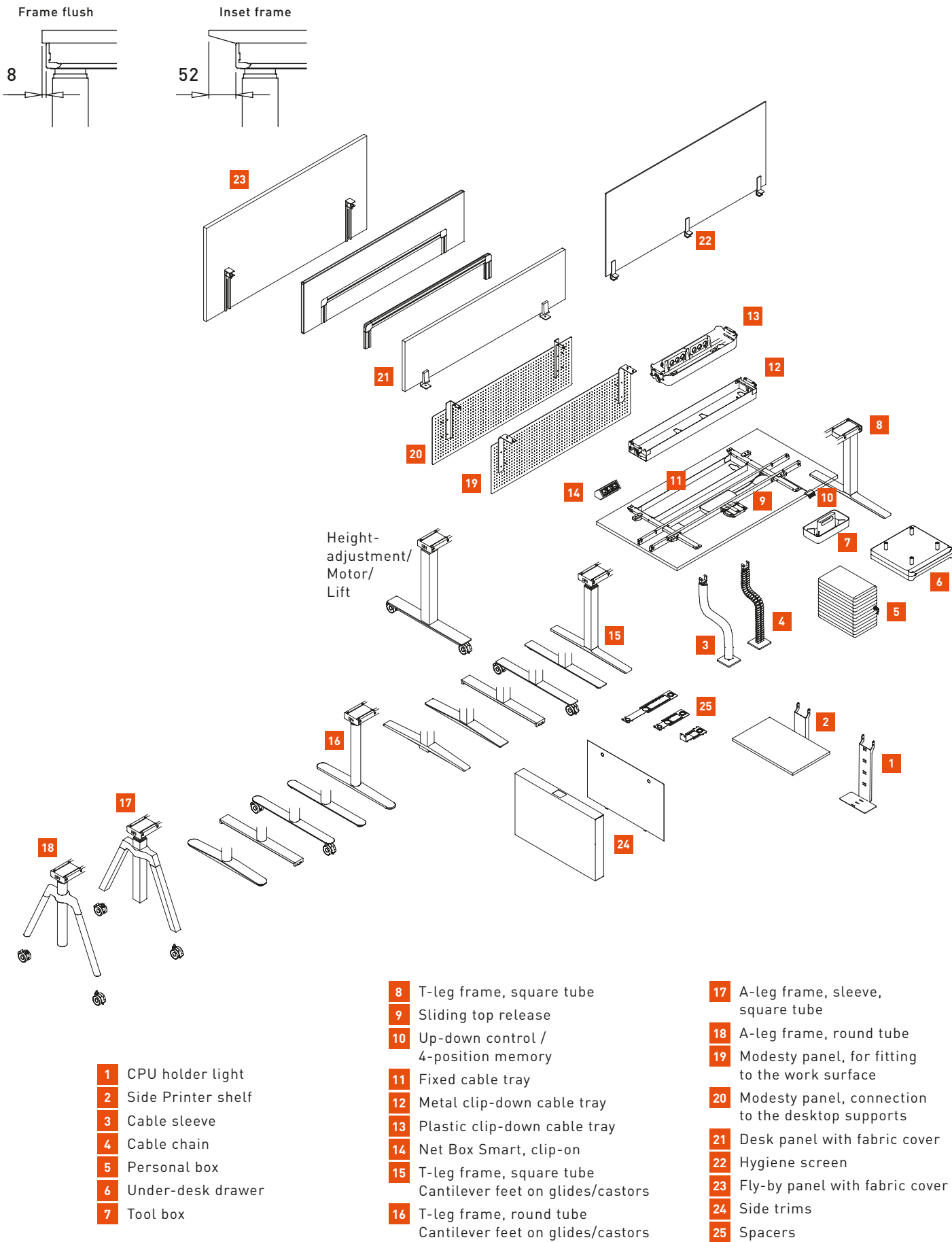

TEAM WORKSTATION

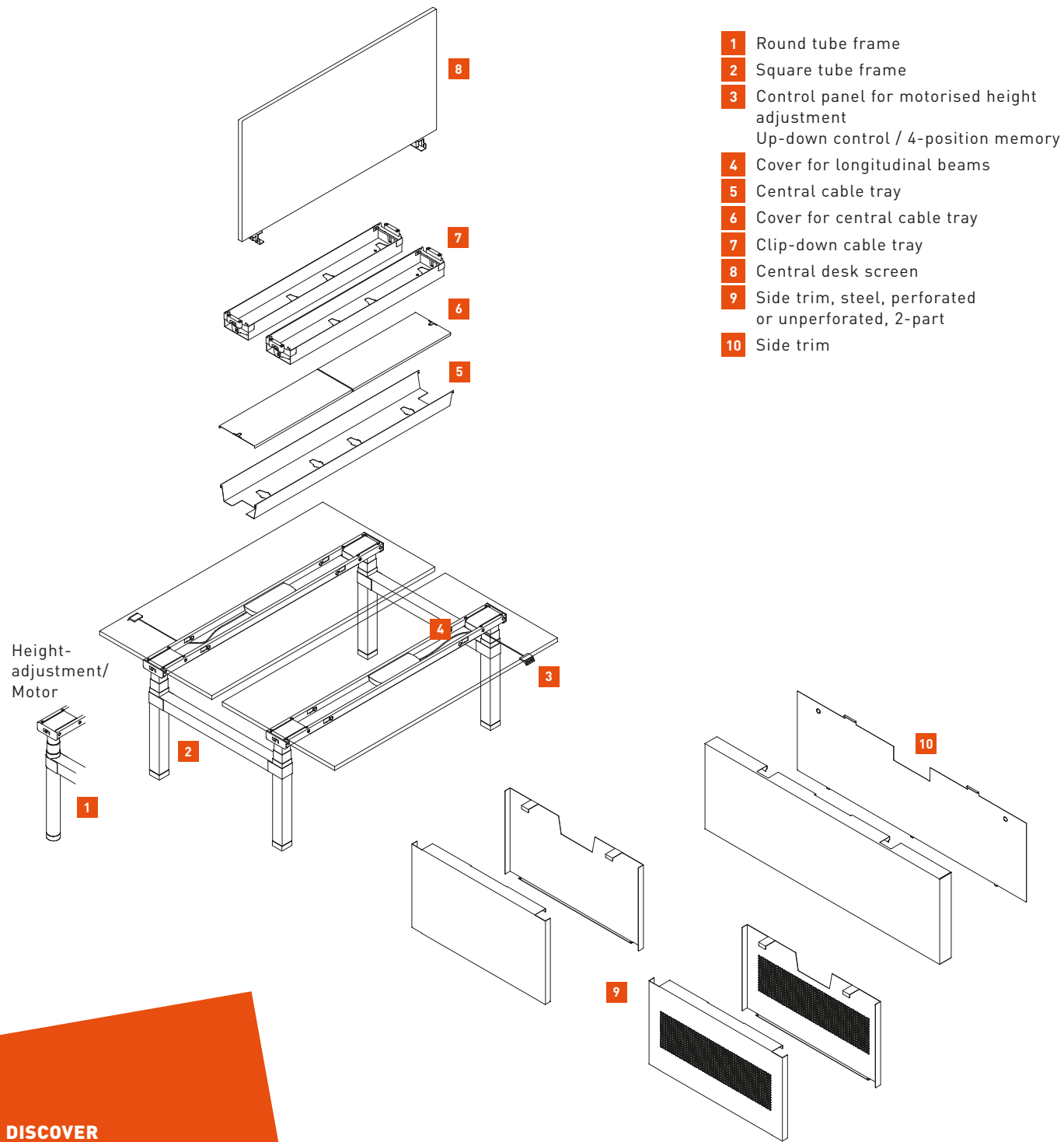

DISCOVER
more screen variants for visual and acoustic protection in our product portfolio!

TALO.YOU INFOCARD

SINGLE AND TEAM WORKSTATION



1 | FRAME DESIGN

Square/round tube leg columns are also available with an A-leg frame in steel tube or real wood.

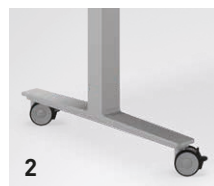
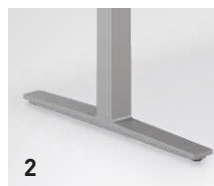

2 | FRAME TYPES

Symmetrical on glides or castors.



3 | FRAME LEGS

Square tube (70 x 70 mm), round tube (Ø 70 mm).



4 | CABLE DUCT WITH CABLE CHAIN

Houses vertical electrics for motorised and lift desks.

5 | OPERATING CONSOLE

In 2 variants for infinite motorised height adjustment.

6 | ELECTRICS CUT-OUT

With brush seal and tool rail to hold flat screen monitors. Also suitable for bench systems.

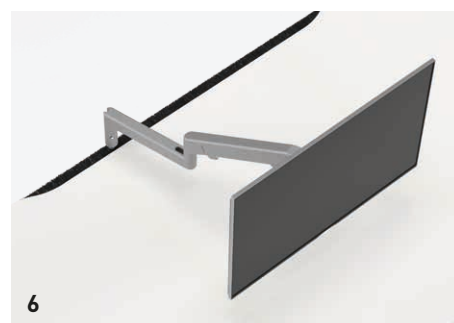

7 | CABLE TRAYS

Fixed or fold-down cable trays. Central cable trays, with or without a cover, height from floor: 420 mm, dimensions: H 100 x D 249/ 219 mm



8 | FUNCTIONAL SIDE TRIM

Optionally either perforated steel or closed to accommodate cables.



9 | UNDER-DESK DRAWER

Plastic under-desk drawer, lockable. Max. load 4 kg. Housing, black or white..



10 | TOOL BOX

Tool box with or without cup holder (for 2 cups). Plastic. Box in black or white, cups available in black or grey.



11 | STORAGE BOX

The box is mounted on the right or left under the tabletop (25 mm) using an adaptation set supplied.

	Single desk	Bench
Height adjustment		
Height-adjustable (Allen key), 650 – 850 mm	■	■
Electric motor, double telescopic action	□	□
Adjustable in height: 640 to 1,300 mm		
Gas lift, double telescopic action	□	-
Adjustable in height: 680 to 1,180 mm		
Legs/Frame		
T-leg (round and square tube)	■	-
Frame type, A-leg	■	-
Castors	■	-
Wire management		
Electrics cut-out with brush seal and tool rail	■	■
Cut-outs/adapters	□	□
Sliding top	□	□
Additional cable chains, cable ducts and clip-on cable sleeve	■	■
3rd level add-ons		
Rail	□	□
Desk screens	□	□
Fly-by screen	□	□

■ Basis □ Option