



## COMPONENT PARTS FOR AXLES

Lippert has been supplying axles and component parts to both the RV industry and the specialty axle industry since 2005. Our axle assemblies and components are traceable down to the exact production run and original lot number.



# AXLE REPLACEMENT

Replacing a trailer axle may sound intimidating, but it doesn't have to be. Whether you're replacing the axle on your full-size RV travel trailer or just a small utility trailer, these guides lay out the steps needed to complete the process from start to finish.

Scan the QR codes below for more information



A complete guide to replacing a trailer axle



How to ID your trailer axle



How to select the right trailer axle

## 2,000 lb. Wheel End Replacement Parts

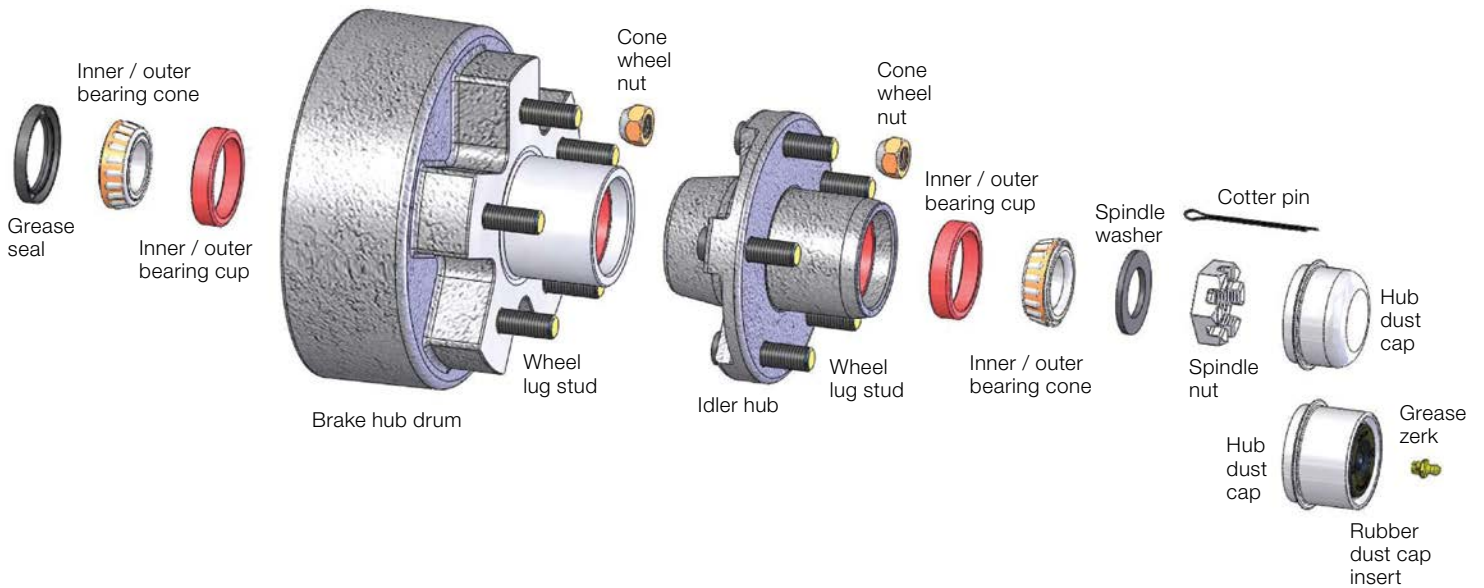

## 3,500 lb. Wheel End Replacement Parts

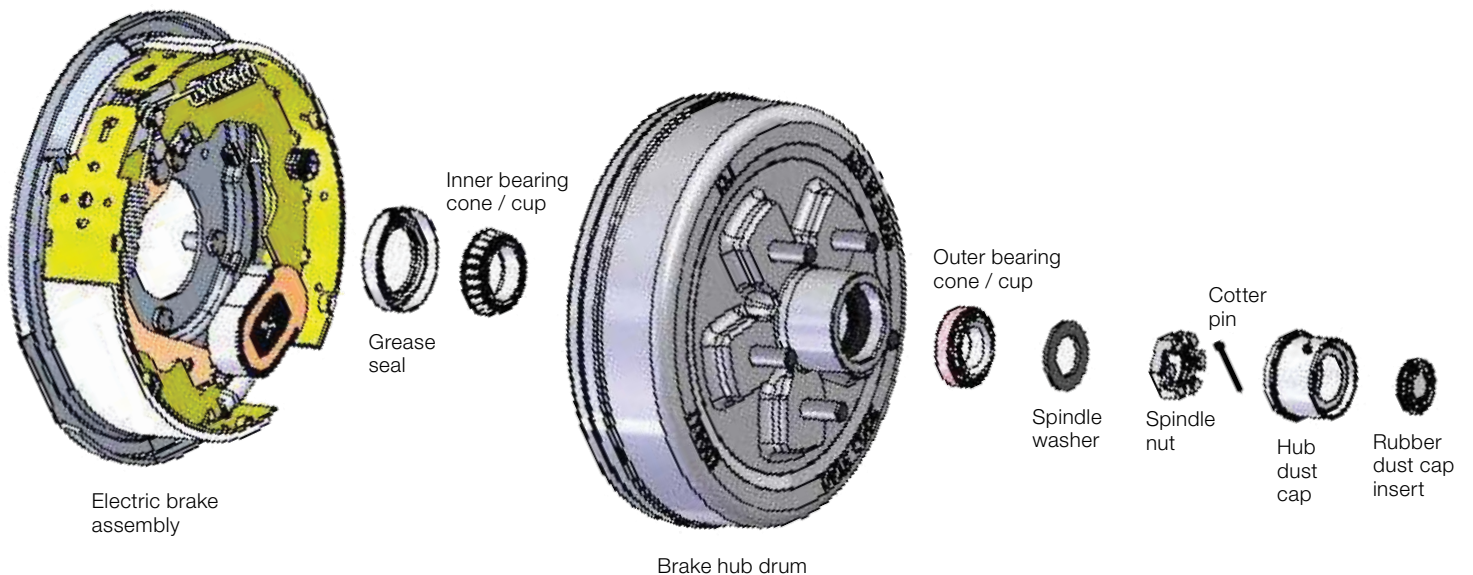

## Electric Brake Assemblies

- Replacement standard electric brake assembly with park
- Easy, do-it-yourself installation
- Available in left-hand (driver) and right-hand (passenger)
- Four-, five- and seven-bolt mounting patterns
- Hardware sold separately
- New electric drum brakes will require a break-in period to achieve full performance

## Forward Self-Adjusting Brake Assemblies

- With no actuator or hydraulic lines, installation is easier than hydraulic brakes
- Electric actuator (sold separately)
- Brakes self-adjust during every forward stop, providing up to 50% better braking distance
- Available in left-hand (road side) and right-hand (curb side) and multiple wheel sizes and axle ratings
- Helps prevent premature brake line and magnet wear for safer travels
- Lippert helps you take the guesswork out of getting your RV back on the road with exact-match parts designed for your RV



298275



298277



296649



136447

Single #	Bulk #	Brake Size	Vehicle Side	Bolt Pattern	Axle Capacity	Adjustment
<b>Electric Brake Assemblies</b>						
297956	122258* (168-piece)	10" x 2.25"	Driver / left	Four-bolt	3,500 lbs.	Manual
298274	122450L* (168-piece)	10" x 2.25"	Passenger / right	Four-bolt	3,500 lbs.	Manual
298275	122259* (126-piece)	12" x 2"	Driver / left	Five-bolt	4,000 - 7,000 lbs.	Manual
298276	122451L* (126-piece)	12" x 2"	Passenger / right	Five-bolt	4,000 - 7,000 lbs.	Manual
298277	156443* (81-piece)	12.25" x 3.38"	Driver / left	Four-bolt	8,000 lbs.	Self-adjusting
298279	156444* (81-piece)	12.25" x 3.38"	Passenger / right	Four-bolt	8,000 lbs.	Self-adjusting
181935	--	12.25" x 3.38"	Driver / left	Seven-bolt	10,000 lbs.	Self-adjusting
181936	--	12.25" x 3.38"	Passenger / right	Seven-bolt	10,000 lbs.	Self-adjusting
297998	--	12.25" x 5"	Driver / left	Seven-bolt	12,000 - 16,000 lbs.	Self-adjusting
2979981	--	12.25" x 5"	Passenger / right	Seven-bolt	12,000 - 16,000 lbs.	Self-adjusting
<b>Forward Self-Adjusting Brake Assemblies</b>						
296649	1222583*	10" x 2.25"	Driver / left	Four-bolt	3,500 lbs.	Self-adjusting
296650	1224503*	10" x 2.25"	Passenger / right	Four-bolt	3,500 lbs.	Self-adjusting
296651	1222593*	12" x 2"	Driver / left	Five-bolt	4,000 - 7,000 lbs.	Self-adjusting
296652	1224513*	12" x 2"	Passenger / right	Five-bolt	4,000 - 7,000 lbs.	Self-adjusting
<b>Brake Assembly Replacements Parts</b>						
136447	--	12" x 2"	Magnet with black lead wires, retainer clip and spring			

\* Sold in bulk quantities

## Hubs

Part #	Brake Hub Size	Bolt Pattern	Wheel Size	Stud Size	Bearing Kit #	Axle Capacity
<b>Idler Hub</b>						
134574	--	4 on 4"	8" - 12"	1/2"	--	2,200 lbs.
122098	--	5 on 4-1/2"	13" - 15"	1/2"	--	3,500 lbs.
<b>Brake Hub Drum Only</b>						
126003	10"	5 on 4-1/2"	12" - 15"	1/2"	--	3,500 lbs.
122094	12"	6 on 5-1/2"	15" - 16"	1/2"	--	6,000 lbs.
122096	12"	8 on 6-1/2"	16"	1/2"	--	7,000 lbs.
134543	12"	8 on 6-1/2"	16" - 17-1/2"	9/16"	--	7,000 lbs.
<b>Brake Hub Drum with Bearing Kit Included</b>						
814210	10"	5 on 4-1/2"	12" - 15"	1/2"	333948	3,500 lbs.
814211	12"	6 on 5-1/2"	15" - 16"	1/2"	333950	6,000 lbs.
814212	12"	8 on 6-1/2"	16"	1/2"	333951	7,000 lbs.
814213	12"	8 on 6-1/2"	16" - 17-1/2"	9/16"	333951	7,000 lbs.
<b>Brake Hub Drum Assemblies (Bearing Kit Pre-Installed &amp; Greased)</b>						
814200	10"	5 on 4-1/2"	12" - 15"	1/2"	333948	3,500 lbs.
141286	10"	6 on 5-1/2"	14" - 15"	1/2"	--	4,400 lbs.
814202	12"	6 on 5-1/2"	15" - 16"	1/2"	333950	6,000 lbs.
814203	12"	8 on 6-1/2"	16"	1/2"	333951	7,000 lbs.
148629	12"	8 on 6-1/2"	16" - 17-1/2"	9/16"	--	8,000 lbs.
814204	12"	8 on 6-1/2"	16" - 17-1/2"	9/16"	333951	7,000 lbs.
<b>Brake Drum Hubs</b>						
347627	12"	8 on 6-1/2"	17-1/2"	5/8"	--	8,000 lbs.
359552	12"	8 on 6-1/2"	17-1/2"	9/16"	--	8,000 lbs.
2772121	12-1/4"	8 on 6-1/2"	17-1/2"	5/8"	--	8,000 lbs.
2772101	12-1/4"	8 on 6-1/2"	17-1/2"	9/16"	--	8,000 lbs.
297983	12-1/4"	8 on 6-1/2"	17-1/2"	5/8"	--	12,000 lbs.
353323	12-1/4"	8 on 275mm	17-1/2"	M22	--	16,000 lbs.



134574



126003



814200

## Axle Bearing Kits

- Fits 3,500 to 7,000 lb. capacity trailer axles
- Includes all components needed to repack one axle hub: outer bearing with cotter pin, outer race, inner race, inner bearing and grease seal
- Compatible with Lippert, Dexter or AI-Ko trailer axle hubs



Part #	Outer Bearing	Outer Race	Inner Race	Inner Bearing	Axle Capacity	Includes
333948	L44649	L44610	L68111	L68149	3,500 lbs.	Grease seal and cotter pin
333949	LM67048	LM67010	25520	25580	5,200 lbs.	Grease seal and cotter pin
333950	15123	15245	25520	25580	6,000 lbs.	Grease seal and cotter pin
333951	14125A	14276	25520	25580	7,000 lbs.	Grease seal and cotter pin

## Dust Caps & Grease Seals



Part #	Two-Pack #	10-Pack #	Inside Diameter	Outside Diameter	Shaft Size	Axle Capacity
<b>Universal Rubber Insert for Lubed Dust Caps</b>						
--	--	693722	--	--	--	2,000 - 8,000 lbs.
<b>Unitized Oil Seals</b>						
276712	--	--	2.226" ID	3.391" OD	2-1/4"	5,200 - 8,000 lbs.
176692	--	--	2.875" ID	3.875" OD	2-7/8"	10,000 lbs.
295924	--	--	3.125" ID	4.500" OD	3-1/16"	12,000 - 16,000 lbs.
<b>Grease Seals</b>						
--	333960	333961	1.719" ID	2.565" OD	--	3,500 lbs.
--	333962	333963	2.25" ID	3.376" OD	--	5,200 - 8,000 lbs.
<b>Clear Plastic Oil Caps</b>						
695814	--	--	Includes rubber plug and O-ring			8,000 lbs.
693935	--	--	Includes rubber plug and O-ring			10,000 - 16,000 lbs.
<b>Aluminum Grease Caps</b>						
85373929	--	--	Includes rubber plug and O-ring			8,000 lbs.
85373829	--	--	Includes rubber plug and O-ring			10,000 - 16,000 lbs.
<b>Aluminum Oil Caps</b>						
85373928	--	--	Includes rubber plug, O-ring and fill plug			8,000 lbs.
85373828	--	--	Includes rubber plug, O-ring and fill plug			10,000 - 16,000 lbs.

## Axle Hanger

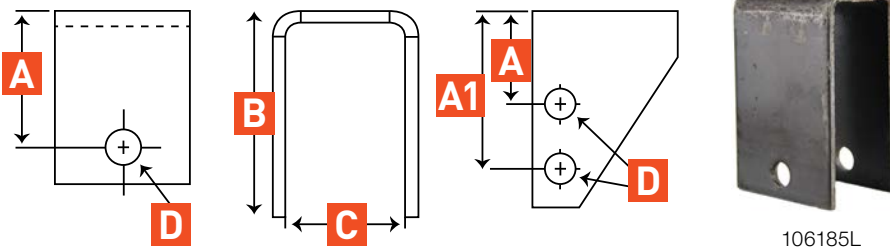

Part #	To Hole (A)	Length (B)	Width (C)	Hole Size (D)
106185L	4.25"	4.948"	2"	9/16"

## Axle Hardware



297427



297429



121803L



126238



126197



122076



134581

Part #	Description	Thread End	Length	Axle Tube	Axle Capacity
297427	Axle mounting kit - includes four U-bolts, two tie-plates and eight nuts	1/2"-20	5.1"	2.38"	3,500 lbs.
297429	Axle mounting kit - includes four U-bolts, two tie-plates and eight nuts	1/2"-20	6.5"	3"	4,400 lbs.
121803L	Wheel lug stud (.617 knurl)	1/2"-20	2"	--	--
132624	Wheel lug stud (.617 knurl)	9/16"-18	2.31"	--	--
126238	Wet bolt	7/16"-20	2.32"	--	--
126197	Wet bolt	7/16"-20	2.82"	--	--
176321	Flange wheel nut	5/8"-18	--	--	--
352303	Wheel nut	M22-1.5	--	--	--
122076	60° cone wheel nut	1/2"-20	--	--	--
134581	60° cone lug nut	9/16"-18	--	--	--

## AP Kits & Components



121098L



121097L



126171

Part #	Description	Dimensions
121097L	Tandem AP kit	33" axle spacing (EQ-104)
121098L	Tandem AP kit	33" axle spacing (EQ-310)
126171	Bronze bushing	.58" (ID) x .70 (OD) x 1.74" (L)
2020219547	Universal Tandem Axle Repair Kit	

## Axle Springs



Part #	Springs	Capacity	Industry Standard	Spring Width	Eye-to-End Of Spring Length	Loaded Length	Unloaded Eye-to-Eye Length	Loaded Arch Length
<b>Single-Eye Loaded Axle slipper Springs</b>								
710494	7	4000 lbs.	72-33	2.00"	26.88"	--	--	2.00"
176326	5	5,000 lbs.	72-80	2.5"	30.5"	--	--	2.7"
<b>Double-Eye Axle Leaf Springs</b>								
125269	4	1,400 lbs.	72-13	--	--	21"	20.5"	2.38"
124903L	4	1,750 lbs.	72-42	--	--	26"	25.5"	1.5"
702096	4	3,000 lbs.	72-26	--	--	26"	25.25"	1.75"
129745	4	2,200 lbs.	72-78	--	--	26"	25.25"	2"
702095	4	2,600 lbs.	72-97	--	--	26"	25.25"	1.75"
679372	6	3,500 lbs.	72-98	--	--	26"	24.875"	1.75"
679373	7	4,000 lbs.	72-100	--	--	26"	24.875"	1.75"
2021095282	7	4,000 lbs.	72-100	--	--	26"	24.875"	1.75"

## Shock Assemblies

- Bolt-on shock kit absorbs road shock to provide a more comfortable towing experience
- Kit comes with everything needed to attach gas shocks to existing RV or trailer suspension
- Single replacement shocks are also available



281255



281281



283280



283271

Part #	Includes	Fits	Compressed Length	Extended Length
281255	Two shock assemblies, four U-bolts, two shock mount assemblies, two tie plates, eight washers, hex nuts and hex bolts	2-3/8" axles tubes	8-5/8"	13-1/2"
281281	Two shock assemblies, four U-bolts, two shock mount assemblies, two tie plates, eight washers, hex nuts and hex bolts	3" axles tubes	8-5/8"	13-1/2"
283280	One heavy-duty yellow shock, four top plates, four rubber bushings, two nuts	All axle tube sizes	8-5/8"	13-1/2"
283271	One standard black shock, four top plates, four rubber bushings, two nuts	All axle tube sizes	7-1/2"	12"

## EQUA-FLEX® RUBBERIZED EQUALIZER

- Dramatically reduces fore to aft trailer movement, otherwise known as chucking
- Helps eliminate trailer and cargo damage caused by road shock and vibration
- Delivers a ride as smooth as torsion axles at a fraction of the cost
- Includes pre-installed bronze bushings
- Center hanger and other mounting hardware sold separately



### Standard

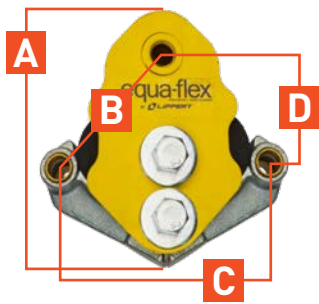

### Wide stance

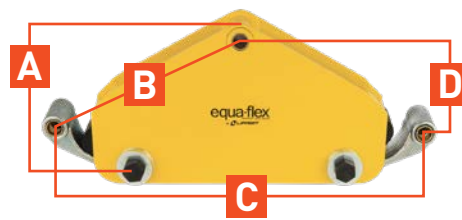

### Heavy-duty

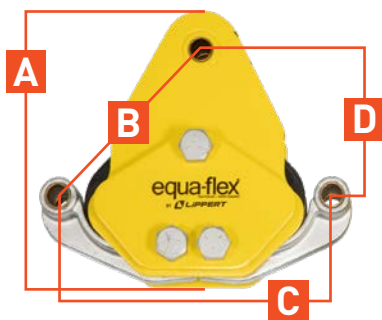

Helps eliminate trailer and cargo damage caused by road shock and vibration

Part #	Axle Configuration	A	B	C	D	E	Axle Capacity
279687	Tandem	6"	4-1/8"	5-1/2"	2-7/8"	--	4,000 lbs. - 6,000 lbs.
279688	Tandem, heavy-duty	7-1/4"	5-1/2"	7-1/4"	3-5/8"	--	6,000 lbs. - 8,000 lbs.
314336	Tandem, wide stance	6-1/2"	8-1/4"	14-5/8"	1-7/8"	--	3,500 lbs. - 5,200 lbs.
281314	Triple	6"	4-1/8"	5-1/2"	2-7/8"	6-3/4"	3,000 lbs. - 6,000 lbs.
279689	Triple, heavy-duty	7-1/4"	5-1/2"	7-1/4"	3-5/8"	8-3/8"	5,000 lbs. - 8,000 lbs.



## ROAD ARMOR™ SHOCK-ABSORBING TRAILER EQUALIZER KIT

- Using anti-shock technology, road shock and vibrations are dampened, resulting in less chucking and less strain on the trailer
- Offers RVers and trailer owners a superior suspension enhancement
- Exceptional substitution for torsion axles
- Single pivoting arm allows constant absorption and dampened road shock from the leading or trailing spring, utilizing the trailer's natural motion
- Upgraded spray-coating on all fasteners to match automotive specifications
- Mounting hardware sold separately
- Patent pending



Engineered to obtain maximum absorption with its anti-shock technology

Greaseable bronze bushings improve wear and tear

Part #	Axle Configuration	Axle Capacity	Includes
2021015191	Tandem	3,500 lbs. - 8,000 lbs.	Two tandem equalizers, greaseable bronze bushings and fasteners

## CENTER POINT® AIR RIDE RV SUSPENSION SYSTEMS

- Dampens road shock and trailer sway for a smoother, more comfortable ride
- Helps eliminate trailer and cargo damage caused by road shock and vibration
- Dampens road shock more effectively than torsion axles
- Dramatically improves braking distance in panic stops
- Includes all necessary mounting hardware for easy installation



Part #	Description	Axle Configuration
1565391	Suspension upgrade kit	Tandem
1565401	Suspension upgrade kit	Triple
293054	Air unit only	--

# LIPPERT TRAILER AXLE SOLUTIONS

Lippert axles always take you further. Our state-of-the-art robotic welders ensure the highest precision and quality on every component. Our axle assemblies and components are traceable down to the exact production run and original lot number, giving us optimum product visibility and serviceability.

## Features & Benefits

- Powder-coated tube assemblies and zinc plated hardware prevent rust and corrosion
- Waterproof connections on all electrical wiring ensures long-term electrical performance, protects connections from the elements and helps prevent corrosion
- One-piece, integrated spindle flange machining ensures consistent material for increased strength and improved brake alignment (3,500 - 16,000 lb. straight axles)
- Weld quality verified using ultrasound technology ensures proper weld location, penetration and quality
- DC electric nut runner with recordable torque readings provides consistent and accurate U-bolt torque for component traceability
- Automated and robotic spindle welding improves weld quality and consistency with hard-fixture tooling to ensure tow and camber alignment accuracy and reduced tire wear
- 100% brake adjustment during assembly ensures brakes have correct adjustment and maximum effectiveness once activated
- 100% brake continuity checks ensure all wiring and magnets are connected, live and operational
- Automated grease pack line ensures bearing and cup compatibility, seal fit, and delivers repeatable and reliable amount of grease
- Aluminum alloy, upgraded Valcrum premium oil bath caps will not crack like plastic oil caps
- Forward self-adjusting brakes for improved brake performance and consistency
- Electric, hydraulic, hydraulic free-backing and hydraulic disc brakes available

## Optional Features

- Forward self-adjusting brakes for improved brake performance and consistency (7,000 lbs. and under)
- Coated with E-coat primer to triple corrosion resistance life



## Advantages of Super Lube

- Time-saving lubrication system requires no disassembly of wheels or hubs
- Makes changing grease easier and cleaner
- Super Lube system fills the entire bearing cavity with grease, allowing for complete submersion
- Pumping new grease through zerk purges old grease for a complete repack
- Better long-term protection than standard hubs

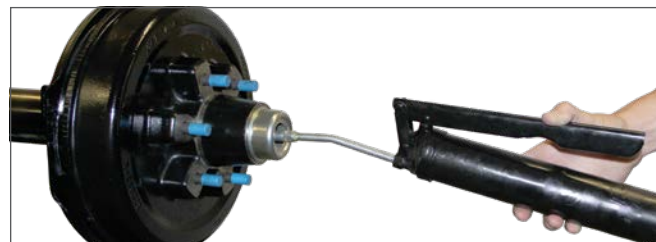

Grease cap with rubber plug allows easy access to grease zerk in axle spindle



## Torsion Axles

- Requires less maintenance than spring axles
- Rubberized torsion beam and cords absorb road shock and vibrations for a quiet, smooth ride
- Available in square and diamond orientations
- Various starting angles control trailer height
- Independent wheel suspension

## Spring Axles

- Integrated, one-piece spindle flange
- Straight or drop spindles
- Slipper or double-eye leaf spring suspension
- Standard or upgraded equalized suspension

## Axle Comparison Chart

Feature	Torsion Axles	Spring Axles
Warranty	11-year	6-year
Axle assemblies	Single, tandem	Single, tandem, triple
Axle capacity	2,000 - 12,000 lbs. (square bracket) 2,000 - 7,000 lbs. (diamond bracket)	2,000 - 16,000 lbs.
Idler axles	2,000 - 8,000 lbs.	2,000 - 8,000 lbs.
CSA certification	2,000 - 7,000 lbs.	2,000 - 7,000 lbs.
Oil bath option	7,000 - 12,000 lbs.	7,000 - 16,000 lbs.
Valcrum premium oil caps included on	8,000 - 12,000 lbs.	8,000 - 16,000 lbs.
Forward self-adjusting brakes option	3,500 - 12,000 lbs.	3,500 - 16,000 lbs.
Hutch HD suspension system option in single, tandem or triple applications	--	10,000 - 16,000 lbs.
Super lube lubrication system option	2,000 - 8,000 lbs.	Standard on 8,000 lb.



Diamond pattern torsion axle



Square pattern torsion axle