



# 9,000 BTU/H WALL MOUNTED HEAT PUMP SYSTEM

SUBMITTAL COVER SHEET

PROJECT NAME \_\_\_\_\_

LOCATION \_\_\_\_\_



ARCHITECT \_\_\_\_\_

ENGINEER \_\_\_\_\_

CONTRACTOR \_\_\_\_\_

REFERENCE \_\_\_\_\_

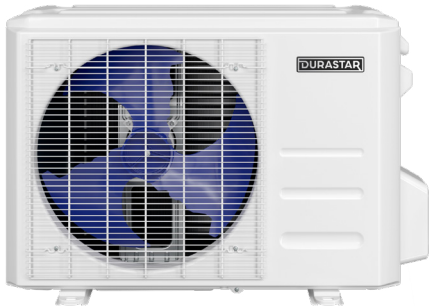
SUBMITTED BY \_\_\_\_\_ DATE \_\_\_\_\_

Indoor Unit (IDU): DRAW09F1A	Outdoor Unit (ODU): DRA1U09S1A	Wireless Remote Control
		

CAPACITIES		
Cooling Capacity (BTU/hr)	Rated <sup>1</sup>	9000
	Minimum	3600
	Maximum	10300
Heating Capacity (BTU/hr)	Rated <sup>2</sup>	9800
	Minimum	3500
	Maximum	11500

EFFICIENCY DATA	
SEER	22.8
EER	14.0
HSPF	10.5

### PRODUCT FEATURES

- Wireless Remote Control with "Follow Me" Technology
- Variable Speed Inverter Compressor
- Auto Restart
- Auto Changeover
- 24-hour Timer
- Self Clean Function

OUTDOOR TEMPERATURE OPERATION	
Cooling	-13 °F - 122 °F (-25 °C - 50 °C)
Heating	-13 °F - 86 °F (-25 °C - 30 °C)

ELECTRICAL DATA	
Voltage/Phase/Frequency	208-230V, 1 Phase, 60 Hz
Voltage Range	187-253V
Recommended Breaker (Amps)	15
Minimum Circuit Ampacity (Amps)	10
Minimum Wire Size	16 AWG
Rated Current - Cooling (Amps) <sup>1</sup>	2.9
Rated Current - Heating (Amps) <sup>2</sup>	4.2

<sup>1</sup>Measured at 95 °F.  
<sup>2</sup>Measured at 47 °F.





# 9,000 BTU/H WALL MOUNTED HEAT PUMP SYSTEM

SPECIFICATIONS

SYSTEM DATA	
Refrigerant Type	R-410A
Refrigerant Charge (oz.)	38.8
Oil Type	Ester Oil VG74
Oil Charge (oz.)	12.5 (370 ml)
Design Pressure (PSIG)	550/340

LINE SET REQUIREMENTS	
Connection Type	Flare
Liquid	Ø1/4" (Ø6.35mm)
Gas	Ø3/8" (Ø9.52mm)
Pre-Charge Length	25'
Minimum Length	10'
Maximum Length	82'
Maximum Height Differential	33'
Additional Refrigerant (oz./ft)	0.16

FAN DATA		
Indoor Unit Air Flow (CFM)	Low	141
	Medium	205
	High	265
Moisture Removal (Pints/hr)	1.46	
Drain Port O.D. / Drain Hose I.D.	Ø5/8" (Ø16mm)	

SOUND PRESSURE (dB(A))		
Indoor Unit	Low	25
	Medium	30
	High	36.5
Outdoor Unit	55	

INDOOR UNIT DIMENSIONS		
Unit Dimensions	Width	31 9/16"
	Depth	7 7/16"
	Height	11 11/16"
Carton Dimensions	Width	34 7/16"
	Depth	11 1/4"
	Height	14 15/16"
Net Weight	18.5 lbs.	
Gross Weight	24.3 lbs.	

OUTDOOR UNIT DIMENSIONS		
Unit Dimensions	Width	30 5/16"
	Depth	11 13/16"
	Height	21 7/8"
Carton Dimensions	Width	35 7/16"
	Depth	13 9/16"
	Height	23"
Net Weight	67.2 lbs.	
Gross Weight	71.7 lbs.	



# 9,000 BTU/H WALL MOUNTED HEAT PUMP SYSTEM

IDU DIMENSIONS - DRAW09F1A

## Unit Dimensions

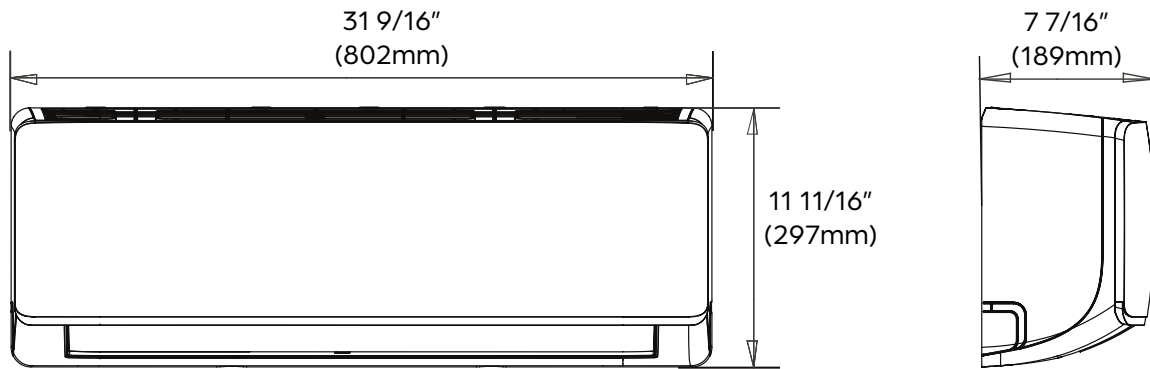

## Mounting Plate Dimensions

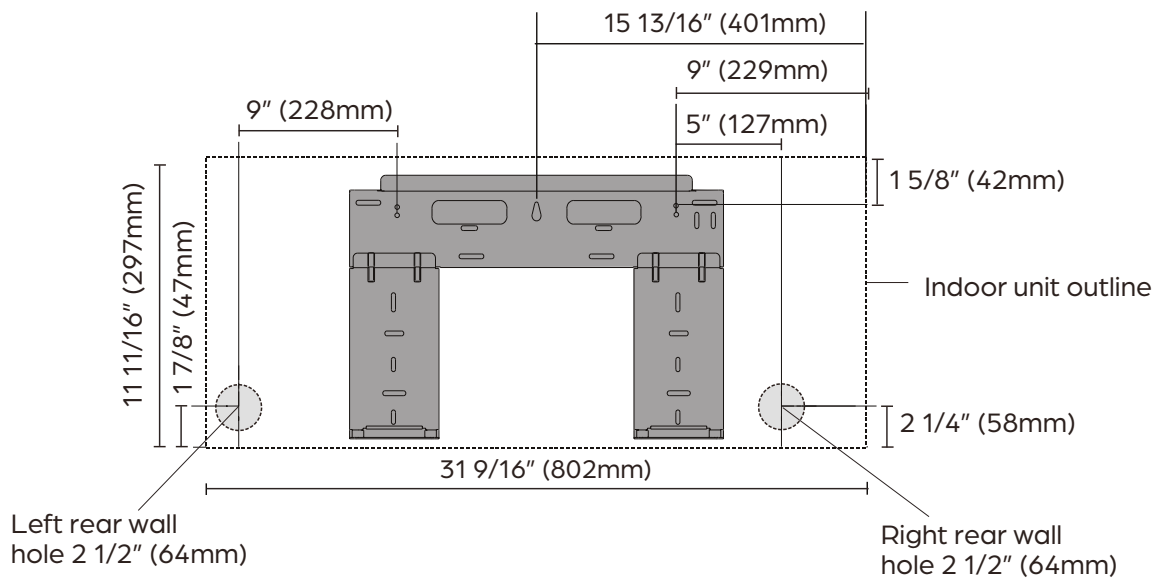

## Clearance Distances

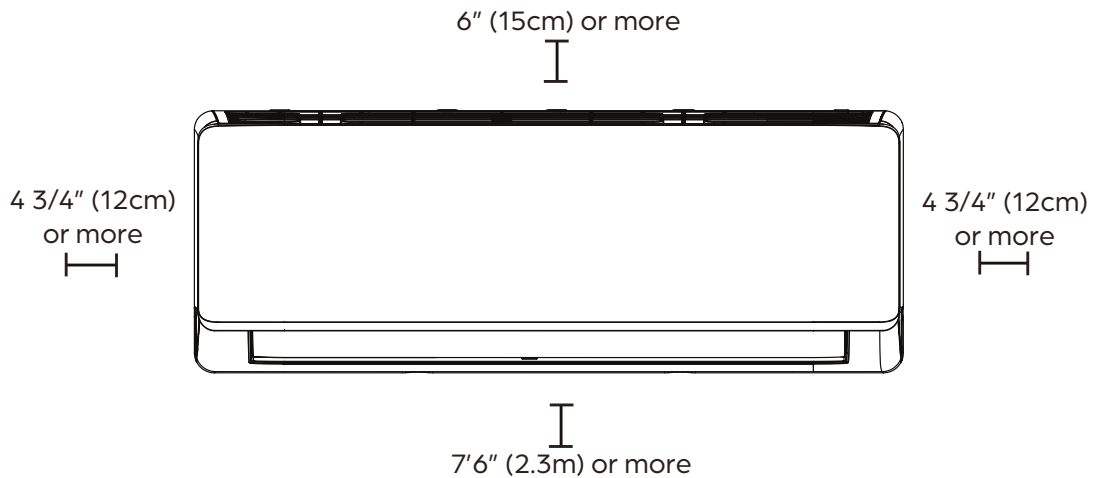



# 9,000 BTU/H WALL MOUNTED HEAT PUMP SYSTEM

ODU DIMENSIONS - DRA1U09S1A

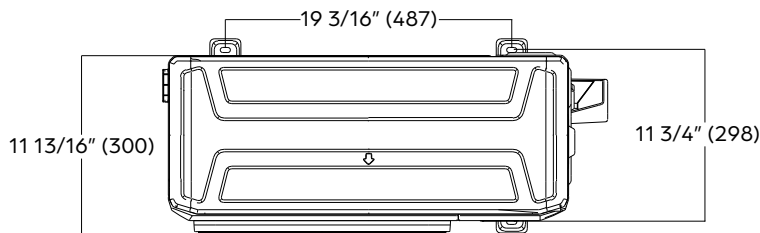
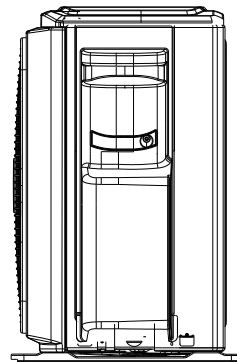
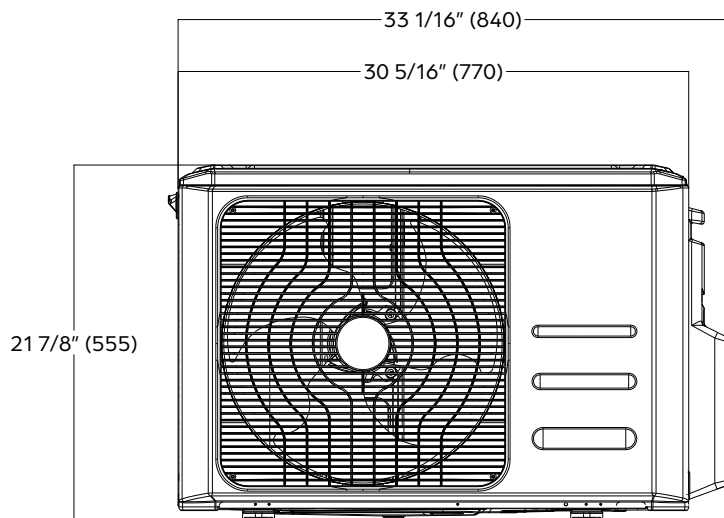
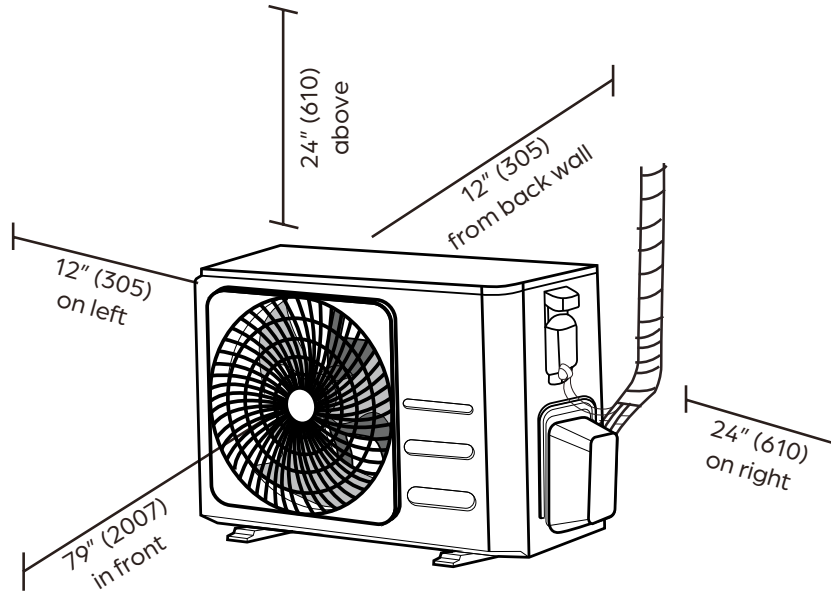

**NOTE**

Illustrations in this document are for explanatory purposes. The actual shape of your mini-split equipment may vary slightly.