



# 18,000 BTU/H WALL MOUNTED HEAT PUMP SYSTEM

SUBMITTAL COVER SHEET

PROJECT NAME \_\_\_\_\_

LOCATION \_\_\_\_\_



ARCHITECT \_\_\_\_\_

ENGINEER \_\_\_\_\_

CONTRACTOR \_\_\_\_\_

REFERENCE \_\_\_\_\_

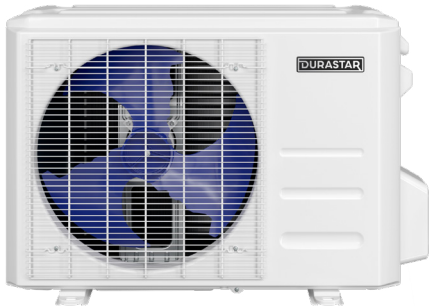
SUBMITTED BY \_\_\_\_\_ DATE \_\_\_\_\_

Indoor Unit (IDU): DRAW18F1A	Outdoor Unit (ODU): DRA1U18S1A	Wireless Remote Control
		

CAPACITIES		
Cooling Capacity (BTU/hr)	Rated <sup>1</sup>	18000
	Minimum	4500
	Maximum	18500
Heating Capacity (BTU/hr)	Rated <sup>2</sup>	18000
	Minimum	4600
	Maximum	18800

EFFICIENCY DATA	
SEER	21.0
EER	13.0
HSPF	10.0

### PRODUCT FEATURES

- Wireless Remote Control with "Follow Me" Technology
- Variable Speed Inverter Compressor
- Auto Restart
- Auto Changeover
- 24-hour Timer
- Self Clean Function

OUTDOOR TEMPERATURE OPERATION	
Cooling	-13 °F - 122 °F (-25 °C - 50 °C)
Heating	-13 °F - 86 °F (-25 °C - 30 °C)

ELECTRICAL DATA	
Voltage/Phase/Frequency	208-230V, 1 Phase, 60 Hz
Voltage Range	187-253V
Recommended Breaker (Amps)	20
Minimum Circuit Ampacity (Amps)	15
Minimum Wire Size	16 AWG
Rated Current - Cooling (Amps) <sup>1</sup>	6.1
Rated Current - Heating (Amps) <sup>2</sup>	6.82

<sup>1</sup> Measured at 95 °F.  
<sup>2</sup> Measured at 47 °F.





# 18,000 BTU/H WALL MOUNTED HEAT PUMP SYSTEM

SPECIFICATIONS

SYSTEM DATA	
Refrigerant Type	R-410A
Refrigerant Charge (oz.)	68.8
Oil Type	Ester Oil VG74
Oil Charge (oz.)	15.2 (450 ml)
Design Pressure (PSIG)	550/340

LINE SET REQUIREMENTS	
Connection Type	Flare
Liquid	Ø1/4" (Ø6.35mm)
Gas	Ø1/2" (Ø12.7mm)
Pre-Charge Length	25'
Minimum Length	10'
Maximum Length	98'
Maximum Height Differential	66'
Additional Refrigerant (oz./ft)	0.16

FAN DATA		
Indoor Unit Air Flow (CFM)	Low	306
	Medium	365
	High	559
Moisture Removal (Pints/hr)	3.28	
Drain Port O.D. / Drain Hose I.D.	Ø5/8" (Ø16mm)	

SOUND PRESSURE (dB(A))		
Indoor Unit	Low	32
	Medium	38
	High	43
Outdoor Unit	60	

INDOOR UNIT DIMENSIONS		
Unit Dimensions	Width	42 1/2"
	Depth	8 7/8"
	Height	13 3/16"
Carton Dimensions	Width	45 1/2"
	Depth	12 5/8"
	Height	16 5/16"
Net Weight	29.5 lbs.	
Gross Weight	39.0 lbs.	

OUTDOOR UNIT DIMENSIONS		
Unit Dimensions	Width	33 1/4"
	Depth	14 5/16"
	Height	27 5/8"
Carton Dimensions	Width	38"
	Depth	15 9/16"
	Height	30 1/2"
Net Weight	105.2 lbs.	
Gross Weight	112.4 lbs.	



# 18,000 BTU/H WALL MOUNTED HEAT PUMP SYSTEM

IDU DIMENSIONS - DRAW18F1A

## Unit Dimensions

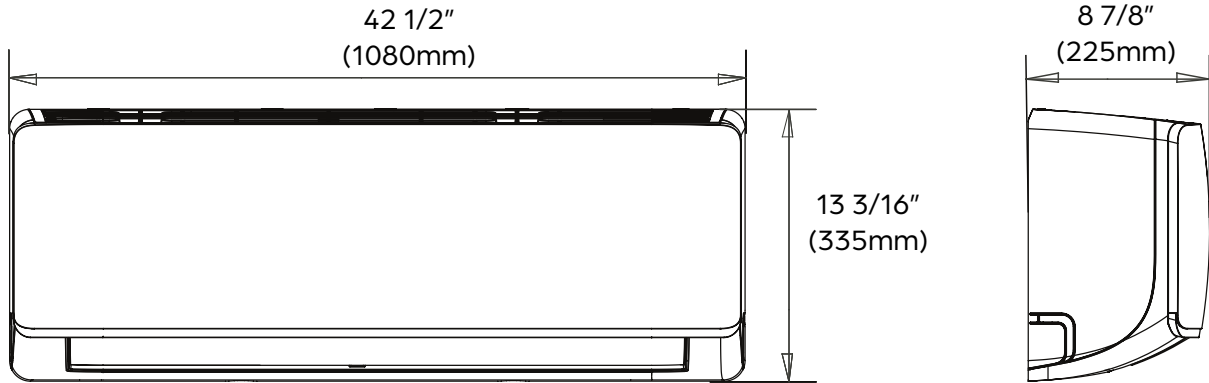

## Mounting Plate Dimensions

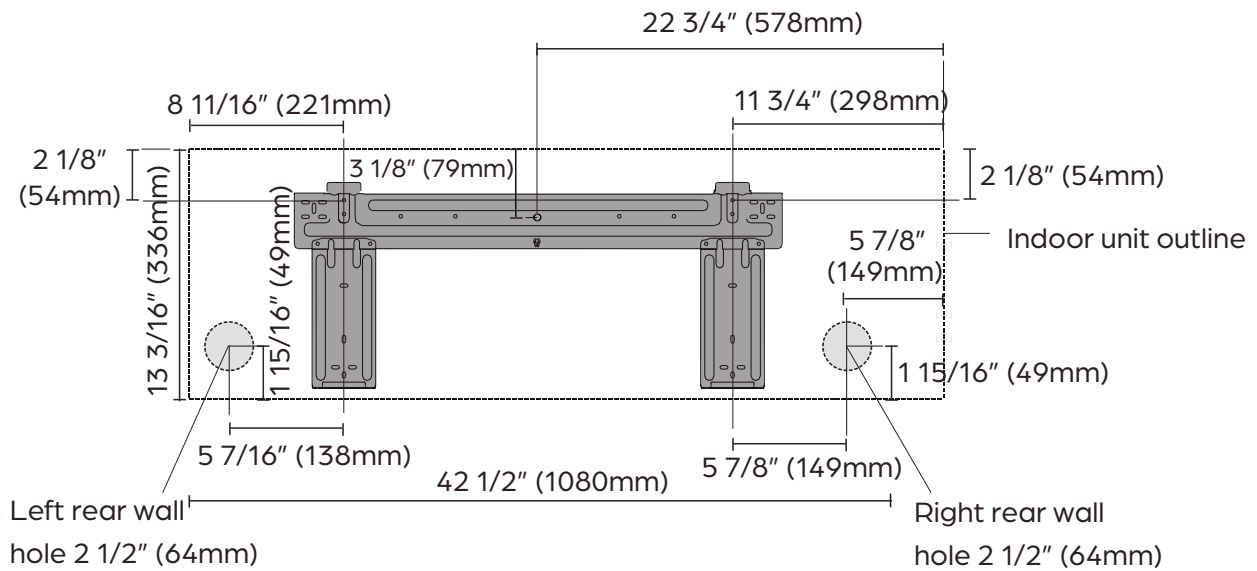

## Clearance Distances

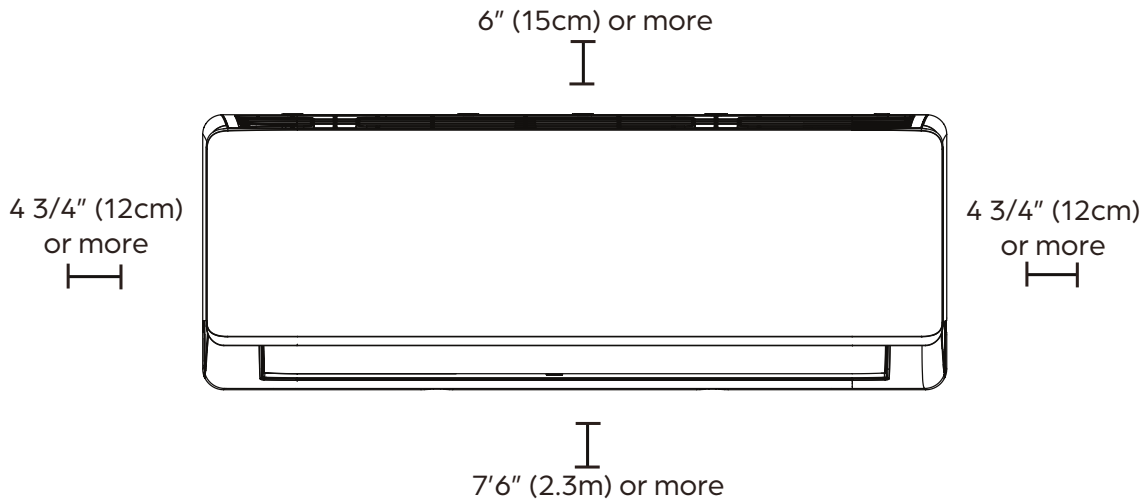



# 18,000 BTU/H WALL MOUNTED HEAT PUMP SYSTEM

ODU DIMENSIONS - DRA1U18S1A

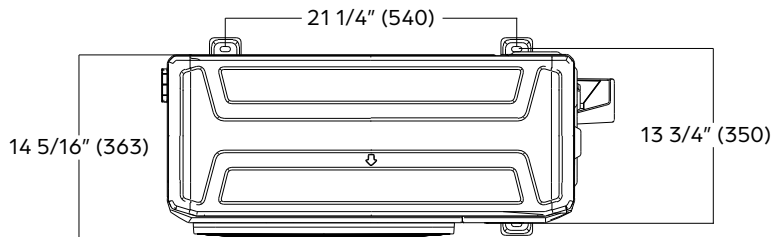
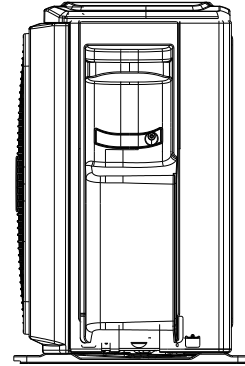
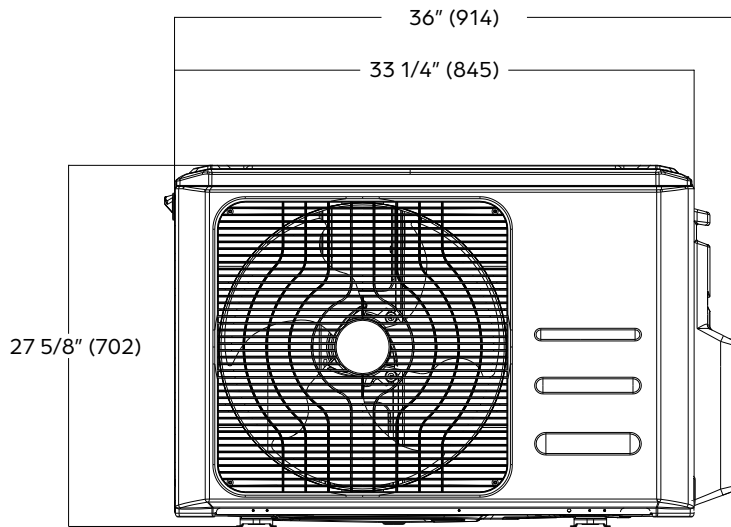
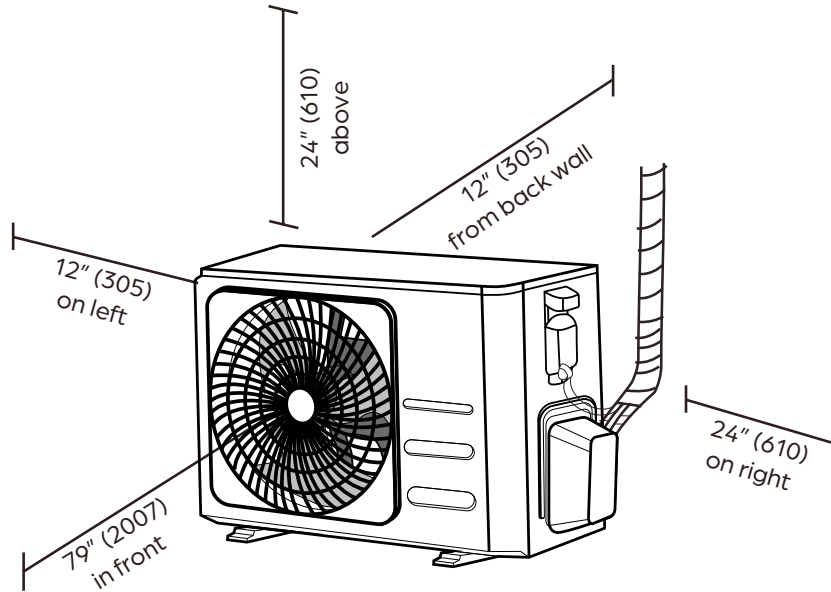

## NOTE

Illustrations in this document are for explanatory purposes. The actual shape of your mini-split equipment may vary slightly.

Specifications are subject to change without notice.

© 2021 Ferguson Enterprises LLC

www.durastar.com