

Parallax[®] Thin

USER MANUAL



ORIGINAL INSTRUCTIONS

DISCLAIMER

Legrand AV Inc. and its affiliated companies and subsidiaries (collectively, "Legrand AV"), intend to make this manual accurate and complete. However, Legrand AV makes no claim that the information contained herein covers all details, conditions or variations, nor does it provide for every possible contingency in connection with the installation or use of the products described herein. The content herein is subject to change without notice or obligation of any kind. To the maximum extent permitted by applicable law, Legrand AV makes no representation or warranty, expressed or implied, regarding the information contained herein. Furthermore, Legrand AV assumes no responsibility for accuracy, completeness or sufficiency of the information contained in this document.

Da-Lite® is a registered trademark of Legrand AV.
All rights reserved.

PREPARATION

It requires two people to install a Parallax Thin. To maintain optimal projected image geometry and screen alignment, a flat and straight wall free from obstructions and angular distortions should be used.

Choose a clean work area for assembly using padded material or other soft, clean materials. The work area should be larger than the overall screen size and directly in front of the location where the screen is to be installed.

HARDWARE PROVIDED



Thick Pull Hook
(For Silver Corner Springs)



Thin Pull Hook
(For Black Springs)

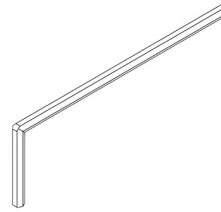

Allen Wrench

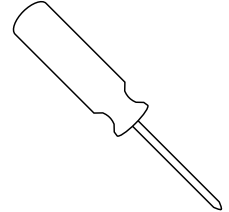

Phillips Screwdriver

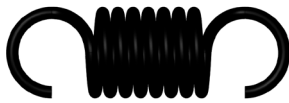

Black Spring

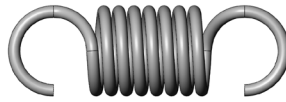

Silver Spring (Corners)

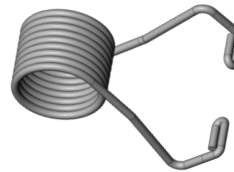

(8) Clamp Spring

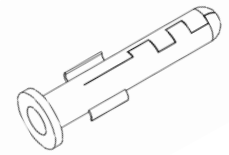

Concrete Anchor
(To Be Used with Wall Mount
Screw in Concrete Walls)

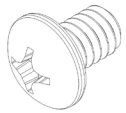

Connects Inner
Frame Brackets
(24) 1/4" - 20 x 3/8"

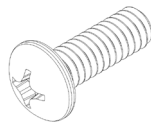

Connects Spreader Bars
to Inner Frame
(4) 1/4" - 20 x 3/4"

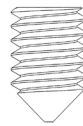

Connects Outer Bezel Brackets
(Set Screw)
(24) Set Screws

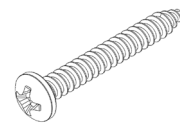

Connects Wall Mount
(4) 10 x 1-1/2" silver

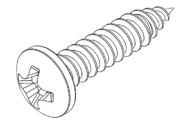

Connects Additional
Lower Wall Mount
(2) 10 x 7/8" Black

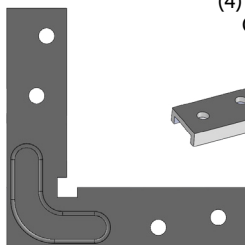

(4) Silver Inner Frame
Corner Brackets

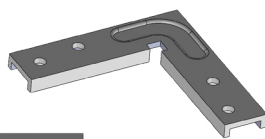

(4) Silver Outer Bezel Corner Brackets

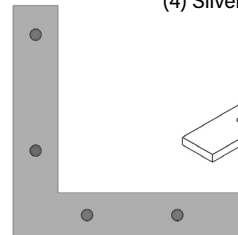

Corner Connecting Brackets

(2) Black Inner Frame Connecting
Brackets



(2) Silver Outer Bezel Connecting
Brackets



Middle Connecting Brackets

MOUNTING HARDWARE

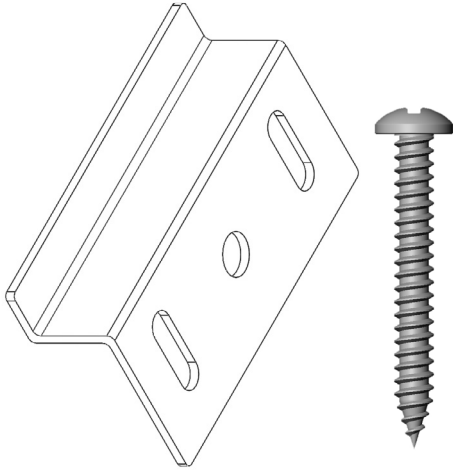

(2) Upper Wall Mount Bracket

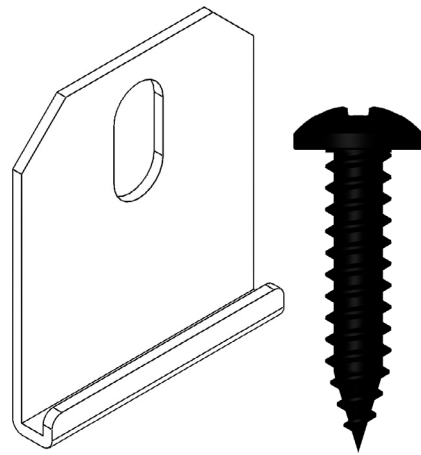

(2) Optional Lower Bracket

INNER FRAME ASSEMBLY

1. Assemble the inner frame sections with black corner brackets and black center connector brackets with (24) 1/4" - 20 x 3/8" screws. Ensure that the connector brackets are oriented with the flanges facing the front of the frame. See illustration. Frame sections without Pro-Trim (black flocking) are the outer bezel frame sections.

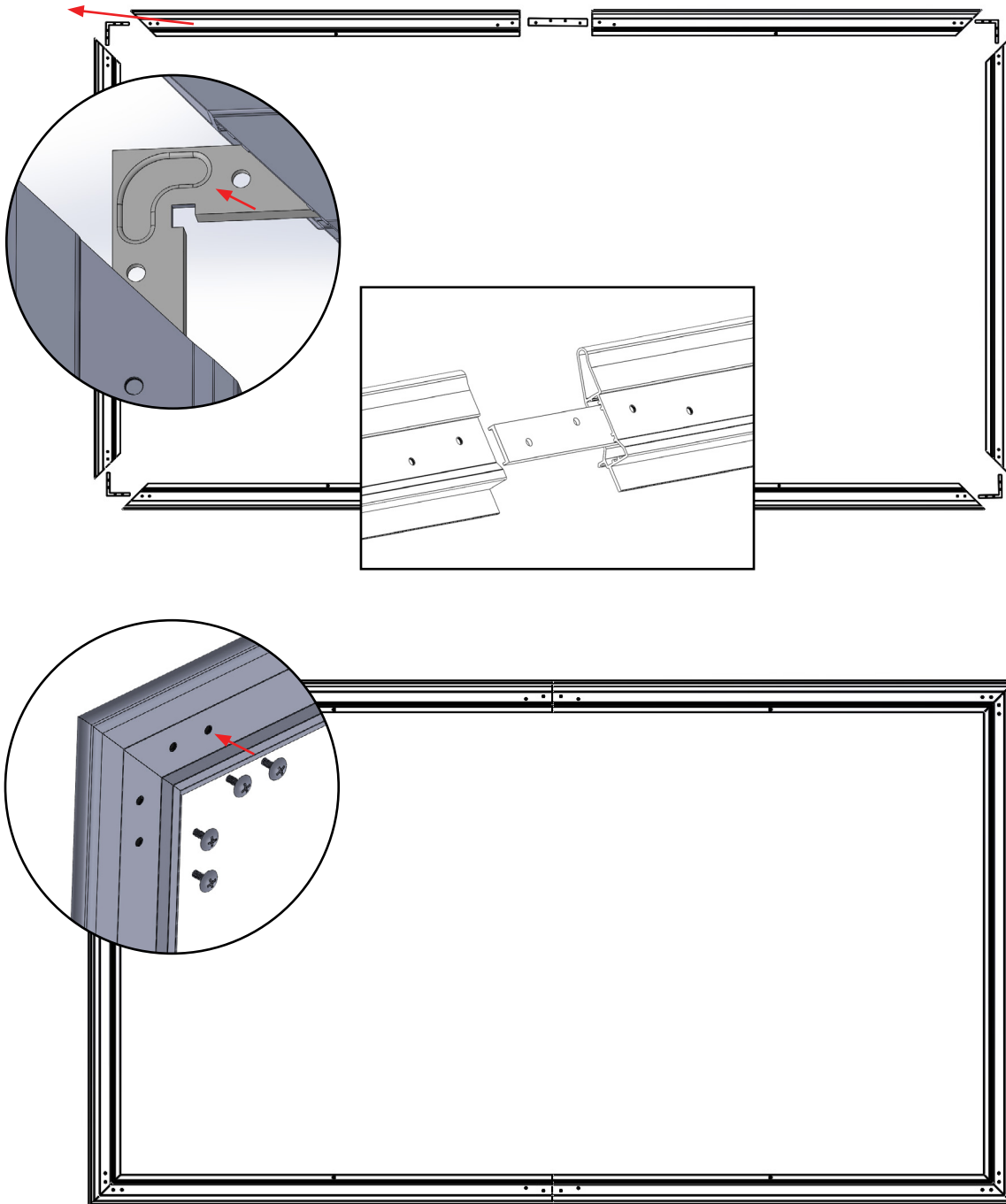

SPREADER BAR ATTACHMENT

1. Attach spreader bars to inner frame using (4) 1/4" - 20 x 3/4" screws.

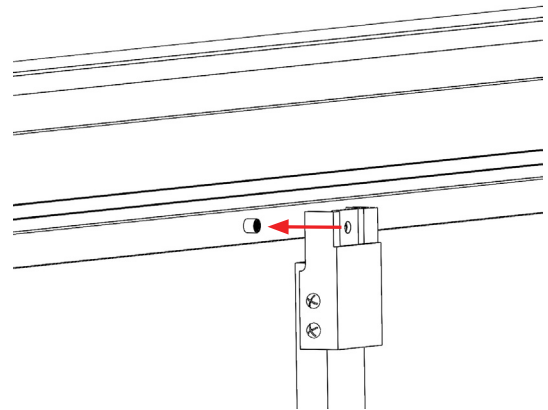
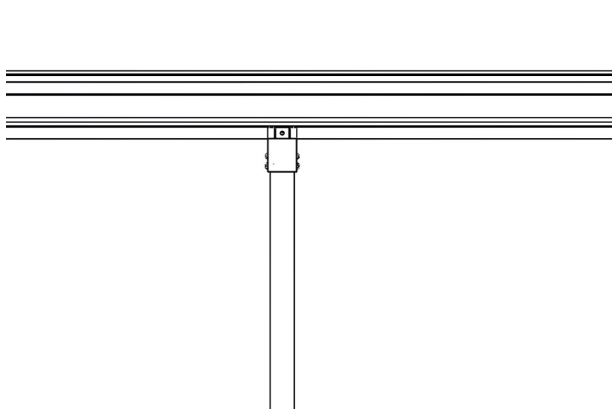
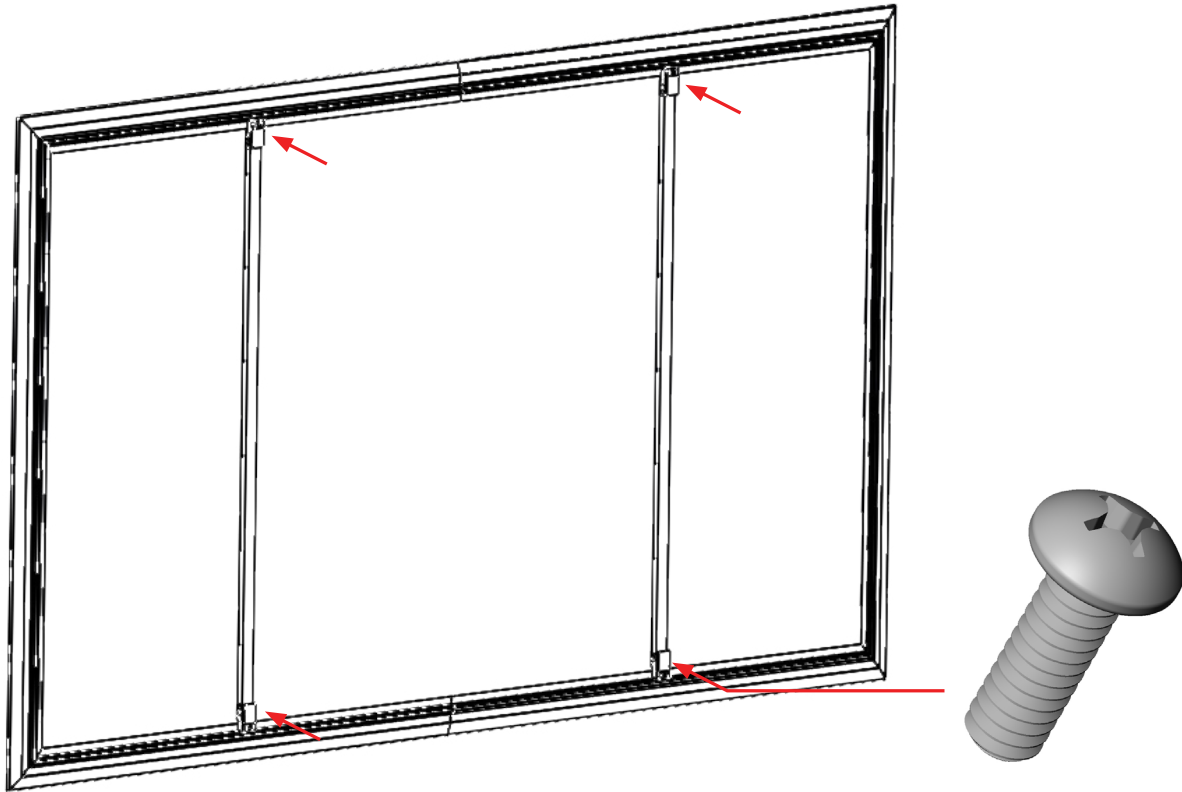

SURFACE TO FRAME ATTACHMENT

1. Unroll screen surface and place it viewing side down on the non-woven fabric (included in package).
2. With another person, lift the frame and place it screw side down onto the back of the screen.
3. Adjust the frame corners to align in the middle of the cut-out corners of the screen. The corner of the inner frame will extend past the edge of the fabric. Ensure that all four corners extend the same distance.

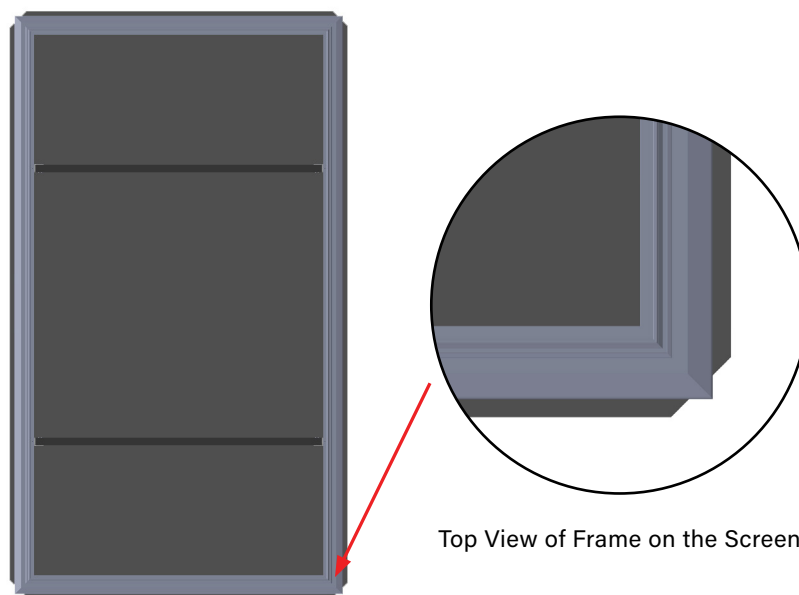
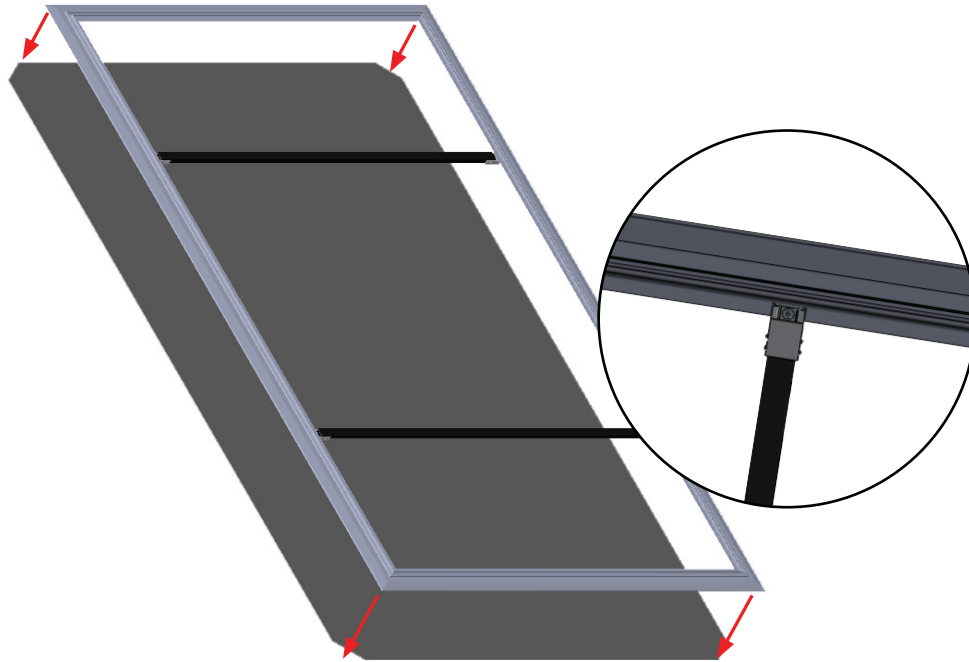

Top View of Frame on the Screen

SURFACE TO FRAME ATTACHMENT (CONT.)

4. Insert the tension rods into corresponding sleeves on the outer edges of the screen surface. Gently push the rod to pop off the eyelets on the sleeve. Six tension rods are included for each screen. The four shorter tensioned rods are for the top and bottom (2 each) and the two longer tension rods are for the left and right side.

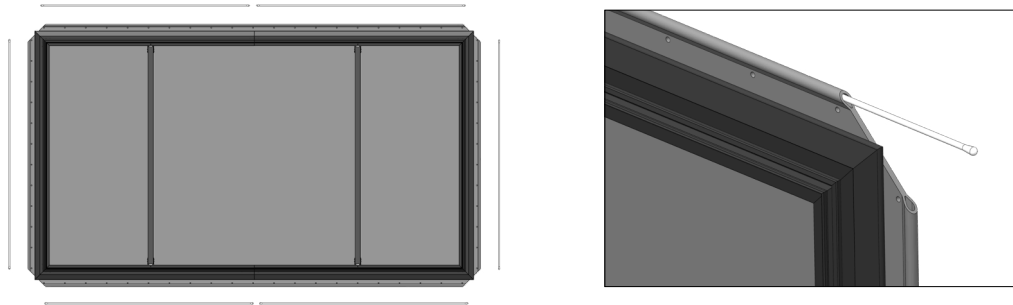

5. With two people positioned on opposite sides, start with attaching the black springs at the middle and work your way to the corners, where you will use two silver springs per corner. Attach one end of the spring to the frame and use the pull hook to attach the other end into the screen surface eyelets. When pulling the screen surface eyelet with the pull hook, ensure the pull hook is looped around the tension rod. If this is not done properly, the screen surface may tear.

Note: The springs feature two different tension strengths with the silver spring being the strongest and recommended for use on the corners. The thick pull hook should be used for the silver corner springs and the thin pull hook should be used for the black springs in all other locations. Springs can slide side-to-side as needed. Inspect frame positioning after attaching first several springs and throughout the process to ensure the frame is aligned with screen surface properly on all four sides and at the corners.

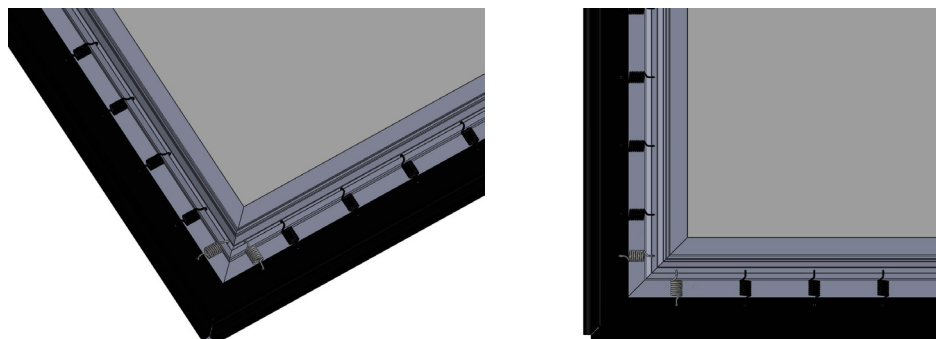
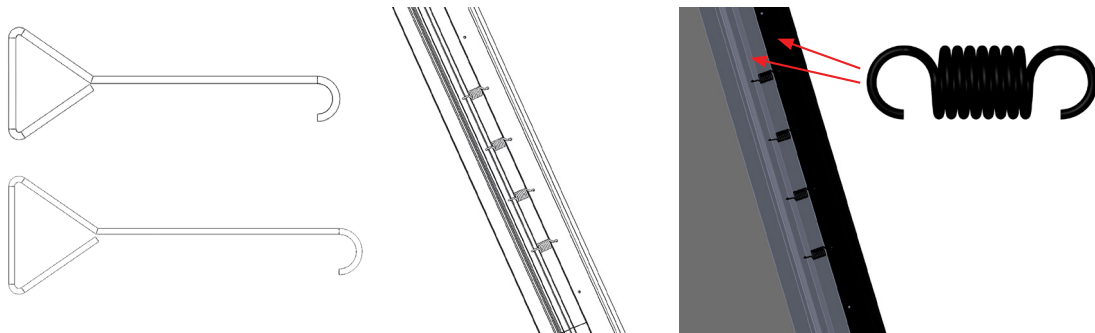

OUTER BEZEL ASSEMBLY

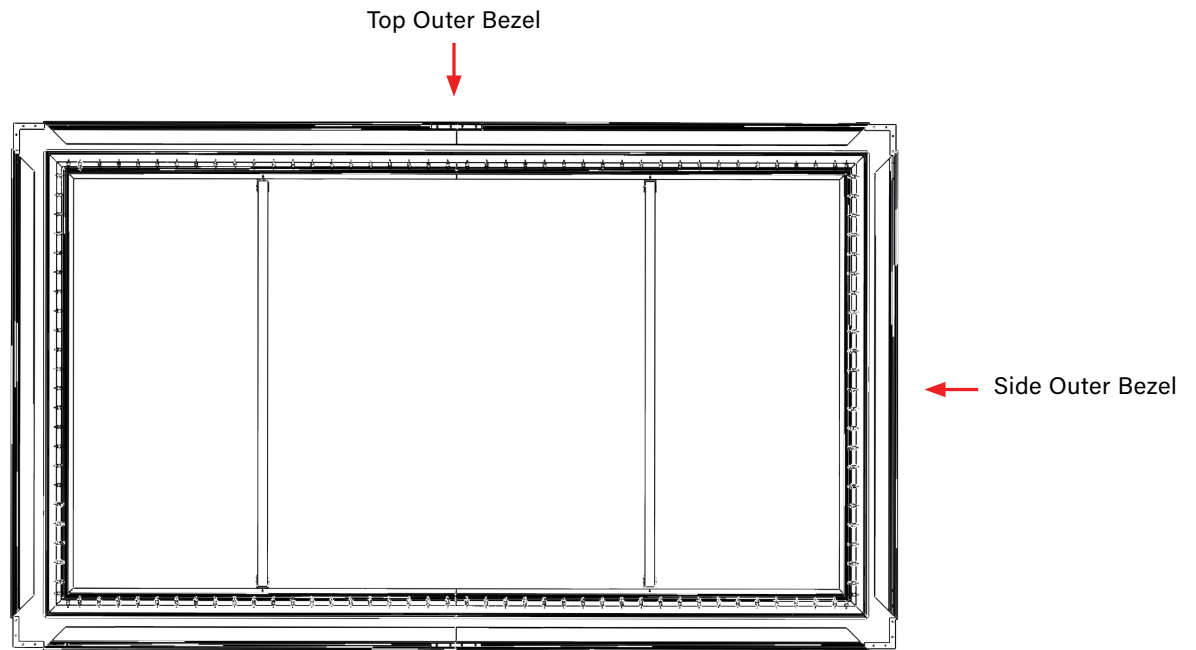

1. Slide the outer bezel onto the inner frame.

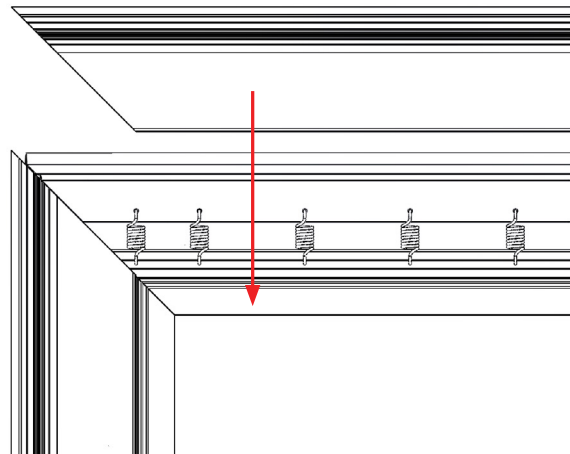
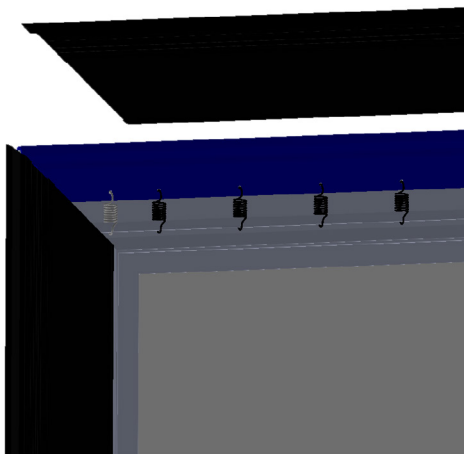

OUTER BEZEL ASSEMBLY (CONT.)

2. Attach silver outer brackets and silver corner brackets along the outer bezel frame using set screws and Allen wrench to secure into place.

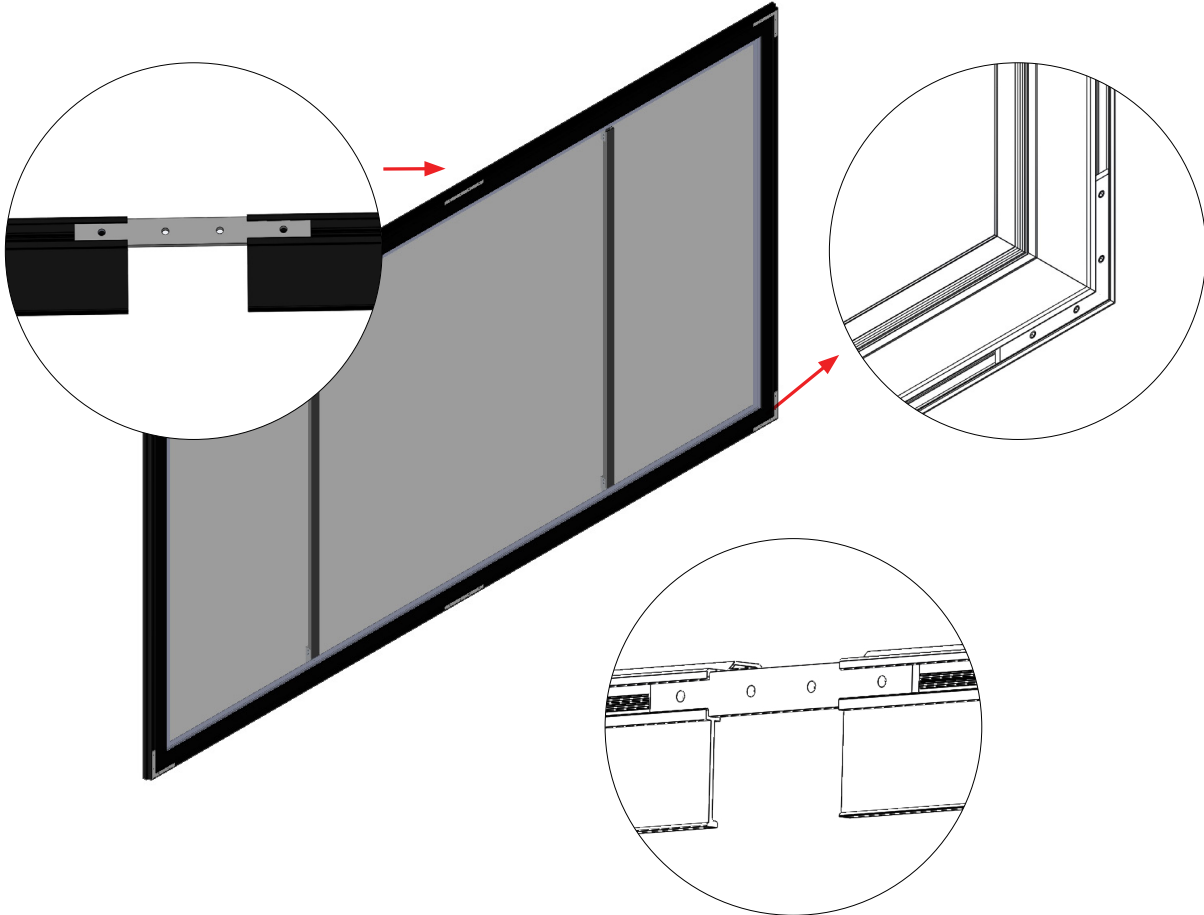

CLAMP SPRING INSTALLATION

1. Prepare the hook and clamp springs.
2. Fasten one end of the clamp spring to the internal frame by hand and hold it steady.
3. Pull the other end of the clamp spring with the hook by the other hand and fasten it to the outer frame.
4. Remove the hook.

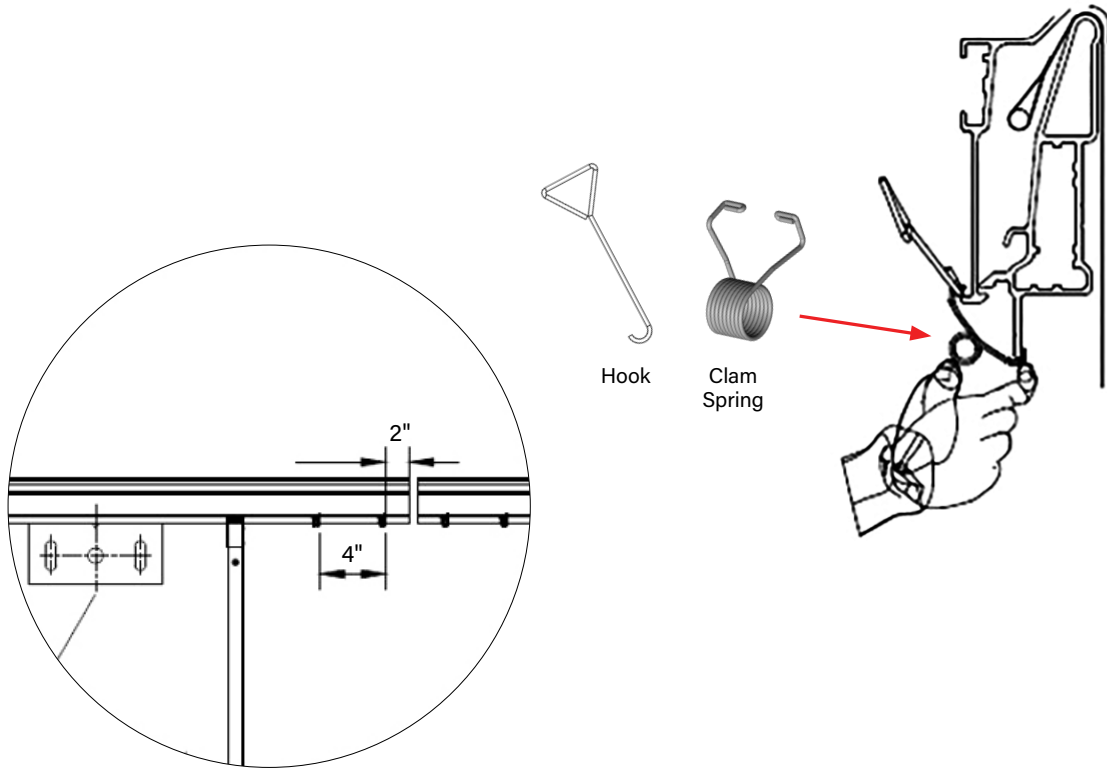

Note: Finish the installation of the fixed frames before doing this step.

MOUNTING THE SCREEN ON THE WALL

1. Align the wall mount brackets in the same horizontal line and secure them to the wall. Secure the two wall brackets to wall studs at the desired height. The outside edge of each wall bracket must be no greater than 5" away from the left and right edges of the frame. You will need at least 2" clearance above the drilled holes to hang the screen.

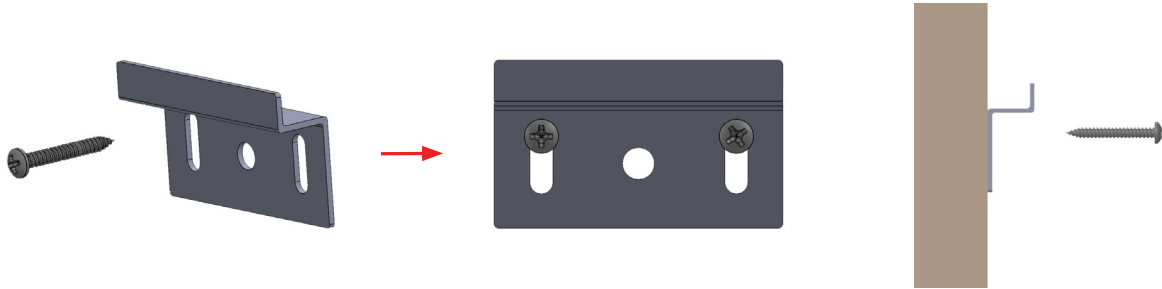

2. The Parallax Pure UST 0.6 screen surface is directional. Before hanging the screen on the wall mount brackets, locate the "DOWNSIDE" label on the back of the screen surface to ensure the screen is oriented correctly.

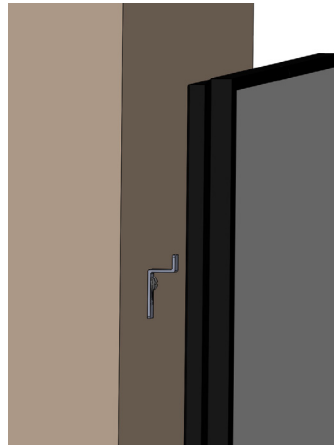

3. With two people, one on either end of the screen, lift the screen onto the wall, making sure the wall brackets are securely seated in the back of the screens frame. Adjust the screen horizontally as needed.

4. (Optional) Install the bottom bracket to attach the bottom frame to the wall if necessary. Optional bottom bracket recommended for movement prevention.

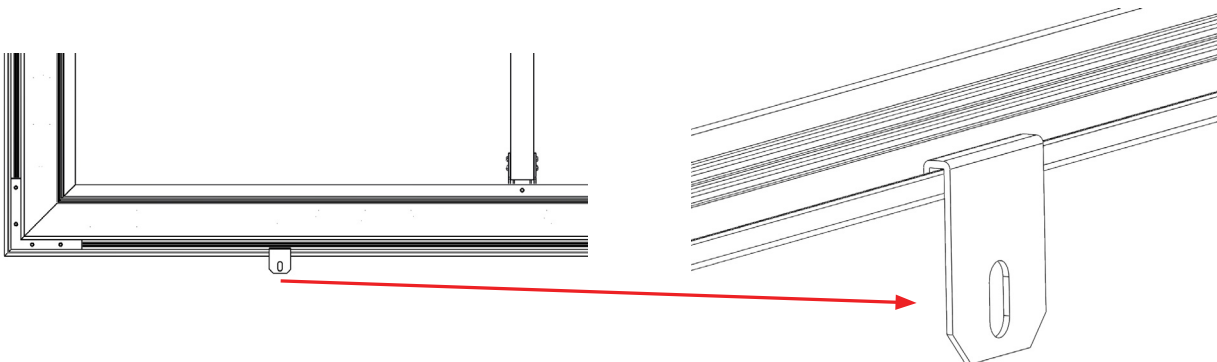

CONDITIONS FOR TRANSPORTATION AND STORAGE

- Temperature: Between 40 - 100°F (5 - 40°C)
- Relative Humidity: 30% to 70%, non-condensing
- Always keep the projection screen horizontal during transport and storage
- Make sure the entire package is supported when stored
- Do not stack more than six projection screens on top of each other
- Make sure the heaviest package is placed at the bottom of the stack

Screen surface should be allowed to air out once every two months, or otherwise used on a regular basis, if the temperature is above 72°F (22°C) and at least once every month if the temperature goes above 85°F (30°C).

LIMITED FIVE-YEAR WARRANTY ON DA-LITE PRESENTATION PRODUCTS

Legrand AV Inc. warrants certain Da-Lite branded products to the original purchaser only, to be free from defects in materials and workmanship for a period of five (5) years from the date of purchase by the original purchaser; provided they are properly operated according to Da-Lite's instructions and are not damaged due to improper handling or treatment after shipment from the factory.

Limited five-year warranty applies to the following products:

Wireline Advantage®, Tensioned Advantage Series, Advantage Series, Tensioned DescenderPro, DescenderPro, Tensioned Conference, Tensioned Professional, Professional, Da-Lift Projector Lifts, Tensioned Contour®, Contour, Tensioned Cosmopolitan® Series, Cosmopolitan Series, Designer Contour, Slimline, Studio, Arena, Motorized Scenic Roller, Ascender, Parallax®, Parallax Thin, FullVision, UTB Contour, Cinema Contour, Da-Snap, Perm-Wall, Imager, IDEA™ Screen, IDEA Panoramic, Fast-Fold® Deluxe, Fast-Fold Deluxe Drapery Kits, Flex Plex, Da-Glas, Da-Plex Rear Projection Mirror System, and Holo Screen.

This warranty does not apply to equipment showing evidence of misuse, abuse or accidental damage, or which has been tampered with or repaired by a person other than authorized Da-Lite personnel.

Da-Lite's sole obligation under this warranty shall be to repair or to replace (at Da-Lite's option) the defective part of the merchandise. Returns for service should be made to your Da-Lite dealer. If it is necessary for the dealer to return the screen or part to Da-Lite, transportation expenses to and from Da-Lite are payable by the purchaser and Da-Lite is not responsible for damage in shipment. To protect yourself against damage or loss in transit, insure the product and prepay all transportation expenses.

TO THE MAXIMUM EXTENT PERMITTED BY APPLICABLE LAW, THIS WARRANTY IS IN LIEU OF ALL OTHER WARRANTIES, EXPRESS OR IMPLIED, INCLUDING WARRANTIES AS TO FITNESS FOR USE AND MERCHANTABILITY.

Any implied warranties of fitness for use, or merchantability, that may be mandated by statute or rule of law are limited to the five (5) year warranty period. This warranty gives you specific legal rights, and you may also have other rights, which vary from state-to-state. **TO THE MAXIMUM EXTENT PERMITTED BY APPLICABLE LAW, NO LIABILITY IS ASSUMED FOR EXPENSES OR DAMAGES RESULTING FROM INTERRUPTION IN OPERATION OF EQUIPMENT, OR FOR INCIDENTAL, DIRECT, OR CONSEQUENTIAL DAMAGES OF ANY NATURE.**

In the event that there is a defect in materials or workmanship of a Da-Lite product, you may contact Customer Care at 3100 North Detroit Street, Warsaw, IN 46582, (866) 977-3901.

IMPORTANT: THIS WARRANTY SHALL NOT BE VALID AND DA-LITE BRANDED PRODUCTS SHALL NOT BE BOUND BY THIS WARRANTY IF THE PRODUCT IS NOT OPERATED IN ACCORDANCE WITH THE DA-LITE WRITTEN INSTRUCTIONS.

Keep your sales receipt to prove the date of purchase and your original ownership.



facebook.com/dalitescreencompany



youtube.com/@daliteprojectionscreens



linkedin.com/company/da-lite-screen-company-llc

USA 866.977.3901 av.support@legrand.com

CANADA 877.345.4329 av.support@legrand.com

EMEA +31 495 580 840 av.emea.sales@legrand.com

APAC +852 2145 4099 av.asia.sales@legrand.com

DA-LITE[®]

A brand of  **legrand**

C2G | CHIEF | DA-LITE | LUXUL | MIDDLE ATLANTIC | VADDIO | WIREMOLD

©2026 Legrand AV Inc. 240427 Rev C 2/26 Da-Lite is a registered trademarks of Legrand AV Inc. All other brand names or marks are used for identification purposes and are trademarks of their respective owners. All patents are protected under existing designations. Other patents pending.