

EDGESTAR®

ECK24 Kegerator Installation Guide

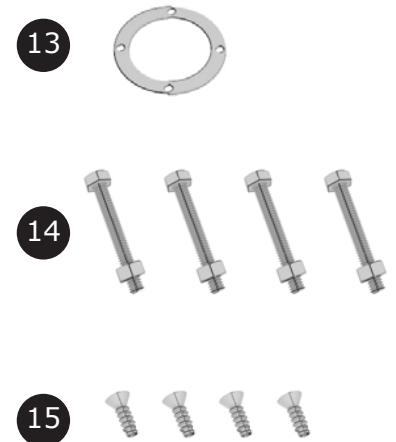
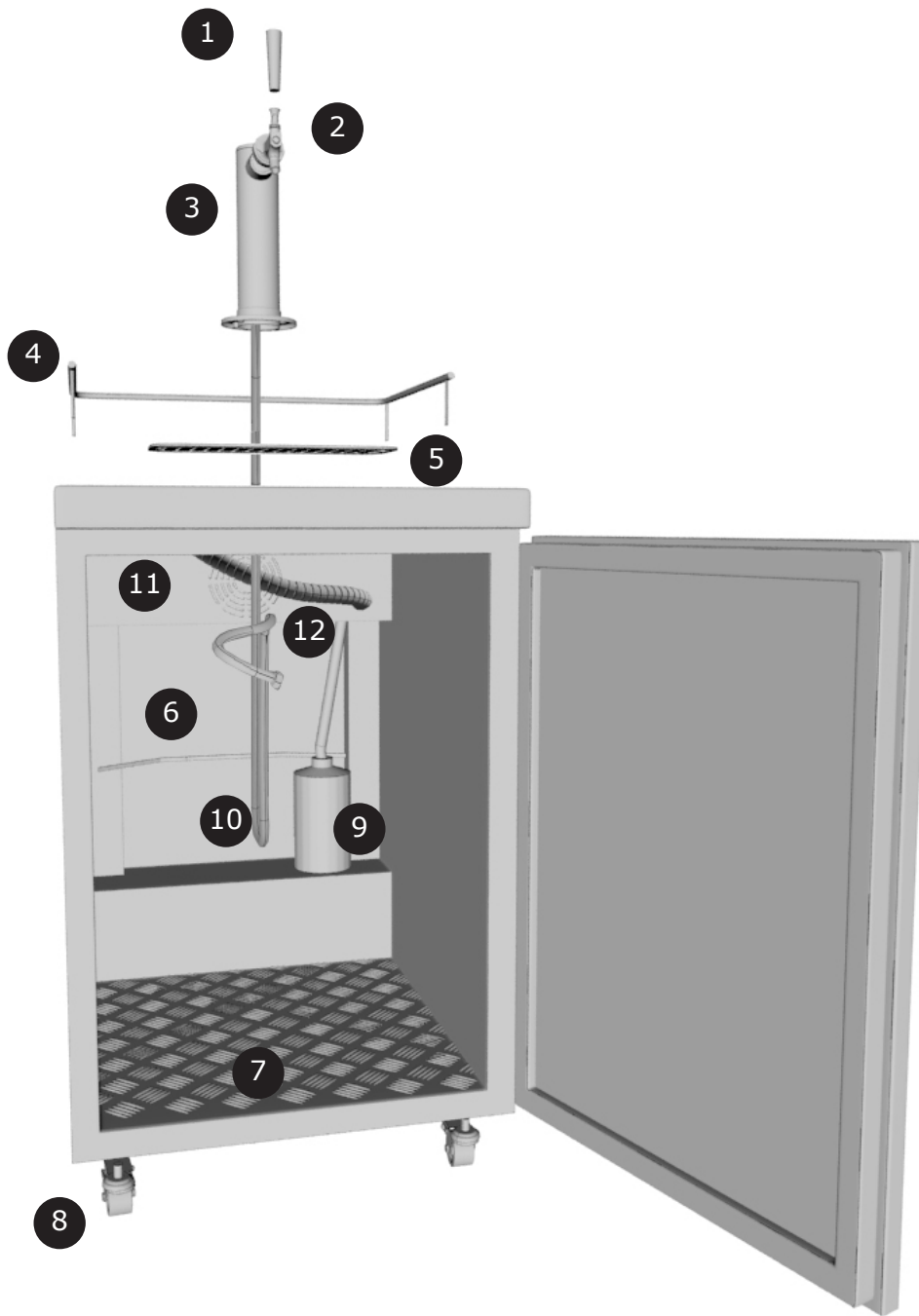

- 1. Faucet Handle
- 2. Faucet
- 3. Beer Tower
- 4. Guard Rail
- 5. Drip Tray
- 6. Cylinder Strap
- 7. Metal Keg Floor Support
- 8. Casters (x4)

- 9. Bottle Reservoir and Tube
- 10. Beer Line
- 11. Thermostat Control
- 12. Internal Fan Pipe
- 13. Tower Gasket
- 14. Tower Bolts (4)
- 15. Rail Screws (4)

Tools Needed:

- Wrench
- Flat Head Screwdriver
- Phillips Head Screwdriver

For additional information
visit edgestar.com

1

Install Tower

Mount the tower gasket (#13) by lining it up with the preexisting holes at the top of the unit. Install the tower (#3) by first unraveling the beer line (#10) from the bottom of the tower. Feed the beer line through the top opening that was under the cabinet plug.



2

Secure Tower

Once the beer line (#10) is fed into the unit line up the holes at the bottom of the tower, install the four bolts (#14) and secure with the flat washer and nut from the inside.



3

Install Handle & Faucet

Screw the faucet handle (#1) to the beer faucet (#2). Line up the beer faucet to the tower shank at the front of the tower (#3) and tighten the collar by hand.



4

Install Railing

Line up the guard rail (#4) with the existing holes at the top of the unit. Use the rail screws (#15) to mount the guard rail to the top of the unit.



5

Secure CO₂ Tank

Place the CO₂ cylinder on the inside ledge and secure with the cylinder strap (#6).



6

Power on unit

Adjust the temperature by turning the thermostat knob (1 is the warmest to 7 is the coldest setting). Note: To help keep the temperature uniform throughout the unit, the circulation fan will continually run even if you turn the thermostat to off. You can only shut off the circulation fan by unplugging the unit.

**Warning:**

CO₂ can be dangerous! CO₂ cylinders contain high-pressured gas, which can be hazardous if handled improperly. Please handle with care.

Removing the Unit from the Pallet

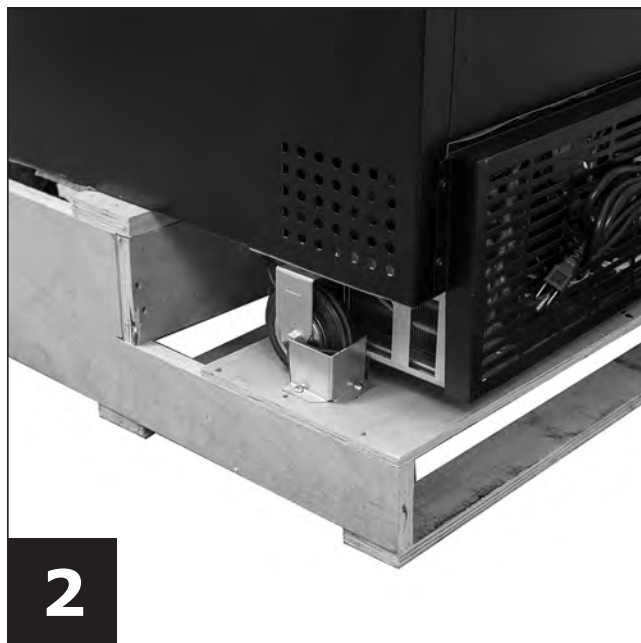

1. Carefully remove the straps and packaging from the unit
2. Locate the metal L-brackets on the base of the pallet.
3. Unscrew the metal L-brackets by using a screw driver.
4. Remove L-brackets from pallet. With two people, carefully lift the unit off the pallet.

*Note: We recommend keeping the packaging until you have inspected the product for damage and tested the unit to work properly.

Cleaning the Unit

Monthly maintenance is required to be covered under the manufacturers warranty. To maintain your refrigerator, unplug the unit and use a vacuum attachment to clean out the side and back vent grills. This will keep your refrigerator running efficiently and prolong the life of your compressor.

Warning:

This guide is provided for informational purposes only. It is provided as a supplement to the owner's manual.

Please refer to the owner's manual for a full discourse on installation, usage and maintenance. If you have any questions about the installation of this appliance, feel free to contact EdgeStar service at 866.319.5473 or consult a qualified installer. Neither the manufacturer nor its distributors shall be liable for any incidental, consequential, indirect, special, or punitive damages of any nature, including without limitation, lost revenues or profits, or any other damage whether based in contract, tort, or otherwise.

CO2 cylinder comes empty due to HAZMAT restrictions. It will need to be filled locally at any air/gas supplier prior to use.