

MODEL MC1226

MCCULLOCH

Handheld Steam Cleaner

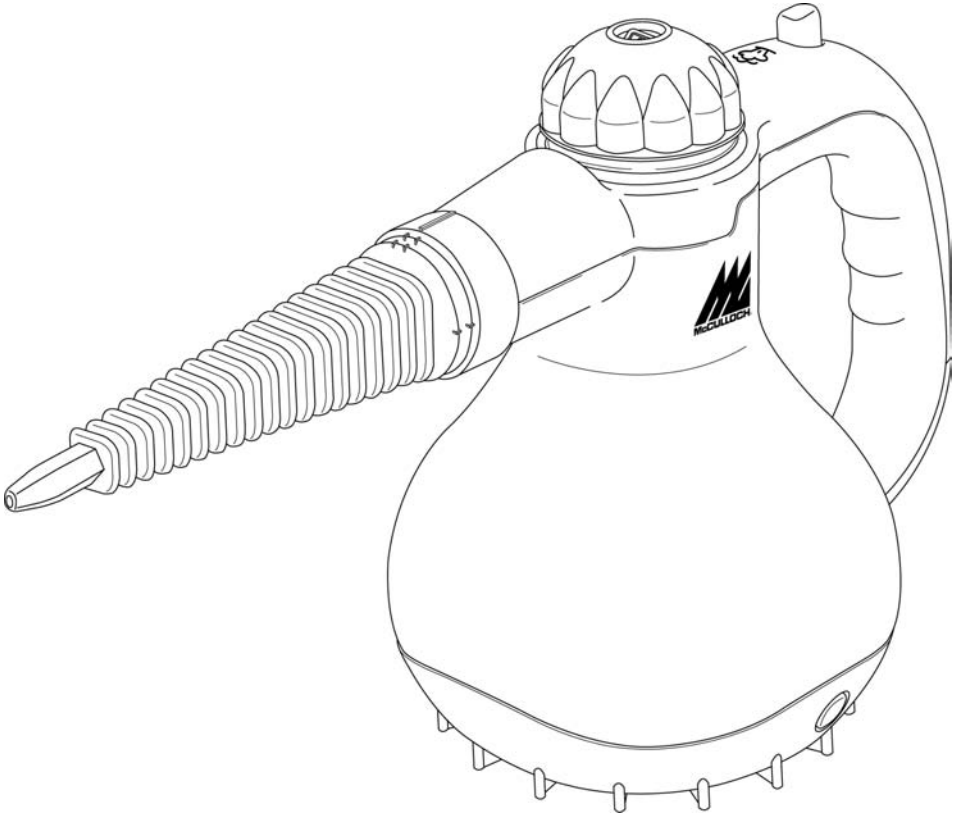

by Top Innovations, Inc.

**Please read all instructions before use.
Mail in your warranty registration card.**

Dear Valued Customer,

Congratulations on purchasing your new **MC1226 Handheld Steam Cleaner**. This versatile and convenient product places the cleaning power of steam in a compact and lightweight appliance that is easy to take anywhere you need to clean.

Plug in your **Handheld Steam Cleaner** and in minutes you are ready to eliminate dirt, grease, grime, stains and more from most anywhere in or around your home. In addition to removing dirt and grime, you will receive the many benefits that steam provides. Hot steam cleans naturally, without the need for harsh chemicals. It refreshes upholstery and eliminates smoke and other unpleasant odors, making your carpet and furniture like new again. Use it in your living room, kitchen, bedrooms, bathrooms, and anywhere else that you need to clean. And when you're finished steaming, the **Handheld Steam Cleaner's** light weight and compact size make it quick and convenient to store.

Top Innovations, Inc. would like to invite you to visit our Customer Support Web site at:

www.SteamFast.com

On this Web site you will find additional information about many other exciting products that are available, helpful tips on ways in which you can utilize your **Handheld Steam Cleaner**, and other useful information to assist you in maximizing the power of steam!

Enjoy your new **MC1226 Handheld Steam Cleaner!**

A handwritten signature in cursive script, appearing to read "Benny Lee".

Benny Lee
Chairman and CEO
Top Innovations, Inc.

IMPORTANT SAFETY INSTRUCTIONS



WARNING: To reduce the risk of fire, electrical shock, or injury, the following basic safety precautions should always be followed when using an electrical appliance.

WARNING: To reduce the risk of electrical shock, this appliance has a grounded (three-pronged) plug. This plug will fit in a polarized wall outlet only one way. If the plug does not fit fully in the outlet, contact a licensed electrician to install a proper outlet. DO NOT attempt to modify the plug or defeat this safety feature.

READ ALL INSTRUCTIONS BEFORE USE

DANGER

Any appliance is electrically live even when switch is off. To reduce risk of death by electric shock:

1. Always unplug power cord immediately after using.
2. Do not place or store unit where it can fall or be pulled into a sink or tub.
3. Do not place in, or drop into water or other liquid.
4. If unit falls into water, immediately unplug power cord. Do not reach into the water.

WARNING

To reduce risk of burns, electrocution, fire, or injury to persons:

1. Use *Handheld Steam Cleaner* only for its intended purpose as indicated in this manual.
2. Do not use an extension cord to operate this unit.
3. Before plugging power cord into electrical outlet, be sure that all electrical information on rating label agrees with your power supply.
4. To reduce likelihood of circuit overload, DO NOT operate another high wattage appliance on the same circuit as this unit.
5. To protect against risk of electric shock, do not immerse unit in water or other liquids. Do not use power cord as handle, allow it to hang over edge of counters, or be crimped or closed in doors.
6. Never yank power cord to disconnect from outlet; instead, grasp plug and pull to disconnect.
7. Do not operate unit with a damaged power cord or if the unit has been dropped or damaged. To avoid risk of electrical shock, do not disassemble unit; take it to a qualified service repair person for examination and repair. Incorrect reassembly can cause a risk of electrical shock when unit is used.
8. Close supervision is required for any appliance being used near children, pets and plants. Do not leave unit unattended while plugged in.

IMPORTANT SAFETY INSTRUCTIONS

10. This unit is not intended for use by persons (including children) with reduced physical, sensory or mental capabilities, or lack of experience and knowledge, unless they have been given supervision or instruction concerning use of the unit by a person responsible for their safety.
11. If Heating Indicator Light does not illuminate when power cord is plugged in, unit is not operating normally. Immediately turn unit off and disconnect from power supply - have unit serviced by qualified service personnel.
12. Unplug power cord before filling Boiler with water.
13. Do not use unit where aerosol-based products are being used, or where oxygen is being administered.
14. Unit is only meant to be used with recommended MC1226 accessories. Using other types of attachments may cause damage to unit or injury.
15. When filling Boiler, only water should be used in unit - other cleaning agents could damage unit or cause injury. Distilled or de-mineralized water is highly recommended, in order to minimize potential build-up of mineral deposits. Do not overfill unit.
16. Do not attempt to use unit without properly filling Boiler.
17. To reduce risk of contact with hot water emitting from Steam Nozzle, check appliance before each use by positioning it away from body and pressing Steam Button. Do not operate unit if Steam Nozzle is blocked.
18. Burns can occur from touching hot metal parts, hot water, or steam. Do not touch Steam Nozzle while unit is in use. Do not turn unit upside-down - it may contain hot water.
19. When steaming any item for the first time, it is recommended that you consult the manufacturer's guidelines for material being steamed. For items in question, test on an inconspicuous area before proceeding.
20. Do not allow power cord to touch hot surfaces during use. Wrap cord loosely around unit when storing.
21. Always allow *Handheld Steam Cleaner* to cool completely (at least 30 minutes) before storing.

SAVE THESE INSTRUCTIONS!
FOR HOUSEHOLD USE ONLY

PRODUCT INFORMATION



The following features and accessories are included with your *Handheld Steam Cleaner*. Carefully inspect packing material for all parts listed below. To obtain possible missing parts, refer to the **Customer Support** section on Page 14 of this manual.

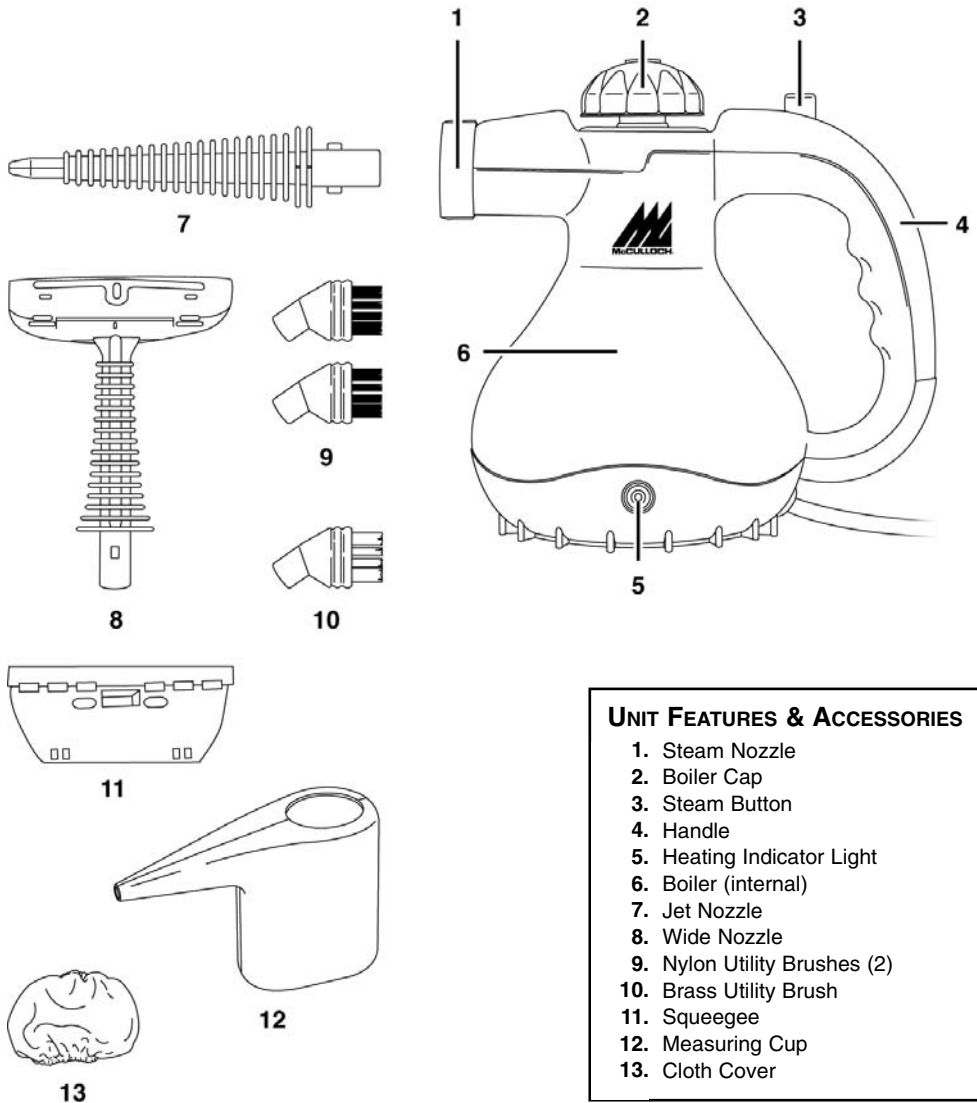

UNIT FEATURES & ACCESSORIES

1. Steam Nozzle
2. Boiler Cap
3. Steam Button
4. Handle
5. Heating Indicator Light
6. Boiler (internal)
7. Jet Nozzle
8. Wide Nozzle
9. Nylon Utility Brushes (2)
10. Brass Utility Brush
11. Squeegee
12. Measuring Cup
13. Cloth Cover

- The *Steam Nozzle* (1) emits the flow of hot, penetrating steam whenever the *Steam Button* is pressed and held.

CAUTION: Do not direct steam towards surfaces that may be damaged by extreme heat or moisture.

- The *Boiler Cap* (2) is designed to safely contain steam inside the *Boiler*. The *Boiler Cap* must be unscrewed and removed in order to fill the *Boiler* with water.
- The *Steam Trigger* (3) is pressed and held in order to start the flow of steam from the *Steam Nozzle*, then released when you wish to stop.
- The *Handle* (4) is ergonomically designed for grip and user comfort, while remaining cool and safe to grasp.
- The *Heating Indicator Light* (5) illuminates when the power cord is plugged in and the *Boiler* has begun heating. The *Heating Indicator Light* will turn off when the *Boiler* is fully heated and the unit is ready to begin producing steam.

NOTE: The *Heating Indicator Light* may cycle off and on during use, accompanied by a slight temporary drop in steam pressure - this is normal.

- The *Boiler* (6) is the internal reservoir where water is held and converted into steam. For optimal steam production, the *Boiler* should be filled with no more than 6 oz. (177 ml.) of water.
- The *Jet Nozzle* (7) connects to the *Steam Nozzle* and is designed to focus the flow of steam for concentrated cleaning. The *Nylon Brushes*, *Brass Brush* and *Angled Nozzle* all connect to the *Jet Nozzle*.
- The *Wide Nozzle* (8) connects to the *Steam Nozzle*, dispersing the flow of steam over a wider area. The *Squeegee* and *Cloth Cover* both connect to the *Wide Nozzle*.
- The 2 *Nylon Utility Brushes* (9) and the *Brass Utility Brush* (10) connect to the *Jet Nozzle* and are designed for scrubbing especially tough stains. The *Nylon Brushes* are ideal for use on many surfaces around the home, including carpet, ceramic tile, grouting, and more. The *Brass Brush* is perfect for use on BBQ grills, oven racks, automobile engines, shop tools and other hard metal surfaces.

NOTE: Some delicate surfaces, such as painted wood or stainless steel, may be scratched or damaged by the bristles of the *Utility Brushes*. Use careful judgement when deciding what surface to clean with any of the *Utility Brushes*. If you are unsure if a surface will be damaged, it is recommended that you test a small inconspicuous spot before proceeding.

- The *Squeegee* (11) connects to the *Wide Nozzle* and is designed for cleaning windows, mirrors, and other smooth surfaces.
- The *Measuring Cup* (12) provides an easy and convenient way to consistently fill the *Boiler* with the optimum amount of water (6 oz. / 177 ml.).
- The *Cloth Cover* (13) stretches over the *Wide Nozzle* and is designed to absorb excess moisture, helping to prevent water spotting. This allows effective steaming of fabrics and upholstery.

ASSEMBLING THE HANDHELD STEAM CLEANER



CONNECTING JET NOZZLE / WIDE NOZZLE

WARNING: DO NOT attempt to connect any accessories while unit is emitting steam. Doing so could result in burns or other injury.

1. Insert cylinder on back of Jet Nozzle or Wide Nozzle (FIGURE 1) into opening of Steam Nozzle (FIGURE 2). Align it so that two tabs on sides of cylinder (FIGURE 1-A) fit into two tab holes on sides of opening (FIGURE 2-B). Be sure to push accessory in as far as possible.

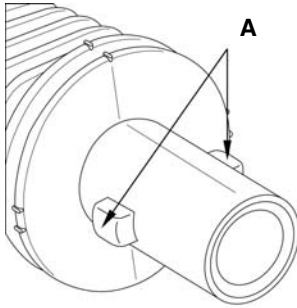

FIGURE 1

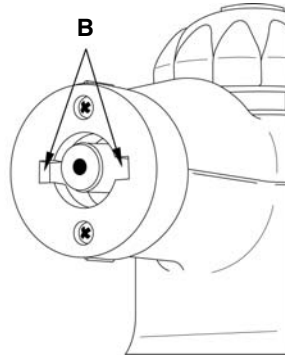

FIGURE 2

2. Rotate Jet Nozzle or Wide Nozzle in a clockwise direction as indicated below (FIGURE 3-A). Twist until you feel it “lock” into place and it will move no further. Note that single guide line on top of Steam Nozzle aligns between dual guide lines on Jet Nozzle / Wide Nozzle (FIGURE 3-B).

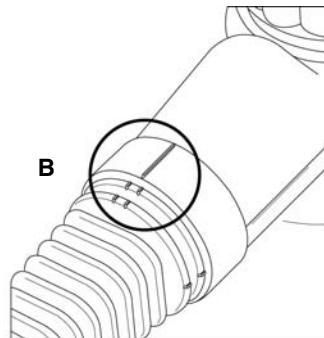
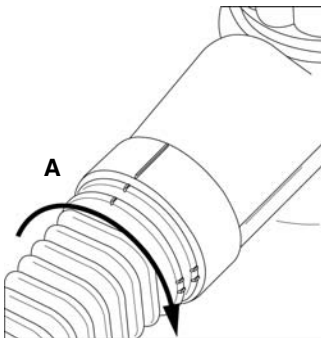

FIGURE 3

CONNECTING UTILITY BRUSHES

NOTE: Both Nylon Utility Brushes and the Brass Utility Brush are attached in the same manner.

1. Begin by aligning hexagonal-shaped hole on back of Utility Brush with hexagonal tip of the Jet Nozzle (FIGURE 4).

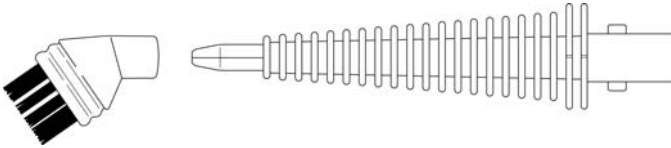

FIGURE 4

2. Firmly press Utility Brush onto tip of Jet Nozzle (FIGURE 5-A).

IMPORTANT: Make sure accessory is pushed as far as possible onto tip to ensure that it is properly set in place and space between the accessory and the Jet Nozzle is sealed (FIGURE 5-B). This prevents heated steam from escaping and causing injury.

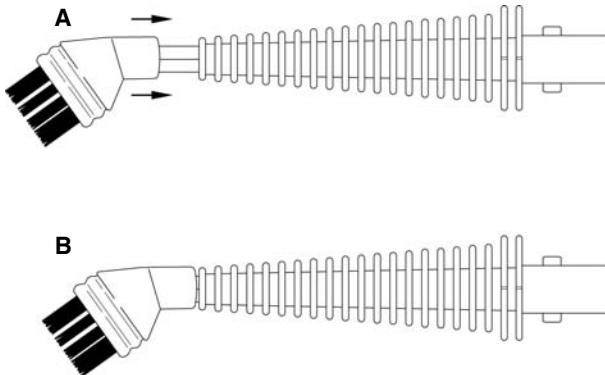

FIGURE 5

3. To remove Utility Brush, make sure unit is unplugged and has had sufficient time to cool down. Then simply grasp Brush and firmly pull until it disconnects from Jet Nozzle.

ASSEMBLING THE HANDHELD STEAM CLEANER

McCULLOCH

CONNECTING SQUEEGEE

1. Connect Squeegee to Wide Nozzle by inserting hook tabs on bottom of Squeegee (FIGURE 6-A) into slots on bottom of Wide Steam Nozzle (FIGURE 6-B).
2. Swing Squeegee backwards until hook latch on back snaps over tab on top of Wide Nozzle.
3. Connect Wide Nozzle to Steam Nozzle as normal (refer to Page 7 for more details).

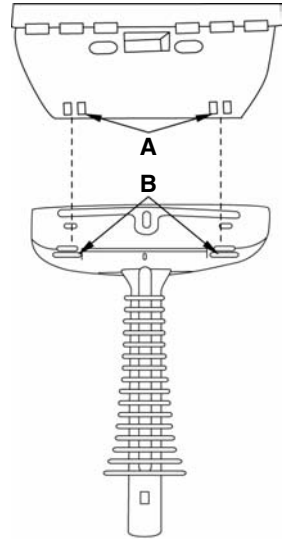

FIGURE 6

USING CLOTH COVER

1. Stretch Cloth Cover around Wide Nozzle (FIGURE 7). Cloth Cover should fit snugly enough to stay in place while steaming.
2. Connect Wide Nozzle to Steam Nozzle as normal (refer to Page 7 for more details).

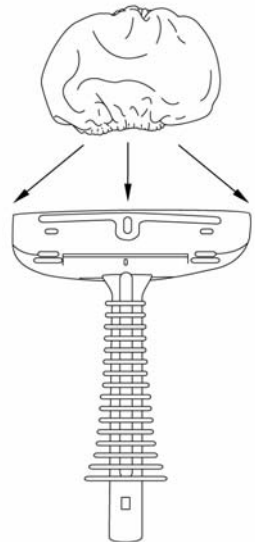

FIGURE 7

FILLING BOILER WITH WATER

1. Place *Handheld Steam Cleaner* on a flat, level surface.
2. Make sure electrical cord is unplugged from outlet.
3. If unit has been in use, allow at least 5 minutes for Boiler to cool. Press and hold Steam Button to ensure that any remaining steam has been released.
4. Cautiously remove Boiler Cap by unscrewing it in a counter-clockwise direction, and lift it off.
5. Boiler should always be emptied after each use. If it was not emptied after the last use, empty it now - this will make it easier to fill with the correct amount of water.
6. Fill included Measuring Cup with 6 oz. (177 ml.) of water.

NOTE: In order to extend the life of your *Handheld Steam Cleaner* and keep it functioning at it's maximum potential, it is highly recommended that distilled or de-mineralized water be used in Boiler.

7. Carefully pour water from Measuring Cup into Boiler through fill hole.

WARNING: Extreme caution should be used when pouring water into the Boiler. Do not look directly down into fill hole when filling. Keep your free hand and any children or pets at a safe distance.

NOTE: In order to prevent excessive water dripping in steam, do not exceed the Boiler's maximum capacity of 6 oz. (177 ml.).

8. Replace Boiler Cap, screwing it in a clockwise direction to tighten. Make sure it is screwed on securely to prevent hot water or steam from escaping.

USING THE *HANDHELD STEAM CLEANER*



OPERATING THE *HANDHELD STEAM CLEANER*

Before operating, make sure all desired accessories are connected and Boiler is filled with the correct amount of water (refer to Pages 7-10 for details).

1. For first-time use, remove protective plastic cover that is shipped on electrical plug. Plug power cord into a convenient 3-prong electrical outlet. Heating Indicator Light will illuminate to show that unit is receiving power and Boiler has begun to heat.

CAUTION: This unit uses a grounded (3-prong) electrical plug. Use only in properly installed 3-prong electrical outlets. Do not attempt to alter plug or circumvent this safety feature in any way.

2. After approximately 3-4 minutes, Heating Indicator Light will turn off. This indicates that Boiler is fully heated, and unit is ready to begin steaming.

NOTE: Heating Indicator Light may cycle off and on during use, accompanied by a slight temporary drop in steam pressure - this is normal.

3. Point Steam Nozzle (and any connected accessories) towards surface you wish to steam, and press Steam Button. Hold Button down for a continuous flow of steam.

CAUTION: Always be sure that Steam Nozzle and other accessories are pointed in a safe direction (away from yourself, other people, pets, and plants) before pressing Steam Button.

NOTE: When steaming any surface for the first time, it is recommended that you consult the manufacturer's guidelines for material being steamed. For items in question, test steam on an inconspicuous area before proceeding.

4. Using a slight back-and-forth motion over the area you are steaming will enhance the cleaning process, as will scrubbing the area (if a Utility Brush is connected). Wipe steamed areas with a clean cloth to remove loosened dirt and grime.

CAUTION: Wiping an area while it is still wet is recommended, but use care when wiping surfaces such as metal that may still be hot.

5. To effectively kill bacteria and other microorganisms, hold Steam Nozzle (and any connected accessories) approximately 1/2 inch from surface and press Steam Button. Keep Button held and concentrate steam on the same spot for at least 5 seconds.
6. Full Boiler (6 oz. / 177 ml.) will provide approximately 8 minutes of steam. If you wish to continue steaming, refer to procedure on Page 10 to refill Boiler.
7. Once you are finished using your *Handheld Steam Cleaner*, immediately unplug power cord from electrical outlet. Refer to Page 12 for proper cleaning and storage procedures.

PROPER STORAGE

Preparing your *Handheld Steam Cleaner* for storage is quick and simple. When you have finished your steaming tasks, follow the steps listed below.

1. Unplug power cord from electrical outlet.
2. Allow unit to cool for at least 30 minutes. Press Steam Button to release remaining steam pressure.
3. Remove all connected accessories from unit.
4. Unscrew and remove Boiler Cap. Drain any water remaining in Boiler into a sink or tub - this will help to minimize potential mineral build-up and prevent overfilling during next use.
5. Loosely replace Boiler Cap - do not screw on tightly, as this may make it difficult to remove for next use.
6. Wrap power cord loosely around unit. Store *Handheld Steam Cleaner* in a cool, dry location, along with all included accessories.

MINERAL BUILD-UP

A common maintenance need for steam appliances is the removal of build-up caused by high mineral content in many municipal water supplies. This mineral build-up may limit the effectiveness and reduce the life of your *Handheld Steam Cleaner*.

The best way to minimize mineral build-up is to use distilled or de-mineralized water when using your *Handheld Steam Cleaner*. In addition, it is recommended that the Boiler be cleaned at least once a month in order to remove any deposits that form. This will help to extend the life of your *Handheld Steam Cleaner* and keep it functioning at its maximum potential.

To clean Boiler:

1. Unplug power cord from electrical outlet.

IMPORTANT: Unit should remain unplugged during rinsing procedure.

2. Allow unit to cool for at least 30 minutes. Press Steam Button to release remaining steam pressure.
3. Remove all connected accessories from unit.
4. Unscrew and remove Boiler Cap, then drain any water remaining in Boiler into a sink or tub.
5. Using Measuring Cup, make a mixture of approximately 3 oz. (89 ml.) vinegar and 3 oz. (89 ml.) distilled water.

NOTE: For best results, it is highly recommended that distilled or de-mineralized water be used when cleaning Boiler.

6. Slowly pour water-vinegar solution into Boiler through fill hole.
7. Allow water-vinegar solution to soak in Boiler for roughly 30-45 minutes.
8. Drain water-vinegar solution out of Boiler into a sink or tub.
9. Thoroughly rinse Boiler with fresh water until vinegar odor dissipates, then replace Boiler Cap.

TROUBLESHOOTING GUIDE



PROBLEM	POSSIBLE CAUSE	SOLUTION
Unit fails to heat up. Heating Indicator Light DOES NOT illuminate.	Unit is not plugged in.	Plug power cord into electrical outlet.
	Household circuit breaker / ground fault interrupter has tripped or blown a fuse.	Reset circuit breaker / ground fault interrupter, or replace fuse. If you need assistance, contact a licensed electrician.
	Unit is damaged or otherwise in need of repair.	Immediately cease usage and unplug. Contact Customer Support for further assistance (see Page 14 for details).
Unit fails to heat up. Heating Indicator Light DOES illuminate.	Boiler is empty.	Refer to Filling Boiler with Water procedure on Page 10 for refilling instructions.
	Mineral build-up in unit.	Refer to Removing Mineral Build-Up procedure on Page 12 for cleaning instructions.
	Unit is damaged or otherwise in need of repair.	Immediately cease usage and unplug. Contact Customer Support for further assistance (see Page 14 for details).
Steam output is weak or intermittent.	Water level in Boiler is running low.	Refer to Filling Boiler with Water procedure on Page 10 for refilling instructions.
	Mineral build-up in unit.	Refer to Removing Mineral Build-Up procedure on Page 12 for cleaning instructions.

CUSTOMER SUPPORT

For problems with your *Handheld Steam Cleaner*, please refer to the troubleshooting guide located on Page 13. Additional inquiries should be directed to our Customer Support services through our Web site, www.TopInnovations.com, on the *Contact Us* Web page.

If you do not have internet access, you may also contact our Customer Support Department by telephone, at **1-800-711-6617** or **1-816-584-9700**, ext. **130** or **131**.

NOTE: In order for our customer service representatives to help you as quickly and efficiently as possible, please have the following information ready before calling:

- Purchase information (where and when you purchased this product)
- Copy of purchase receipt / proof of purchase
- Product Serial Number

PRODUCT SERIAL NUMBER

For your convenience, space has been provided below for you to record the serial number of your unit (located on the back or bottom of the unit) for easy reference when contacting our Customer Service Department.

_____ - _____

NOTES

WARRANTY INFORMATION



You must call Top Innovations Warranty Service at (800) 711-6617 and obtain a Return Authorization Number before returning any product for any reason.

30-DAY MONEY BACK POLICY

If this item does not meet your expectations, it may be returned within 30 days of the date of purchase for either a replacement or full refund of the purchase price less any shipping charges. In some circumstances, an additional restocking fee will apply.

ONE YEAR LIMITED WARRANTY

(If outside USA, additional shipping charges may apply)

Top Innovations, Inc., warrants this product to be free from defects in material and workmanship for a period of (1) one year from the date of purchase. This warranty does not cover damage caused by misuse, negligence, use by improper current or voltage, commercial use, use contrary to operating instructions or disassembly, repair or alteration by any person other than Top Innovations, Inc. Warranty Service Department.

Top Innovations, Inc., will repair or replace at its option. This warranty gives you specific legal rights and may have other rights, which may vary from state to state.

Should there be any missing or defective parts or accessories, please contact Customer Support. In most cases, it is not necessary to return the entire unit. We can ship most replacement parts directly to your home.

Upon expiration of your 1 year limited warranty, you will be advised of the cost of repair before any servicing is done. **You must have a Return Authorization Number.** For non-warranty service, please enclose a check for the amount required. Or, you may pay by money order, Visa, MasterCard, AmEx or Discover credit card.

If you need to request warranty service, or have any questions about coverage under this warranty, please visit the Warranty Service Request page on our Web site, www.TopInnovations.com. You may also email customerservice@topinnovations.com, or phone (800) 711-6617, ext 130 or 131.

Please have your product serial number ready before contacting Warranty Service Department. The serial number is located on the back or bottom of your unit.

Performance of any obligation of this Warranty, or 30-Day Money Back Policy, may be obtained by:

1. Call (800) 711-6617 for a Return Authorization Number before returning your unit. Failure to obtain a Return Authorization Number will cause a delay in service.
2. Include a copy of purchase receipt.
3. Box the item securely, in its original packaging if available. Include original packing materials and accessories unless advised otherwise by a Customer Service agent.
4. Include your name, address, telephone number, and Return Authorization Number on returned package.

Send unit postage/freight-prepaid (Top Innovations does not accept "collect" or COD returns) to:

**Top Innovations, Inc.
Warranty Service Department
6655 Troost Ave.
Kansas City, MO 64131**

Call Top Innovations, Inc., Customer Service at (800) 711-6617, or (816) 584-9700 if you have any questions about the procedures described above.



Top Innovations, Inc.

6655 Troost Ave. • Kansas City, MO 64131

TEL: (800) 711-6617 / (816) 584-9700

FAX: (816) 584-9066

www.TopInnovations.com

customerservice@topinnovations.com



PRINTED IN CHINA