

www.fogelusa.com



## Back Bar Coolers

- Sturdy, stainless steel top
- White pre-painted steel interior, ample storage space for refrigerated bar products
- Self closing doors with safety stop at 120 degrees and recesses handles, with door locks
- Strong body with thick walls, injected with CFC free polyurethane foam
- Exterior cabinet and lining made of galvanized, pre-painted steel, w/baked polyester paint
- Reinforced, adjustable, heavy-duty epoxy coated shelves
- Fully sealed galvanized steel base to prevent dirt accumulation underneath the unit
- UL Classified to ANSI/NSF 7
- Forced-air evaporator for quick temperature pull-down
- Forced-air condenser made of copper and aluminum, resistant to rust and saline environments
- Heavy-duty R-134a condensing unit with easy access for maintenance
- Incandescent interior light



Model No.	Description	Size DxLxH	Voltage	Amps	HP	Cubic Feet	Est. Ship Wt
MR-15-US	2 Doors/4 Shelves	24" x 56.25" x 36.5"	115	6.5	1/4	14.5	335#
MR-15-GL	2 Glass Doors/4 Shelves	24" x 56.25" x 36.5"	115	6.5	1/4	14.5	335#

### Fogel USA

831 Easy Cayuga St • Philadelphia, PA 19124 • 1-800-344-8222 • 1-215-464-6800  
Fax: 1-215-969-4890 • Email: sales@fogelusa.com • www.fogelusa.com

# Back Bar Coolers



## Technical Data

Model #	MR-15-US	MR-15-GL
<b>Outside Dimensions</b>		
Depth	24"	24"
Length	56.25"	56.25"
Height	36.5"	36.5"
Door Size	31.625" H x 19.375"L	31.25"H x 18.875"L
Door Type	solid swing	2 glass swing
<b>Inside Dimensions</b>		
Depth	18.625"	18.625"
Length	52.25"	52.25"
Height	31.25"	31.25"
Shelf Size	(1) 32" x 17.25" (3) 18.125" x 17.25"	(1) 32" x 17.25" (3) 18.125" x 17.25"
# of Shelves	4	4
Capacity: Cubic Foot	14.5	14.5
<b>Specifications</b>		
Operating Temperature	33°F-41°F	33°F-41°F
Refrigerant	R-134a	R-134a
Compressor Size HP	1/4	1/4
Voltage	115	115
Amperage	6.5	6.5
Cord and Plug	yes	yes
<b>Shipping Dimensions</b>		
Depth	27.625"	27.625"
Length	59.5"	59.5"
Height	41.5"	41.5"
Gross Weight lbs.	335	342
Cubic feet	40	40

- Cases are designed to operate at 75° Fahrenheit and 55% relative humidity.
- Specification subject to change without notice.



831 E Cayuga Street, Philadelphia, PA 19124 USA • (215) 464-6800 • 1-800-344-8222  
 Fax (215) 969-4890 • E-Mail: sales@fogelusa.com • www.fogelusa.com

**FOGEL GROUP USA, LLC**



### MR-15-US and MR-15-GL Side View - Plan View

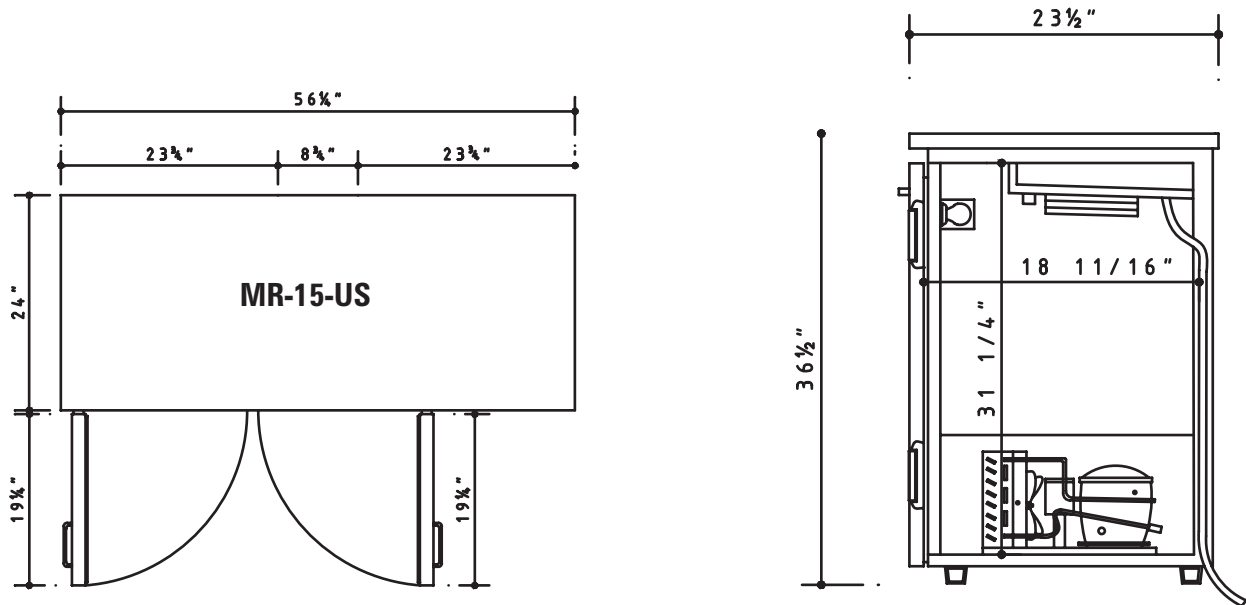

• Specification subject to change without notice.

#### **FOGEL GROUP USA, LLC**

831 E Cayuga Street, Philadelphia, PA 19124 USA • (215) 464-6800 • 1-800-344-8222  
Fax (215) 969-4890 • E-Mail: [sales@fogelusa.com](mailto:sales@fogelusa.com) • [www.fogelusa.com](http://www.fogelusa.com)

