

REFRIGERATOR TO KEGERATOR CONVERSION INSTRUCTIONS

For converting a compact
refrigerator to a draft beer system

Your kit should include the following items:

- 1 ea: CO2 Pressure Regulator
- 1 ea: Keg Coupler, American "D" Style
- 1 ea: Beer Faucet and Knob
- 1 ea: Draft Tower W/Beer Tube and Washer
- 1 ea: 5/16" Gas Line Assembly, W/Clamps
- 1 ea: Spanner Wrench
- 4 ea: 10-32 x 3-1/2" Screws
- 4 ea: 10-32 Hex Nuts
- 4 ea: Flat Washer

Additional tools required (not included)

- Tape Measure
- Power Drill
- 1/4" Drill Bit
- 2-1/2" Hole Saw
- Crescent Wrench
- Phillips Head Screwdriver
- Pliers

STEP 1:

Locate and mark on the top of the refrigerator where you would like the beer tower to be. Make sure there is enough room in front of the tower for a drip tray (not included), about 5". You may want to use masking tape to cover this area to prevent scratching. Drill a 1/4" pilot hole through the top of the refrigerator. Keep the drill as perpendicular to the top as possible. Next, cut a 2-1/2" hole through the top using the hole saw and the pilot hole as your guide. You may need to cut from both sides of the top.

STEP 2

Take the tower and drop the beer line through the hole you just cut. Position the tower with the faucet facing the front of the refrigerator. Mark the location of the (4) mounting holes. Remove the tower and drill the marked holes with the 1/4" drill bit.

STEP 3

Again, take the tower and drop the beer line through the 2-1/2" hole. Attach the tower using the provided screws, washers and nuts.

STEP 4

Attach the beer line to the keg coupler. Remove the blue cap from the keg coupler and attach the wing nut to the coupler. Make sure the black beer washer is in place to prevent any leaks. (See FIGURE 1)

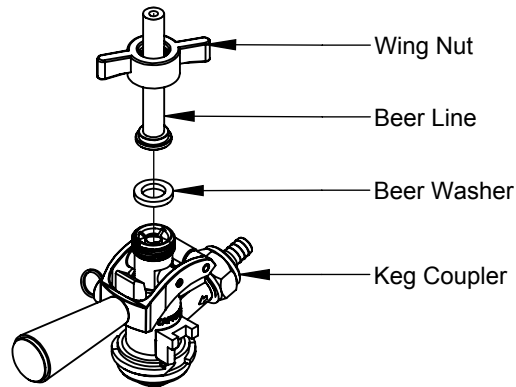

FIGURE 1

STEP 5

Attach the gas line to the keg coupler. Soak the gas line in HOT water for a minute to soften the line. Once the line is softened, simply slide the line over the barbed gas inlet of the coupler. Using a pliers, squeeze the plastic clamp to tighten. (See FIGURE 2)

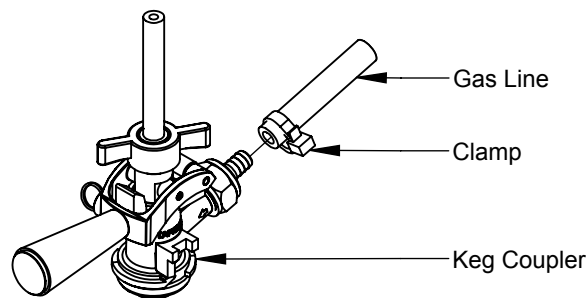

FIGURE 2

STEP 6

Attach the other end of the gas line to the CO2 regulator. Again, soak the line in HOT water to soften. Slip the line onto the barbed outlet of the CO2 regulator and clamp. (SEE FIGURE 3)

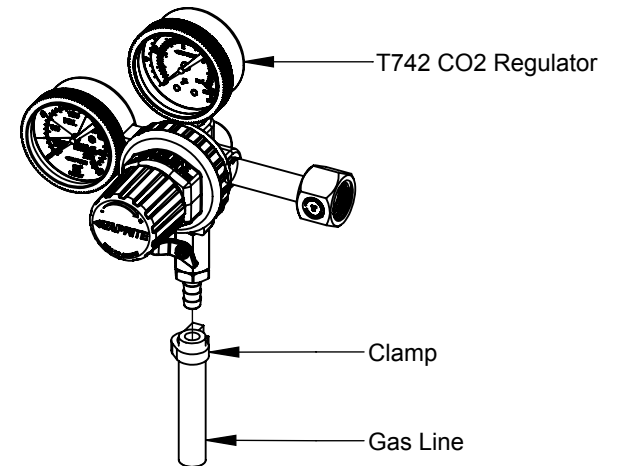

FIGURE 3

STEP 7

Attach the faucet to the draft tower using the spanner wrench to tighten. (SEE FIGURE 4)

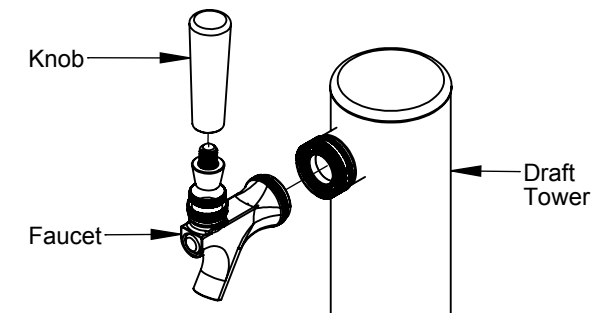

FIGURE 4

You are now ready to attach the regulator to a CO2 tank, tap your first keg and enjoy a draft beer at home! For tips and tricks on how to get the most out of your draft beer system visit www.draughtquality.org. Enjoy!