

READ AND SAVE THESE INSTRUCTIONS

AIRCARE®

SPACE SAVER **EVAPORATIVE HUMIDIFIER**

MODEL SS390DWHT USE AND CARE GUIDE

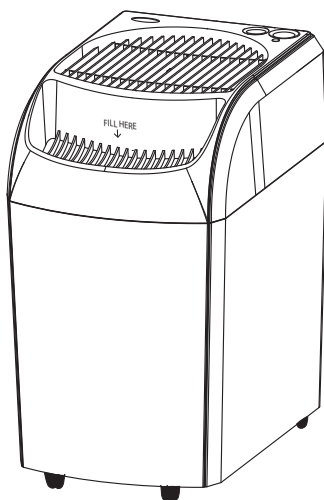

- ▶ Auto Humidistat
- ▶ Three Speed Fan
- ▶ Easy Pour-in Reservoir
- ▶ Four Casters

Français 11
Español 21



TO ORDER PARTS AND ACCESSORIES CALL 1.800.547.3888

COMFORT IS IN THE AIR

IMPORTANT SAFEGUARDS

General Safety Instructions

READ BEFORE USING YOUR HUMIDIFIER

DANGER: means if the safety information is not followed someone will be seriously injured or killed.

WARNING: means if the safety information is not followed someone could be seriously injured or killed.

CAUTION: means if the safety information is not followed someone may be injured.

1. To reduce the risk of fire or shock hazard, this humidifier has a polarized plug (one blade is wider than the other). Plug humidifier directly into a 120V, A.C. electrical outlet. Do not use extension cords. If the plug does not fully fit into the outlet, reverse plug. If it still does not fit, contact a qualified electrician to install the proper outlet. Do not change the plug in any way.
2. Keep the electric cord out of traffic areas. To reduce the risk of fire hazard, never put the electric cord under rugs, near heat registers, radiators, stoves or heaters.
3. Always unplug the unit before moving, cleaning or removing the fan assembly section from the humidifier, or whenever it is not in service.
4. Keep the humidifier clean. To reduce the risk of injury, fire or damage to humidifier, use only cleaners specifically recommended for humidifiers. Never use flammable, combustible or poisonous materials to clean your humidifier
5. Do not put foreign objects inside the humidifier.
6. Do not allow unit to be used as a toy. Close attention is necessary when used by or near children.
7. To reduce the risk of electrical hazard or damage to humidifier, do not tilt, jolt or tip humidifier while unit is running.
8. To reduce the risk of accidental electrical shock, do not touch the cord or controls with wet hands.
9. To reduce the risk of fire, do not use near an open flame such as a candle or other flame source.

WARNING: For your own safety, do not use humidifier if any parts are damaged or missing.

WARNING: To reduce risk of fire, electric shock, or injury always unplug before servicing or cleaning.

WARNING: To reduce the risk of fire or shock hazard, do not pour or spill water into control or motor area. If controls get wet, let them dry completely and have unit checked by authorized service personnel before plugging in.

INTRODUCTION

Your new humidifier adds invisible moisture to your home by moving dry inlet air through a saturated wick. As air moves through the wick, the water evaporates into the air, leaving behind any white dust, minerals, or dissolved and suspended solids in the wick. Because the water is evaporated, there is just clean and invisible moist air.

As the evaporative wick traps accumulated minerals from the water, its ability to absorb and evaporate water decreases. We recommend changing the wick at the beginning of every season. In hard water areas, more frequent replacement may be necessary to maintain your humidifier's efficiency.

Use only AIRCARE® or Essick Air® brand replacement wicks and chemicals. To order parts, wicks and chemicals call 1-800-547-3888. This humidifier uses wick # 1043. Only the AIRCARE® or Essick Air® evaporative wick guarantees the certified output of your humidifier. Use of other brands of wicks voids the certification of output and may void your warranty.

HOW YOUR HUMIDIFIER WORKS

Dry air is drawn into the humidifier top, then air is moisturized as it passes through the saturated evaporative wick in the reservoir.

The humidified air is then fanned out into the room through the lower front grille.

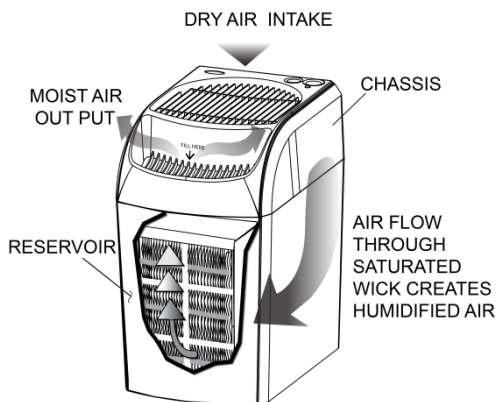

Description	SS390DWH
Water Capacity	6 gallons
Sq. ft. coverage	2300 (Tight Const.)
Fan Speeds	3
Replacement Wick	No. 1043
Adjustable Humidistat	Yes
Refill Indication	Yes
Controls	Digital
Casters	Yes (4)
ETL Listed	Yes
Volts	120
Hertz	60
Watts	70

* Based on an area with an 8' ceiling height ANSI/AHAM HU-1-1997. SEC. 8.1. Results may vary depending on average or tight construction

NOTES ON LOCATION:

In order to get the most effective use from your humidifier, it is important to position the unit where the most humidity is needed or where the moist air will be circulated throughout the house such as near a cold air return. If the unit is positioned close to a window, condensation may form on the window pane. If this occurs the unit should be repositioned in another location.

Do NOT position the unit directly in front of a hot air duct or radiator. Do NOT place on soft carpet.

Due to release of cool, moist air from the humidifier, it is best to direct air away from thermostat and hot air registers. Ensure free air flow around humidistat. Position humidifier next to an inside wall on a level place at least 4 inches away from the wall or curtains.

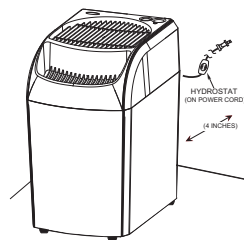

ASSEMBLY

- 1) Unpack humidifier from carton.
- 2) Remove all packaging materials. Check to see that you have all of the following items removed from the box, accessory kit and cabinet before discarding the packaging:

- Evaporative wick and wick retainer
- Caster kit
- Lift rod assembly with Styrofoam float
- Manual

CASTERS

- 3) Turn the emptied cabinet upside down. Insert each caster stem into one of the four caster holes on the corner of the humidifier bottom. The casters should fit snugly and be inserted until the stem shoulder reaches the cabinet surface.
- 4) Turn the cabinet right side up.

EVAPORATIVE WICK

- 5) Place the float assembly and attached lift rod into the boxed area on the bottom of the inside of the cabinet. Slip lift rod into retainer ring and twist to secure. The float rod should be able to freely move up and down about 3/8". The retainer ring should be located between the two ribs on the lift rod.
- 6) Place the wick assembly into the guides provided in the bottom of the cabinet and the ribs along the sides.
- 7) Place the chassis onto the cabinet ensuring that the chassis seats correctly into the front and back grooved edges.

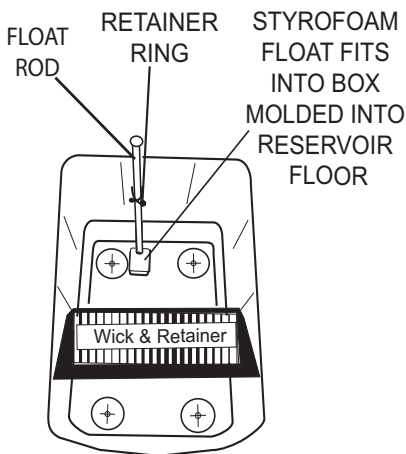

WATER FILL

CAUTION: Before filling, ensure unit is turned OFF.

- 8) With the power off, fill the reservoir with water to the level indicated on the wick frame assembly and “Fill to Here” decal on the cabinet side wall. Do not overfill. When first filled, the reservoir capacity is 6 gallons.

NOTE: When the reservoir is being filled for the first time, the dry wick absorbs water, requiring more water on the first fill up than subsequent fillings.

- 9) For subsequent fillings, turn power off, refill, then, turn unit on again.

NOTE: We recommend using AIRCARE® or Essick Air® Bacteriostat Treatment when you refill the water reservoir to eliminate bacterial growth. Add bacteriostat according to the instructions on the bottle.

NOTE: Under no circumstances should you use Water Treatment products intended for Rotobelt or Ultrasonic humidifiers.

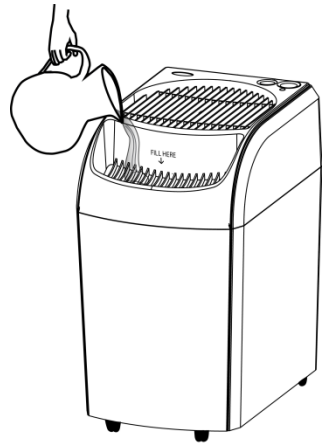

ABOUT HUMIDITY

Where you set your desired humidity levels depends on your personal comfort level, the outside temperature and the inside temperature.

NOTE: Recent CDC tests show that the chances of flu transmission are greatly reduced at levels of 43% humidity.

You may wish to purchase a hygrometer* to measure the humidity level in your home. The following is a chart of recommended humidity settings.

IMPORTANT: Water damage may result if condensation starts to form on windows or walls. Humidity SET point should be lowered until condensation no longer forms. We recommend room humidity levels do not exceed 50%.

When Outdoor Temperature is:		Recommended Indoor Relative Humidity (RH) is
°F	°C	
-20	-30°	15 - 20%
-10°	-24°	20 - 25%
2°	-18°	25 - 30%
10°	-12°	30 - 35%
20°	-6°	35 - 40%
30°	-1°	40 - 45%

*Model 1990 digital hygrometer is available for purchase by calling 1-800-547-3888.

NOTE: External hygrometer readings and humidistat readings may differ. Humidity levels can vary significantly even in one room.

OPERATION

Plug cord into wall receptacle. Your humidifier is now ready for use. The humidifier should be placed at least **FOUR** inches away from any walls and away from heat registers. Unrestricted airflow into the unit will result in the best efficiency and performance.

NOTE: This unit has a humidistat loated on the cord that senses the humidity level around the immediate area of the humidifier. It turns the fan on when the relative humidity in your home is below the humidistat setting and will turn the fan off when the relative humidity reaches the humidistat setting.

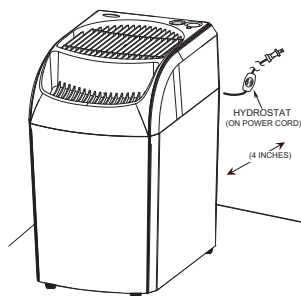

CONTROL PANEL

This unit is controlled by two buttons.

To Turn On and Off

Press and hold the portion of the button with the fan icon to turn the unit on and off.

Fan Speed

After unit is on, press the same portion of the button to adjust the speed. Fan speeds proceed from high to medium to low.

PRESS ONCE FOR POWER /
PRESS AGAIN FOR FAN SPEEDS /
PRESS AND HOLD TO TURN OFF

DIGITAL
DISPLAY

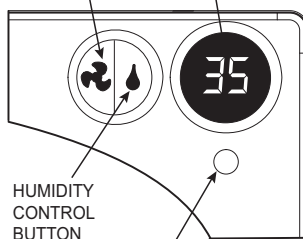

Humidity Setting

Use the portion of the button with the droplet icon to adjust humidity. Humidity settings will increase in 5% increments to 65%. Once the 65% setting is selected the humidifier will run continuously.

NOTE: When excessive condensation exists, a lower speed setting is recommended.

Display

The digital panel displays fan speed (F1 - F3) and humidity levels as they are adjusted. Once set, the room humidity will display.

OTHER INDICATIONS

CAUTION: Disconnect power before cleaning or servicing unit. Keep grille dry at all times.

REFILL INDICATION

- 1) When the unit is out of water, the display flashes F, the blue light illuminates and the motor automatically shuts off.
- 2) Refill unit according to the instructions in the **WATER FILL** section.

This humidifier has a check filter reminder timed to appear after 720 hours of operation. When the Check Filter (CF) message is displayed, disconnect the power cord and check the condition of the filter. The CF function will reset after the unit is **plugged back in**.



REPLACEMENT OF WICK

CAUTION: Before changing wick, ensure unit is turned OFF and unplugged.

NOTE: This unit uses model 1043 wick. Replace the wick at the beginning of each season, and more often in areas with hard water.

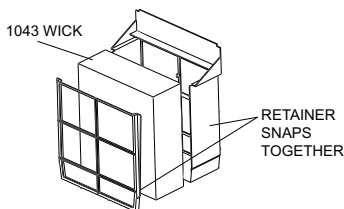

- 1) To replace wick, lift the retainer with wick out of the unit. Lay the retainer on its back, unsnap front grid from retainer frame. Extract and discard old wick. **Do not discard wick retainer.**
- 2) Insert new wick into frame and reinstall retainer front grid.

CARE AND MAINTENANCE

Cleaning your humidifier regularly helps eliminate odors and bacterial and fungal growth. Ordinary household bleach is a good disinfectant and can be used to wipe out the humidifier base and bottle/reservoir after cleaning. We recommend cleaning your humidifier at least once every two weeks to maintain optimum environmental conditions for your home. **We also recommend using AIRCARE® or Essick Air® Bacteriostat Treatment each time you refill your humidifier to eliminate bacterial growth.** Add bacteriostat according to the instructions on the bottle. Please call 1-800-547-3888 to order Bacteriostat Treatment, part number 1970.

- 1) Turn off unit completely and unplug from outlet.
- 2) Lift off the chassis.
- 3) Roll or carry the base to cleaning basin. Lift wick from the base allowing the water to drain and remove float assembly from wick. Rinse wick under fresh water only. Do not use soap, detergent, or any other cleaners on the wick. Leave in sink to drain.

REMOVING SCALE

- 4) Pour out any remaining water from the reservoir. Fill reservoir $\frac{1}{2}$ full with water and add 8 oz. (1 cup) of white vinegar. Let stand 20 minutes.
- 5) Dampen a soft cloth with undiluted white vinegar and wipe out reservoir to remove scale. Rinse the water bottle and reservoir thoroughly with fresh water to remove scale and cleaning solution before disinfecting.

DISINFECTING UNIT

- 6) Fill the reservoir $\frac{1}{2}$ full with water and add 1 teaspoon of bleach. Let solution stay for 20 minutes, then rinse with water until bleach smell is gone. Dry interior surfaces with clean cloth. Wipe down the outside of the unit with a soft cloth dampened with fresh water.
- 7) Refill unit and reassemble per **ASSEMBLY** instructions.

SUMMER STORAGE

- 1) Clean unit as outlined in Care & Maintenance section.
- 2) Discard used wick and any water in the reservoir. Do not discard wick retainer. Allow to dry thoroughly before storage. **Do not** store with water inside reservoir.
- 3) Do not store unit in an attic or other high-temperature area, as damage is probable.
- 4) Install new filter at beginning of season

REPAIR PARTS LIST

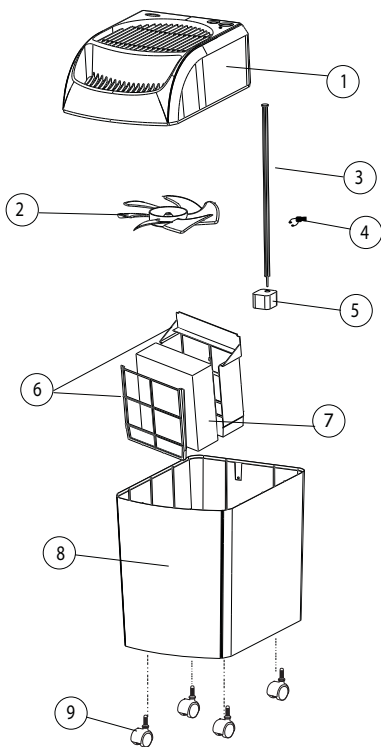

ITEM NO.	DESCRIPTION	SS390DWHT PART NO.
1	Chassis	1B72929
2	Fan Blade	1B5060470
3	Float Rod	1B72125
4	Float Rod Retainer	1B5460590
5	Float	1B5060400
6	Wick retainer	4V3398020GRYP
7	Wick	1043
8	Cabinet	4V3395020
9	Casters (set of 4)	1B5460070
13	Owner's Manual (not shown)	1B72927

Order by part number, not by item number. To order, call: 1-800-547-3888
or visit our website www.aircareproducts.com

TROUBLESHOOTING GUIDE

Trouble	Probable Cause	Remedy
Unit does not operate on any speed setting	No power to unit.	Ensure polarized plug is fully inserted in wall outlet.
	Unit has run out of water – fan will not operate without water is present.	Refill reservoir.
	Refill switch operation/improper positioning of float assy.	Ensure float assembly is correctly positioned as described in “Water Fill”, page 5.
Motor does not turn on.	<p>Check motor/fan operation.</p> 	<p>CAUTION: Do not touch the fan when accomplishing this test, as the motor may turn on.</p> <p>To test the motor, turn unit ON and turn all knobs fully ON.</p> <p>Turn the chassis over and insert finger into tab where float rod is supposed to go. If fan turns on, the fan and motor are working correctly.</p>
	If unit has overheated, motor temp-sensing fuse may have tripped.	Take unit to authorized service station. DO NOT ATTEMPT electrical repairs yourself.
	Wick may be installed incorrectly	Remove and reinstall wick correctly.
Not enough humidity.	<p>Wick is old and ineffective.</p> <p>Humidistat is not set high enough</p>	<p>Replace wick when clogged or hardened with minerals.</p> <p>Increase humidity setting on control panel.</p>
Too much humidity. (condensation becomes heavy on fold surfaces in room)	Humidistat is set too high.	Reduce humidistat setting or increase room temperature.
Water leak	Cabinet may have been overfilled. There is a safety overflow hole in rear of cabinet.	DO NOT OVERFILL cabinet. Correct water level is indicated inside of cabinet side wall.
Odor	Bacteria may be present.	<p>Clean and disinfect cabinet following Care and Maintenance instructions.</p> <p>Add EPA registered Bacteria Treatment according to instructions on the bottle.</p> <p>It may be necessary to replace the wick if odor persists.</p>

HUMIDIFIER TWO YEAR LIMITED WARRANTY POLICY

SALES RECEIPT REQUIRED AS PROOF OF PURCHASE FOR ALL WARRANTY CLAIMS.

This warranty is extended only to the original purchaser of this humidifier when the unit is installed and used under normal conditions against defects in workmanship and materials as follows:

- Two (2) years from date of sale on the unit, and
- Thirty (30) days on wicks and filters, which are considered disposable components and should be replaced periodically.

The manufacturer will replace the defective part/product, at its discretion, with return freight paid by the manufacturer. It is agreed that such replacement is the exclusive remedy available from the manufacturer and that TO THE MAXIMUM EXTENT PERMITTED BY LAW, THE MANUFACTURER IS NOT RESPONSIBLE FOR DAMAGES OF ANY KIND, INCLUDING INCIDENTAL AND CONSEQUENTIAL DAMAGE OR LOSS OF PROFITS OR REVENUES.

Some states do not allow limitations on how long an implied warranty lasts, so the above limitations may not apply to you.

Exclusions from this warranty

We are not responsible for replacement of wicks and filters.

We are not responsible for any incidental or consequential damage from any malfunction, accident, misuse, alterations, unauthorized repairs, abuse, including failure to perform reasonable maintenance, normal wear and tear, nor where the connected voltage is more than 5% above the nameplate voltage.

Alterations include the substitution of name brand components including, but not limited to wicks and bacteria treatment.

We are not responsible for any damage from the use of water softeners or treatments, chemicals or descaling materials.

We are not responsible for the cost of service calls to diagnose the cause of trouble, or labor charge to repair and/or replace parts.

No employee, agent, dealer or other person is authorized to give any warranties or conditions on behalf of the manufacturer. The customer shall be responsible for all labor costs incurred.

This warranty will be null & void if purchaser attempts to repair or replace any parts which are mechanical or electrical.

Some states do not allow the exclusion or limitation of incidental or consequential damages, so the above limitations or exclusions may not apply to you.

How to obtain service under this warranty

Within the limitations of this warranty, purchaser with inoperative units should contact customer service at **800-547-3888** for instructions on how to obtain service within warranty as listed above.

This warranty gives the customer specific legal rights, and you may also have other rights which vary from province to province, or state to state.

Register your product at www.essickair.com or www.AIRCAREproducts.com.