

## TEMPUS EXTRA BULKHEAD

LEMHBHM3



**NOTE** - To comply with regulations, installation must be carried out by qualified electrician and in accordance with the current IEE Wiring Regulations (BS7671) and Building Regulations. Battery is replaceable and LED module is non-user replaceable light source. Replacement battery is needed when they no longer meet their rated duration of operation after the corresponding recharge period. The light source contained in this luminaire shall only be replaced by the manufacturer or his service agent or similar person. Wire specification should meet 60245 IEC57, 2x1mm<sup>2</sup> (for LS not connected) or 3x1mm<sup>2</sup> (for LS connected).

### SPECIFICATIONS

- **Input Voltage:** AC220-240V 50/60Hz
- **Emergency Duration:** >3 Hours
- **Recharge Time:** 24 Hours
- **Operating Environmental Temperature:** 40°C
- **Battery:** 6.4V 3600Mah LeFeP04
- **Emergency Lumen:** 800lm



**ENSURE ELECTRICAL SUPPLY IS DISCONNECTED/ ISOLATED BEFORE COMMENCING INSTALLATION**

### OPERATION

The luminaire should be connected to the mains supply for a minimum of 24 hours before operating in emergency mode as the batteries need to be fully charged before they will provide their full rated duration. When charging or fully charged, the indicator shows green, while in emergency condition the indicator will not light up.

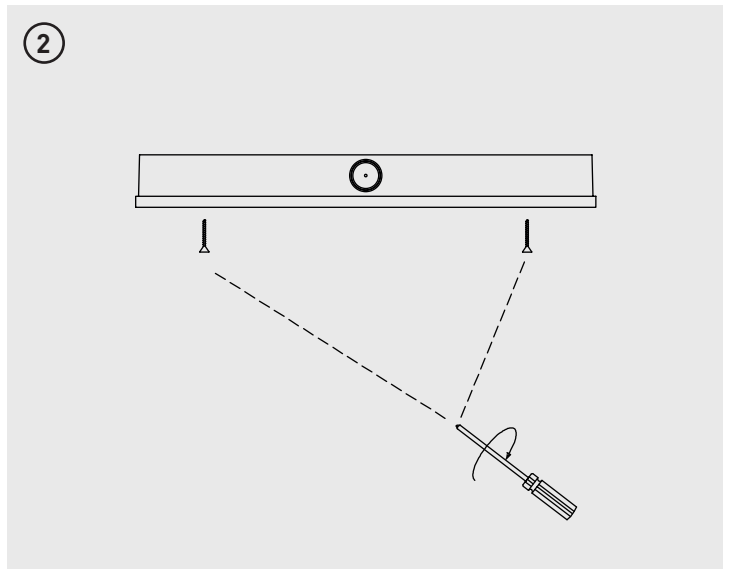
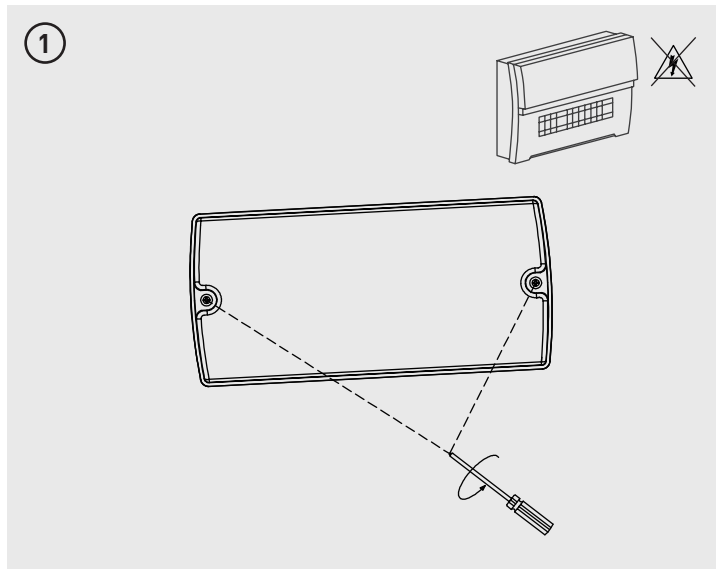

**3** **Maintained**

**INPUT**

**Connect test device to SL**

Once a month test for 30 seconds, if the lamp operates in the emergency condition, means the emergency function is normal.

Twice a year test for at least 1 hour, if the lamp operates in the emergency condition, means the emergency function is normal.

---

**Non-Maintained**

**INPUT**

**Connect test device to L**

Once a month test for 30 seconds, if the lamp operates in the emergency condition, means the emergency function is normal.

Twice a year test for at least 1 hour, if the lamp operates in the emergency condition, means the emergency function is normal.

Tech Help Line

UK - 0330 0249 279

Non UK - +44 (0)1952 238 100

Supplied by LUCECO  
Stafford Park 1, Telford, Shropshire,  
England, TF3 3BD

Visit our website at [www.luceco.com](http://www.luceco.com)

Servicio de asistencia telefónica

UK - 0330 0249 279

Non UK - +34 93 829 55 74

(EU) Luceco SE  
C/ Bobinadora 1-5  
08302 Mataró Spain

Visite nuestra web en [www.luceco.com](http://www.luceco.com)

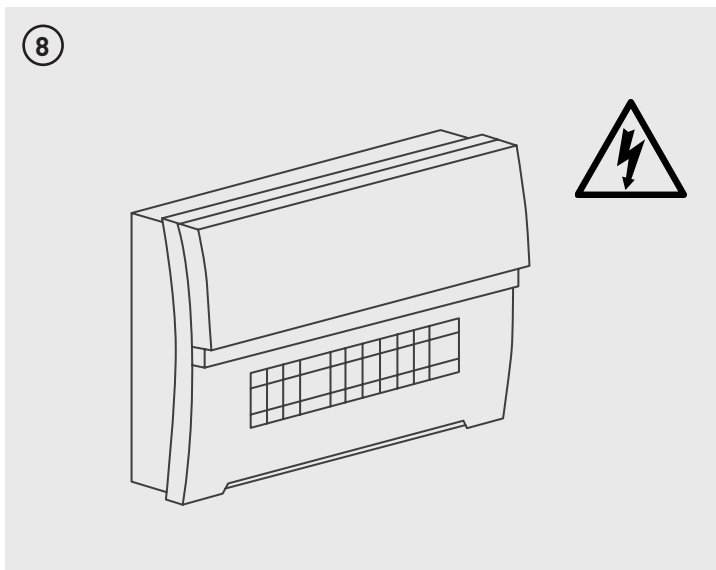
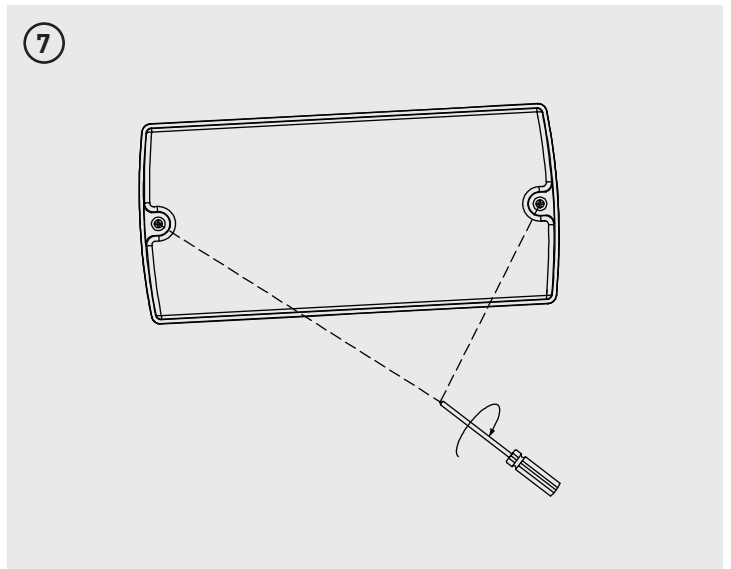
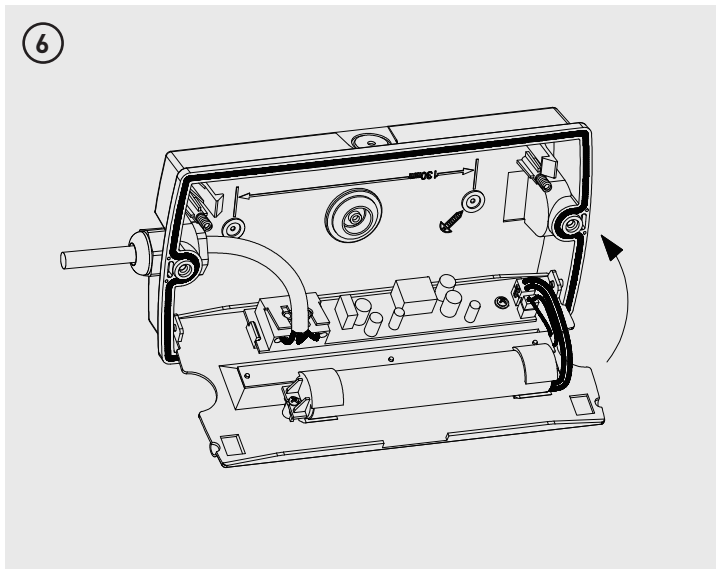
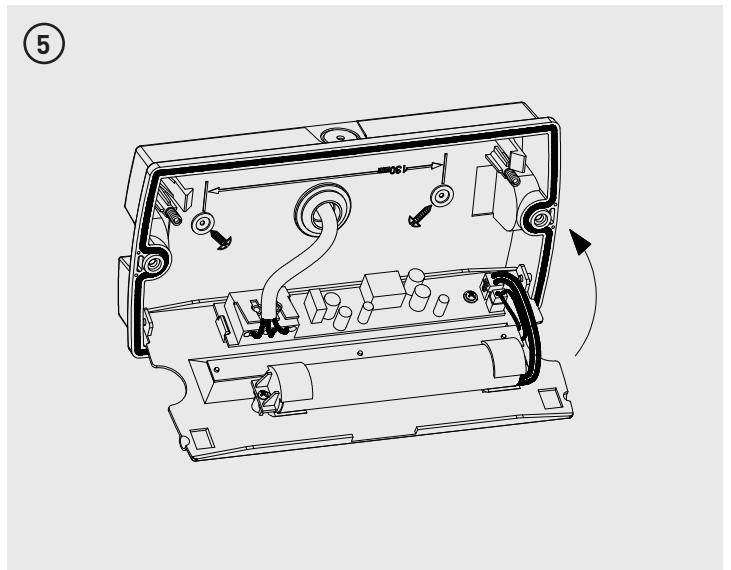
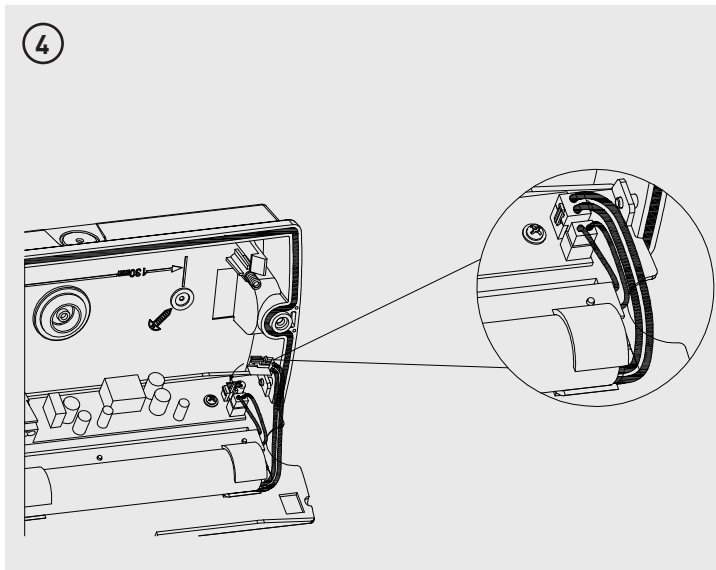

Tech Help Line

UK - **0330 0249 279**

Non UK - **+44 (0)1952 238 100**

Supplied by LUCECO  
Stafford Park 1, Telford, Shropshire,  
England, TF3 3BD

Visit our website at [www.luceco.com](http://www.luceco.com)

Servicio de asistencia telefónica

UK - **0330 0249 279**

Non UK - **+34 93 829 55 74**

(EU) Luceco SE  
C/ Bobinadora 1-5  
08302 Mataró Spain

Visite nuestra web en [www.luceco.com](http://www.luceco.com)

## RECOMMENDED ROUTINE PROCEDURE

The following test is designed to ensure the continued protection of your premises and occupants. Because of the possibility of a failure of the normal lighting supply occurring shortly after a period of testing, all tests should, whenever possible, be undertaken at times of least risk, e.g. during daylight hours.

### ONCE A DAY

Visual inspection of battery charge LED.

### ONCE A MONTH

Each unit should be energized from its battery for about 30 seconds by simulation of a failure of the normal lighting supply to ensure the lamp operates in the emergency condition.

### TWICE A YEAR

Each unit should be energized from its battery for a continuous period of at least one hour.

### AFTER THREE YEARS & EACH SUBSEQUENT YEAR

All units with specified durations in excess of 1 hour should be energized for their full rating period.

## ROUTINE TEST RECORD

Month	Test	First Year		Second Year		Third Year		Fourth Year		Fifth Year	
		Signed	Date	Signed	Date	Signed	Date	Signed	Date	Signed	Date
1	Function										
2	Function										
3	Function										
4	Function										
5	Function										
6	Function										
7	Function										
8	Function										
9	Function										
10	Function										
11	Function										
12	Function										

## EXPLANATION OF LED INDICATOR

	COLOUR	LED INDICATION	STATUS	COMMENT
	Green	Slow flashing green (3 sec on, 1 sec off)	Charging mode	AC mode
	Green	Permanent Green	Fully charged	AC mode
	Green	Fast flashing green (0.1 sec on, 0.1 sec off)	Function test underway	
	Green	Slow flashing green (1 sec on, 1 sec off)	Duration test underway	
	Red	Permanent red	Load failure	Open circuit/short circuit failure/LED failure (emergency mode)
	Red	Slow flashing red (1 sec on, 1 sec off)	Battery failure	Battery failed the duration test or function test/no battery
		Green and red off	DC mode	Battery operation (emergency mode)

Tech Help Line

UK - 0330 0249 279

Non UK - +44 (0)1952 238 100

Supplied by LUCECO  
Stafford Park 1, Telford, Shropshire,  
England, TF3 3BD

Visit our website at [www.luceco.com](http://www.luceco.com)

Servicio de asistencia telefónica

UK - 0330 0249 279

Non UK - +34 93 829 55 74

(EU) Luceco SE  
C/ Bobinadora 1-5  
08302 Mataró Spain

Visite nuestra web en [www.luceco.com](http://www.luceco.com)