

SUSPENDED LINEAR LINEA

LLA12WDCC, LLA15WDCC



This Luminaire contains two light sources of Class <D>



- ES** Esta luminaria contiene dos fuentes luminosas de clase <D>
- FR** Ce luminaire contient deux sources lumineuses de classe <D>
- IT** Questo apparecchio di illuminazione contiene due sorgenti luminose di Classe <D>
- PT** Esta luminária contém duas fontes de luz de classe <D>
- DE** Diese Leuchte enthält zwei Lichtquellen der Klasse <D>

<p>ASSEMBLY AND INSTALLATION EN</p> <ul style="list-style-type: none"> This product is only suitable for indoor use This product must be disconnected before insulation resistance testing of the lighting circuit 	<p>MONTAJE E INSTALACIÓN ES</p> <ul style="list-style-type: none"> Este producto sólo es adecuado para uso interior Este producto debe ser desconectado antes de ensayar, en el circuito eléctrico, la resistencia de aislamiento 	<p>NOTICE D'ASSEMBLAGE ET DE MONTAGE FR</p> <ul style="list-style-type: none"> Ce produit est uniquement réservé à une installation intérieure Ce produit doit être déconnecté avant tout test de résistance du circuit d'éclairage
<p>MONTAGGIO E INSTALLAZIONE IT</p> <ul style="list-style-type: none"> Questo prodotto è adatto solo per uso interno Questo prodotto deve essere scollegato prima del test di resistenza di isolamento del circuito di illuminazione 	<p>MONTAGGIO E INSTALLAZIONE PT</p> <ul style="list-style-type: none"> Este produto é adequado apenas para uso interno Este produto deve ser desconectado antes do teste de resistência de isolamento do circuito de iluminação 	<p>ZUSAMMENBAU UND INSTALLATION DE</p> <ul style="list-style-type: none"> Nur zur Verwendung in trockenen Räumen Vor der Isolationswiderstandsprüfung muß das Produkt von der Spannungsversorgung getrennt werden

LIGHT SOURCE WARNING
The light source contained in this luminaire shall only be replaced by the manufacturer or service agent or a suitably qualified person

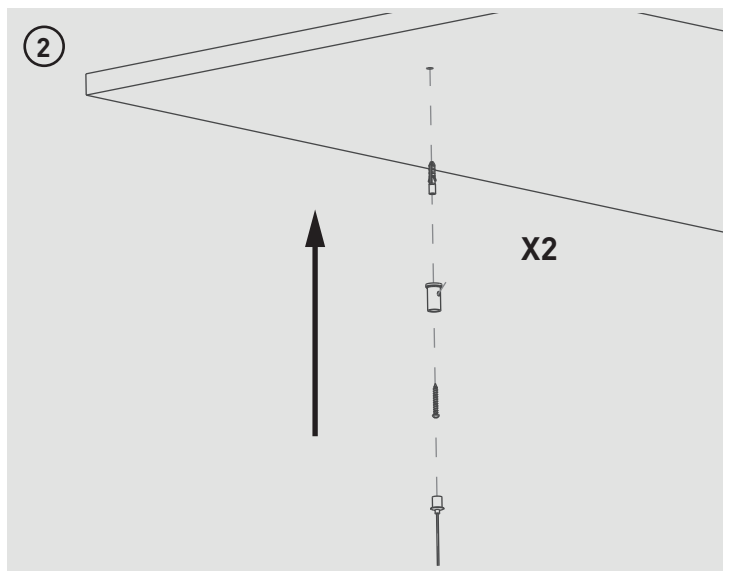
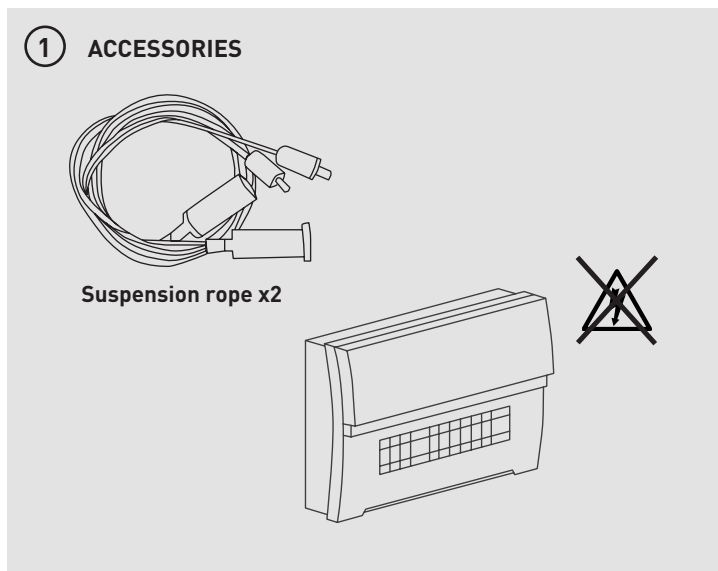
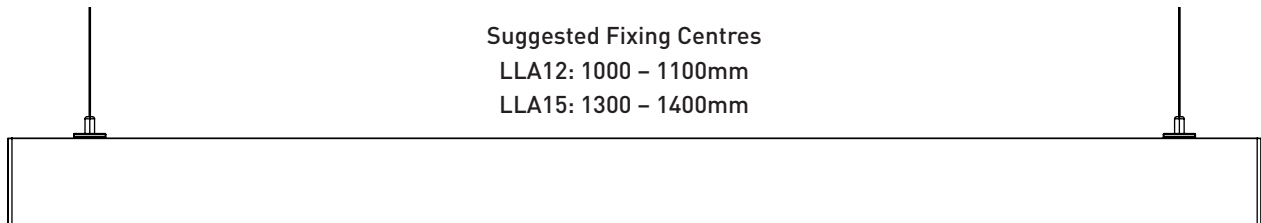

Tech Help Line
UK - 0330 0249 279
Non UK - +44 (0)1952 238 100
Luceco plc, Telford, TF3 3BD, UK.

Visit our website at www.luceco.com

Servicio de asistencia telefónica
UK - 0330 0249 279
Non UK - +34 93 829 55 74

Luceco SE, Barcelona, 08460, ES.
Visite nuestra web en www.luceco.com

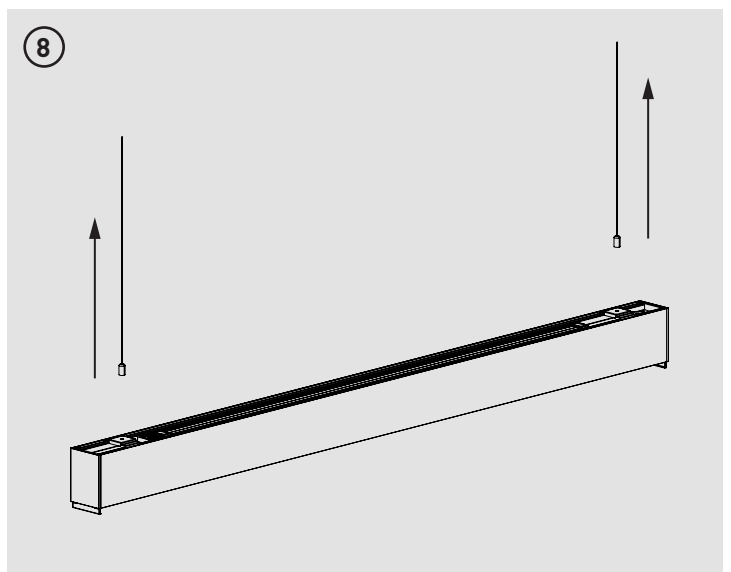
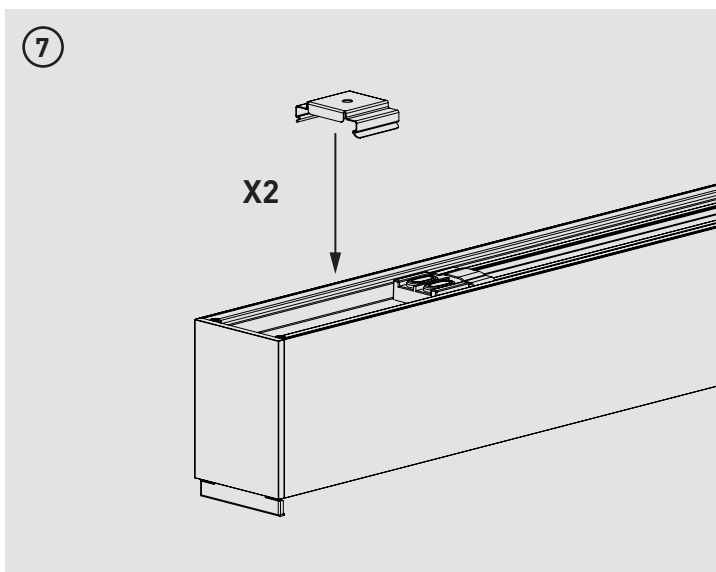
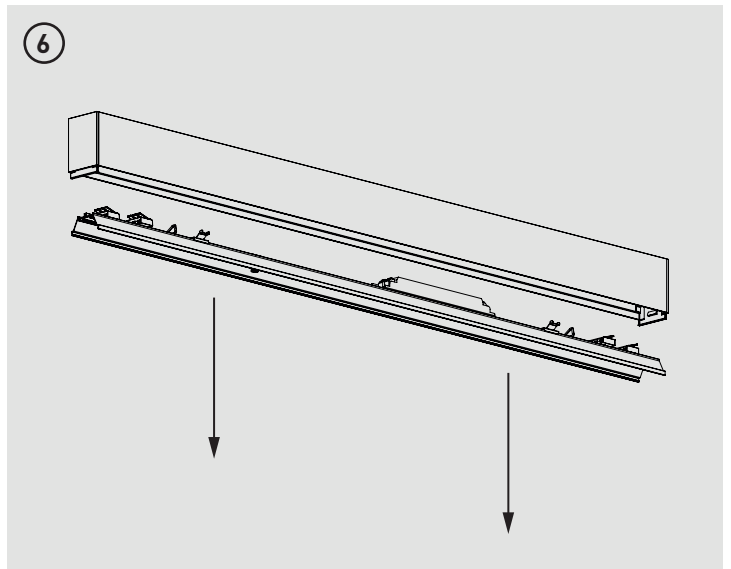
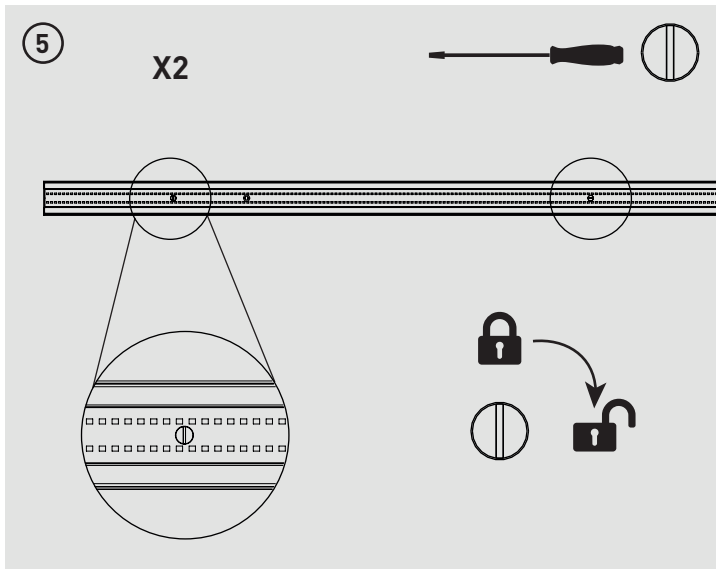
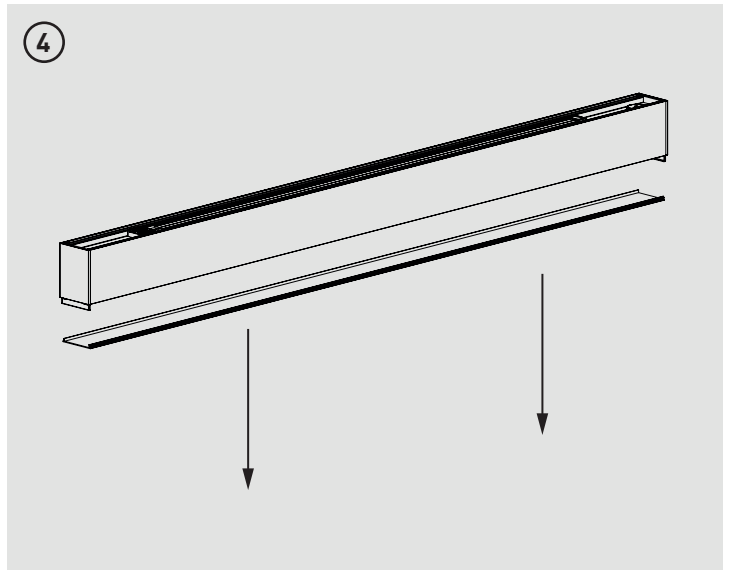
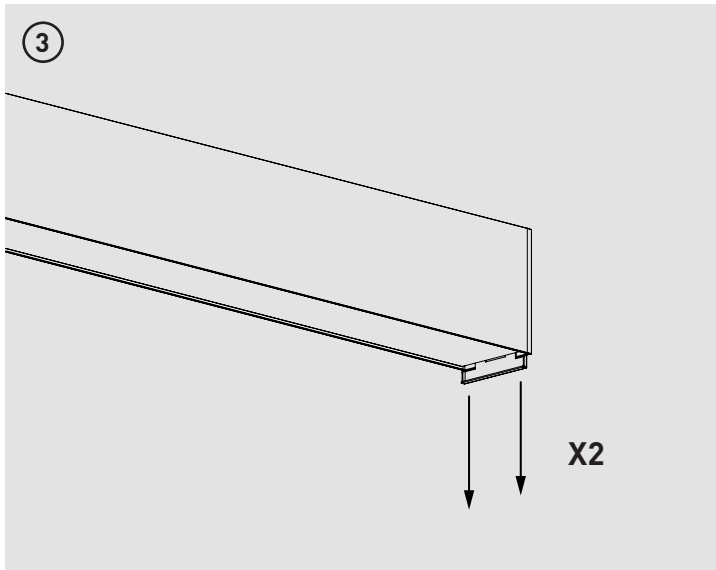

Tech Help Line

UK - 0330 0249 279
Non UK - +44 (0)1952 238 100

Luceco plc, Telford, TF3 3BD, UK.

Visit our website at www.luceco.com

Servicio de asistencia telefónica

UK - 0330 0249 279
Non UK - +34 93 829 55 74

Luceco SE, Barcelona, 08460, ES.

Visite nuestra web en www.luceco.com

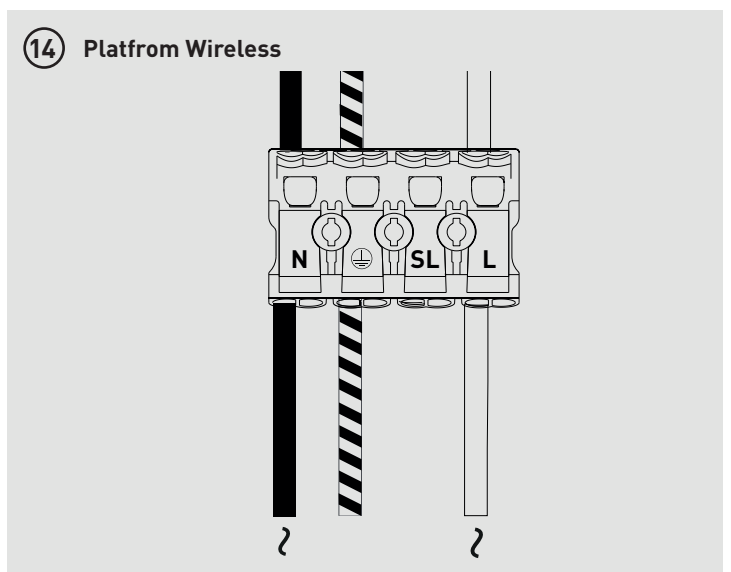
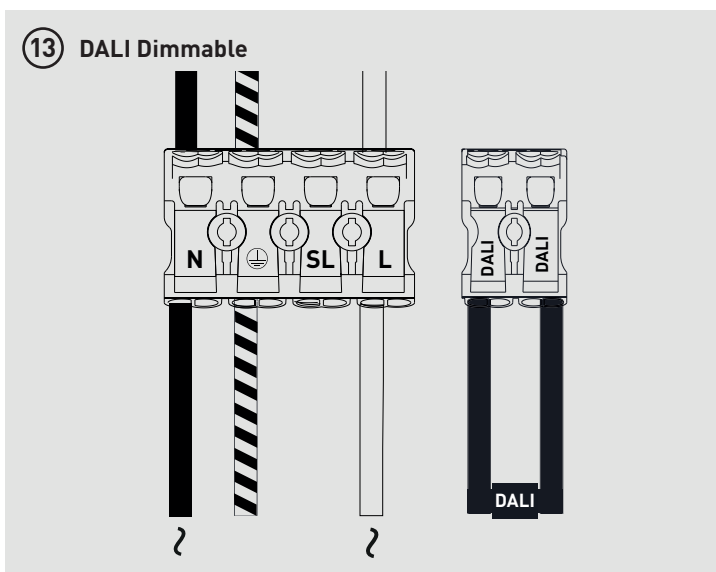
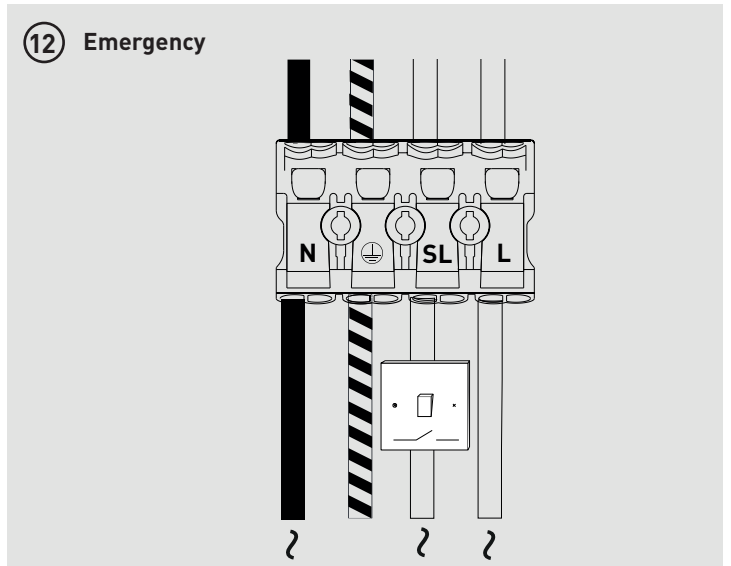
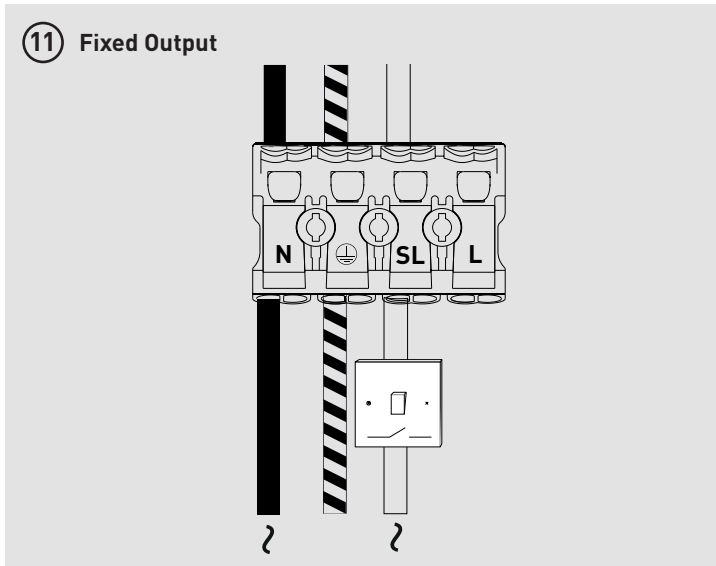
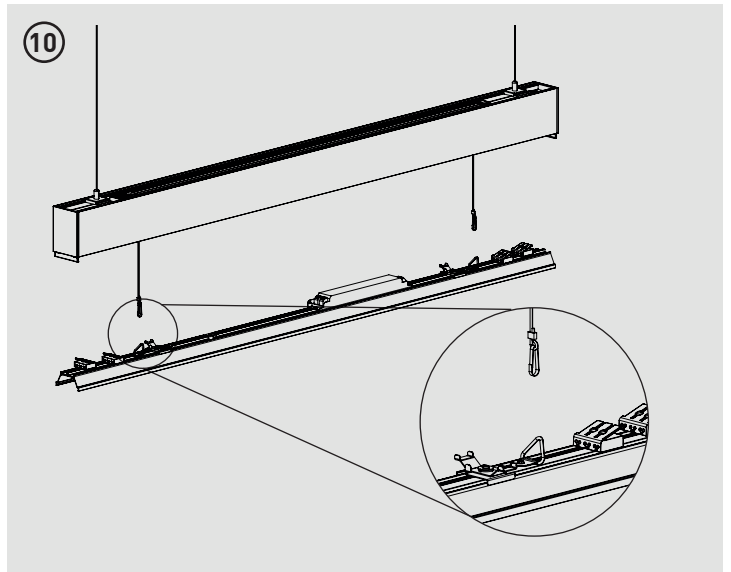
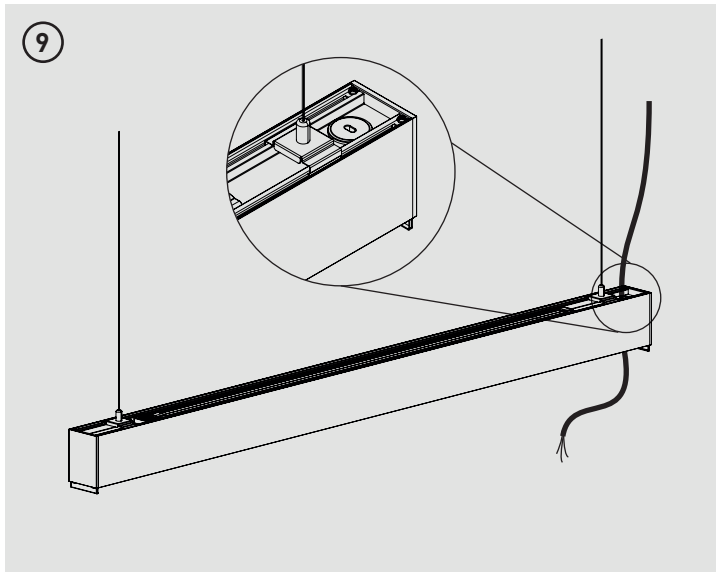

Tech Help Line

UK - 0330 0249 279
Non UK - +44 (0)1952 238 100

Luceco plc, Telford, TF3 3BD, UK.

Visit our website at www.luceco.com

Servicio de asistencia telefónica

UK - 0330 0249 279
Non UK - +34 93 829 55 74

Luceco SE, Barcelona, 08460, ES.

Visite nuestra web en www.luceco.com

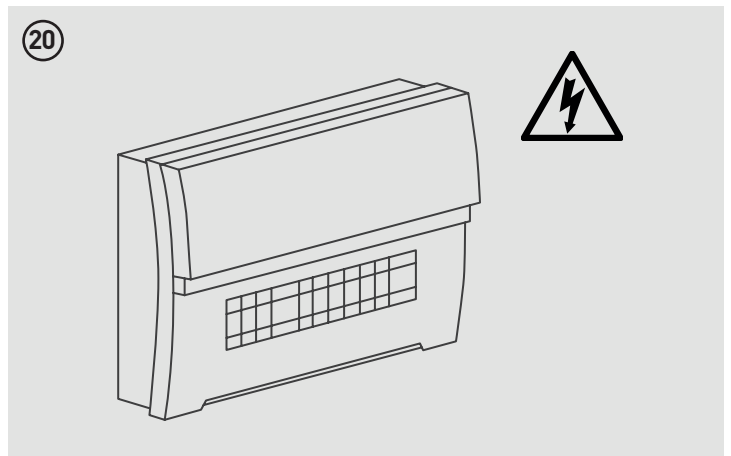
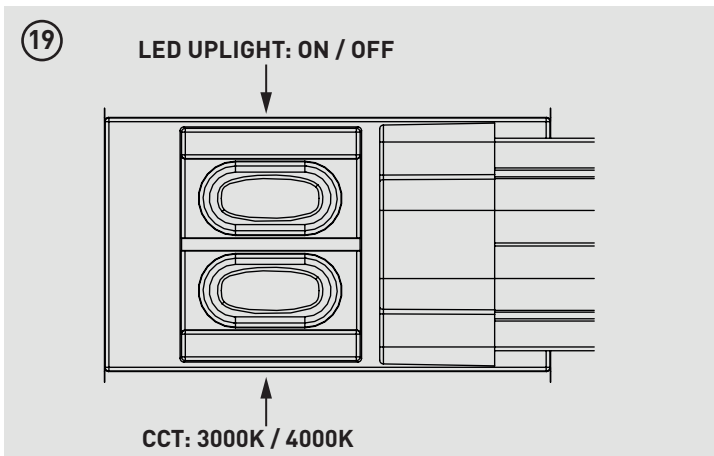
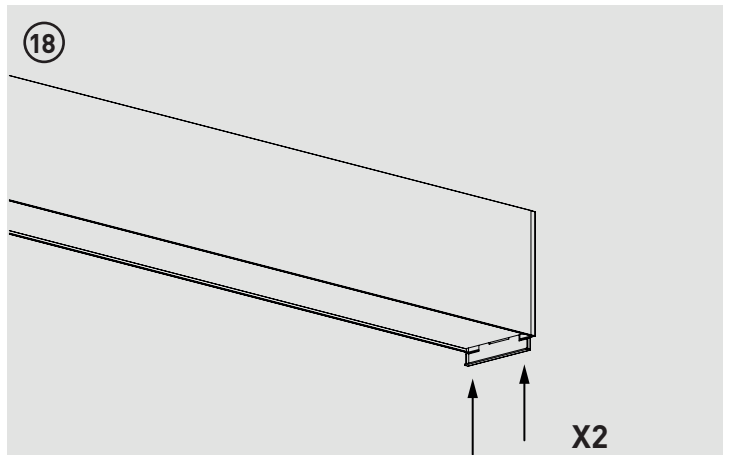
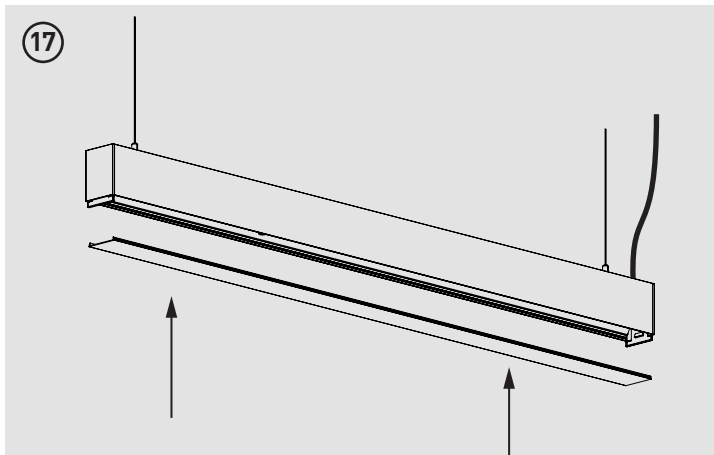
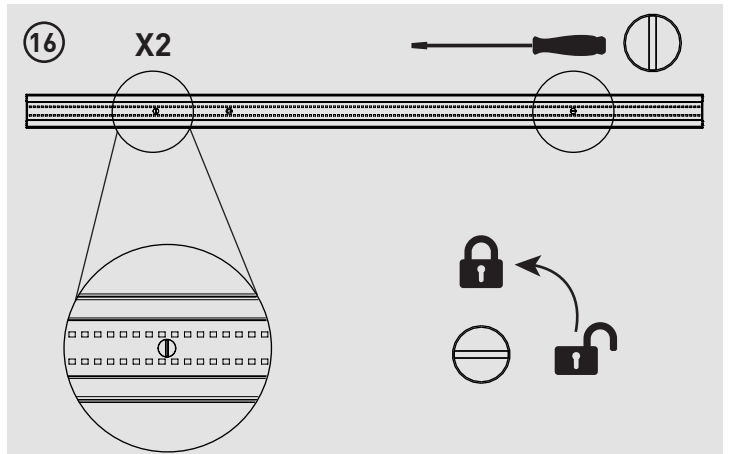
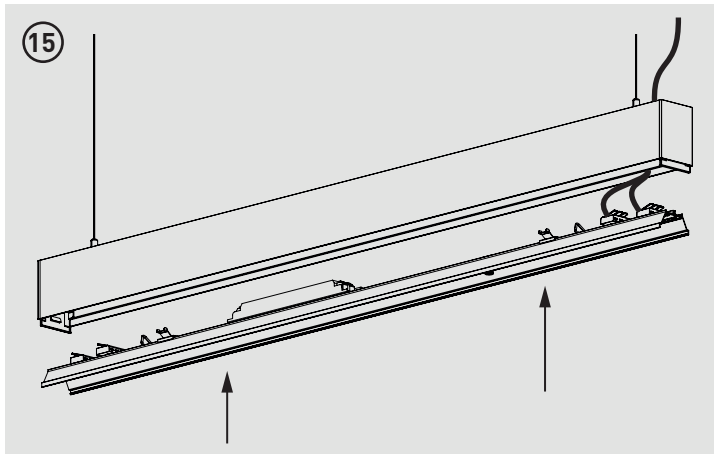

LINEA DIP-SWITCH LUMENS SETTING

LLA12WDCC

Setting	Power	Lm/m	1	2	3	4
3600lm, 600 mA (pre-set)	25.5 W	3000	ON	-	-	ON
3100 Lm, 500 mA	22 W	2600	ON	ON	-	ON
2400 Lm, 400 mA	17 W	2100	ON	-	ON	ON
1900 Lm, 300 mA	13.5 W	1600	ON	ON	ON	ON

LLA15WDCC

Setting	Power	Lm/m	1	2	3	4
4500 Lm, 750 mA (pre-set)	32 W	3000	-	ON	ON	-
3600 Lm, 650 mA	25.5 W	2600	-	-	-	ON
3000 Lm, 550 mA	21.5 W	2100	-	ON	-	ON
2400 Lm, 400 mA	17 W	1600	ON	-	ON	ON

Tech Help Line

UK - **0330 0249 279**
Non UK - **+44 (0)1952 238 100**

Luceco plc, Telford, TF3 3BD, UK.

Visit our website at www.luceco.com

Servicio de asistencia telefónica

UK - **0330 0249 279**
Non UK - **+34 93 829 55 74**

Luceco SE, Barcelona, 08460, ES.

Visite nuestra web en www.luceco.com

ACCESSORY

LINEA CONTINUOUS CONNECTOR

LLACON

MECHANICAL CONNECTION

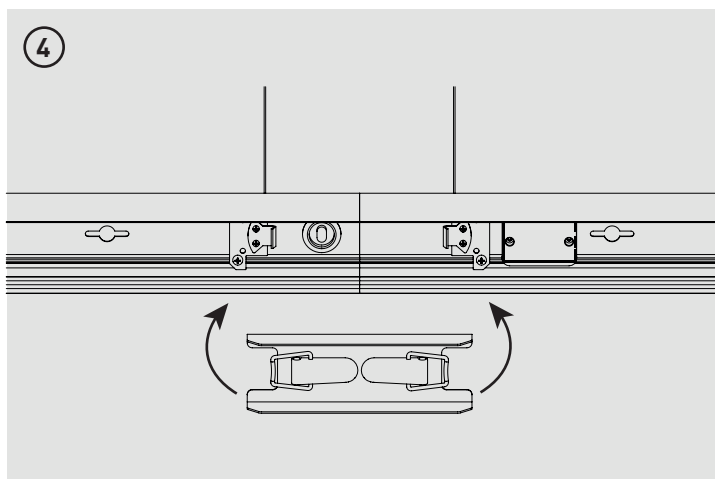
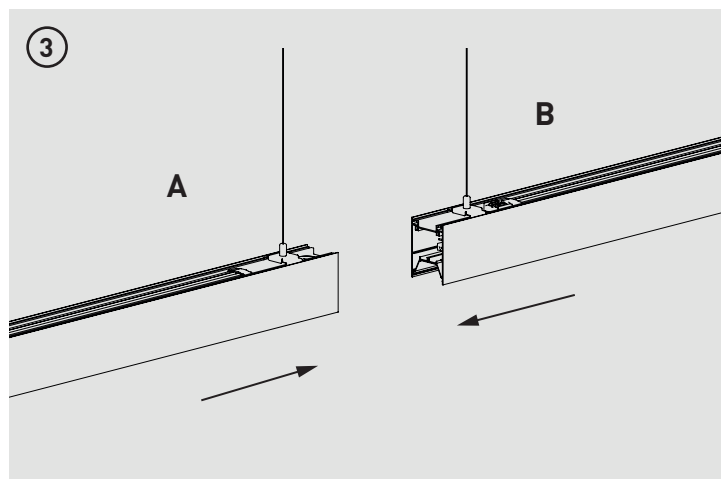
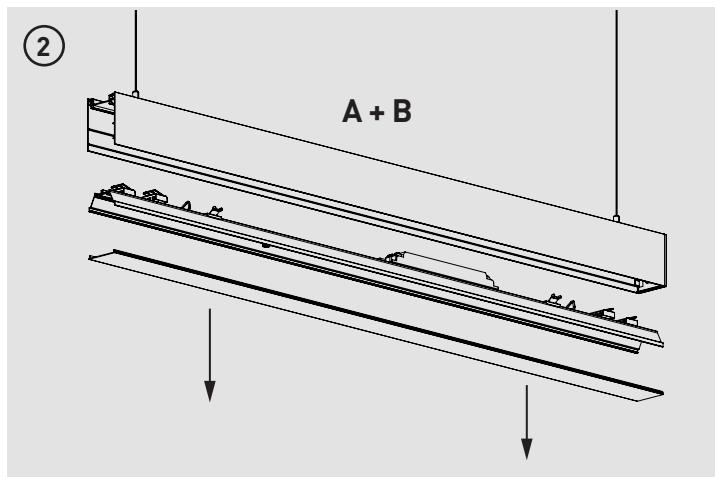
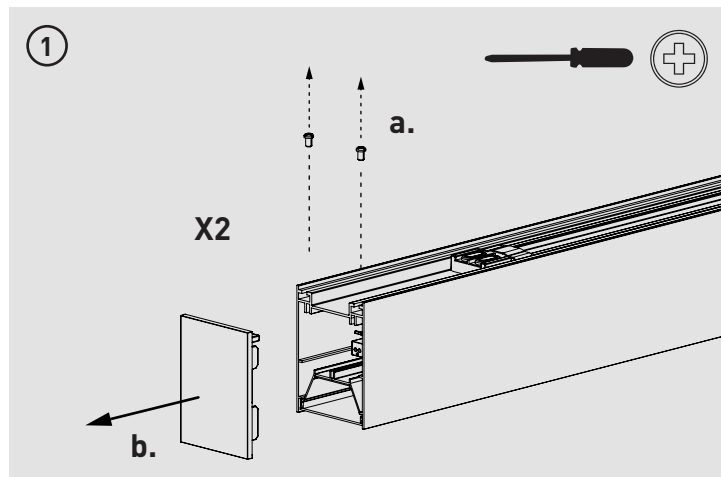

ELECTRICAL CONNECTION

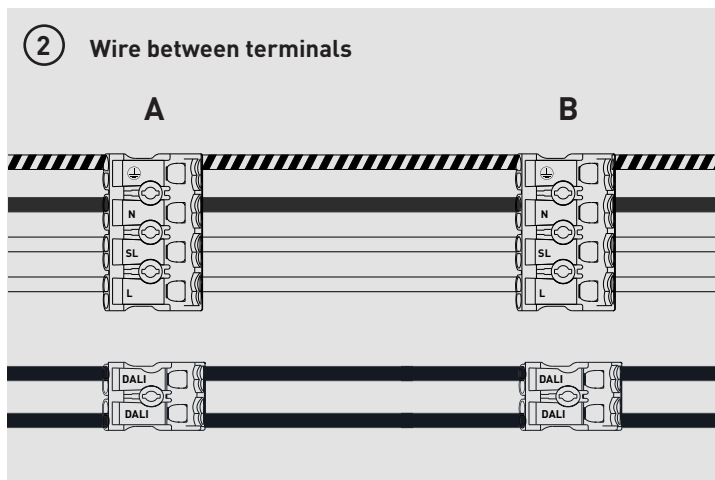
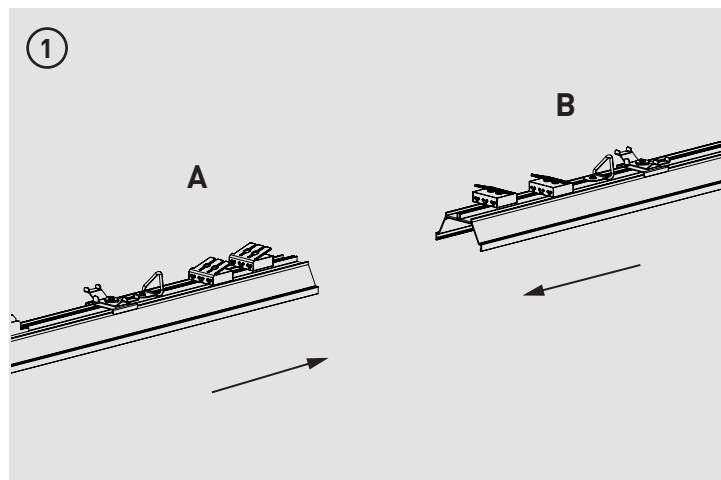

Tech Help Line

UK - 0330 0249 279
Non UK - +44 (0)1952 238 100

Luceco plc, Telford, TF3 3BD, UK.

Visit our website at www.luceco.com

Servicio de asistencia telefónica

UK - 0330 0249 279
Non UK - +34 93 829 55 74

Luceco SE, Barcelona, 08460, ES.

Visite nuestra web en www.luceco.com

ACCESSORY

LINEA L-SHAPED LINKABLE MODULE

LLACONLWCC

This Luminaire contains two light sources of Class <C>

- ES** Esta luminaria contiene dos fuentes luminosas de clase <C>
- FR** Ce luminaire contient deux sources lumineuses de classe <C>
- IT** Questo apparecchio di illuminazione contiene due sorgenti luminose di Classe <C>



- PT** Esta luminária contém duas fontes de luz de classe <C>
- DE** Diese Leuchte enthält zwei Lichtquellen der Klasse <C>

MECHANICAL CONNECTION

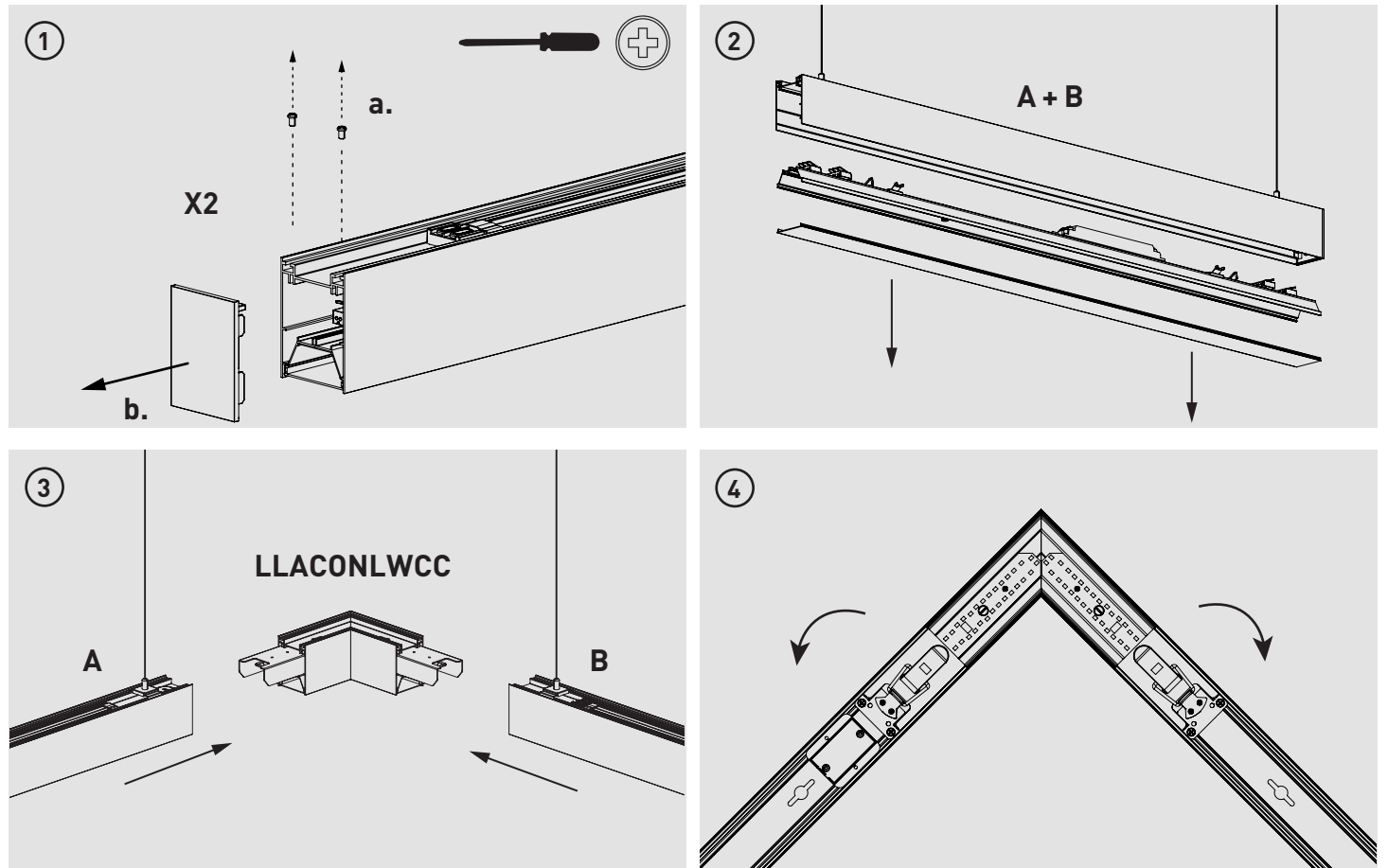

ELECTRICAL CONNECTION

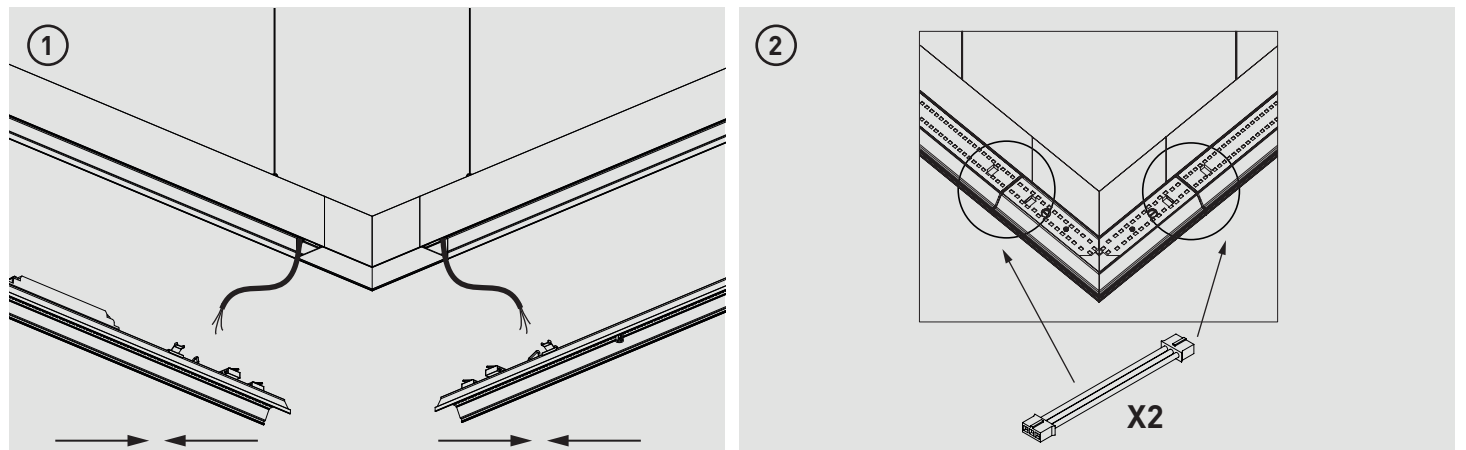

Tech Help Line

UK - 0330 0249 279
Non UK - +44 (0)1952 238 100

Luceco plc, Telford, TF3 3BD, UK.

Visit our website at www.luceco.com

Servicio de asistencia telefónica

UK - 0330 0249 279
Non UK - +34 93 829 55 74

Luceco SE, Barcelona, 08460, ES.

Visite nuestra web en www.luceco.com