



heavy duty round pin plug



WORK

POWER

ideal for power tools, DIY and workshop use

FEATURES

- Heavy duty construction
- Impact resistant, sleeved pins
- Round pin 15A plug
- Ideal for heavy duty power applications

PRODUCT IMAGES



HDPT15B

LINE DRAWING

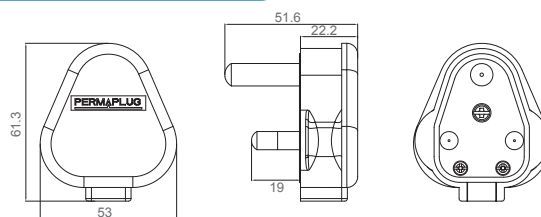

PRODUCT INFORMATION

Part Number	HDPT15B
Product Dimensions	Height 61.3mm x Width 53mm x Depth 51.6mm

TECHNICAL SPECIFICATIONS

Standard(s)	This product is certified to applicable British safety standards
	BS 546
Maximum Load (Wattage)	15A: 3600 Watts, 240 Volts
IF IN DOUBT CONSULT A QUALIFIED ELECTRICIAN	



SAFETY WARNING

PLEASE READ CAREFULLY AND USE IN ACCORDANCE WITH OUR SAFETY INSTRUCTIONS BELOW

- ☒ **DO** Follow the wiring instructions carefully.

