



# Wiring Accessories

## Single to Double Converter Socket

### Wiring Instructions

#### 1. Power Off

Before commencing work always isolate the power at the consumer unit / fuse box.

\*Note – If your installation uses a four-lug metal mounting box, remove the top and bottom lugs or bend fully back.

#### 2. Removal of Existing Accessory

1. Unscrew the accessory from the wall/mounting box.
2. Note the cable connections:

There will generally be three different wiring configurations, the wiring diagram shows 2 wires of each colour connected to each terminal (there could be 1 or 3 wires of each colour connected to each terminal) plus an additional connection between the mounting box earth terminal and the socket earth terminal.

#### 3. Connection (See diagram)

1. Line up the new accessory to mounting box and take note of where each terminal is located.
  2. Connect each wire to the matching terminal.  
An earth connection should always be made between the mounting box earth terminal and the accessory earth terminal, where fitted.
- All bare earth wires must be sheathed with green/yellow sleeving. When connecting the new accessory ensure that only the bare end of the wire enters the terminal and no bare wires are visible.
3. Tighten terminal screws securely. [Do not over tighten]
  4. This socket is fitted with two linked terminals to provide a dual earth facility. This is for use in "clean" installations where additional earth capacity is required to comply with Regulation 607 IEE Wiring Regulations.

#### 4. Complete Installation & Test

1. Carefully position the accessory into the mounting box, ensuring that no wires are trapped between the plate and the wall and secure with screws [do not over tighten] then insert screw covers (optional).
2. Once the installation has been completed correctly, replace the fuse/reset MCB (trip), switch the power back on at the consumer unit and test.

For your safety, this product must be installed in accordance with local Building Regulations. **If in any doubt, or where required by the law, consult a competent person who is registered with an electrical self-certification scheme.** Further information is available online or from your Local Authority.

Please read carefully and use in accordance with these safety wiring instructions. Before commencing any electrical work ensure the supply is switched off at the mains. Either by switching off the consumer unit or by removing the appropriate fuse or turning off MCB (trip). Wiring should be in accordance with the latest edition of the IET regulations (BS 7671). To prevent fire hazard always use cable of the correct rating & type for the application.

**Warning do not exceed the load rating of this device as stated on the rear of the product.**

#### Wire Identification – Twin & Earth Cable

Note - As from 1st April 2004 new colour codes for hard wire installations were introduced.

**EARTH** = Green/Yellow Sleeving

**NEUTRAL** = Black (pre Apr 04) / Blue (after Apr 04)

**LIVE** = Red (pre Apr 04) / Brown (after Apr 04)



#### Removal of Existing Accessory

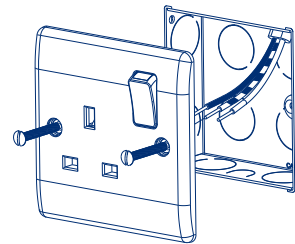

#### Wiring Diagram

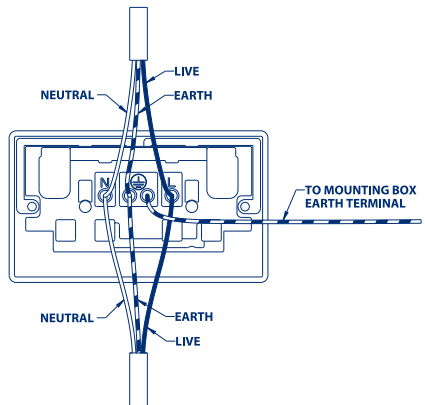

#### Fitting New Converter Socket

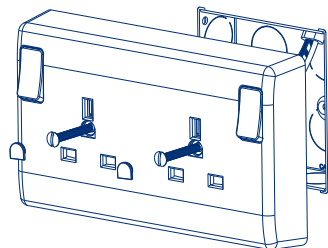

## Care

To maintain the high quality appearance of your switches and sockets, BG Electrical recommend the use of a soft cloth periodically to clean the front face.

## Technical

Voltage : 220-240V ac

Frequency : 50/60Hz

Rating : 13A

Terminal capacity : 3 x 2.5mm<sup>2</sup> 3 x 4mm<sup>2</sup> 2 x 6.0mm<sup>2</sup>

Min box depth (profiled plates) : 25mm

### ASTA Approved

The ASTA quality mark is evidence that the product has been independently tested to comply with the relevant clauses of the applicable standards.



## Batch Code explanation

yyWxx Manufacturing date code, year of manufacture (yy) and week of manufacture (Wxx)

## Address/Helpline

### Luceco PLC

Stafford Park 1  
Telford TF3 3BD  
ENGLAND

### (EU) Luceco SE

C/ Bobinadora 1-5  
08302 Mataró  
SPAIN

If you have further technical assistance you can get in touch with our

#### Technical Helpline on:

**+44 (0)3300 249 279**

**[technical.support@bgelectrical.co.uk](mailto:technical.support@bgelectrical.co.uk)**

## Environmental Protection



This symbol is known as the "Crossed-out Wheelie Bin Symbol". When this symbol is marked on a product or battery, it means that it should not be disposed of with your general household waste. Some chemicals contained within electrical/electronic products or batteries can be harmful to health and the environment. Only dispose of electrical/electronic/battery items in separate collection schemes, which cater for the recovery and recycling of materials contained within. Your co-operation is vital to ensure the success of these schemes and for the protection of the environment.