



Smart!

Smart Socket Installation Guide

Control your Power by:



Mobile



Voice



Touch

- Control Power Anywhere
- On/Off Power Control
- Timer & Scheduling

Wiring Instructions

1. Power Off

Before commencing work always isolate the power at the consumer unit / fuse box.

2a. Replacing An Existing Socket (Removal)

1. Unscrew the socket from the wall/mounting box.
2. Note the cable connections: There will generally be three different wiring configurations, this illustration shows a single wire of each colour connected to each terminal (there could be two or three wires of each colour connected to each terminal) + an additional connection between the mounting box earth terminal and the socket earth terminal.
3. Unscrew each terminal to release the wires.

- **EARTH** = Green & Yellow sleeving
- **NEUTRAL** = Blue (Black pre Apr 04)
- **LIVE** = Brown (Red pre Apr 04)

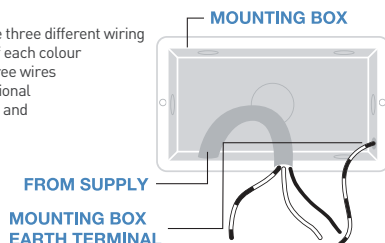

2b. New Installation

1. Install mounting box (metal or patress) for either flush or surface mounting, ensuring appropriate size of product. (Mounting box to be purchased separately)
2. Select the most suitable entry point of the mounting box (knock-out) and route the supply cable through.
3. Cables should be prepared so a sufficient conductor length reaches the terminals. Strip the ends of the individual conductors leaving an adequate length bare to enter terminals.

- **EARTH** = Green & Yellow sleeving
- **NEUTRAL** = Blue (Black pre Apr 04)
- **LIVE** = Brown (Red pre Apr 04)

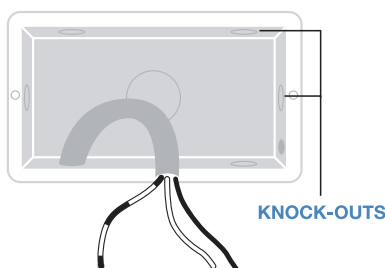

3. Wire Up Your Socket

1. Line up the new socket to mounting box and take note of where each terminal is located.
2. Connect each wire to the matching terminal. (Refer to key in step 2). An earth connection should always be made between the mounting box earth terminal and the socket earth terminal. Make sure no copper wire is exposed & that only the bare end enters the terminal.
3. Tighten terminal screws securely. (Do not over tighten).

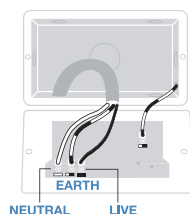

4. Complete The Installation

1. Carefully position the accessory into the mounting box, ensuring that no wires are trapped between the plate and the wall and secure with screws (do not over tighten) then set screw covers in place (optional).



2. Once the installation has been completed correctly, replace the fuse for the circuit, switch the power back on at the consumer unit and test.



5. Insulation testing

This socket outlet is designed to withstand insulation resistance testing at 500V as defined by BS1363-2.

- Perform insulation test between Line & Neutral at 250V.
- 500V test may be performed between Line & Earth, Neutral & Earth.
- Or,
- Disconnect all Neutral connection in the socket and connect into terminal block before replacing the socket prior to test.

Safety Warning

For your safety, this product must be installed in accordance with local Building Regulations. **If in any doubt, or where required by the law, consult a competent person who is registered with an electrical self-certification scheme.** Further information is available online or from your Local Authority.

INDOOR USE ONLY.

Please read carefully and use in accordance with these safety wiring instructions. Before commencing any electrical work ensure supply is switched off at the mains. Either by switching off the consumer unit or by removing the appropriate fuse. Wiring should be in accordance with the latest edition of IET regulations (BS 7671). To prevent fire hazard always use cable of the correct rating, size & type for the application.

Any bare earth wires must be covered with the appropriate green/yellow sleeving.

Warning do not exceed the load rating of this device as stated on rear of the product.

If in doubt always consult a competent electrician

Product Overview

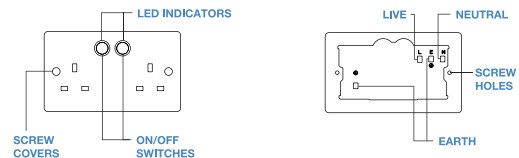

Smart Socket Setup Instructions

6. Install The Bg Home App

Download the BG Home App for your Android or iOS device.



Scan the QR code below



Scan the QR code below



7. Account Creation

Follow the on-screen advice to set-up an initial account.

If you have a BG Home account already skip to "Add Device".

8. Power Up Your Socket

Please follow the in-app instructions. Alternatively, follow the steps below:

On the App press '+' (located at the top-right of the home screen), and select 'Add device'. On the next page, browse to 'WiFi equipment' -> 'Power' -> 'Double Socket', until you reach the screen shown.

Ensure that your Smart Socket is connected to the power supply as per the 'Wiring Instructions'. After the initial power up both switch LED indicators will illuminate **RED, quickly and continuously**, and the socket will be ready for setup. If they are not, press and hold the left button for 5 seconds until they are.

Follow the on-screen instructions to set-up your device. Please make sure your phone is connected to 2.4GHz WiFi so that your device can be discovered and set-up successfully.

Once set up your mobile device will indicate a successful connection and the Red indicator on the socket will turn off.

You can now plug in the device you would like to control.

If these setup procedures fail, follow the "AP Config" setup and follow the step by step instructions on the App.

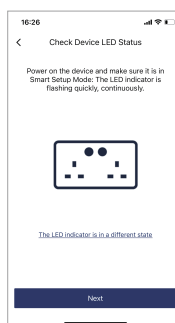

Connecting Additional Smart Devices

To connect additional BG Home Smart Devices, please follow the steps below:

1. Connect and power up the device.
2. Ensure the **RED LED is flashing quickly, continuously**. If it is not, press and hold the button for 5 seconds.
3. On the App press '+' (located at the top-right of the home screen), and select 'Add device'.
4. On the next page either: a) wait for the device to appear automatically after a few seconds and follow the on-screen instructions to add the device or b) select 'WiFi equipment' repeat the instructions from section 3. Please note that option a) will add the device as a sub-device to the first device.
5. Repeat the above for additional BG Home Smart Devices.

Setup Advice & How-To Guides

visit www.bgelectrical.uk/smart for additional support.

Power Control

Power control at each socket can be manual or 'smart'
The power button will illuminate **BLUE** for ON.

Indicator Brightness Control

The intensity of the power indicators can be adjusted. Press and hold button B for 5 seconds. The indicator will illuminate **BLUE** and it will enter the brightness adjustment mode. When the brightness has reached the desired level release the button.

Getting the Most out of your BG Home Sockets

Smart sockets do more than enable you to turn sockets on and off with an App – you can set timers, configure scenes, set a parental lock, control these with your voice and sync up with other smart devices in your home using IFTTT.

Device Menu Screen

Setting Timers

Set up timers so your device will turn on and off at specific times. Save energy by turning sockets off whilst you're at work, turn the lamp on or off at a certain time of day, or set the slow cooker to come on at lunch time so your food is ready to eat when you get home!

Set a Delay

Set a delay time for your sockets to turn on or off after a set length of time. Ideal for sockets where you plug in devices like hair straighteners or heaters for added safety, and for charging your mobile phone so this turns off once it has reached a full charge.

Creating Scenes

You can add many different scenes to suit your lifestyle to further automate your sockets. You may want a number of sockets to turn on or off together without having to operate them all independently. You could set a night-time scene so all lamps turn off and your bedside socket turns on ready to charge your phone, create a 'goodbye' scene for when the house is empty or a 'welcome home' scene so everything is just how you want it when you get home. GO to the 'Scenes' menu on the bottom of the Home screen, select + from the top left corner of the scenes screen and create your custom scene.

Manage Homes

If you have more than one property with smart sockets installed, be it home or office, you can create a separate 'home' for each of these and manage these through the 'Me' menu. Other homes that you have been invited to will also appear in this menu. You can switch between properties in the BG Home App control screen by clicking on the home name at the top of the screen, and switching to the home you want to manage.

Random Function

Turn lamps on and off at random times to imitate home occupancy when you're away for added security.

Invite others to join your home

You may want other members of your household to be able to operate sockets with their own phone or tablet. No problem! You can invite a new member from the BG App Home screen by pressing the + icon at the top of the screen.

Set a Parental Lock

The parental lock allows you to de-activate the active buttons so these cannot be turned on or off at the wall, and prevent members that you have invited within the app from turning sockets on or off, or changing any of your set timers or scenes. This is ideal for sockets which you want to behave in a routine way, and to prevent children turning devices on and off when you don't want them to. To turn on the parental lock, select 'function set' from the ... menu, and toggle the parental lock on or off as required.

Care

To maintain the high quality appearance of sockets, BG Electrical recommend the use of a soft cloth periodically to clean the front face.

Technical Information

Voltage : 220-240V ac
 Frequency : 50/60Hz
 Max Power: 13A 3,120W
 Wire IEEE Standard : Wi-Fi 2.4GHz b/g/n
 Terminal capacity : 3 x 2.5mm² 3 x 4mm² 2 x 6.0mm²
 Min box depth (profiled plates) : 25mm

Batch Code Explanation

yyWxx: Manufacturing date code; year of manufacturing (yy) and week of manufacturing (Wxx)

Address/Helpline

Luceco PLC
 Stafford Park 1
 Telford TF3 3BD
 ENGLAND

(EU) Luceco SE
 C/ Bobinadora 1-5
 08302 Mataró
 SPAIN

If you need further technical assistance you can get in touch with our Technical Helpline on:
+44 (0)3300 249 279
technical.support@bgelectrical.co.uk



UK DECLARATION OF CONFORMITY

This declaration has been issued under the sole responsibility of the manufacturer.

Product

- Smart socket [x22/HC] – 'x' indicates change in colour / front plate
- Type / batch or serial number range 22W25 to 24W25

Name and address of the manufacturer or his authorised representative:

Luceco plc Luceco UK Ltd:
 Building E, Stafford Park 1
 Telford, Shropshire
 TF3 3BD, UK

The object of the declaration is in conformity with the relevant Union harmonisation legislation.

Radio Equipment Regulations 2017 as amended

The Restriction of the use of Certain Hazardous Substances in Electrical and Electronic Equipment Regulations 2012 as amended

References to the relevant designated standards used or references to the other technical specifications in relation to which conformity is declared:

BS1363-2:2016+A1:2018	EN 301 489-1 V2.2.3
EN 60669-2-1:2004+A1:2009+A12:2010	EN 301 489-17 V3.2.4
EN IEC 62311:2020	EN IEC 61000-6-1:2019
BS EN IEC 62311:2020	EN 61000-6-3:2007+A1:2011
EN 300 328 V2.2.2	

Signed for and on behalf of Luceco UK Ltd

Name: David Cleaver
 Position: Senior Product Manager

Signature:

On: 15/06/2022

Environmental Protection



This symbol is known as the "Crossed-out Wheelie Bin Symbol". When this symbol is marked on a product or battery, it means that it should not be disposed of with your general household waste. Some chemicals contained within electrical/electronic products or batteries can be harmful to health and the environment. Only dispose of electrical/electronic/battery items in separate collection schemes, which cater for the recovery and recycling of materials contained within. Your co-operation is vital to ensure the success of these schemes and for the protection of the environment.



EU Declaration of Conformity

This declaration has been issued under the sole responsibility of the manufacturer.

Product

- Smart socket [x22/HC] – 'x' indicates change in colour / front plate
- Type / batch or serial number range 22W25 to 24W25

Name and address of the manufacturer or his authorised representative:

Luceco plc, Luceco Southern Europe, S.L.
 C/ Bobinadora 1-5
 08302 Mataró
 Barcelona (SPAIN)

The object of the declaration is in conformity with the relevant Union harmonisation legislation.

2014/53/EU Radio Equipment Directive

2011/65/EC, 2015/863/ EU Directive RoHS Restriction of the use of certain hazardous substances in electrical and electronic equipment

References to the relevant designated standards used or references to the other technical specifications in relation to which conformity is declared:

BS1363-2:2016+A1:2018	EN 301 489-1 V2.2.3
EN 60669-2-1:2004+A1:2009+A12:2010	EN 301 489-17 V3.2.4
EN IEC 62311:2020	EN IEC 61000-6-1:2019
BS EN IEC 62311:2020	EN 61000-6-3:2007+A1:2011
EN 300 328 V2.2.2	

Signed for and on behalf of

Name: David Cleaver
 Position: Senior Product Manager

Signature:

On: 15/06/2022



If you're an iOS device user, you can control your devices using your iPhone, iPad or Apple Watch.

To control an individual device:

- Select the device from the home screen.
- Press on the ... menu in the top right corner and select 'General'.
- Select 'Add to Siri' and create your Siri shortcut.

Add a scene to make a number of devices change state with one instruction. You will need to create your scene before adding this to Siri.

- Select 'scenes' at the bottom of the home screen.
- Select 'Add to Siri'.
- Choose a pre-configured scene and enter the custom phrase you want to use to activate the scene.



If you're new to Echo, it's a super smart speaker from Amazon that responds to your voice. Once you've bought Amazon Echo and downloaded the BG Home App, you'll just need to enable....

1. Enable the BG Home App

In your Alexa app, tap Skills in the menu and search for BG Home. Tap Enable.

2. Link Account

Enter your BG Home App username and password and follow the onscreen instructions.

3. Talk to Alexa

Now the fun part. Ask Alexa to control your BG Smart Home device.



Now you can use Google's voice-activated speaker to control your Smart Home sockets and adaptors. With the Google Assistant, you can turn on your lights without pressing a button!

1. Setup

Start by getting the Google Home app and setting up your Google Home if you have not done this already.

2. Add BG Smart Home Action

In the Google Home app tap the menu icon and select Home Control. Then tap the + button to see a list of Actions tapping BG Home to select the Action.

3. Link your BG Home Account

Now follow the in-app instructions to link your BG Home App account. Once complete you'll be able to say 'Ok Google, turn my lamp on'.



IFTTT helps you connect all of your different apps and devices. When you sign up for a free account, you can turn on Applets that help your apps and devices work together to do specific things they couldn't do otherwise.

Set up widgets, to turn devices on and off without the need to open the App, turn devices on or off at sunrise and sunset, and use geo-location to turn devices on or off as you approach or leave home.

You can also use IFTTT to synchronise your sockets with smart home devices from other companies, for example you could set a radio plugged in to your smart socket to turn off if your Ring doorbell is pressed, or turn on lamps when you unlock your smart lock that is connected with Samsung smart things - The possibilities are endless!