

# THE RAVEN

1825 W Lawrence Ave  
Chicago, IL 60640



**Steve Schwartz**  
+1 312 228 2157  
[steve.schwartz@jll.com](mailto:steve.schwartz@jll.com)

**Courtney Rouleau**  
+1 312 228 3431  
[courtney.rouleau@jll.com](mailto:courtney.rouleau@jll.com)



# PROPERTY FEATURES



## LOCATION

SWC N Ravenswood Ave  
& W Lawrence Ave

## TOTAL AVAILABLE RETAIL

9,985 SF (Divisible)

## POSSESSION

Spring 2023

## RENT

Negotiable

## COMMENTS

- Ground floor retail with over 150' of frontage on W. Lawrence Ave. at the base of a 167 unit luxury apartment building
- Located adjacent to Mariano's, LA Fitness, Chase Bank and the Ravenswood Metra stop
- 17,000 vpd along Lawrence Ave
- Ideal for both restaurant and retail operators
- Maximize customer experience with an attractive, tree lined, patio.



\*Source: Metra 2019 Annual Report





# SITE PLAN

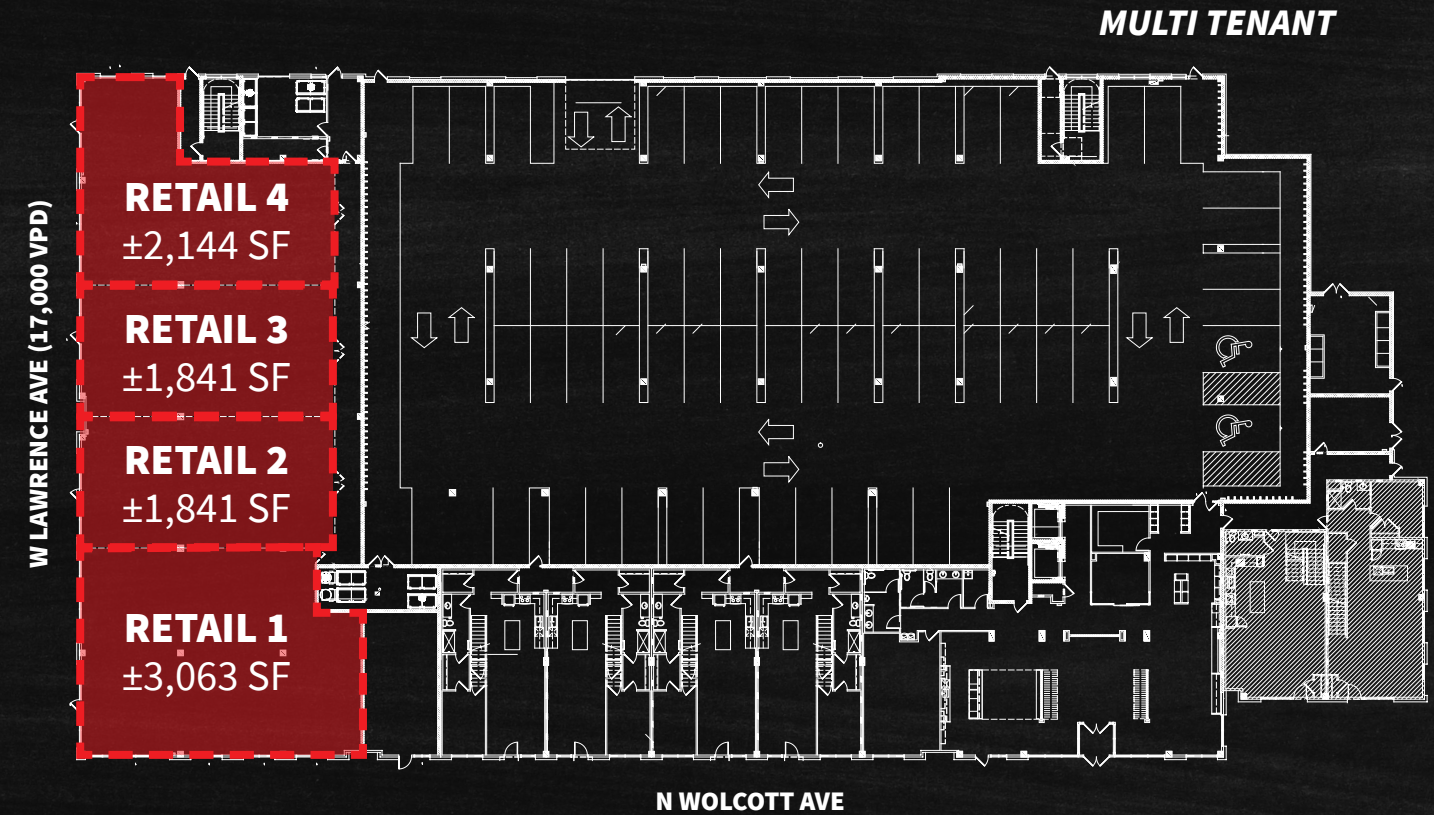
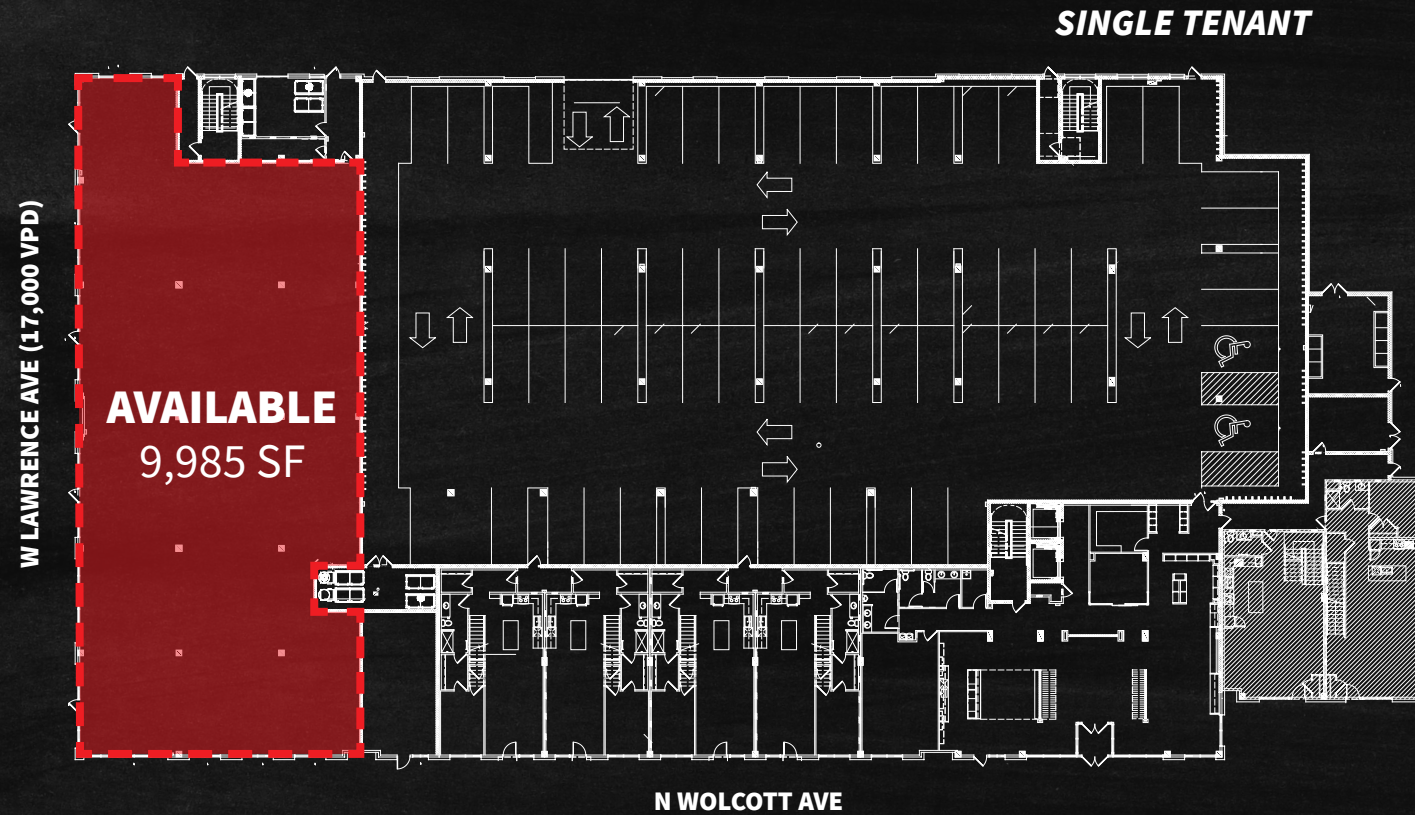

## Neighborhood Demographics

ALL NUMBERS TAKEN FROM ESRI WITHIN 1 MILE.



**54,065**  
DAYTIME POPULATION



**\$135,538**  
AVG. HOUSEHOLD INCOME



**\$462,258**  
MEDIAN HOME VALUE



**66,496**  
RESIDENTIAL POPULATION



**34,010**  
HOUSEHOLDS



**1,954,000+**  
ANNUAL UP-N METRA  
LINE RIDERSHIP



## CONTACT

**Steve Schwartz**

+1 312 228 2157

[steve.schwartz@am.jll.com](mailto:steve.schwartz@am.jll.com)

**Courtney Rouleau**

+1 312 228 3431

[courtney.rouleau@am.jll.com](mailto:courtney.rouleau@am.jll.com)

