

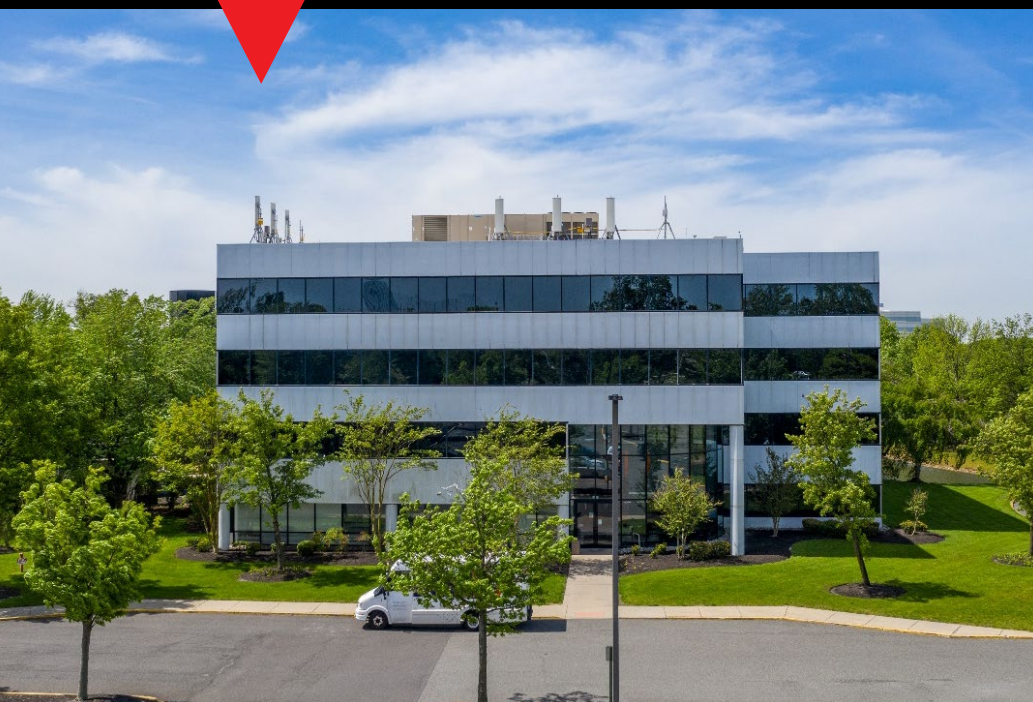

# Laurel Corporate Center

2000 Midlantic Drive  
Mount Laurel, NJ 08054

Sublease Opportunity



## 20,200 s.f. Class A office space

Located near many amenities. Easy access to Route 38 and I-295.

## Property highlights

- Sublease term through 1/31/2026
- Can be delivered furnished
- Space is in new condition
- Restrooms and corridor of floor newly renovated
- Glass on offices and conference rooms
- Large break room
- Great window line with 5 corners
- Direct ramp access to I-295 South

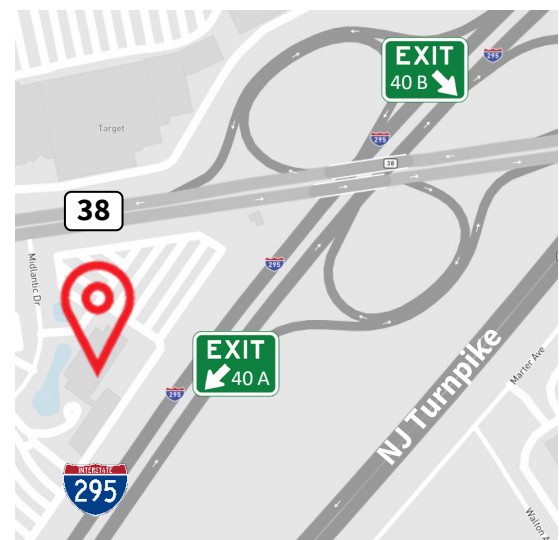



# Laurel Corporate Center

2000 Midlantic Drive, Mount Laurel, NJ 08054

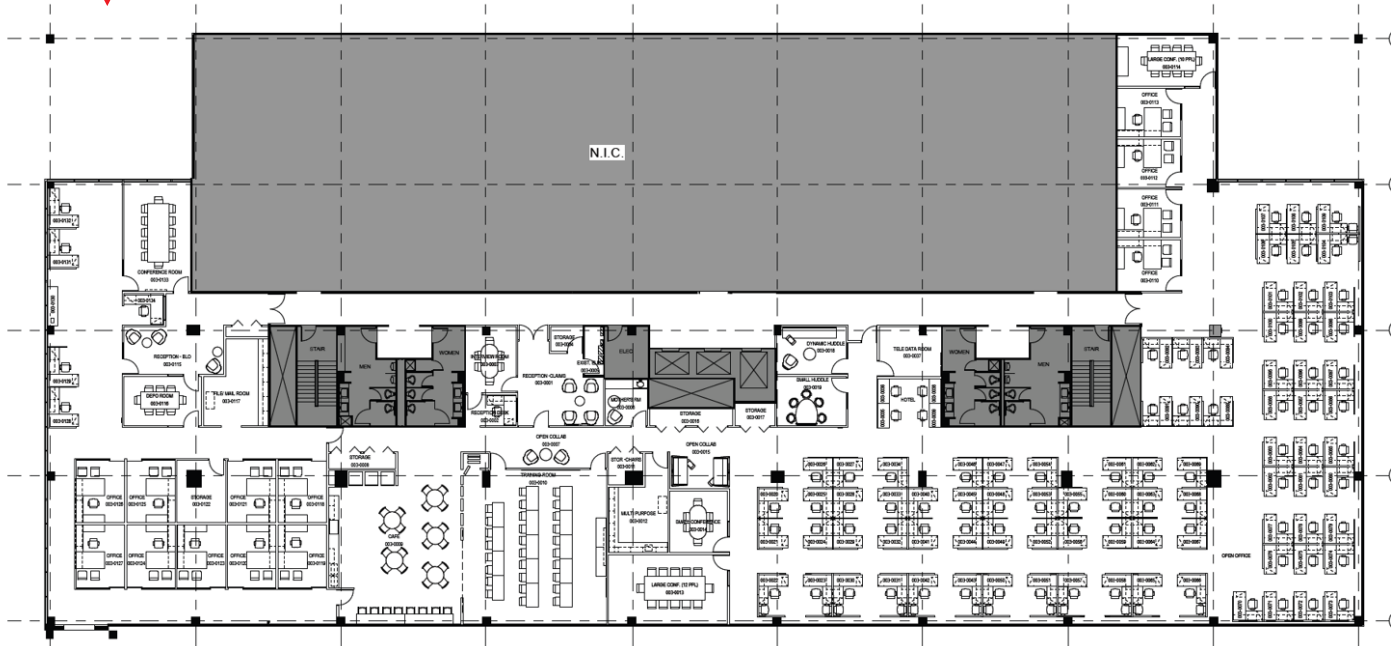

20,200 s.f. sublease



## Contact

Rick Widerman  
Executive Vice President  
+1 856 324 5301  
[rick.widerman@am.jll.com](mailto:rick.widerman@am.jll.com)

Dan Close  
Vice President  
+1 856 324 5306  
[dan.close@am.jll.com](mailto:dan.close@am.jll.com)

Jones Lang LaSalle Brokerage, Inc.  
220 Lake Drive East, Suite 102  
Cherry Hill, NJ 08002  
+1 856 324 5300



Although information has been obtained from sources deemed reliable, neither Owner nor JLL makes any guarantees, warranties or representations, express or implied, as to the completeness or accuracy as to the information contained herein. Any projections, opinions, assumptions or estimates used are for example only. There may be differences between projected and actual results, and those differences may be material. The Property may be withdrawn without notice. Neither Owner nor JLL accepts any liability for any loss or damage suffered by any party resulting from reliance on this information. If the recipient of this information has signed a confidentiality agreement regarding this matter, this information is subject to the terms of that agreement. ©2022. Jones Lang LaSalle IP, Inc. All rights reserved.