



Duane Morris Plaza

30 S. 17th Street | Philadelphia, PA 19103

**18th Floor: 31,609 SF
Available for Sublease**

Peter Barnes, Associate Vice President
(m) +1 215 399 1824 (e) peter.barnes@am.jll.com

Ashley Parrillo, Associate Vice President
(m) +1 215 399 1820 (e) ashley.parrillo@am.jll.com

Anthony LiVecchi, Vice President
(m) +1 215 399 1817 (e) anthony.livecchi@am.jll.com

Property Highlights

- > Full floor law firm space available for sublease
- > Recently renovated
- > Strong sub-landlord credit
- > Furniture available
- > Floor to ceiling windows
- > Sublease through 02/2031

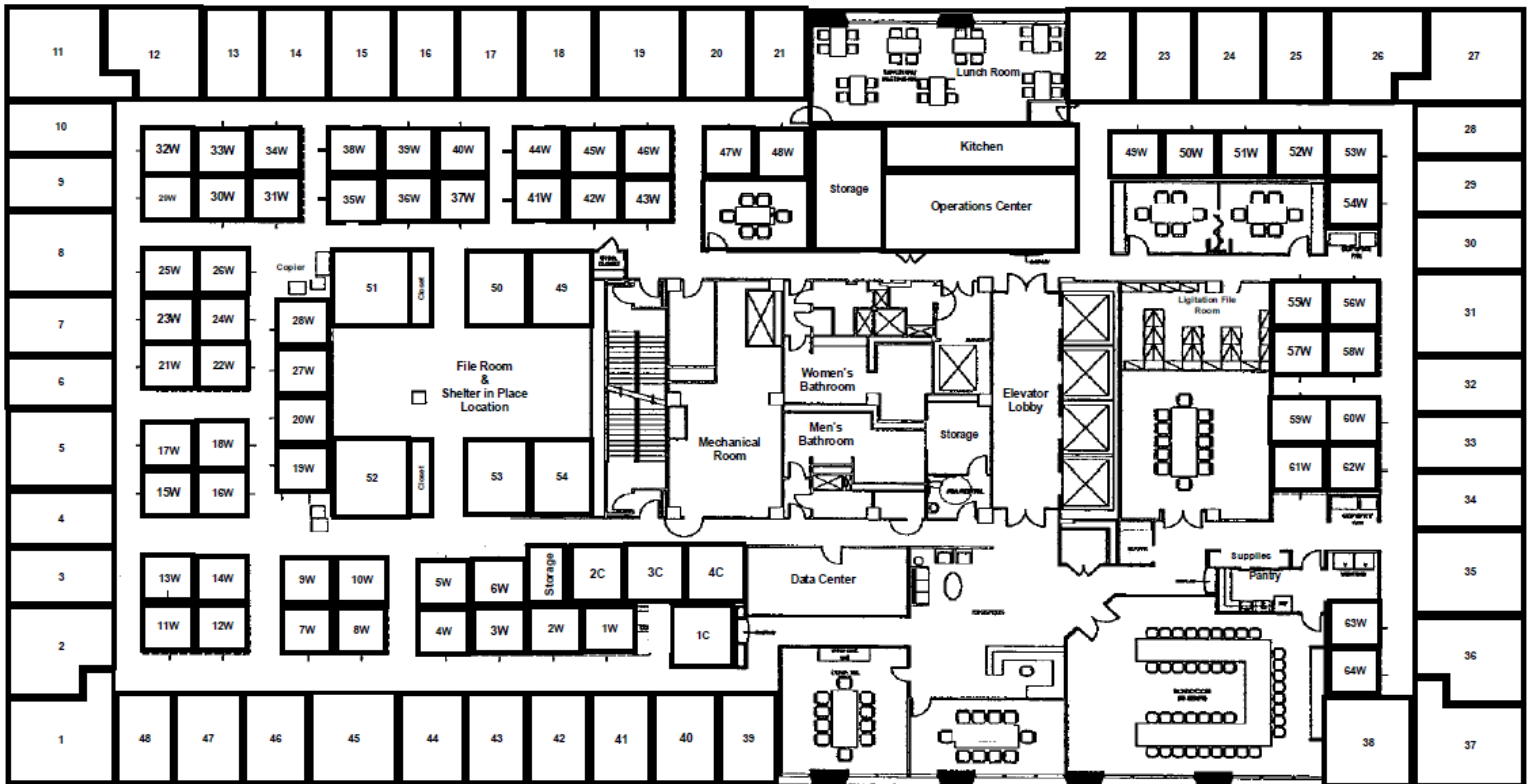

Jones Lang LaSalle Brokerage, Inc.
1650 Arch Street, Suite 2500, Philadelphia, PA 19103

Although information has been obtained from sources deemed reliable, JLL does not make any guarantees, warranties or representations, express or implied, as to the completeness or accuracy as to the information contained herein. Any projections, opinions, assumptions or estimates used are for example only. There may be differences between projected and actual results, and those differences may be material. JLL does not accept any liability for any loss or damage suffered by any party resulting from reliance on this information. If the recipient of this information has signed a confidentiality agreement with JLL regarding this matter, this information is subject to the terms of that agreement. ©2021. Jones Lang LaSalle IP, Inc. All rights reserved.