



Perimeter Park

5221 Paramount Parkway & 1025 Think Place
Morrisville, NC 27560

**Over 300,000 SF of Class A Office available for
Sublease**



5221 & 1025

Adjacent buildings available for a single tenant opportunity



Shared Conference Center
Available for all Tenants



Fitness Center and
Walking Trails Located
within Perimeter Park



4 per 1,000 SF parking ratio



Energy Star Labeled



On-site Cafeteria and
Coffee Bar



Outdoor patio area

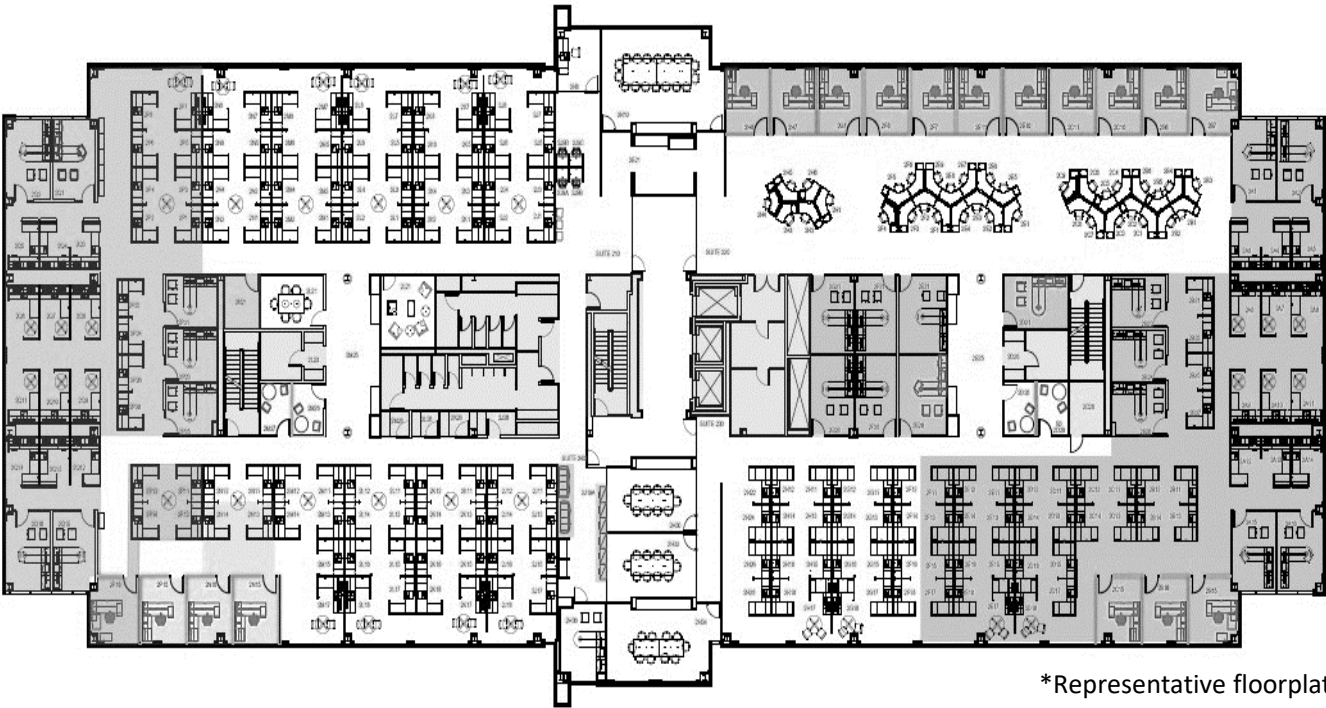

5221 Paramount Parkway

Square Footage:	137,834 SF
Floors:	4
Floor Size:	34,458 SF
Year Built:	2008

1025 Think Place

Square Footage:	187,040 SF
Floors:	5
Floor Size:	37,408 SF
Year Built:	2007



Location and nearby amenities

 5221 Paramount &
1025 Think Place
Morrisville, NC 27560

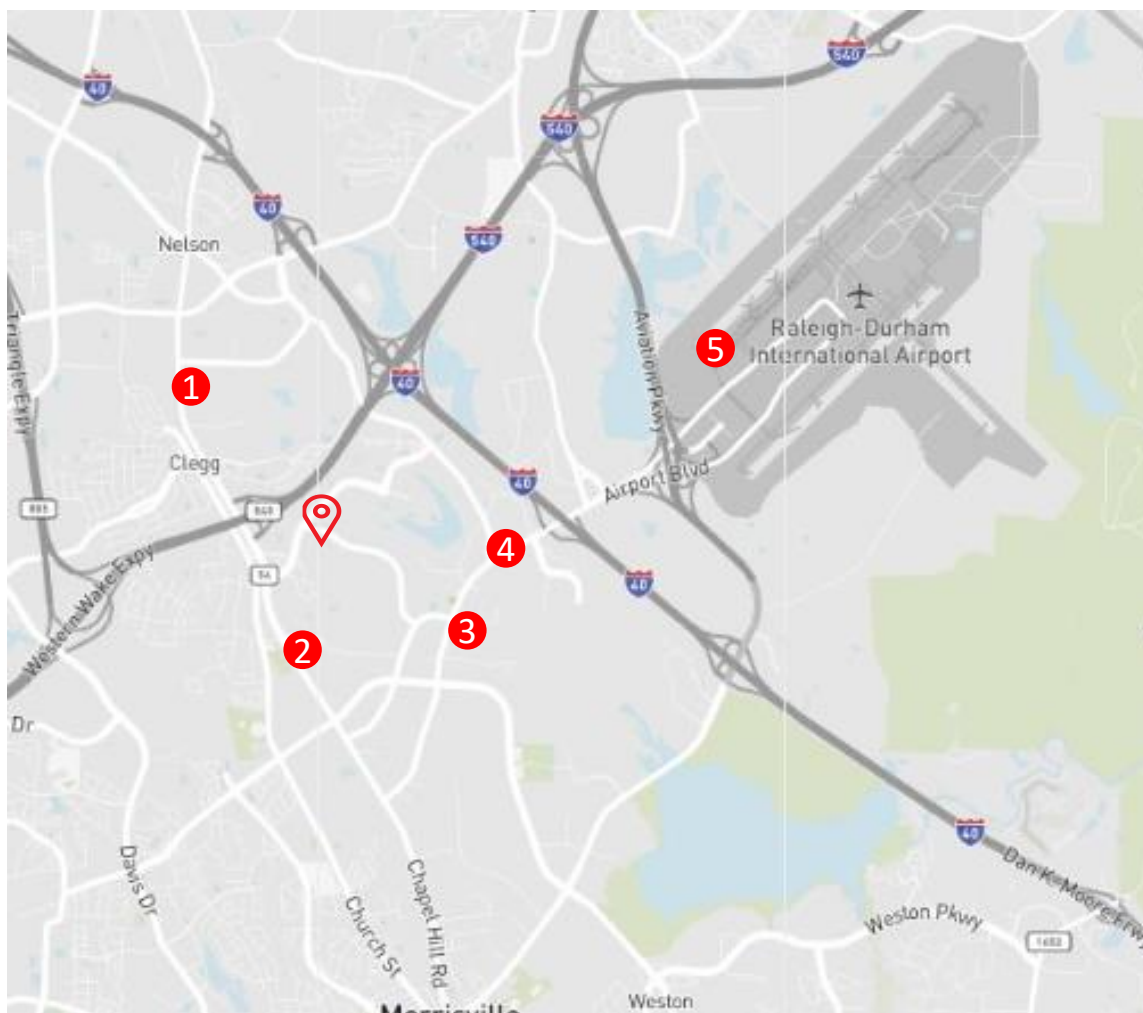

1

Starbucks
Jimmy Johns
BB&T Bank
Page Road Grill
Mez Mexican

2

It's A Wrap
Fount Coffee + Kitchen
Hyatt House
The Daily Taco
Sheetz

3

Oh' Mulligans
Courtyard Marriot
Staybridge Hotel

4

Four Points Sheraton
Holiday Inn
Jersey Mike's Subs
Schlotzsky's

5

Raleigh-Durham
International
Airport

Contact

Bill Sandridge
+1 919 424 8174

Bill.Sandridge@jll.com

Caitlyn Kinnaird
+1 919 424 8457

Caitlyn.Kinnaird@jll.com