



# For Lease

## Oswego Village

101 S State St, Lake Oswego, OR

**5,035 - 11,898 RSF available**

### Overview

- Grocery-anchored office opportunities available now
- Recent multi-million dollar improvements, including: new exterior building facades, updated exterior signage, more accessible storefronts, improved walkability, and additional outdoor dining options
- Steps away from abundant retail and downtown Lake Oswego entertainment and dining options

Suite 3125: 5,035 RSF

- ▶ Ideal for daycare, medical, fitness, and collaborative tech groups
- ▶ Private patio at back of space
- ▶ Shell condition, newly installed skylights, exposed brick and beam
- ▶ Test fit shown for reference

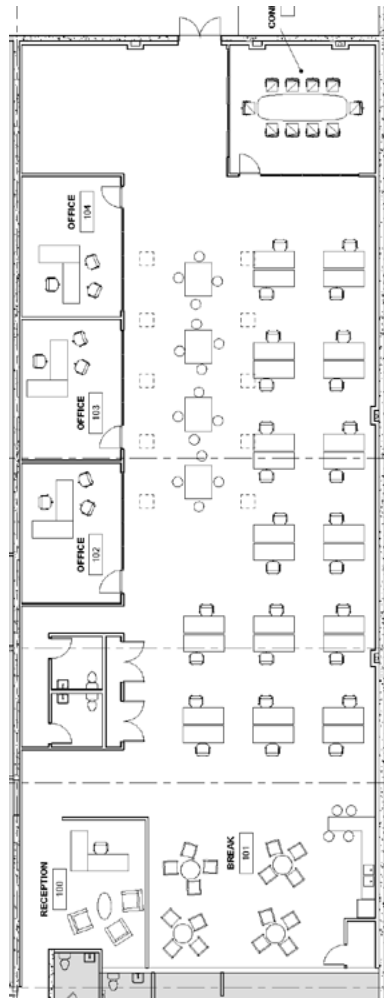

Contiguous Space Options

- |  |  |  |
|--|--|--|
| <b>Option 1:</b><br><b>5,035 -7,535 SF</b><br><i>Suite 3100 + 3125</i> | <b>Option 2:</b><br><b>9,418 SF</b><br><i>Suite 3100 + 3125 + 3130</i> | <b>Option 3:</b><br><b>11,898 SF</b><br><i>Suite 3100 + 3125 + 3130 + 3120</i> |
|--|--|--|



CONCEPTUAL BUILDOUT  
DAYCARE USE



CONCEPTUAL BUILDOUT  
COLLABORATIVE TECH





Walk score

84



Bike score

100



Transit score

83



Jessica Ramey

Vice President

Licensed in OR

503 972 8604

jessica.ramey@am.jll.com

Carter Beyl

Senior Vice President

Licensed in OR

503 505 7120

carter.beyl@am.jll.com



Although information has been obtained from sources deemed reliable, JLL does not make any guarantees, warranties or representations, express or implied, as to the completeness or accuracy as to the information contained herein. Any projections, opinions, assumptions or estimates used are for example only. There may be differences between projected and actual results, and those differences may be material. JLL does not accept any liability for any loss or damage suffered by any party resulting from reliance on this information. If the recipient of this information has signed a confidentiality agreement with JLL regarding this matter, this information is subject to the terms of that agreement. ©2022. Jones Lang LaSalle IP, Inc. All rights reserved.

Jones Lang LaSalle Brokerage, Inc. | 1120 NW Couch St, Suite 500, Portland, OR 97209 | +1 503 972 8000