

PARKWOOD

CROSSING

SIX PARKWOOD CROSSING

600 East 96th Street, Indianapolis, IN 46240



BUILDING HIGHLIGHTS

- Highly efficient, 33,000-square foot floor plates
- Adjacent to PARC amenity & recreation center
- Abundant surface parking
- Excellent I-465 visibility
- Convenient access to I-465 / U.S. 31
- Adjacent to conference center and auto spa
- Beautifully renovated modern lobby with digital display screens
- Lobby and exterior seating areas equipped with wi-fi

PARKWOOD AMENITIES

Parkwood Crossing amenities include a 6,000 square foot fitness center with state-of-the-art equipment, locker rooms and private showers, multiple tech-savvy meeting spaces for small or large groups, multiple cafes with online ordering, indoor and outdoor tenant lounges, an Auto Spa and Tesla/universal car chargers, a 1.36 mile walking path, access to the Carmel Zagster bicycle sharing program and a connecting path to the Monon Trail. (see amenities map on adjacent page)

BUILDING DESCRIPTION

- Total square footage: 200,237
- Stories: 6
- Class: A
- Year built: 2000

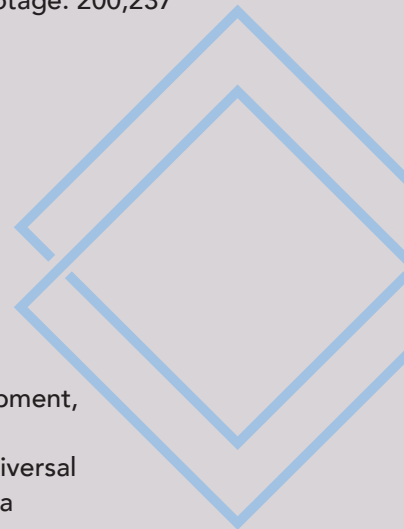

SIX PARKWOOD CROSSING

600 East 96th Street, Indianapolis, IN 46240



**PARKWOOD
CROSSING**

LOCATION

Parkwood Crossing is strategically positioned with immediate access to I-465, U.S. 31, and 96th Street and boasts I-465 visibility. Located at the northern boundary of Indianapolis, the park is adjacent to the affluent suburbs of Carmel, Zionsville and Fishers in Hamilton County. Along with being one of the fastest growing counties in the nation, Hamilton County is home to a population earning more than double the national and state average for household income.

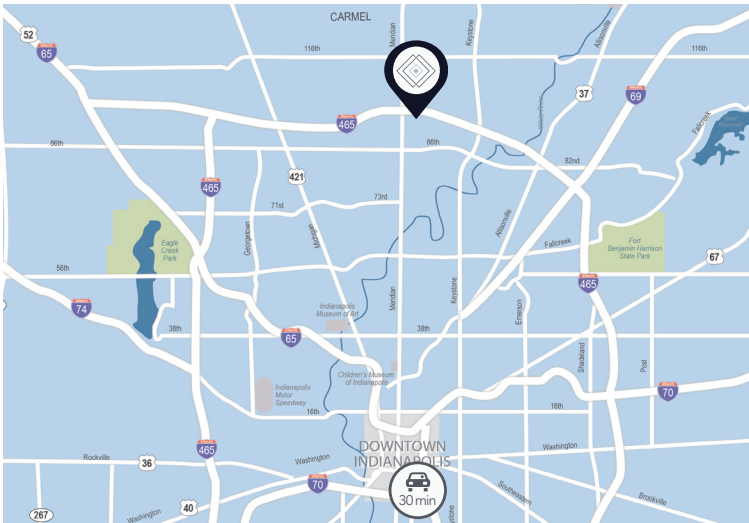

AMENITIES IN PARKWOOD CROSSING



PARC
(Parkwood Amenity and Recreation Center)



Outdoor Lounge / Workspace



Tenant Lounge



1.36 mile walking trail



Café / Grab 'n Go



Tesla / Universal Car Chargers



Wi-Fi in Lobby



Conference Center



Auto Spa

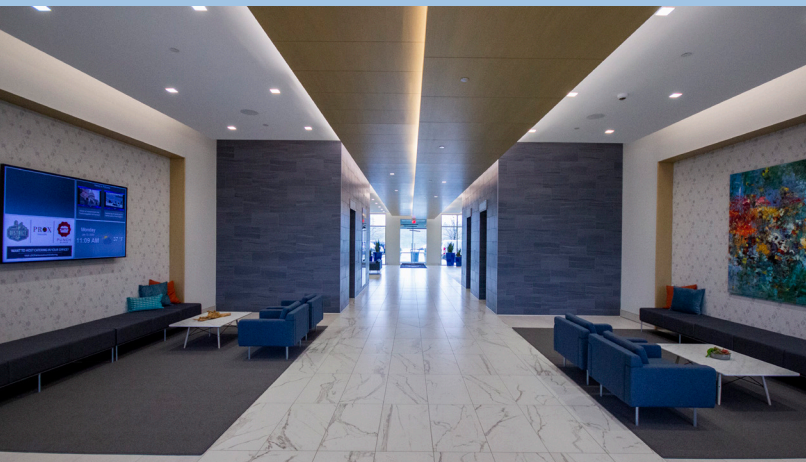

TRACI KAPSALIS
Senior Vice President
+1 317 810 7013
traci.kapsalis@am.jll.com

ADAM BRODERICK
Managing Director, Market Lead
+1 317 810 7178
adam.broderick@am.jll.com

BRITTANY SHULER
Associate Broker
+1 317 810 7176
brittany.shuler@am.jll.com



**STRATEGIC CAPITAL
PARTNERS**

