

For Lease

281 Winter Street
Waltham, MA

Class A office availability



Multiple suites available 1,035 SF - 23,538 SF

281 Winter Street is a three-story 67,000 SF Class A office building set within Somerset Court. Located in the heart of Waltham, this building is a highly visible multi-tenant office building that offers immediate access to Route 128/95, the Massachusetts Turnpike and Routes 2 and 20.

The building's location directly off of Route 128/95 offers easy access in all directions as well as immediate adjacency to Waltham's wealth of shopping and dining amenities as well as several hotels.

Available:

2nd Floor - 23,538 RSF

3rd Floor - 8,942 RSF

3rd Floor - 1,035 RSF

Nearby:



Retail



Lodging



Food



Fitness

AVAILABLE *Space*



**3RD FLOOR
1,035 RSF**

**3RD FLOOR
8,942 RSF**

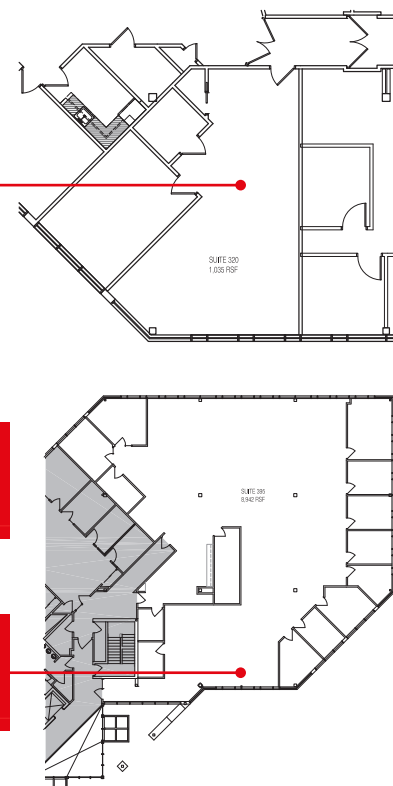

For more information, contact:

Rob Waller
617 316 6405
Robert.Waller@am.jll.com

Sam Crossan
617 316 6496
Sam.Crossan@am.jll.com

Although information has been obtained from sources deemed reliable, neither Owner nor JLL makes any guarantees, warranties or representations, express or implied, as to the completeness or accuracy as to the information contained herein. Any projections, opinions, assumptions or estimates used are for example only. There may be differences between projected and actual results, and those differences may be material. The Property may be withdrawn without notice. Neither Owner nor JLL accepts any liability for any loss or damage suffered by any party resulting from reliance on this information. If the recipient of this information has signed a confidentiality agreement regarding this matter, this information is subject to the terms of that agreement. ©2019 Jones Lang LaSalle IP, Inc. All rights reserved.